

DETAIL OF CURBS ADJACENT TO RAILROAD CROSSINGS

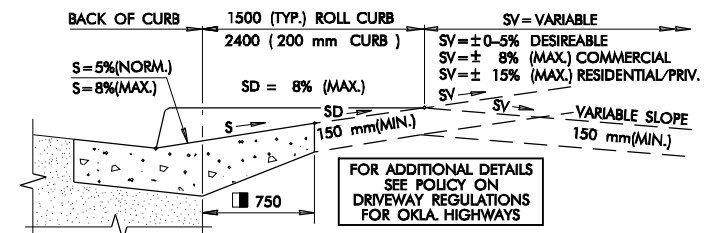

■ WHEN SIDEWALK IS BUILT DIRECTLY BEHIND CURB, THE CONCRETE DRIVEWAY SHOULD BE CONSTRUCTED & EXTENDED TO THE BACK EDGE OF SIDEWALK.

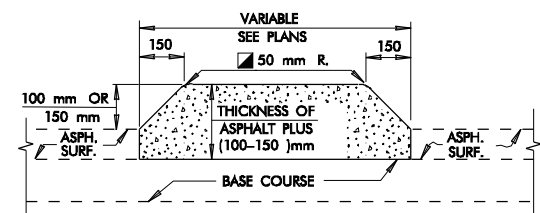

CONCRETE MEDIAN
MOUNTABLE CURB TYPE
(TO BE PAID FOR AS CLASS A CONCRETE.)

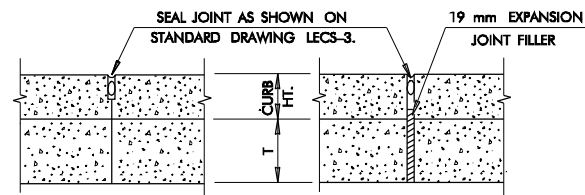

SECTION A-A
ISOLATION JOINTS

CURB & GUTTER JOINTS
BUTT & ISOLATION JOINTS TO EXTEND THROUGH
CURB & GUTTER TO BACK OF CURB

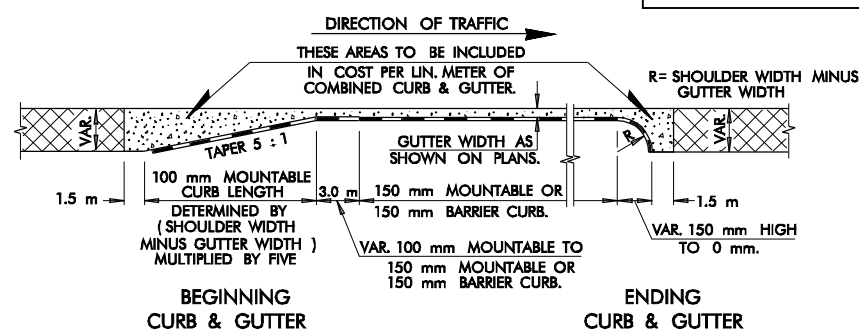

- WIDTH OF CURB & GUTTER WILL BE SPECIFIED.
- ▲ HEIGHT & TYPE OF CURB SHALL BE SPECIFIED.
- ▼ THICKNESS WILL BE SPECIFIED

BASIS OF PAYMENT		
ITEM NO.	ITEM	UNIT
414.06(C)	CONCRETE RAILROAD APPROACH SLAB	SQ. METER
509.06(B)	CLASS A CONCRETE	CUBIC METER
609.06(B)	■ COMBINED CURB & GUTTER (▲)	METER
610.06(B)	CONCRETE DRIVEWAY	SQ. METER
610.06(C)	▼ CONCRETE DIVIDING STRIP	SQ. METER
610.06(H)	▼ BITUMINOUS DIVIDING STRIP	SQ. METER

APPROVED BY ROADWAY ENGINEER

DATE _____

**OKLAHOMA DEPT. OF TRANSPORTATION
ROADWAY STANDARD (METRIC)**

ASPHALT SURFACING CONSTRUCTION DETAILS

1999 SPECIFICATIONS

ASCD-4	01M
--------	-----

ALL DIMENSIONS ON THIS SHEET IN MILLIMETERS UNLESS OTHERWISE NOTED.