

TYPICAL LINE POST DETAIL

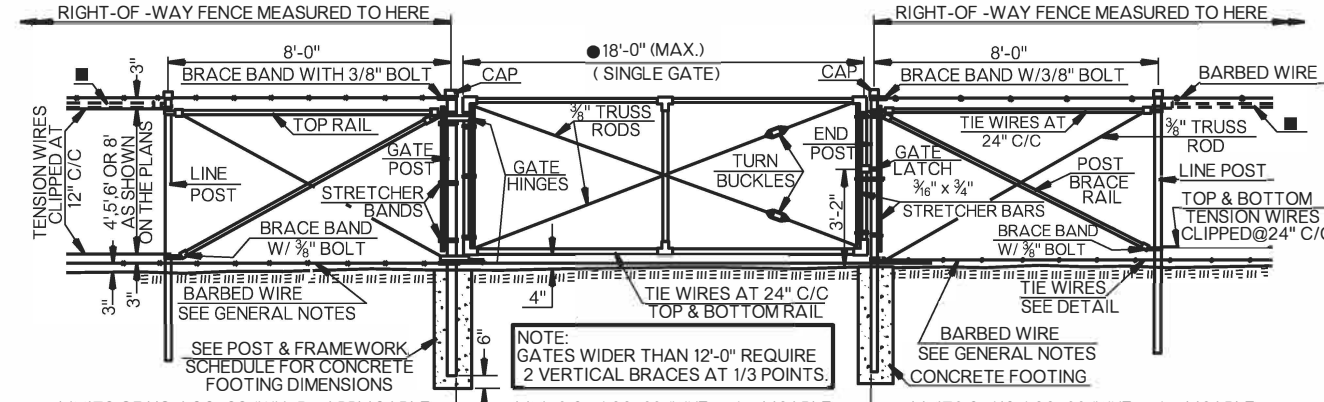

GATE DETAIL

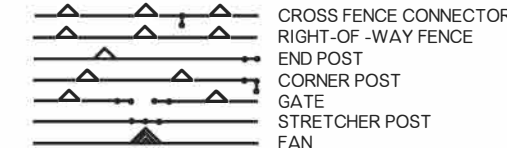

FENCING SYMBOLS ON PLANS
SEE PLAN AND PROFILE SHEETS FOR LOCATION.

CONCRETE FOOTING FOR POSTS

FENCING SYMBOL THIS SHEET

END, CORNER, & STRETCHER DETAILS
USE STRETCHER DETAILS AT ALL CORNERS, BENDS IN R/W, ON HILL TOPS IN VALLEYS OR DEEP DEPRESSIONS AND AT 500 FEET MAXIMUM SPACING - (REQUIRES CONCRETE FOOTING)

SEE PLANS FOR SIZE AND LOCATION OF GATES. FOR WIDTH GREATER THAN 18'-0", USE DOUBLE SWING GATES WITH MIDDLE LATCH. OPENING MAY BE UP TO 36'-0" WIDE.

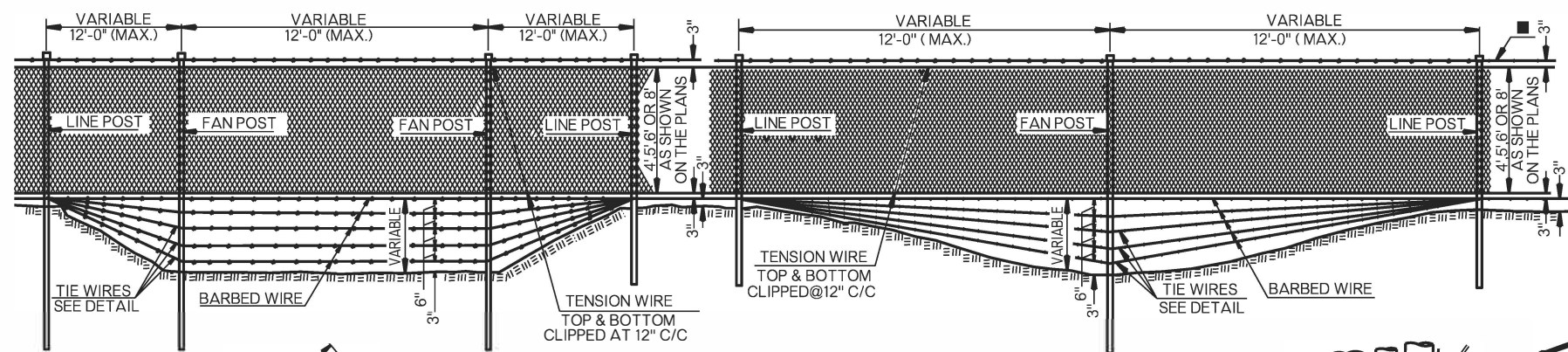

FAN DETAILS

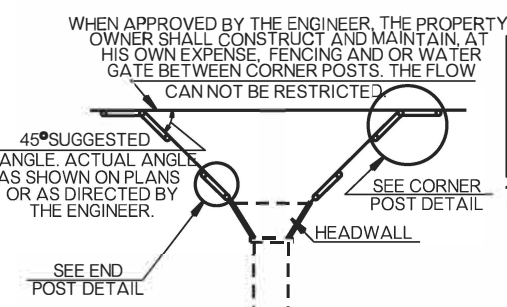

PLAN HEADWALL CONNECTION

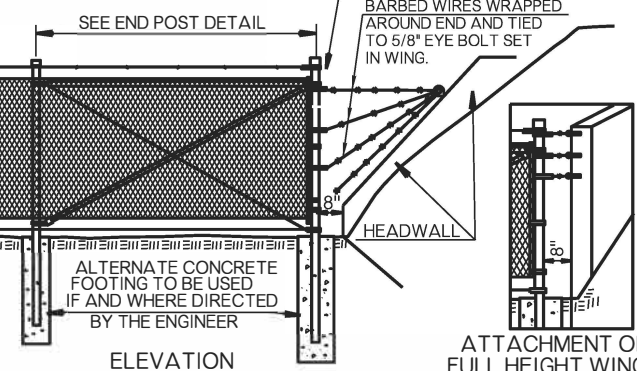

ELEVATION HEADWALL CONNECTION

ATTACHMENT OPTION FULL HEIGHT WING/WALL WHEN WING OR WALL HEIGHT EQUALS FENCE HEIGHT

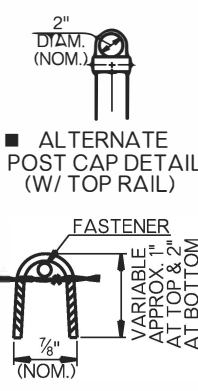

SECTION A-A

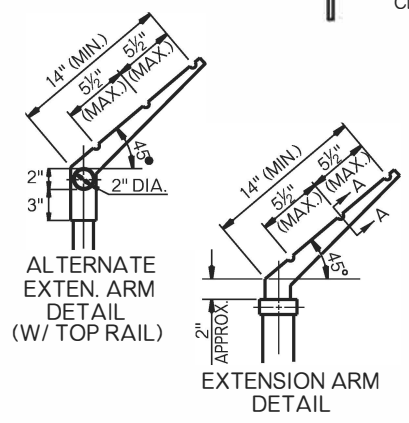

ALTERNATE POST CAP DETAIL (W/ TOP RAIL)

ALTERNATE EXTEN. ARM DETAIL (W/ TOP RAIL)

EXTENSION ARM DETAIL

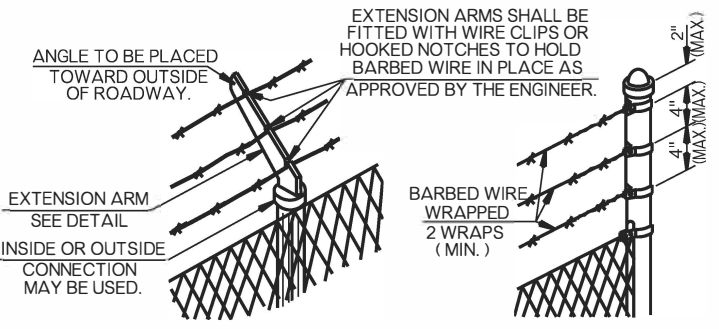

ANGULAR CLIMB BARRIER FOR LINE POSTS

VERTICAL CLIMB BARRIER FOR END & GATE POSTS

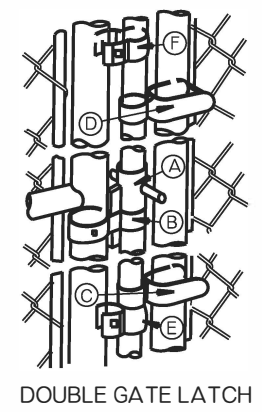

DOUBLE GATE LATCH

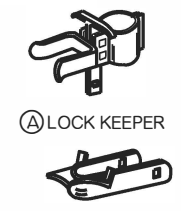

(A) LOCK KEEPER

(B) LOCK KEEPER GUIDE

(C) LOWER FORKS

(D) UPPER FORKS

(E) LOWER GUIDE

(F) UPPER GUIDE

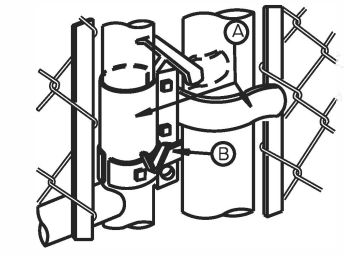

SINGLE GATE LATCH

TYPICAL GATE LATCH DETAIL
ALTERNATE TYPE LATCH MAY BE USED IF APPROVED BY THE ENGINEER.

GENERAL NOTES

- ALL CONSTRUCTION AND MATERIAL REQUIREMENTS SHALL BE IN ACCORDANCE WITH THE 2019 ODOT STANDARD SPECIFICATIONS.
- COST OF BARBED WIRE AND EXTRA LENGTH POSTS FOR FAN TO BE INCLUDED IN PRICE BID FOR CHAIN LINK FENCE.
- THE BOTTOM BARBED WIRE MAY BE OMITTED AND FABRIC INSTALLED 1" CLEAR FROM GROUND LINE IN LOCATIONS APPROVED BY THE ENGINEER.
- ALL MISCELLANEOUS HARDWARE SHALL BE FURNISHED GALVANIZED OR ALUMINUM ALLOY.
- CLIMB BARRIER SHOWN INTENDED ONLY TO SHOW AN ACCEPTABLE TYPE. ALTERNATE CLIMB BARRIERS APPROVED BY THE ENGINEER PRIOR TO INSTALLATION MAY BE USED. FENCE POST EXTENSION ARM SHALL BE MADE OF PRESSED STEEL OR MALLEABLE IRON AND SHALL BE GALVANIZED AFTER FABRICATION.
- CHAIN LINK FABRIC MAY BE ACCEPTED KNUCKLED BOTH SELVAGES IN ALL WIDTHS. NO FABRIC WITH TWISTS AND BARBS ON BOTH SELVAGES WILL BE ACCEPTED.
- STRETCHER POSTS TO BE USED IN GENERAL AT HILL TOPS AND AT BOTTOM OF VALLEYS AND AT A MAXIMUM OF 500 FEET APART.
- ALL POSTS WITH THE EXCEPTION OF LINE POSTS, FAN POSTS AND HEADWALL CONNECTION STRETCHER POSTS SHALL BE EMBEDDED IN CONCRETE WHEN FENCE IS BEING ERECTED ON EARTHEN FOUNDATIONS. OTHER POSTS MAY BE EMBEDDED IN CONCRETE IF AND AS DIRECTED BY THE ENGINEER TO SATISFY SPECIFIC FOOTING REQUIREMENTS.
- WHEN TOP RAIL IS USED IN LIEU OF BARBED TOP WIRE THE COST OF TOP RAIL SHALL BE INCLUDED IN THE PRICE BID FOR FENCE.

SHAPE	POST & FRAMEWORK SCHEDULE												
	LINE POST				END, CORNER, OR STRETCHER POSTS	GATE POSTS			TOP RAIL OR POST BRACE RAIL	GATE FRAMES			
	6" WIDE & LESS	OVER 6" TO 12" WIDE	OVER 12" TO 18" WIDE		6" WIDE & LESS	OVER 6" TO 12" WIDE	OVER 12" TO 18" WIDE		GATES UP TO 6' WIDE	GATES OVER 6' TO 12'	GATES OVER 12' TO 18'		
NOMENCLATURE	1 7/8" O.D. PIPE	ROLL FORMED HEAVY "C"	ROLL FORMED STAND. "C"	"H" RAIL	2 3/8" O.D. PIPE	2 7/8" O.D. PIPE	4" O.D. PIPE	5.9/16" O.D. PIPE	1 5/8" O.D. PIPE	ROLL FORMED	1 5/8" O.D. PIPE	1 7/8" O.D. PIPE	1 7/8" O.D. PIPE
DIMENSIONS	1.9" O.D. T = -0.145"	2.25" x 1.7" T = -0.121"	1.875" x 1.625" T = -0.121"	2.25" x 1.7" T = -0.125"	2.375" O.D. T = -0.154"	2.875" O.D. T = -0.203"	4.0" O.D. T = -0.226"	5.563" O.D. T = -0.258"	1.66" O.D. T = -0.111"	1.625" x 1.25" T = -0.08"	1.66" O.D. T = -0.111"	1.9" O.D. T = -0.120"	1.9" O.D. T = -0.145"
CRITICAL AXIS SEC. MODULUS	.326 IN. ³	.506 IN. ³	.368 IN. ³	.661 IN. ³	.561 IN. ³	1.06 IN. ³	2.39 IN. ³	5.45 IN. ³	0.195 IN. ³	0.165 IN. ³	0.195 IN. ³	0.270 IN. ³	0.326 IN. ³
WEIGHT	2.72 LBS./LIN. FT.	2.78 LBS./LIN. FT.	3.26 LBS./LIN. FT.	3.65 LBS./LIN. FT.	3.65 LBS./LIN. FT.	5.79 LBS./LIN. FT.	9.11 LBS./LIN. FT.	14.63 LBS./LIN. FT.	1.84 LBS./LIN. FT.	1.35 LBS./LIN. FT.	1.84 LBS./LIN. FT.	2.28 LBS./LIN. FT.	2.72 LBS./LIN. FT.
LENGTH FOR GIVEN FENCE FAB. HT.	4' 6"-10" W/CONC. FOOTING; 7'-4" WHEN DRIVEN.	5' 8"-1" W/CONC. FOOTING; 8'-7" WHEN DRIVEN.	5' 9"-4" W/CONC. FOOTING; 9'-10" WHEN DRIVEN.	8' 11"-4" W/CONC. FOOTING; 11'-10" WHEN DRIVEN.	7'-4" W/CONC. FOOTING	8'-7" W/CONC. FOOTING	9'-10" W/CONC. FOOTING	10'-4" W/CONC. FOOTING	7'-10"	9'-1"	10'-4"	12'-4"	
EMBEDMENT FOR GIVEN FENCE FAB. HT.	4' 24" IN CONC. FOOTING; 30" WHEN DRIVEN.	5' 27" IN CONC. FOOTING; 33" WHEN DRIVEN.	5' 30" IN CONC. FOOTING; 36" WHEN DRIVEN.	8' 33" IN CONC. FOOTING; 36" WHEN DRIVEN.	30" IN CONC. FOOTING	33" IN CONC. FOOTING	39" IN CONC. FOOTING	42" IN CONC. FOOTING	36"	39"	42"	42"	
FOOTING DIM. IN EARTH	9" DIA. 36" DEEP				9" DIA.	12" DIA.	16" DIA.	18" DIA.					
FOOTING DIM. IN ROCK	4" DIA. 9" DEEP				4" DIA. 9" DEEP	5" DIA. 12" DEEP	6" DIA. 16" DEEP	8" DIA. 24" DEEP					

DIAMETERS AS SHOWN ARE MINIMUM VALUES. DEPTHS FOR ROCK ARE MINIMUMS. DEPTHS SHOWN FOR CONCRETE FOOTINGS IN EARTH ARE MINIMUM FOR 6'-0" HIGH FENCE AND MAY BE REDUCED 3" FOR EACH FOOT OF FENCE HEIGHT LESS THAN 6'-0" HIGH.

▲ T = WALL THICKNESS

▼ SECTION MODULUS AS SHOWN IS BASED UPON ASTM A53 AND AASHTO M 181. SEE SPECIFICATIONS FOR SUBSTITUTION FORMULA ON CLASS 2 COLD FORMED STEEL PIPE.

● SECTION MODULUS AS SHOWN IS BASED UPON ASTM A501 AND AASHTO M 181. SEE SPECIFICATIONS FOR SUBSTITUTION FORMULA ON CLASS 2 COLD FORMED STEEL PIPE.

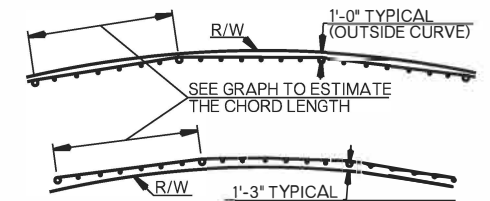
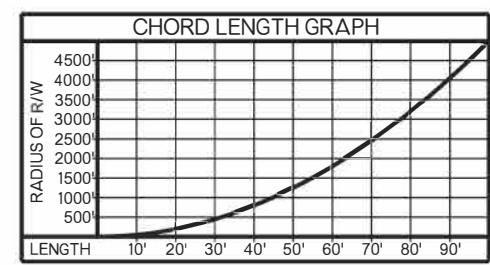

TYPICAL PLACEMENT FOR FENCE ALONG CURVES (WHEN R/W RADIUS IS LESS THAN 5000')

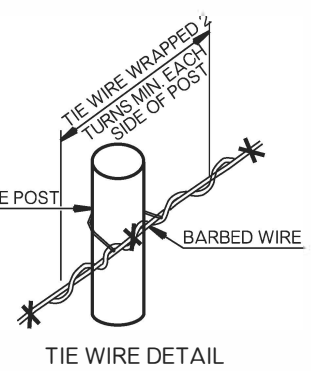

TIE WIRE DETAIL

BASIS OF PAYMENT		
ITEM NO.	ITEM	UNIT
624 (E)	FENCE, STYLE CLF (1 FT. HIGH, CLASS A)	LF
624 (F)	GATE, STYLE CLF (1 FT. HIGH X 1 FT. LONG)	EA

- HEIGHT OF FENCE OR GATE SHALL BE SPECIFIED.
- CLASS A DESIGNATES FENCE OR GATE WITHOUT CLIMB BARRIER
- CLASS B DESIGNATES FENCE OR GATE WITH CLIMB BARRIER
- LENGTH OF GATE SHALL BE SPECIFIED.

APPROVED BY ROADWAY ENGINEER: *[Signature]* DATE: 6/30/22
ROADWAY DESIGN DIVISION STANDARD