

NON-DOWELED CONTRACTION JOINT

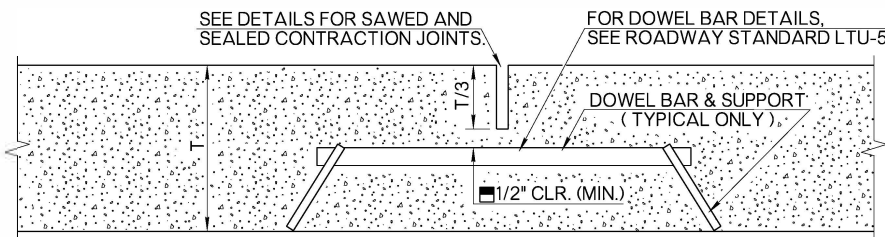

DOWELED CONTRACTION JOINT

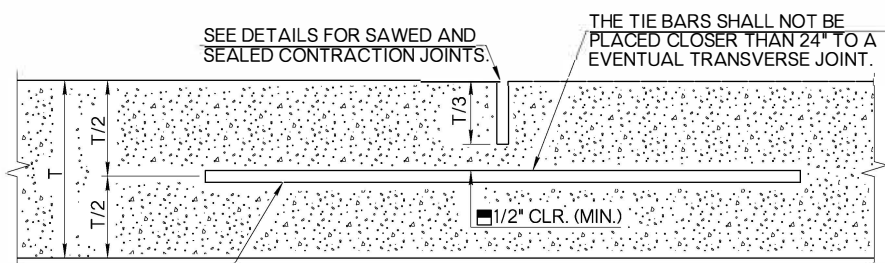

LONGITUDINAL JOINT

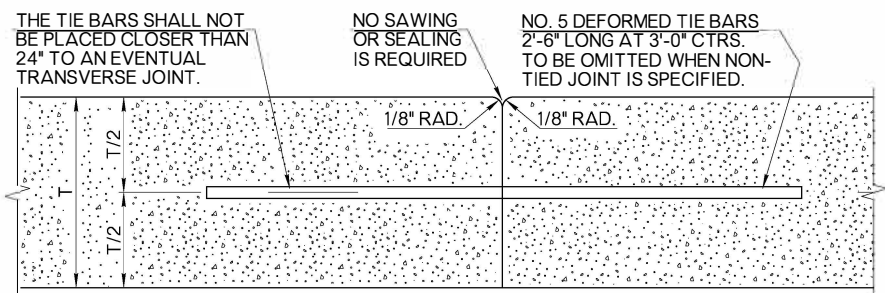

TIED BUTT JOINT AND LONGITUDINAL CONSTRUCTION JOINT

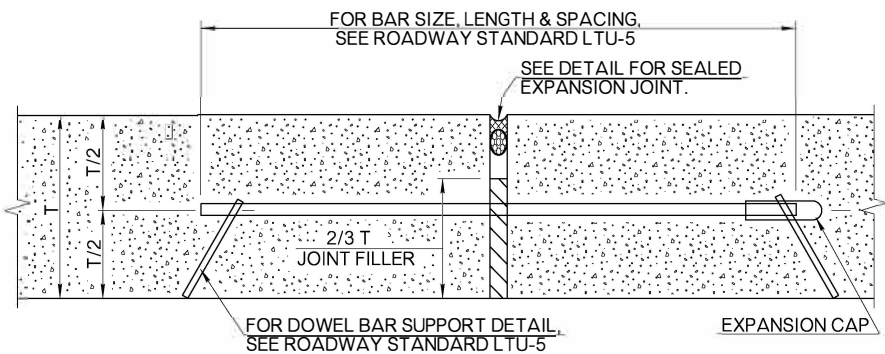

EXPANSION JOINT / ISOLATION JOINT
OMIT DOWEL BARS, CAPS & SUPPORTS FOR ISOLATION JOINTS

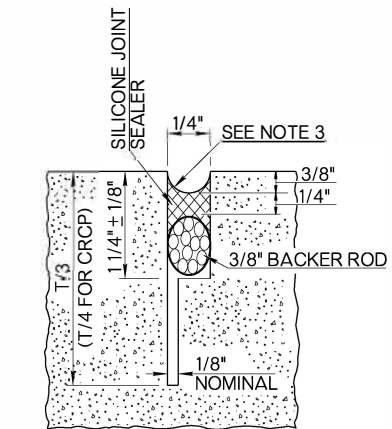

SILICONE SEALANT OPTION

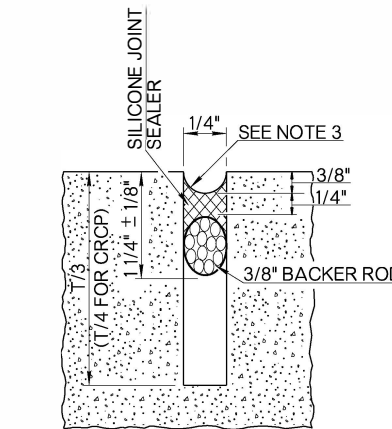

SILICONE SEALANT OPTION

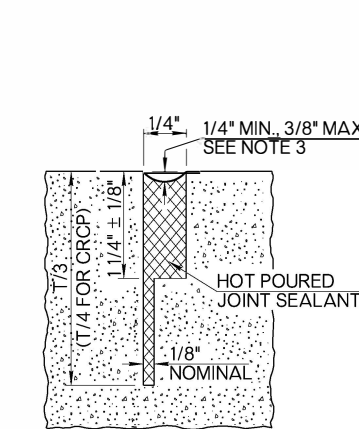

HOT POUR OPTION

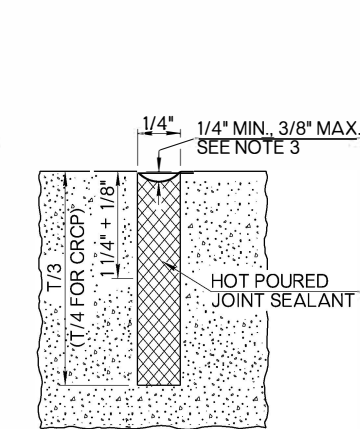

HOT POUR OPTION

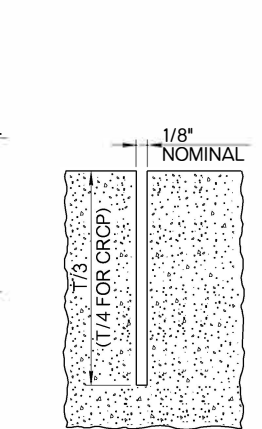

NO SEALANT OPTION

SAWED AND SEALED, CONTRACTION AND LONGITUDINAL JOINTS ALTERNATE DETAILS
UNLESS OTHERWISE SPECIFIED IN THE PLANS, ONLY THE SILICONE SEALANT OPTIONS WILL BE ALLOWED.

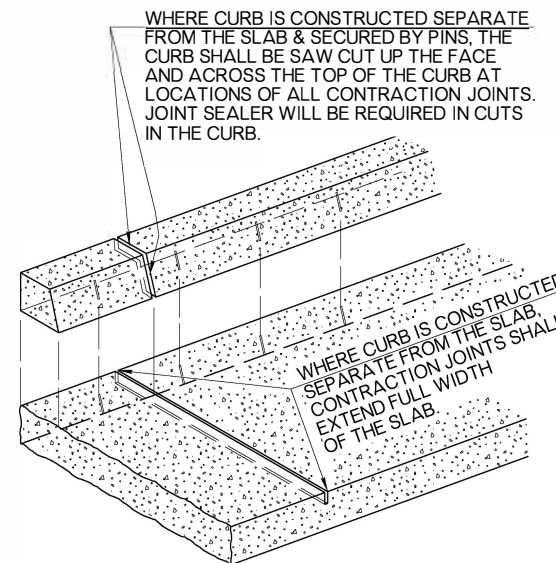

CONTRACTION JOINT WITH SEPARATE CURB

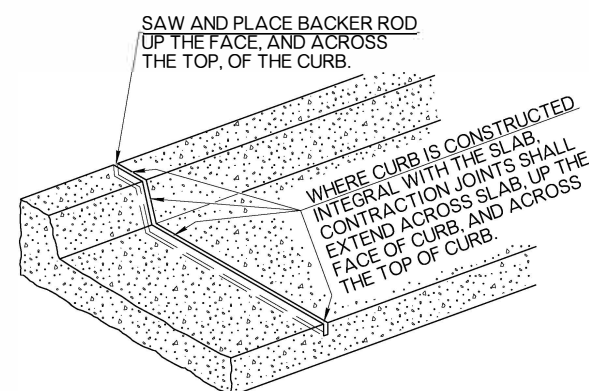

CONTRACTION JOINT WITH INTEGRAL CURB

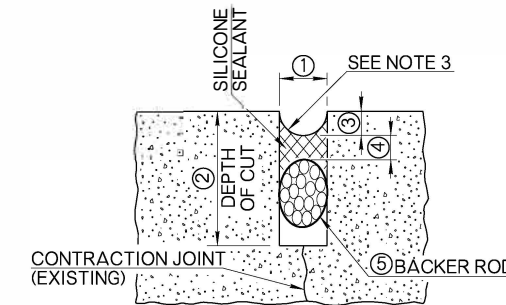

JOINT REHABILITATION DETAILS

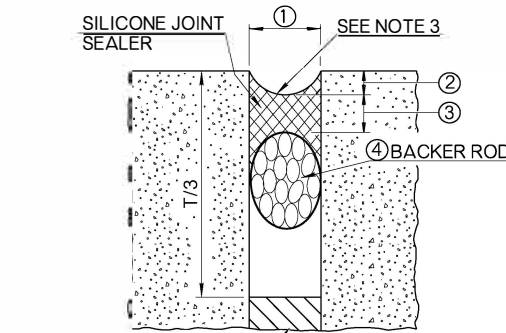

EXPANSION JOINTS / ISOLATION JOINTS

HOT POURED JOINT SEALANT MAY BE USED IN LIEU OF BACKER ROD AND SILICONE SEALANT, IF APPROVED BY THE ENGINEER

JOINT WIDTH ①	SEALANT RECESS DEPTH ②	SILICONE SEALANT THICKNESS ③	BACKER ROD DIAMETER ④
1/2"	3/8"	1/4"	5/8"
3/4"	3/8"	3/8"	7/8"
1"	3/8"	1/2"	1 1/4"
1 1/2"	1/2"	3/4"	2"
2"	1/2"	3/4"	2 1/2"

EXPANSION OR ISOLATION JOINT WIDTH SHALL BE 1/2", UNLESS OTHERWISE SPECIFIED ON THE PLANS. TABLE VALUES, AS SHOWN THIS TABLE, SHALL BE USED IN THOSE SPECIFIED CASES.

SILICONE SEALANT				
JOINT WIDTH ①	DEPTH OF CUT ②	SEALANT RECESS DEPTH ③	SEALANT THICKNESS ④	BACKER ROD DIAMETER ⑤
3/8"	1 1/4"	3/8"	3/16"	1/2"
1/2"	1 3/4"	3/8"	1/4"	5/8"
3/4"	1 3/4"	3/8"	3/8"	7/8"
7/8"	1 3/4"	1/2"	7/16"	1"
1"	2"	1/2"	1/2"	1 1/8"
OVER 1"	OVER 2"	1/2"	1/2"	1 1/4"

GENERAL NOTES

- ALL CONSTRUCTION AND MATERIALS REQUIREMENTS SHALL BE IN ACCORDANCE WITH THE 2019 ODOT STANDARD SPECIFICATIONS.
- ALL CONCRETE JOINT SEALING SHALL BE IN ACCORDANCE WITH SECTION 415 OF THE SPECIFICATIONS.
- THE SHAPE FACTOR, COMBINED WITH THE JOINT CLEANLINESS, IS THE CRITICAL COMBINATION NECESSARY TO GUARANTEE DESIRED BONDING AND FUNCTION OF SEALED JOINTS. THE JOINT SHAPE FACTOR IS DEFINED AS THE FINAL PRESSED SHAPE OF THE SILICONE MATERIAL. THE TOOLING OPERATION WILL FIRMLY PRESS THE FRESHLY APPLIED MATERIAL INTIMATELY AGAINST THE CUT SIDES OF THE RECESS AND THE BACKER ROD SURFACES. THE ROUNDED SHAPE ON TOP AND BOTTOM OF THE SILICONE ALLOWS THE SEALANT TO PROPERLY FLEX BUT MAINTAIN ADHERENCE TO THE PAVING. SELF LEVELING SEALANTS WILL BE INSTALLED TO BE FLUSH WITH THE PAVEMENT SURFACE.
- ON JOINTED PORTLAND CEMENT CONCRETE PAVEMENTS, DOWELED CONTRACTION JOINTS SHALL BE USED ON DRIVING LANES ONLY. CONCRETE SHOULDERS SHALL NOT BE DOWELED UNLESS SPECIFIED ON THE PLANS.
- LONGITUDINAL JOINTS BETWEEN PAVEMENT AND TIED CONCRETE SHOULDERS SHALL NOT BE SAWED OR SEALED UNLESS OTHERWISE SHOWN ON THE PLANS.
- ON ALL SAWED JOINTS, THE KERF DEPTH SHALL CLEAR DOWEL BARS, TIE BARS AND/OR REINFORCING STEEL BY A MINIMUM OF 1/2".
- CONTRACTION JOINTS IN JOINTED P. C. PAVEMENT SHALL BE AT APPROXIMATELY 15'-0" CENTERS, UNLESS OTHERWISE SPECIFIED ON THE PLANS.
- LONGITUDINALLY TIME THE PAVEMENT UNLESS OTHERWISE SPECIFIED, OR AS DIRECTED BY THE ENGINEER. CONSTRUCT LONGITUDINAL GROOVING TO THE FOLLOWING DIMENSIONS: 1/8" TO 3/16" WIDE, 1/8" TO 3/16" DEEP, AND EQUALLY SPACED AT 1/2" TO 1" APART. ENSURE GROOVES ARE NEAT IN APPEARANCE AND OF UNIFORM DEPTH. ALTERNATIVELY, IF TRANSVERSE GROOVING IS APPROVED BY THE RESIDENT ENGINEER, CONSTRUCT TRANSVERSE GROOVING TO THE FOLLOWING DIMENSIONS: 1/8" TO 3/16" WIDE, 1/8" TO 3/16" DEEP, AND EQUALLY SPACED AT 1/2" TO 1" APART.
- CONCRETE PAVEMENTS (SUCH AS DETOURS AND CROSSOVERS) THAT ARE INTENDED TO BE REMOVED BY THE END OF THE PROJECT SHALL NOT BE SEALED.

APPROVED BY ROADWAY ENGINEER DATE: 6/30/22

ROADWAY DESIGN DIVISION STANDARD

JOINTS AND SEALERS - LONGITUDINAL, EXPANSION / ISOLATION, & CONTRACTION



2019 SPECIFICATIONS