

PLAN VIEW
"BELOW GRADE" TYPE

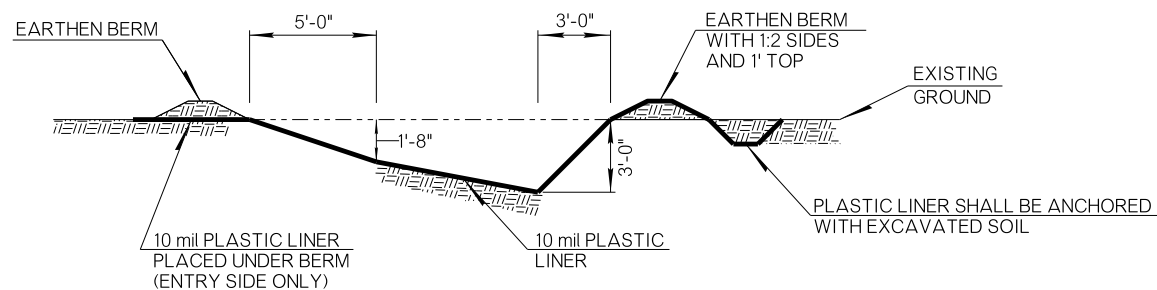

SECTION B-B

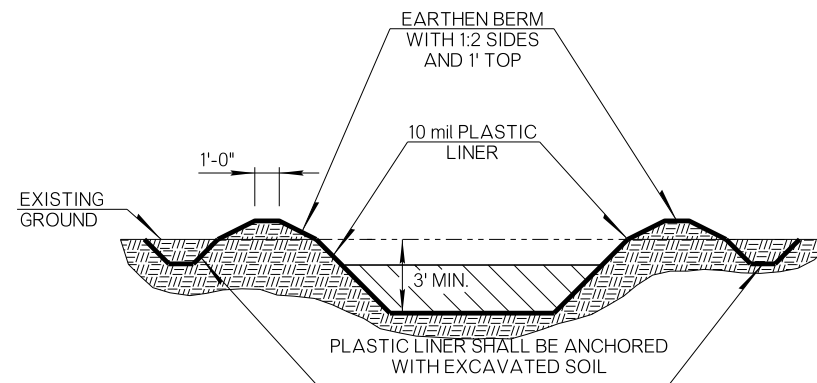

SECTION A-A

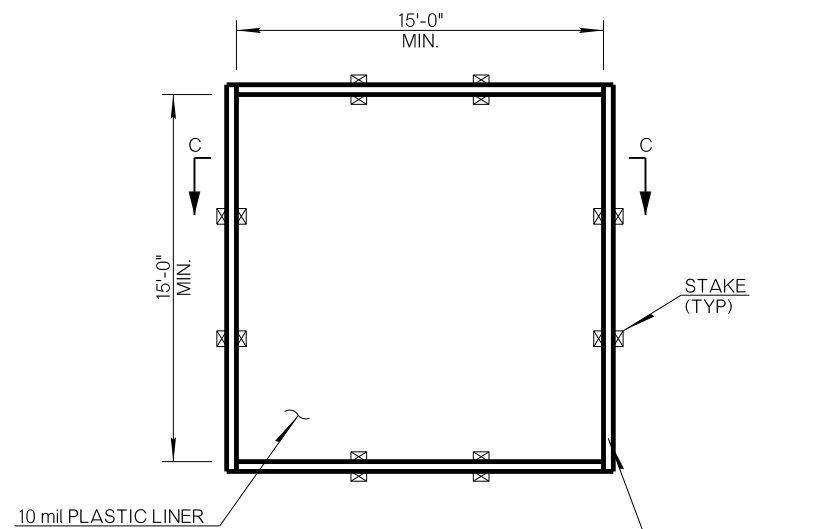

PLAN VIEW
"ABOVE GRADE" TYPE

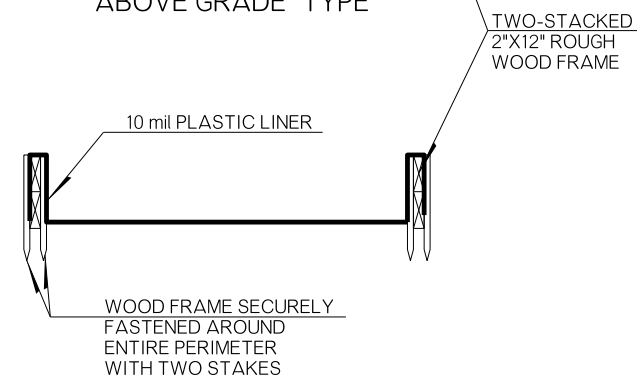

SECTION C-C

GENERAL NOTES

1. ALL CONSTRUCTION AND MATERIAL REQUIREMENTS SHALL BE IN ACCORDANCE WITH SECTION 220.04.H(2) OF THE 2019 ODOT STANDARD SPECIFICATIONS.
2. TEMPORARY CONCRETE WASHOUT DEVICES SHOULD BE CONSTRUCTED ABOVE GRADE OR BELOW GRADE AT THE OPTION OF THE CONTRACTOR. WASHOUT DEVICE SHOULD BE CONSTRUCTED AND MAINTAINED IN SUFFICIENT QUANTITY AND SIZE TO CONTAIN ALL LIQUID AND CONCRETE WASTE GENERATED BY WASHOUT OPERATIONS.
3. PROVIDE A WASHOUT AREA A MINIMUM OF 50 FEET AWAY FROM INLETS, SWALES, DRAINAGE WAYS AND CHANNELS, IF THE SITE CONFIGURATION PROVIDES SUFFICIENT SPACE TO DO SO. IN NO CASE SHALL THE CONCRETE WASHOUT DEVICE BE INSTALLED CLOSER THAN 20 FEET FROM INLETS, SWALES, DRAINAGE WAYS AND CHANNELS.
4. PLASTIC LINER SHALL CONFORM TO ASTM D-4397, BE A MINIMUM OF 10 MIL (0.10 INCHES) THICK, AND FREE OF ALL TEARS AND HOLES AND BE IMPERMEABLE.
5. SIGNS SHALL BE PLACED AT THE CONSTRUCTION ENTRANCE, AT THE LOCATION OF THE CONCRETE WASHOUT DEVICE, AND ELSEWHERE AS NECESSARY TO CLEARLY INDICATE THE LOCATION OF THE FACILITY TO OPERATORS OF CONCRETE TRUCKS AND PUMP RIGS.
6. USE EXCAVATED MATERIAL FOR PERIMETER BERM CONSTRUCTION.
7. THE CONCRETE WASHOUT DEVICE SHALL BE INSTALLED PRIOR TO CONCRETE PLACEMENT ON SITE, AND SHOULD REMAIN IN PLACE UNTIL ALL CONCRETE FOR THE PROJECT IS PLACED.
8. CONCRETE MATERIALS, ACCUMULATED IN PIT, SHALL BE REMOVED, ALONG WITH THE PLASTIC LINER, ONCE THE PIT HAS REACHED 50% CAPACITY, USING SUITABLE WATER TIGHT CONTAINERS AND DISPOSED OF IN ACCORDANCE WITH LOCAL, STATE AND FEDERAL REGULATIONS OR IN A MANNER APPROVED BY THE RESIDENT ENGINEER.
9. ALL MATERIALS, LABOR AND SIGNS NEEDED TO CONSTRUCT AND MAINTAIN THE CONCRETE WASHOUT DEVICE SHALL BE INCLUDED IN OTHER ITEMS OF WORK.
10. ALTERNATE DESIGNS OF THE CONCRETE WASHOUT DEVICE MAY BE USED IF APPROVED BY THE ENGINEER.

APPROVED BY ROADWAY ENGINEER: *R. G. W. S.* DATE: 6/29/22
ROADWAY DESIGN DIVISION STANDARD

CONCRETE WASHOUT APPLICATIONS



2019 SPECIFICATIONS

CWA	0
	R-13