

R 5 E

Copies of this map are available for public use at nominal cost.  
Address:  
OKLAHOMA DEPARTMENT OF TRANSPORTATION  
REPRODUCTION BRANCH (Phone - 521-2586)  
200 N. E. 21st STREET  
OKLAHOMA CITY, OKLA. 73105

N 15 T N 41 T

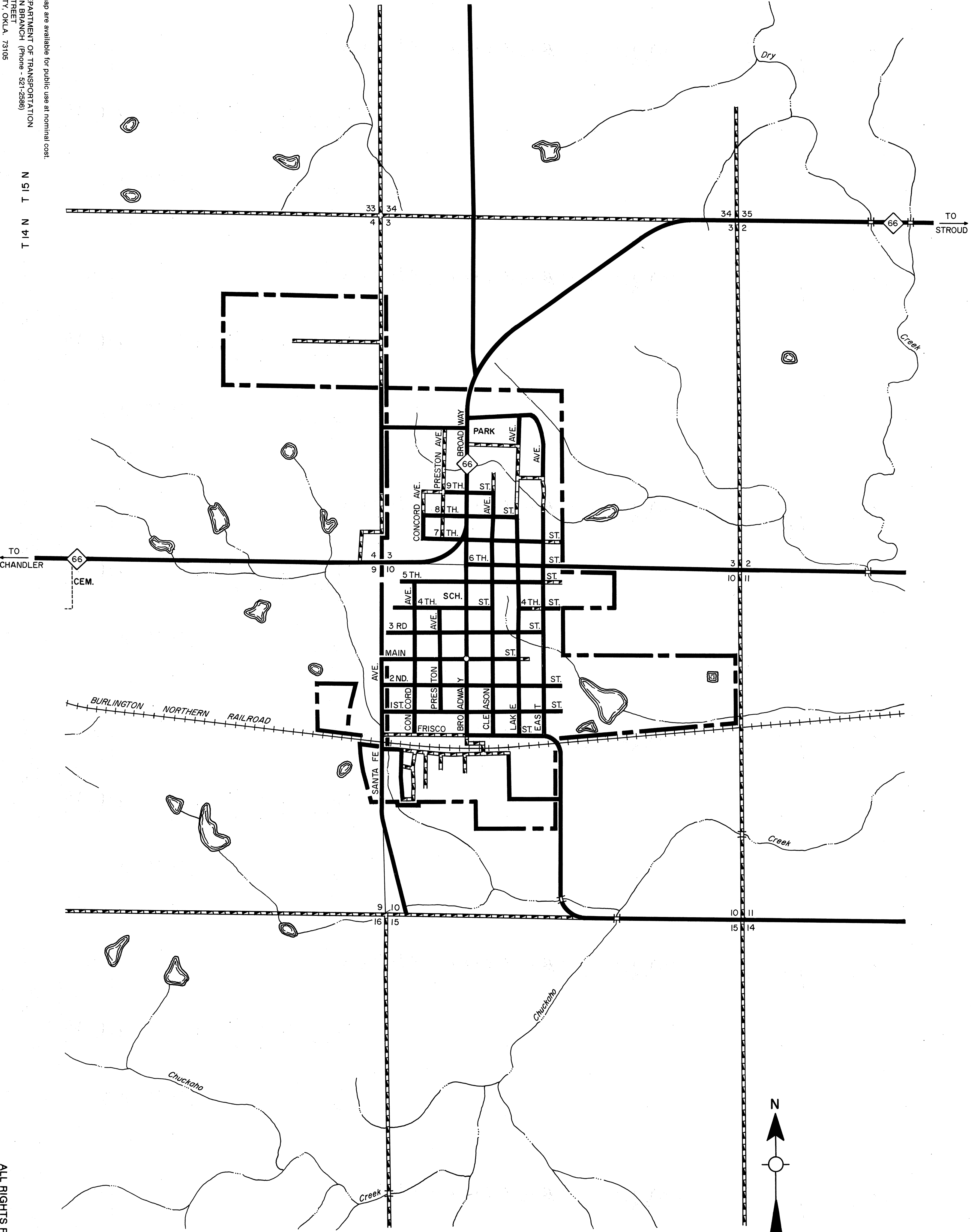

STATE OF OKLAHOMA  
DEPARTMENT OF TRANSPORTATION  
CITY OF  
**DAVENPORT**  
LINCOLN COUNTY  
1990  
POPULATION  
979

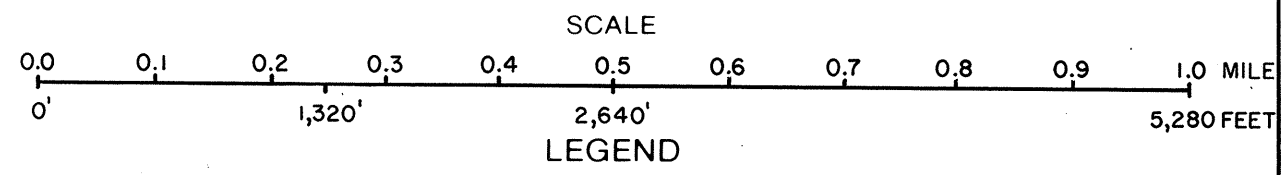

LEGEND

MILEAGE	
PAVED	9.1
GRAVEL	2.6
GRADED & DRAINED	0.1
UNIMPROVED	0.0
TOTAL STREETS & HIGHWAYS	11.8
CORPORATE LIMITS	9.1
STATE NUMBERED ROUTES	2.6
U.S. NUMBERED ROUTES	0.1
INTERSTATE ROUTES	0.0
STREETS	11.1
HIGHWAYS	0.7

ALL RIGHTS RESERVED

DAVENPORT, LINCOLN CO. MARCH 1990