

Copies of this map are available for public use at nominal cost.  
 OKLAHOMA DEPARTMENT OF TRANSPORTATION  
 PRINTING SERVICES Phone (405) 521-2596  
 200 N.E. 21st STREET  
 OKLAHOMA CITY, OKLAHOMA 73105-3204

This map indicates those roads known to the Department to be open to public travel. Placement of a road on the map has no relationship to maintenance responsibility by any level of government.

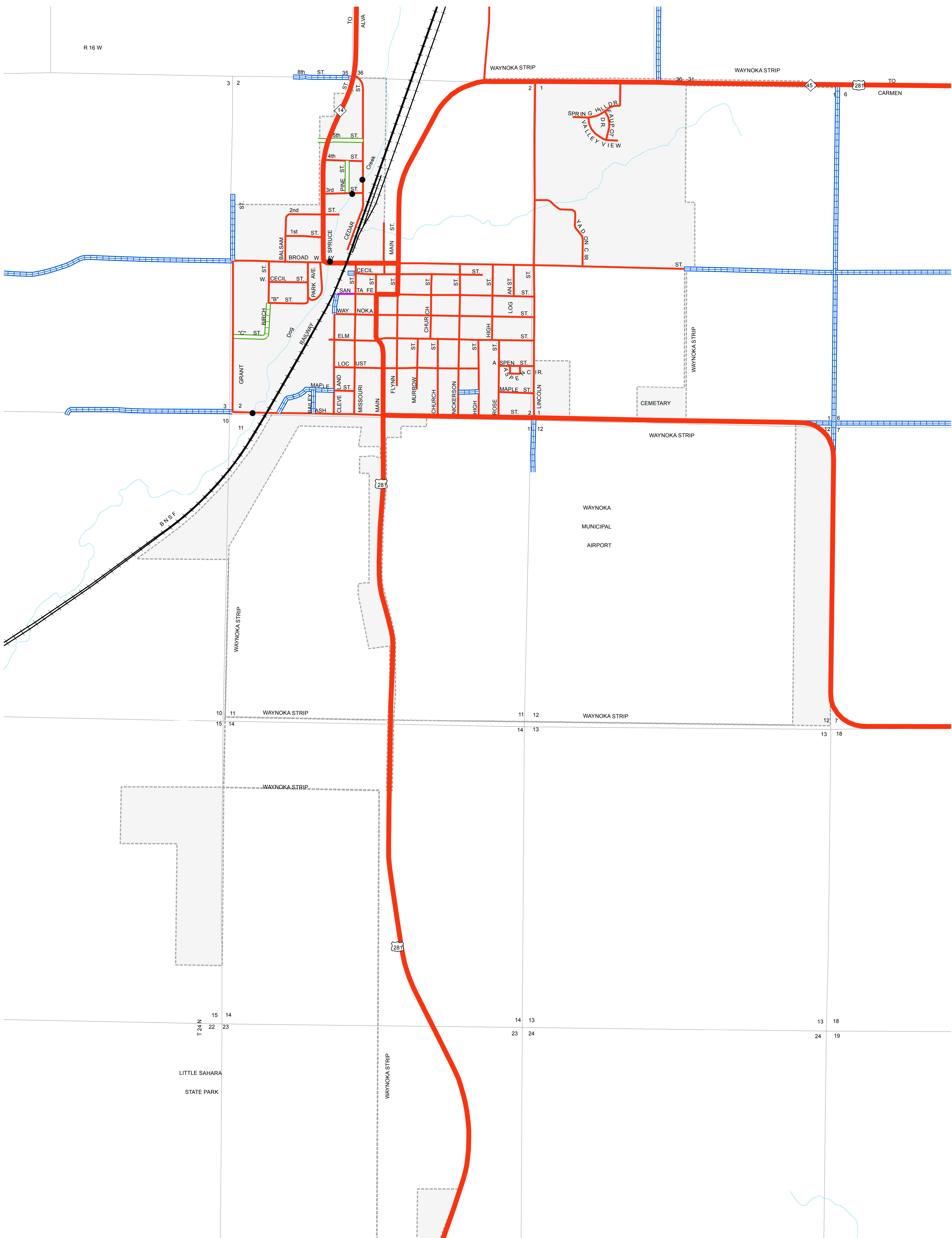

**STATE OF OKLAHOMA**  
**DEPARTMENT OF TRANSPORTATION**

CITY OF  
**WAYNOKA**  
 WOODS COUNTY

CENSUS YEAR 2010  
 POPULATION 927

**Legend**

- Interstate
- US Highway
- State Highway
- Divided Highway, 4 or more lanes
- Asphalt
- Concrete
- Gravel
- Grade & Drain
- Unimproved
- Railroad
- Corporate Limit
- WAYNOKA County Line
- Section Line
- Wildlife Management Area
- Wildlife Refuge
- River or Stream
- Lake or Reservoir
- Bridges
- Low Water Crossing

N

0 0.15 0.3 0.45 Miles  
 0 800 1,600 2,400 Feet

0 0.25 0.5 0.75 1 Kilometers

