

Copies of this map are available for public use at nominal cost.  
 Address:  
 OKLAHOMA DEPARTMENT OF TRANSPORTATION  
 PRINTING SERVICES (Phone - 521-2586)  
 200 N.E. 21st STREET  
 OKLAHOMA CITY, OKLA. 73105

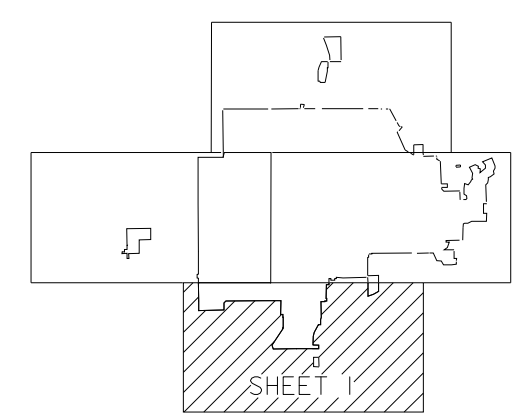

STATE OF OKLAHOMA  
 DEPARTMENT OF TRANSPORTATION  
 CITY OF  
**PONCA CITY**  
 KAY COUNTY  
 CENSUS YEAR 2010  
 POPULATION 25,387  
 SCALE IN MILES

0 1/4 1/2 1 MILE  
 0 1,320 2,640 5,280 FEET

0 200 400 0.5 KILOMETERS

SCALE IN METERS

LEGEND

- CORPORATE LIMITS ————
- STATE NUMBERED ROUTES
- U.S. NUMBERED ROUTES
- INTERSTATE ROUTES

N



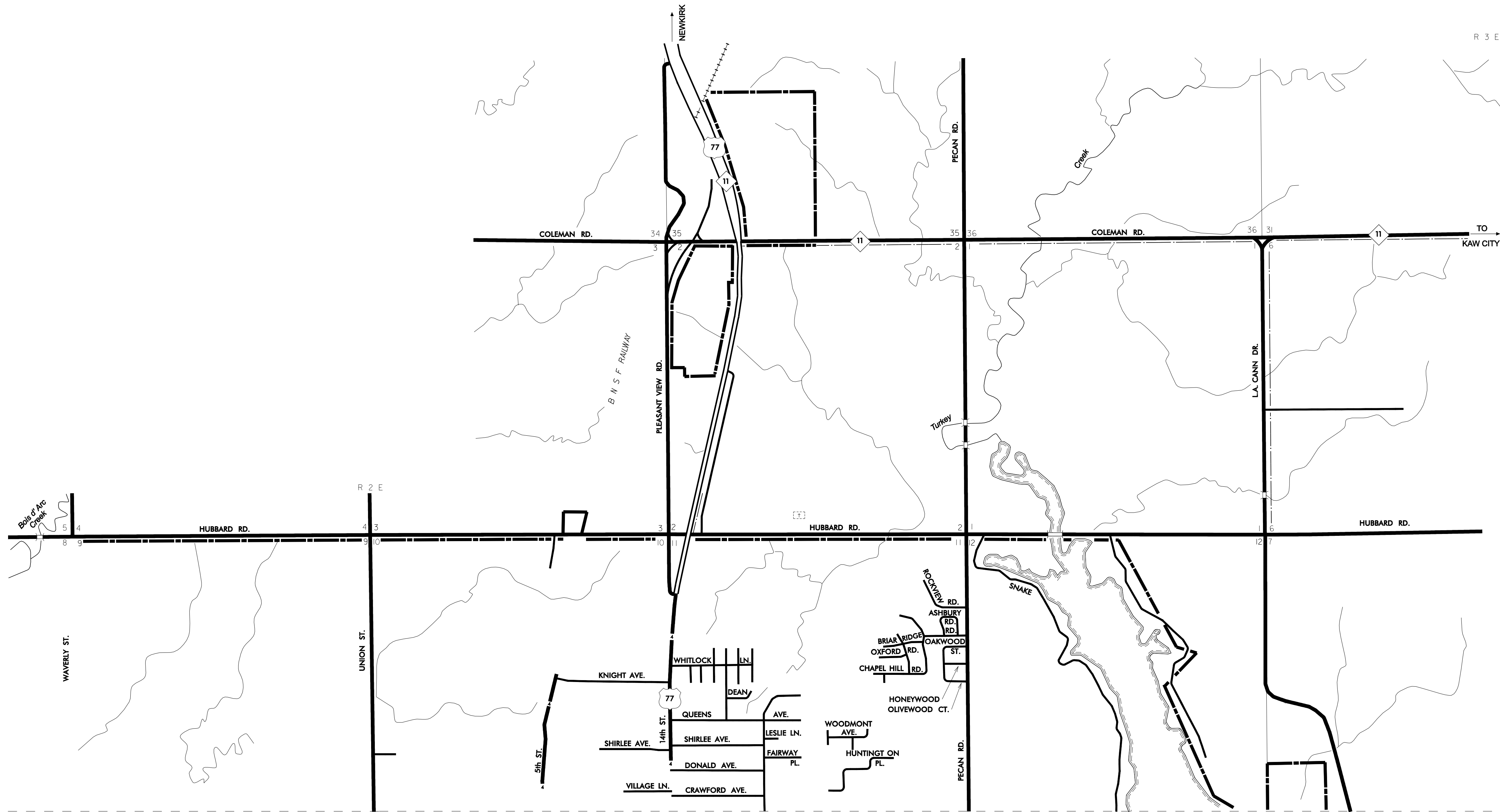

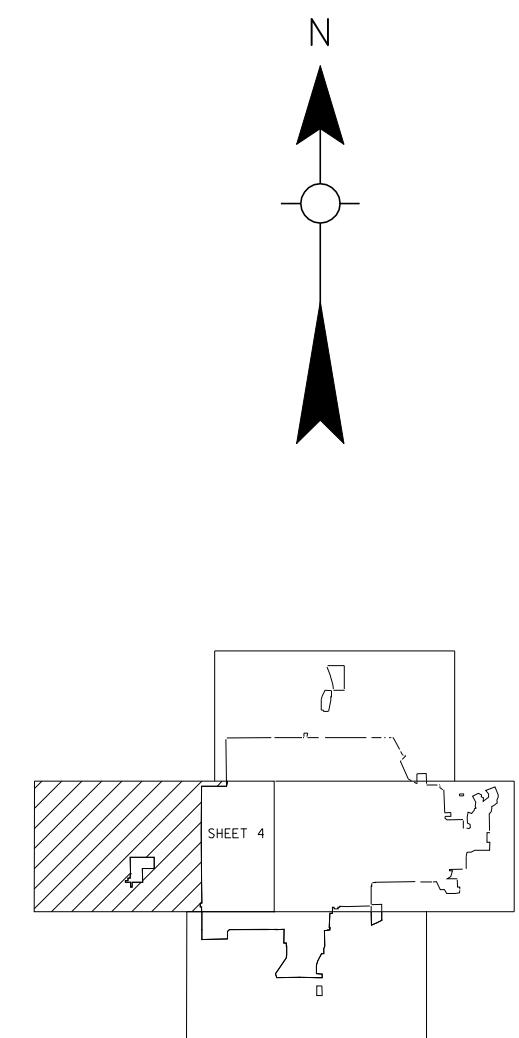
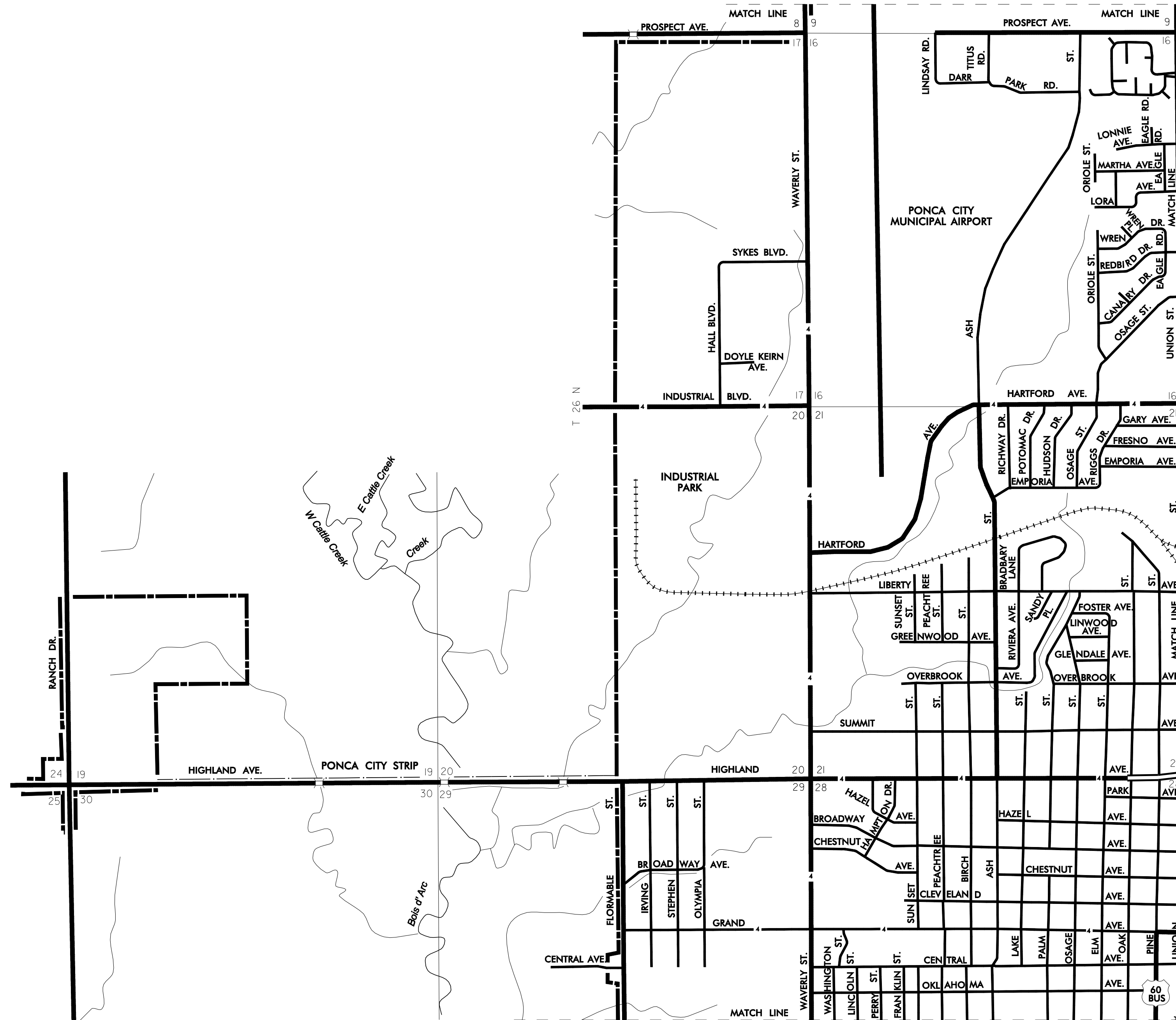

Copies of this map are available for public use at nominal cost.  
 Address:  
 OKLAHOMA DEPARTMENT OF TRANSPORTATION  
 PRINTING SERVICES (Phone - 521-2586)  
 200 N.E. 21st STREET  
 OKLAHOMA CITY, OKLA. 73105

ALL RIGHTS RESERVED

COMPUTER GENERATED

JULY 2011

PONCA CITY, SHEET 4, KAY COUNTY