

Legend

	Interstate		Asphalt		Corporate Limit		River or Stream
	US Highway		Concrete		ARDMORE		Lake or Reservoir
	State Highway		Gravel		County Line		Bridges
	Highways		Grade & Drain		Section Line		Low Water Crossing
	Local Roads		Unimproved		Wildlife Management Area		
	Railroad		Wildlife Refuge				

Copies of this map are available for public use at nominal cost.
 Address:
 OKLAHOMA DEPARTMENT OF TRANSPORTATION
 PRINTING SERVICES Phone (405) 521-2586
 200 N.E. 21st STREET
 OKLAHOMA CITY, OKLAHOMA 73105-3204

This map indicates those roads known to the Department to be open to public travel. Placement of a road on the map has no relationship to maintenance responsibility by any level of government.

© COPYRIGHT 2018
 PRINTED AT STATE EXPENSE

NOT FOR RESALE

**STATE OF OKLAHOMA
 DEPARTMENT OF TRANSPORTATION**

**CITY OF
 ARDMORE
 CARTER COUNTY**

CENSUS YEAR 2010
 POPULATION 24,283

ALL RIGHTS RESERVED COMPUTER GENERATED September, 2018

ARDMORE, CARTER COUNTY

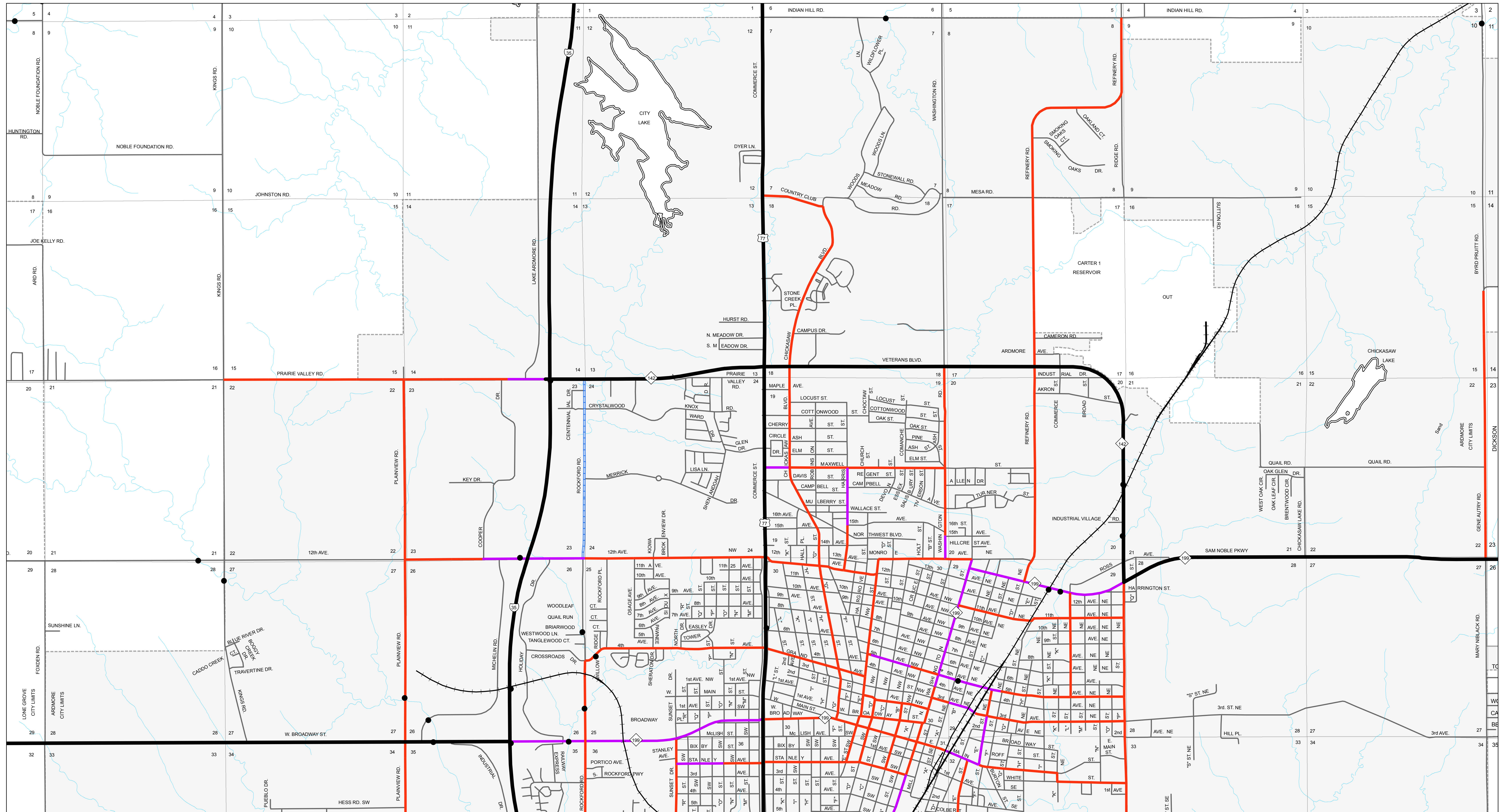

Legend

- Interstate
- US Highway
- State Highway
- Highways
- Local Roads
- Railroad
- Asphalt
- Concrete
- Gravel
- Grade & Drain
- Unimproved
- Corporate Limit
- ARDMORE
- County Line
- Section Line
- Wildlife Management Area
- Wildlife Refuge
- River or Stream
- Lake or Reservoir
- Bridges
- Low Water Crossing

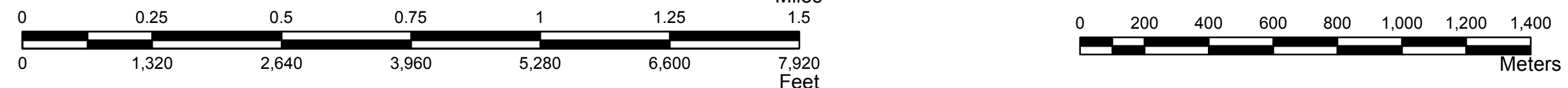
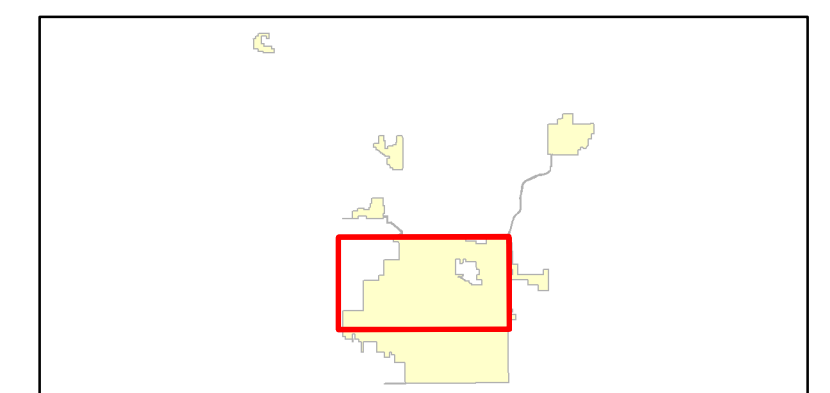
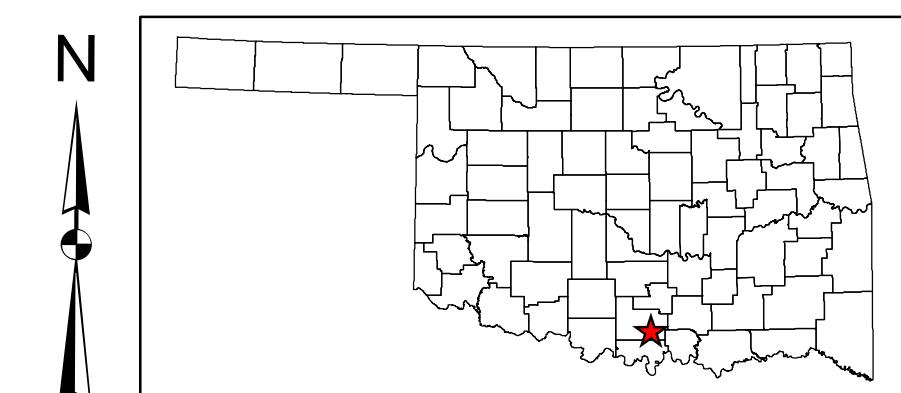

Copies of this map are available for public use at nominal cost.
 Address:
 OKLAHOMA DEPARTMENT OF TRANSPORTATION
 PRINTING SERVICES Phone (405) 521-2586
 200 N.E. 21st STREET
 OKLAHOMA CITY, OKLAHOMA 73105-3204

This map indicates those roads known to the Department to be open to public travel. Placement of a road on the map has no relationship to maintenance responsibility by any level of government.

**STATE OF OKLAHOMA
 DEPARTMENT OF TRANSPORTATION**

CITY OF
ARDMORE
 CARTER COUNTY

CENSUS YEAR 2010
 POPULATION 24,283

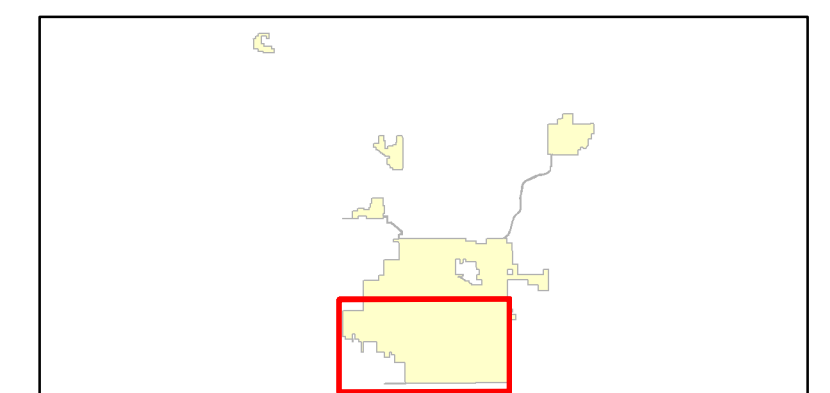
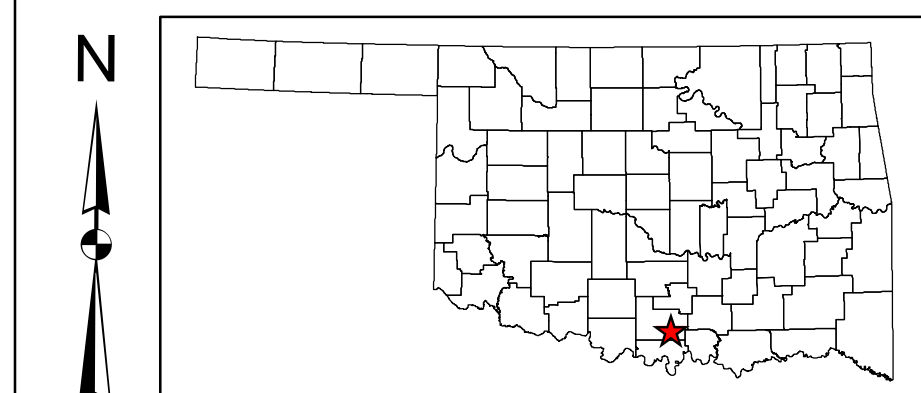
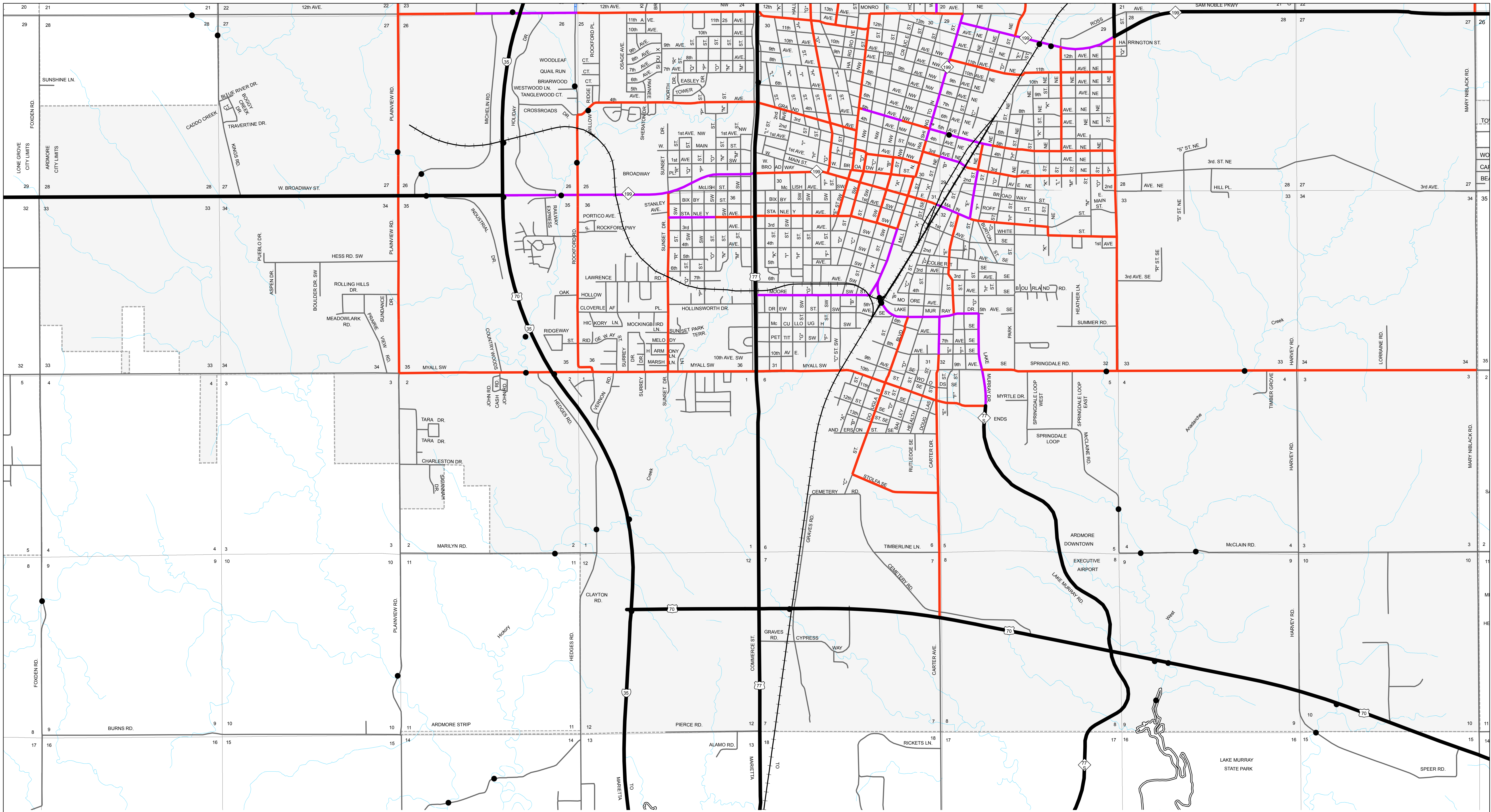

- Legend**
- Interstate
 - US Highway
 - State Highway
 - Highways
 - Local Roads
 - Railroad
 - Asphalt
 - Concrete
 - Gravel
 - Grade & Drain
 - Unimproved
 - Corporate Limit
 - ARDMORE
 - County Line
 - Section Line
 - Wildlife Management Area
 - Wildlife Refuge
 - River or Stream
 - Lake or Reservoir
 - Bridges
 - Low Water Crossing

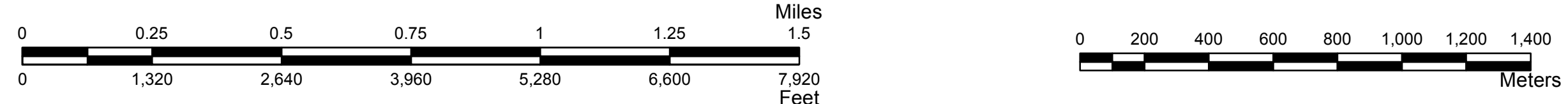

Copies of this map are available for public use at nominal cost.
 Address:
 OKLAHOMA DEPARTMENT OF TRANSPORTATION
 PRINTING SERVICES Phone (405) 521-2586
 200 N.E. 21st STREET
 OKLAHOMA CITY, OKLAHOMA 73105-3204

This map indicates those roads known to the Department to be open to public travel. Placement of a road on the map has no relationship to maintenance responsibility by any level of government.

© COPYRIGHT 2018
 PRINTED AT STATE EXPENSE
NOT FOR RESALE

STATE OF OKLAHOMA
DEPARTMENT OF TRANSPORTATION

CITY OF
ARDMORE
 CARTER COUNTY

CENSUS YEAR 2010
 POPULATION 24,283

ALL RIGHTS RESERVED COMPUTER GENERATED September, 2018