

This map indicates those roads known to the Department to be open to public travel. Placement of a road on the map has no relationship to maintenance responsibility by any level of government.

© COPYRIGHT 2018  
 PRINTED ON STATE EXPENSE

NOT FOR RESALE

ALL RIGHTS RESERVED  
 GENERAL HIGHWAY MAP

WOODS COUNTY

OKLAHOMA

COMPUTER GENERATED  
 76

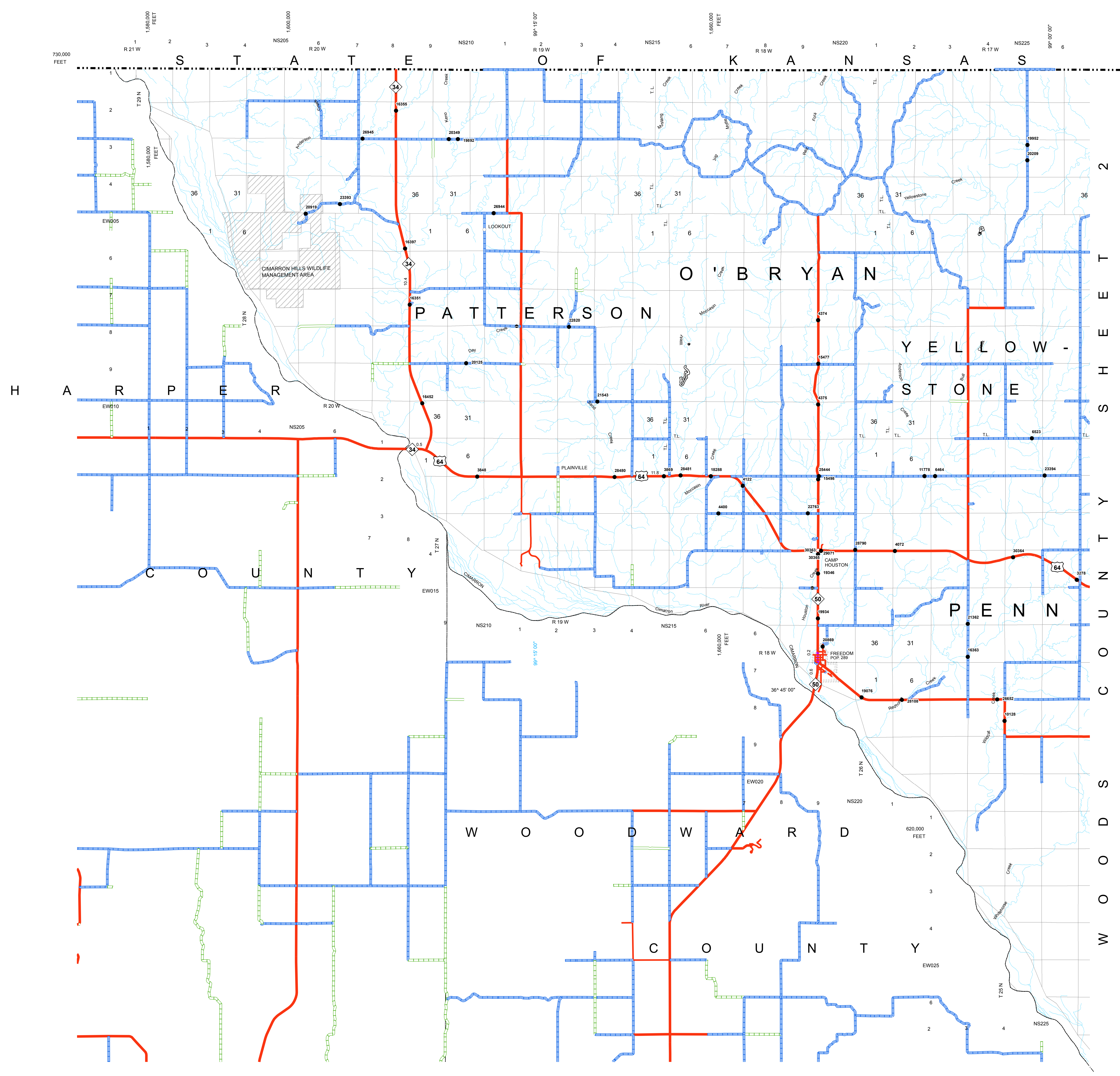

**Legend**

- |                              |                            |                                 |
|------------------------------|----------------------------|---------------------------------|
| ◇ State Highway              | ▬ State Line               | • Bridges                       |
| □ US Highway                 | ▬ County Line              | • Low Water Crossing            |
| ▬ Divided Highway - Asphalt  | ▬ Section Line             | ☼ Natural Elevation Point       |
| ▬ Divided Highway - Concrete | ▬ Corporate Limit          | ◊ Natural Elevation Point; MESA |
| ▬ Asphalt                    | ▨ Wildlife Management Area |                                 |
| ▬ Concrete                   | ▨ Wildlife Refuge          |                                 |
| ▬ Gravel                     | ▬ River or Stream          |                                 |
| ▬ Grade & Drain              | ▭ Lake or Reservoir        |                                 |
| ▬ Unimproved                 |                            |                                 |
| ▬ Railroad                   |                            |                                 |

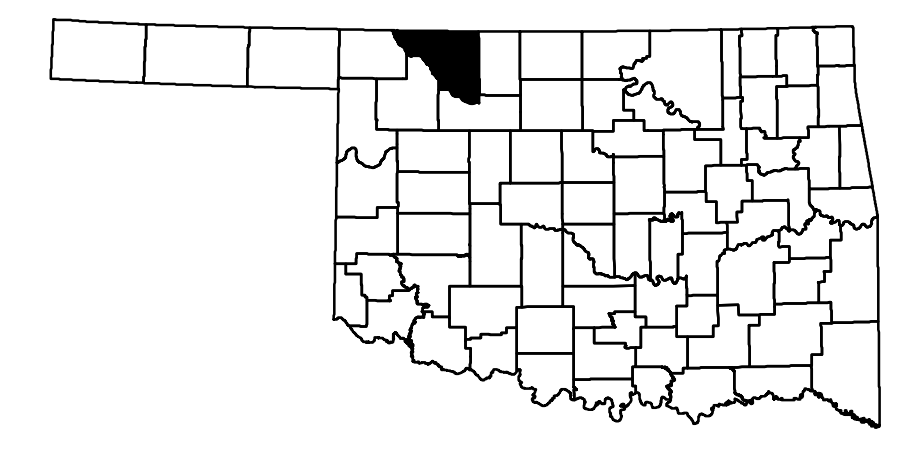
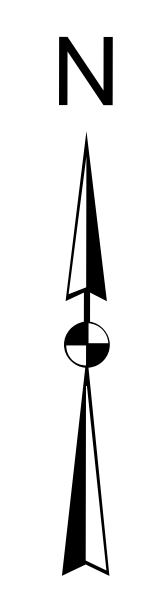

ALL DATA CURRENT AS OF DATE LISTED BELOW  
 October 2, 2018

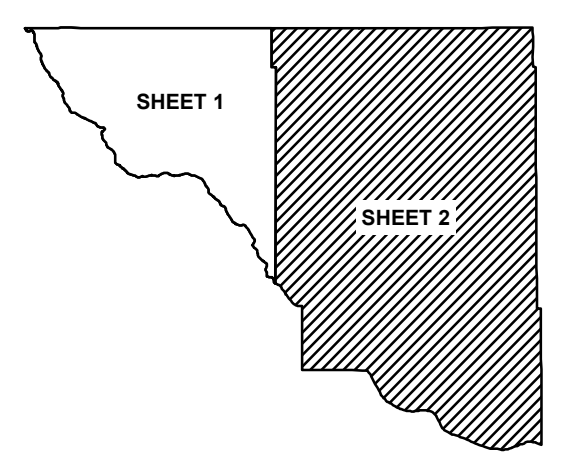

**GENERAL HIGHWAY MAP  
 WOODS COUNTY  
 OKLAHOMA**

PREPARED BY THE  
 OKLAHOMA DEPARTMENT OF TRANSPORTATION  
 STRATEGIC ASSET AND PERFORMANCE  
 MANAGEMENT DIVISION  
 IN COOPERATION WITH THE  
 U.S. DEPARTMENT OF TRANSPORTATION  
 FEDERAL HIGHWAY ADMINISTRATION

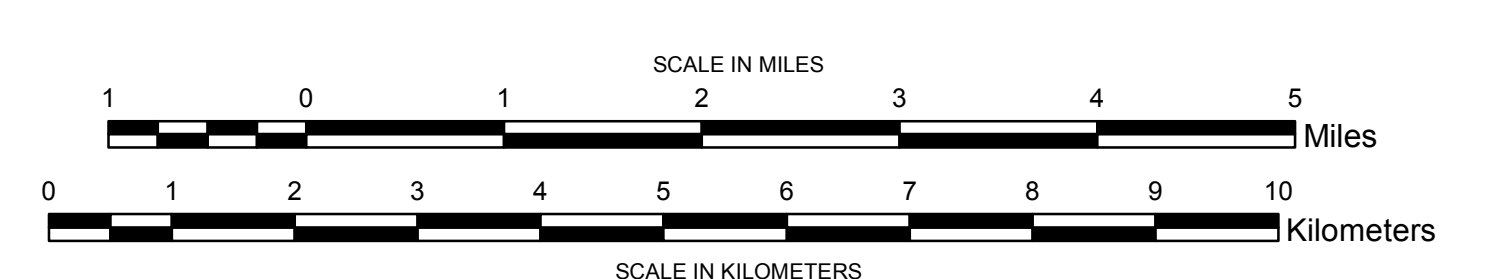

LAMBERT CONFORMAL CONIC PROJECTION U.S. & GEODETIC SURVEY DATA  
 20,000 FOOT GRID; OKLAHOMA PLANE COORDINATE SYSTEM NORTH PROJECTION ZONE  
 POPULATION FIGURES BASED ON 2010 U.S. CENSUS  
 CD POP 8.678

Copies of this map are available for public use at a nominal cost.  
 Address: OKLAHOMA DEPARTMENT OF TRANSPORTATION  
 PRINTING SERVICES Phone (405) 521-2288  
 200 N. E. 24th STREET  
 OKLAHOMA CITY, OKLAHOMA 73105-3204

This map indicates those roads known to the Department to be open to public travel. Placement of a road on the map has no relationship to maintenance responsibility by any level of government.

© COPYRIGHT 2018  
 PRINTED ON SUSTAINABLE PAPER

**NOT FOR RESALE**

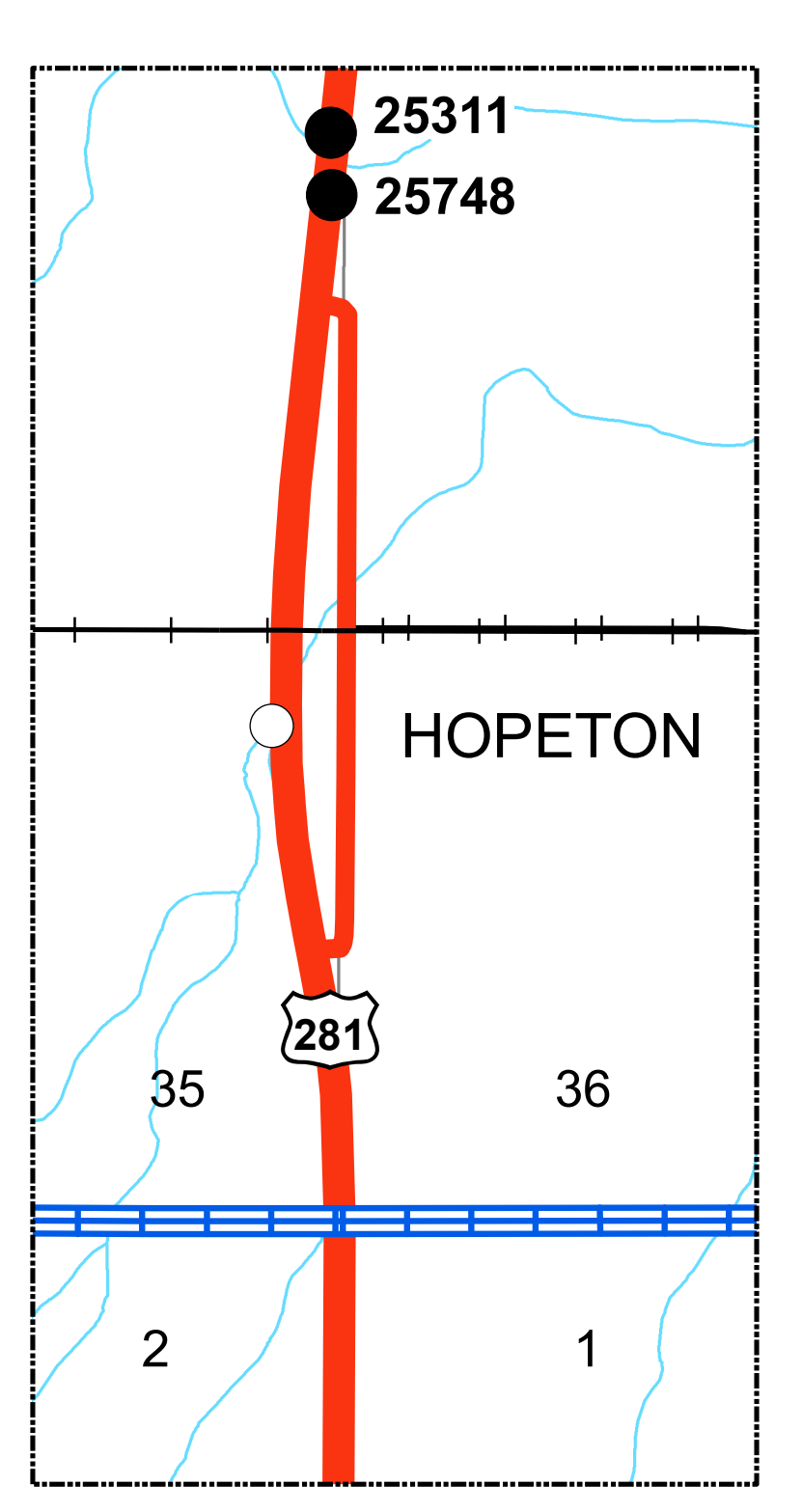
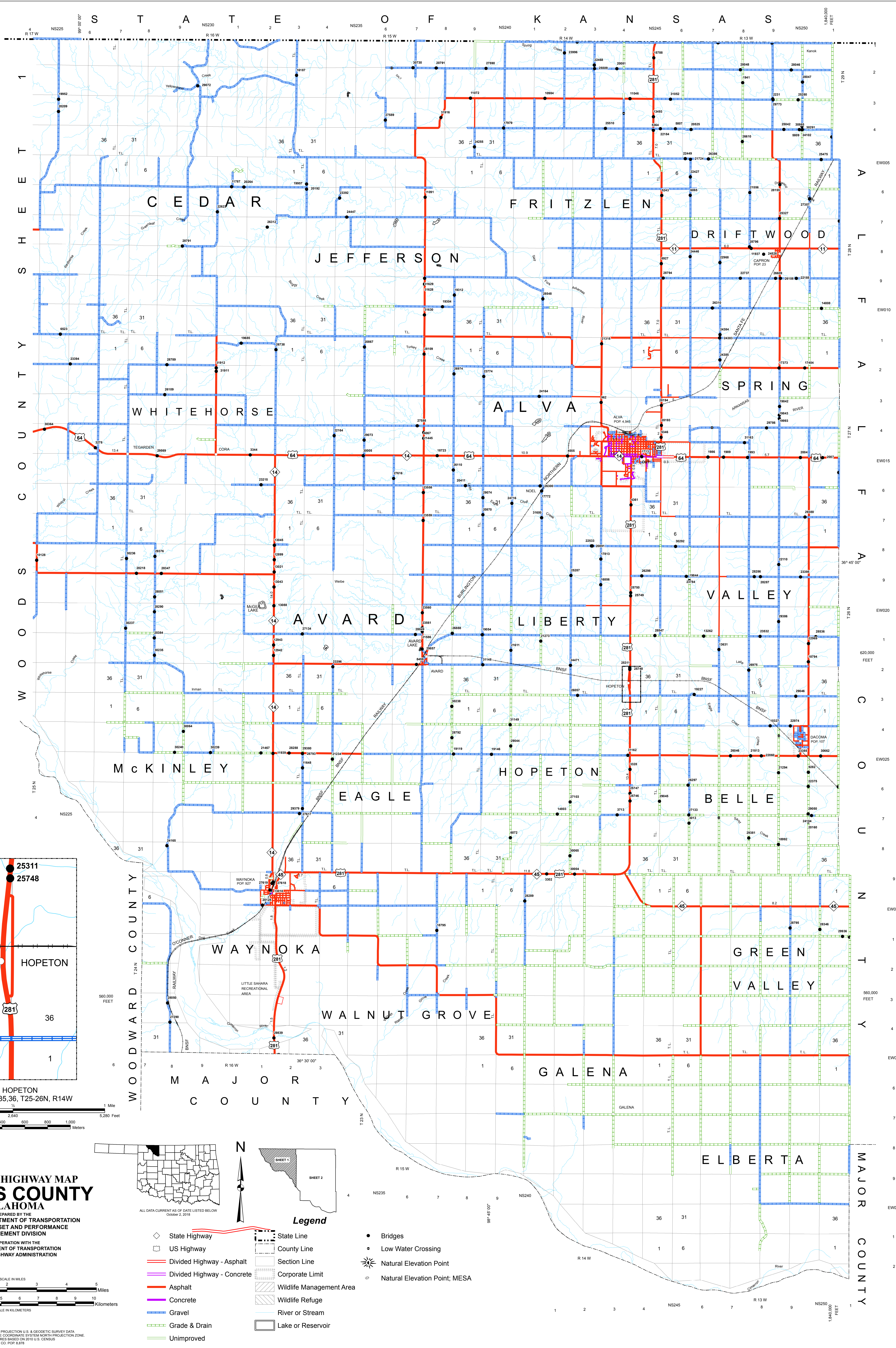

HOPETON  
 SEC. 1, 2, 35, 36, T25-26N, R14W

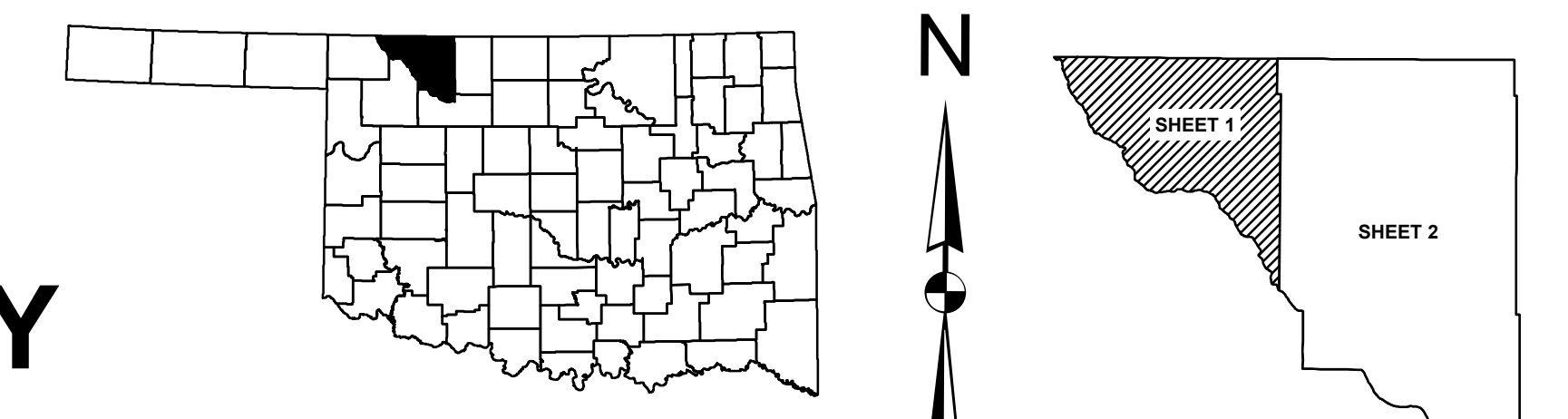
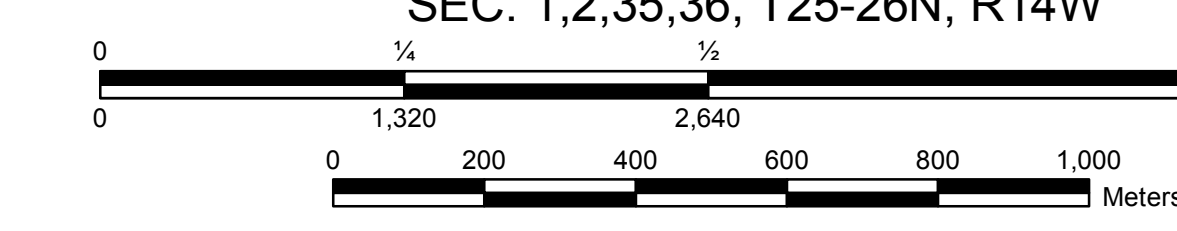

**GENERAL HIGHWAY MAP  
 WOODS COUNTY  
 OKLAHOMA**  
 PREPARED BY THE  
 OKLAHOMA DEPARTMENT OF TRANSPORTATION  
 STRATEGIC ASSET AND PERFORMANCE  
 MANAGEMENT DIVISION  
 IN COOPERATION WITH THE  
 U.S. DEPARTMENT OF TRANSPORTATION  
 FEDERAL HIGHWAY ADMINISTRATION

ALL RIGHTS RESERVED  
 GENERAL HIGHWAY MAP  
 WOODS COUNTY  
 OKLAHOMA  
 COMPUTER GENERATED