

Copies of this map are available for public use at nominal cost.  
 Address: OKLAHOMA DEPARTMENT OF TRANSPORTATION  
 PRINTING SERVICES Phone (405) 521-2456  
 200 N. E. 24th STREET  
 OKLAHOMA CITY, OKLAHOMA 73105-3204

This map indicates those roads known to the Department to be open to public travel. Placement of a road on the map has no relationship to maintenance responsibility by any level of government.

© COPYRIGHT 2018  
 PRINTED ON SINGLE PAPER

NOT FOR RESALE

ALL RIGHTS RESERVED

GENERAL HIGHWAY MAP  
 SEMINOLE COUNTY

OKLAHOMA  
 COMPUTER GENERATED

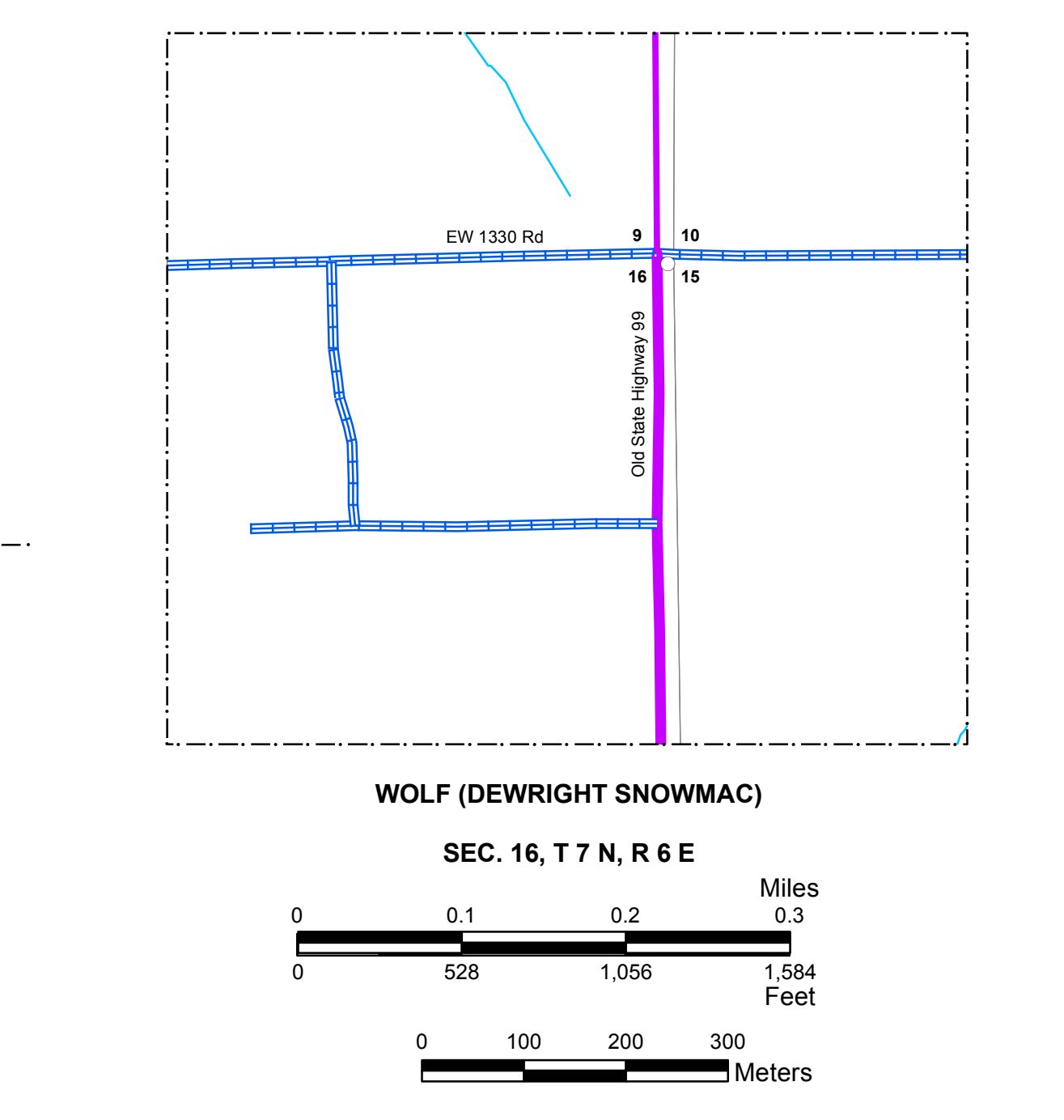
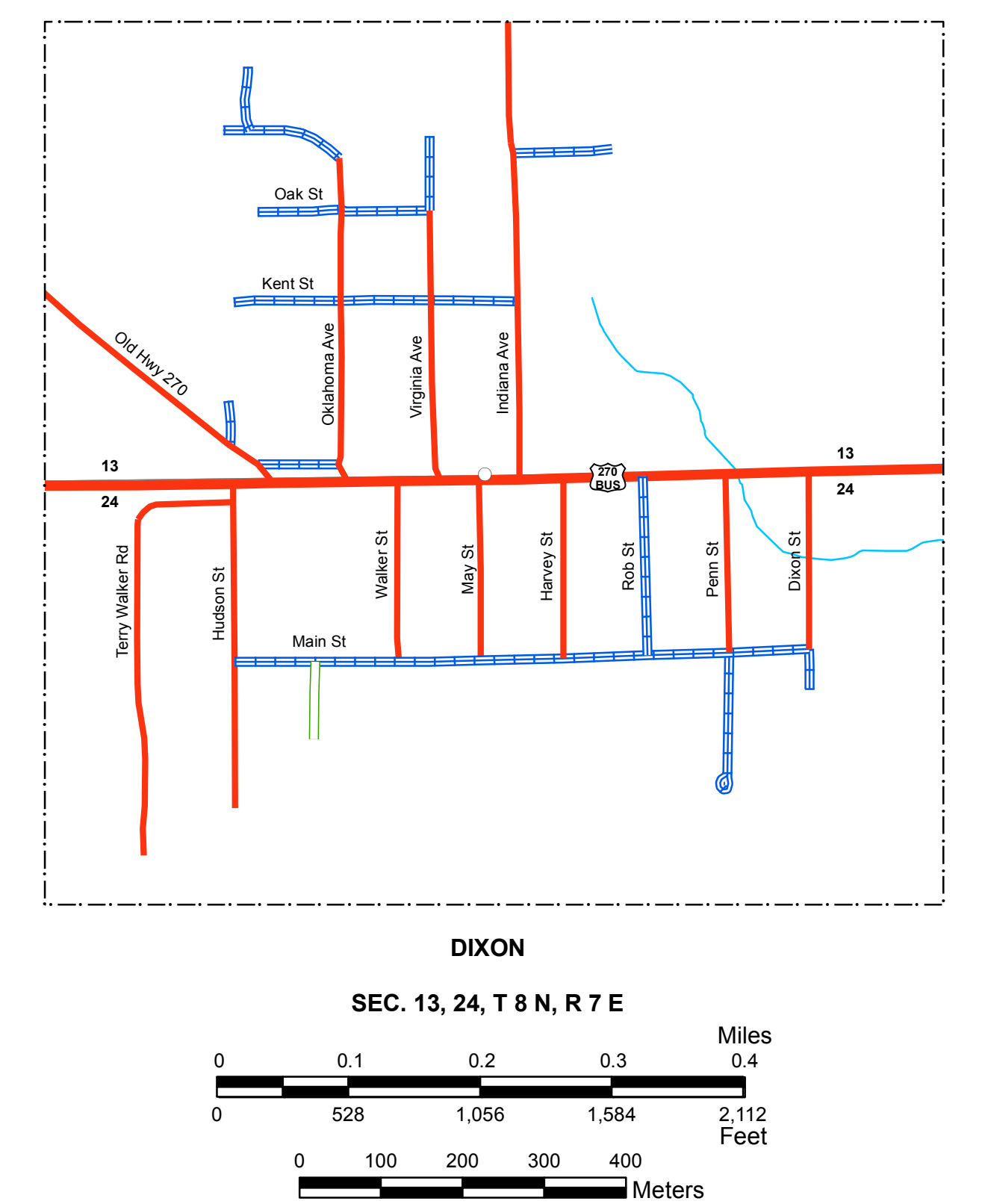
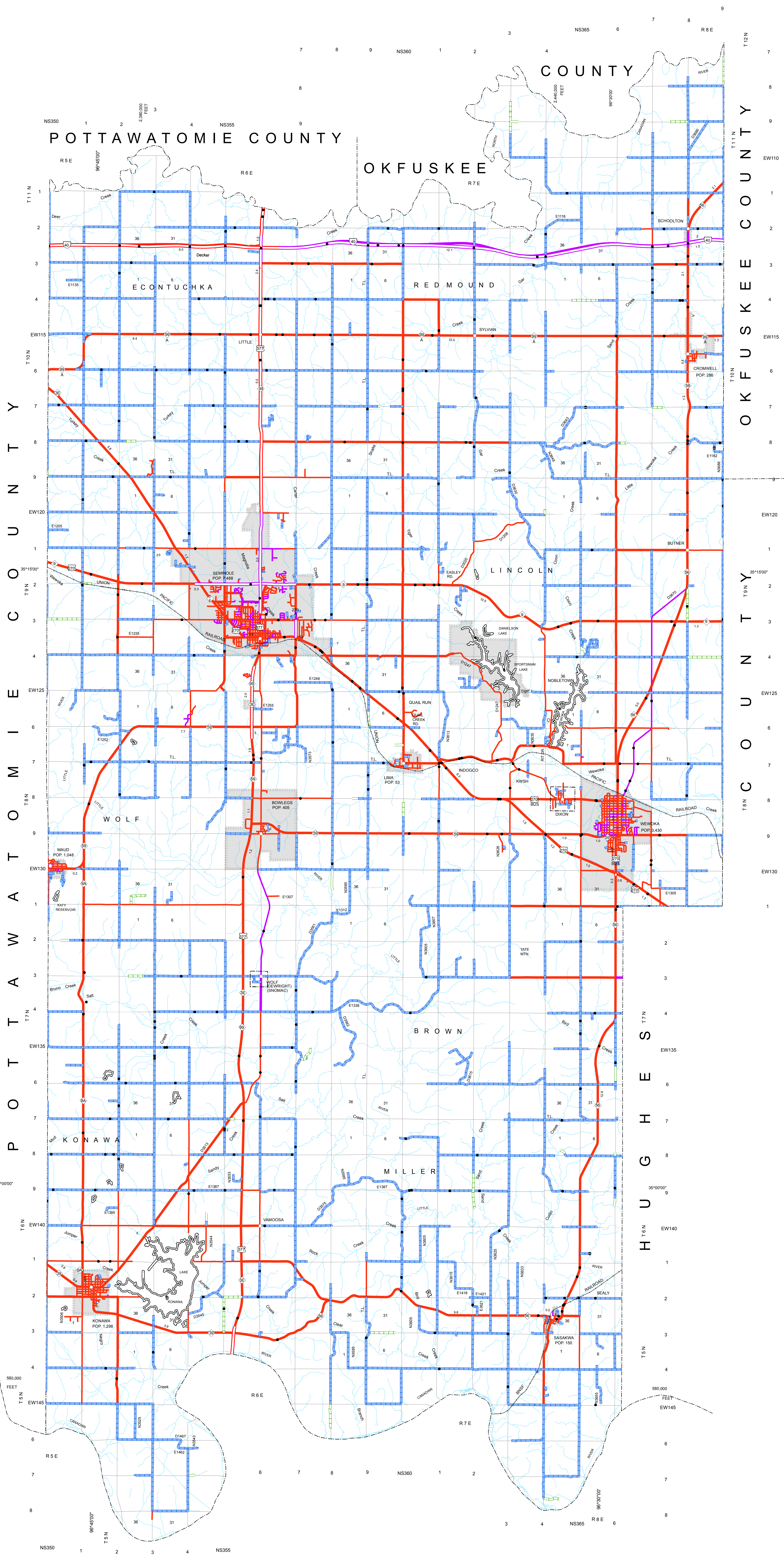

- Legend**
- Interstate Highway
  - State Highway
  - US Highway
  - Divided Highway - Asphalt
  - Divided Highway - Concrete
  - Asphalt
  - Concrete
  - Gravel
  - Grade & Drain
  - Unimproved
  - Railroad
  - State Line
  - County Line
  - Section Line
  - Corporate Limit
  - Wildlife Management Area
  - Wildlife Refuge
  - River or Stream
  - Lake or Reservoir
  - Bridges
  - Low Water Crossing
  - Natural Elevation Point
  - Natural Elevation Point

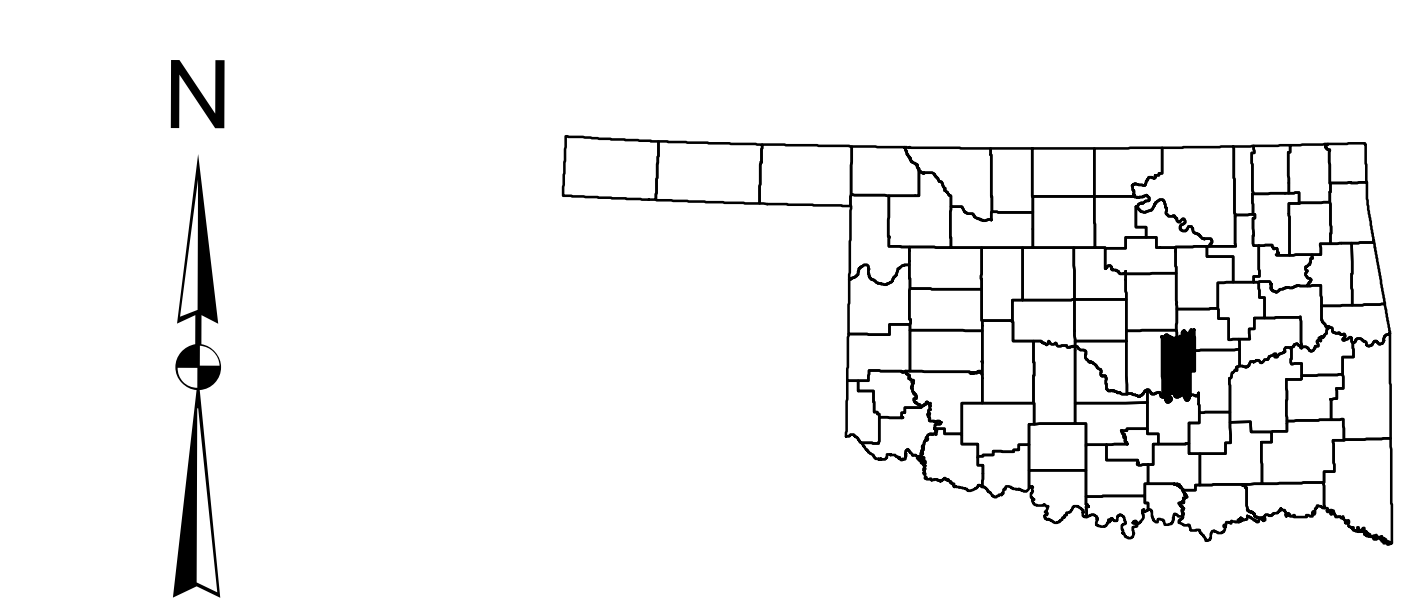

**GENERAL HIGHWAY MAP  
 SEMINOLE COUNTY  
 OKLAHOMA**

PREPARED BY THE  
 OKLAHOMA DEPARTMENT OF TRANSPORTATION  
 STRATEGIC ASSET AND PERFORMANCE  
 MANAGEMENT DIVISION

IN COOPERATION WITH THE  
 U.S. DEPARTMENT OF TRANSPORTATION  
 FEDERAL HIGHWAY ADMINISTRATION

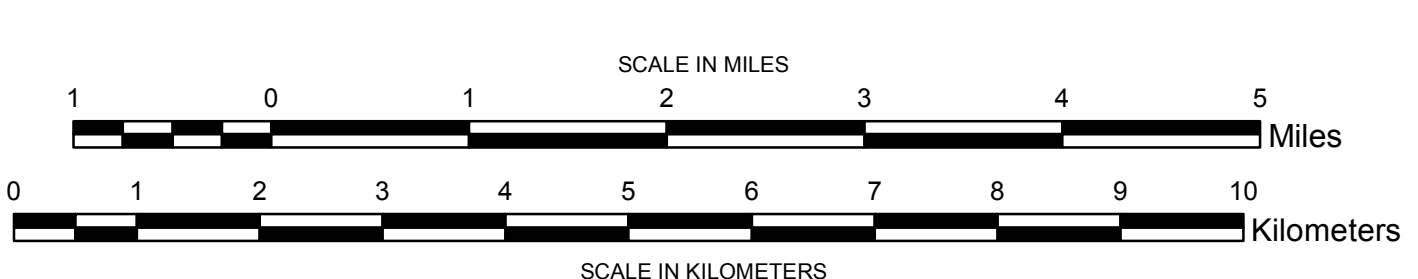

LAMBERT CONFORMAL CONIC PROJECTION U.S. & GEODETIC SURVEY DATA  
 20,000 FOOT GRID; OKLAHOMA PLANE COORDINATE SYSTEM NORTH PROJECTION ZONE;  
 POPULATION FIGURES BASED ON 2010 U.S. CENSUS  
 CD: POP-25-02

ALL DATA CURRENT AS OF DATE LISTED BELOW  
 October 2, 2018