

- Legend**
- | | | | | | |
|--|--------------------|--------------------------|--------------------------|--|--------------------------|
| | Interstate Highway | | Divided, 4 or more lanes | | Railroad |
| | US Highway | | Asphalt | | Section Line |
| | State Highway | | Concrete | | Corporate Limits |
| | Bridge | Road Surface Type | | | County Line |
| | Low Water Crossing | | Asphalt | | Wildlife Refuge |
| | Town Center | | Concrete | | Wildlife Management Area |
| | Mesas | | Gravel | | State Park |
| | Mountains & Peaks | | Grade & Drain | | US Military Installation |
| | Lake or Reservoir | | Unimproved | | State Line |
| | River or Stream | | | | |

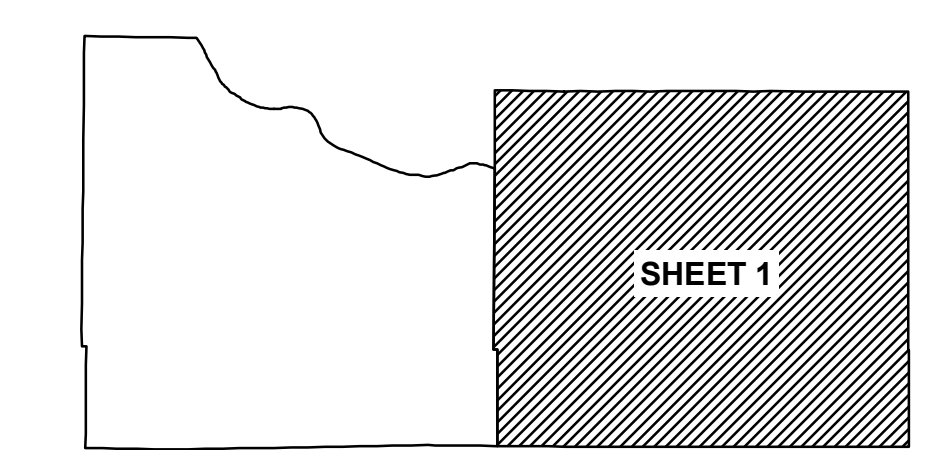
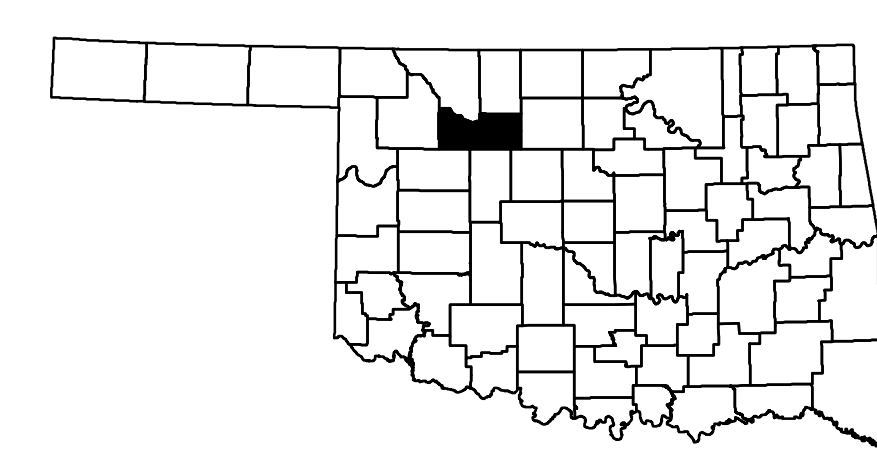

**GENERAL HIGHWAY MAP
MAJOR COUNTY
OKLAHOMA**

PREPARED BY THE
OKLAHOMA DEPARTMENT OF TRANSPORTATION
STRATEGIC ASSET AND PERFORMANCE
MANAGEMENT DIVISION

IN COOPERATION WITH THE
U.S. DEPARTMENT OF TRANSPORTATION
FEDERAL HIGHWAY ADMINISTRATION

Copies of this map are available for public use at nominal cost.
Address:
OKLAHOMA DEPARTMENT OF TRANSPORTATION
PRINTING SERVICES Phone (405) 521-2556
200 N.E. 21st STREET
OKLAHOMA CITY, OKLAHOMA 73105-3204

This map indicates those roads known to the Department to be open to public travel. Placement of a road on the map has no relationship to maintenance responsibility by any level of government.

© COPYRIGHT 2019
PRINTED AT STATE EXPENSE
NOT FOR RESALE

ALL RIGHTS RESERVED
COMPUTER GENERATED
GENERAL HIGHWAY MAP
MAJOR COUNTY
OKLAHOMA

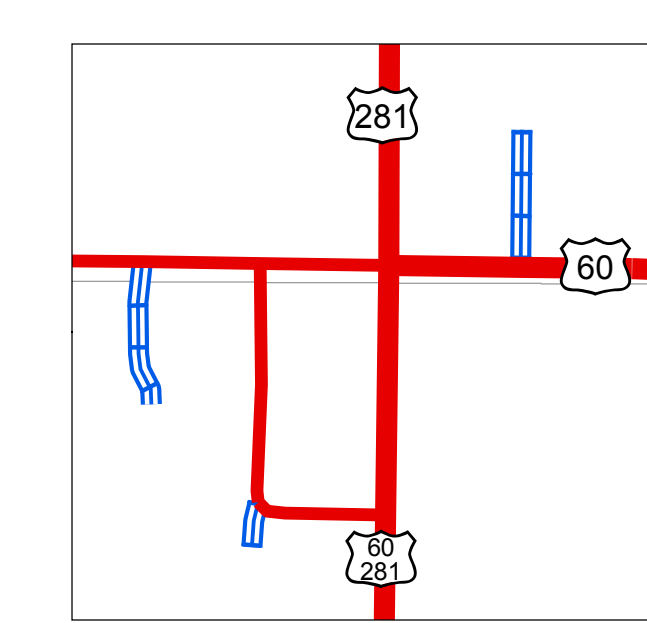
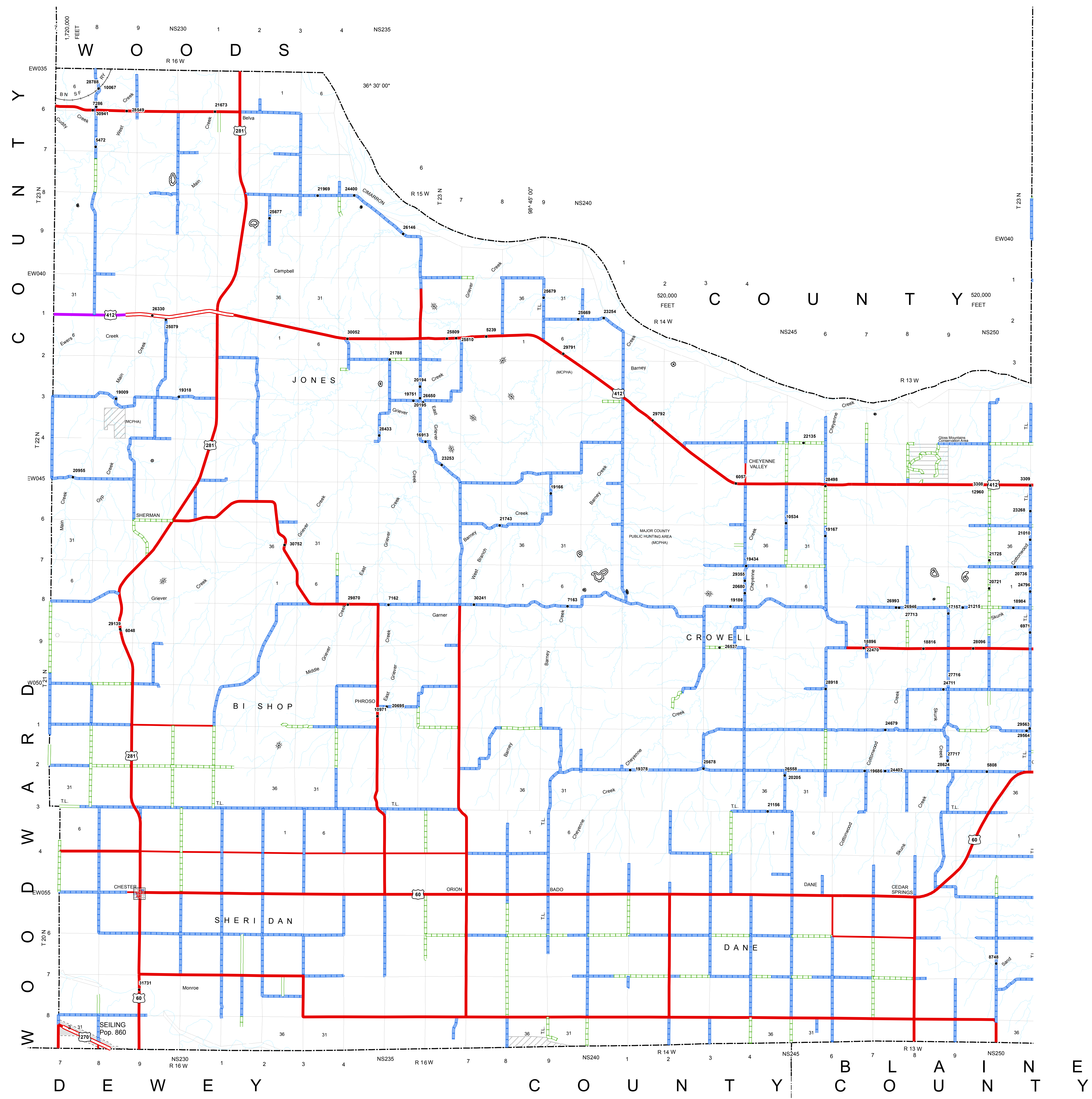

CHESTER
SEC. 8, 9, 16, 17, T 20 N, R 16 W

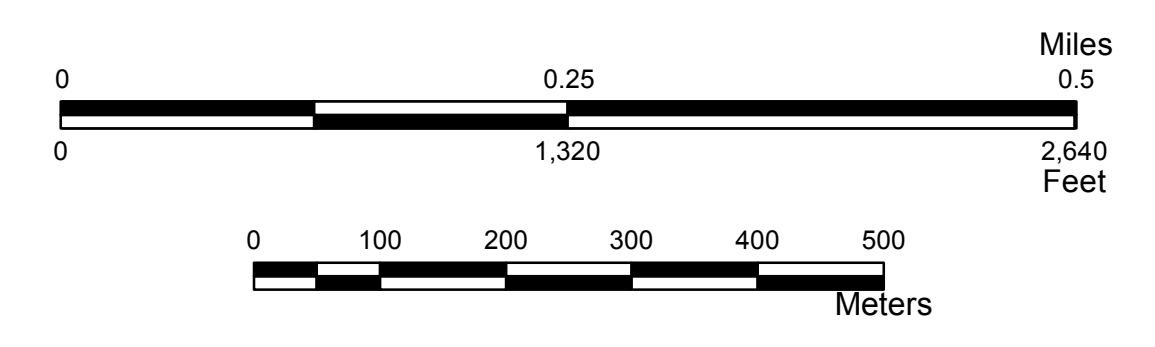

- Legend**
- Interstate Highway
 - US Highway
 - ◇ State Highway
 - Bridge
 - Low Water Crossing
 - Town Center
 - ☼ Mesas
 - ☼ Mountains & Peaks
 - ☼ Lake or Reservoir
 - River or Stream
 - Divided, 4 or more lanes
 - Asphalt
 - Concrete
 - Road Surface Type
 - Asphalt
 - Concrete
 - Gravel
 - Grade & Drain
 - Unimproved
 - Railroad
 - Section Line
 - Corporate Limits
 - County Line
 - Wildlife Refuge
 - Wildlife Management Area
 - State Park
 - US Military Installation
 - State Line

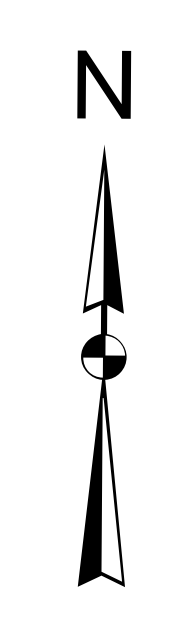

ALL DATA CURRENT AS OF DATE LISTED BELOW
October 14, 2019

GENERAL HIGHWAY MAP MAJOR COUNTY OKLAHOMA

PREPARED BY THE
OKLAHOMA DEPARTMENT OF TRANSPORTATION
STRATEGIC ASSET AND PERFORMANCE
MANAGEMENT DIVISION
IN COOPERATION WITH THE
U.S. DEPARTMENT OF TRANSPORTATION
FEDERAL HIGHWAY ADMINISTRATION

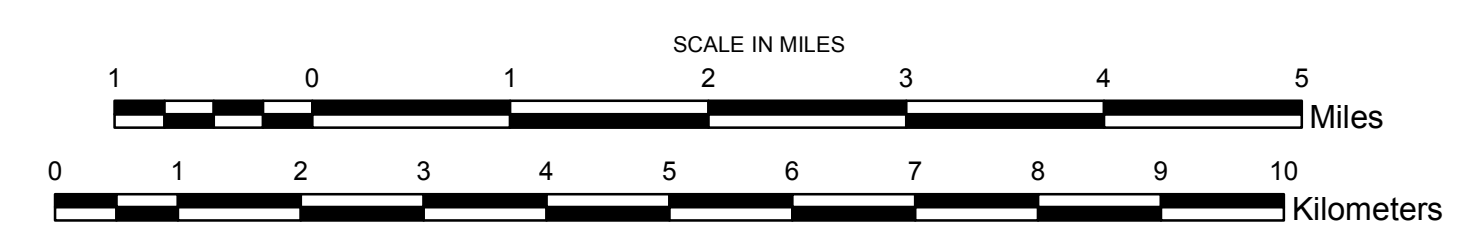

LAMBERT CONFORMAL CONIC PROJECTION U.S. & GEODETIC SURVEY DATA
20,000 FOOT GRID - OKLAHOMA PLANE COORDINATE SYSTEM NORTH PROJECTION ZONE
POPULATION FIGURES BASED ON 2010 U.S. CENSUS
CD POP 7.527

Copies of this map are available for public use at nominal cost.
Address:
OKLAHOMA DEPARTMENT OF TRANSPORTATION
PRINTING SERVICES Phone (405) 521-2586
200 N.E. 21st STREET
OKLAHOMA CITY, OKLAHOMA 73105-3204

This map indicates those roads known to the Department to be open to public travel. Placement of a road on the map has no relationship to maintenance responsibility by any level of government.