

- Legend**
- ◇ State Highway
  - US Highway
  - ▬ Divided Highway - Asphalt
  - ▬ Divided Highway - Concrete
  - ▬ Asphalt
  - ▬ Concrete
  - ▬ Gravel
  - ▬ Grade & Drain
  - ▬ Unimproved
  - ▬ Railroad
  - ▬ River or Stream
  - ▬ State Line
  - ▬ County Line
  - ▬ Section Line
  - ▬ Corporate Limit
  - ▬ Wildlife Management Area
  - ▬ Wildlife Refuge
  - ▬ Lake or Reservoir
  - Bridges
  - Low Water Crossing
  - ☼ Natural Elevation Point
  - ⊕ Natural Elevation Point; MESA

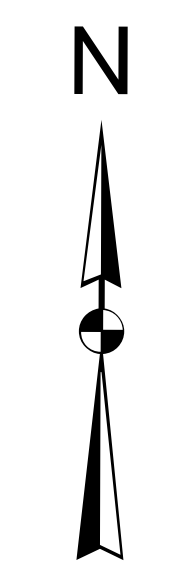

**GENERAL HIGHWAY MAP  
CREEK COUNTY  
OKLAHOMA**

PREPARED BY THE  
OKLAHOMA DEPARTMENT OF TRANSPORTATION  
STRATEGIC ASSET AND PERFORMANCE  
MANAGEMENT DIVISION  
IN COOPERATION WITH THE  
U.S. DEPARTMENT OF TRANSPORTATION  
FEDERAL HIGHWAY ADMINISTRATION

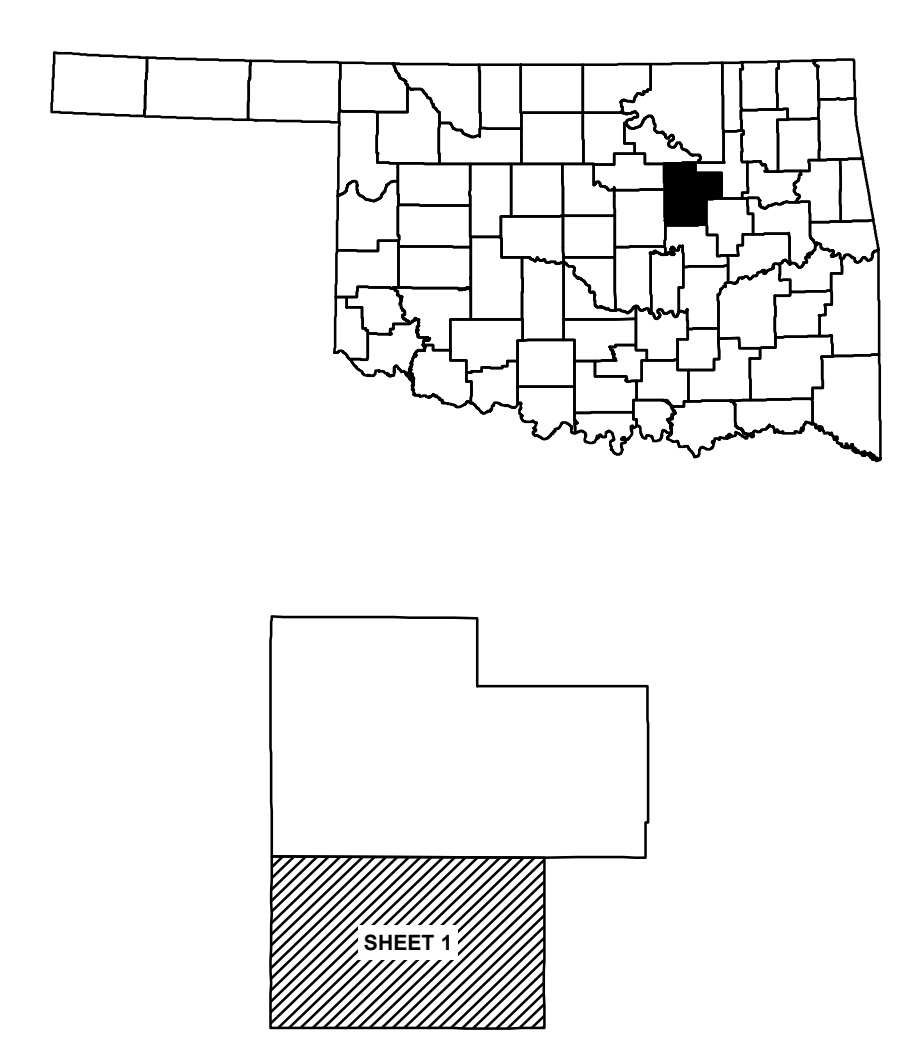
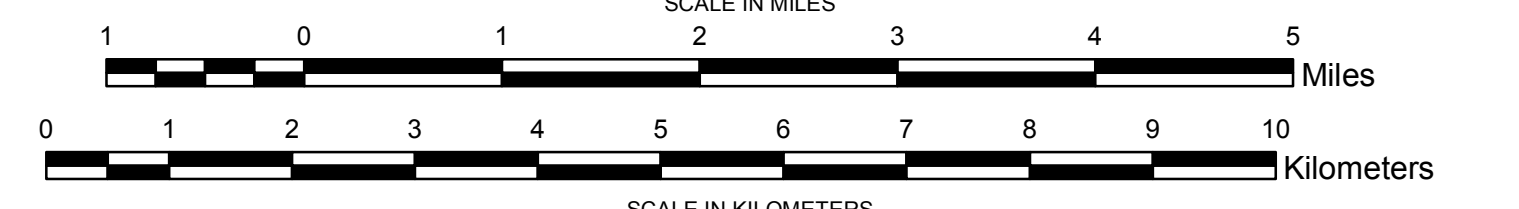

ALL DATA CURRENT AS OF DATE LISTED BELOW  
October 2, 2018

LAMBERT CONFORMAL CONIC PROJECTION U.S. & GEODETIC SURVEY DATA  
20,000 FOOT GRID, OKLAHOMA PLANE COORDINATE SYSTEM NORTH PROJECTION ZONE.  
POPULATION FIGURES BASED ON 2010 U.S. CENSUS  
CO. POP. 69,967

Copies of this map are available for public use at nominal cost.  
Address:  
OKLAHOMA DEPARTMENT OF TRANSPORTATION  
PRINTING SERVICES Phone (405) 521-2586  
200 N.E. 21st STREET  
OKLAHOMA CITY, OKLAHOMA 73105-3204

This map indicates those roads known to the Department to be open to public travel. Placement of a road on the map has no relationship to maintenance responsibility by any level of government.

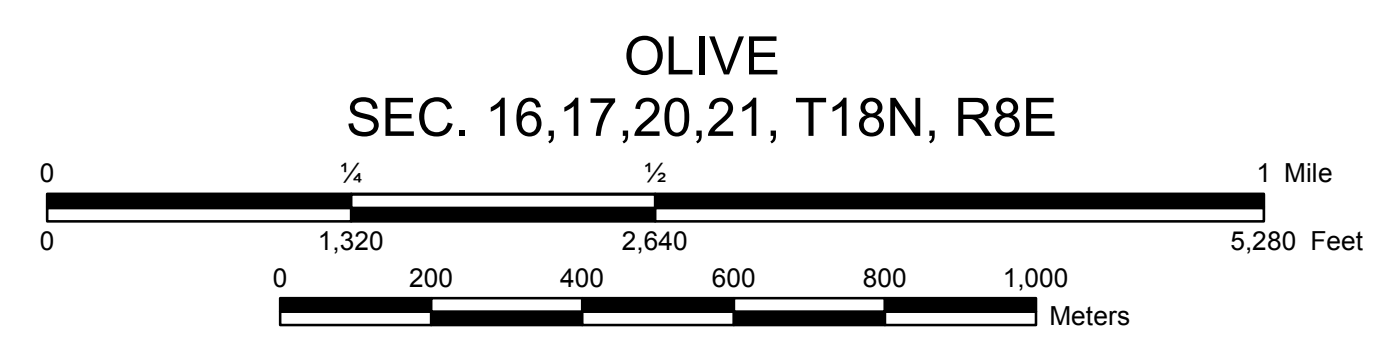
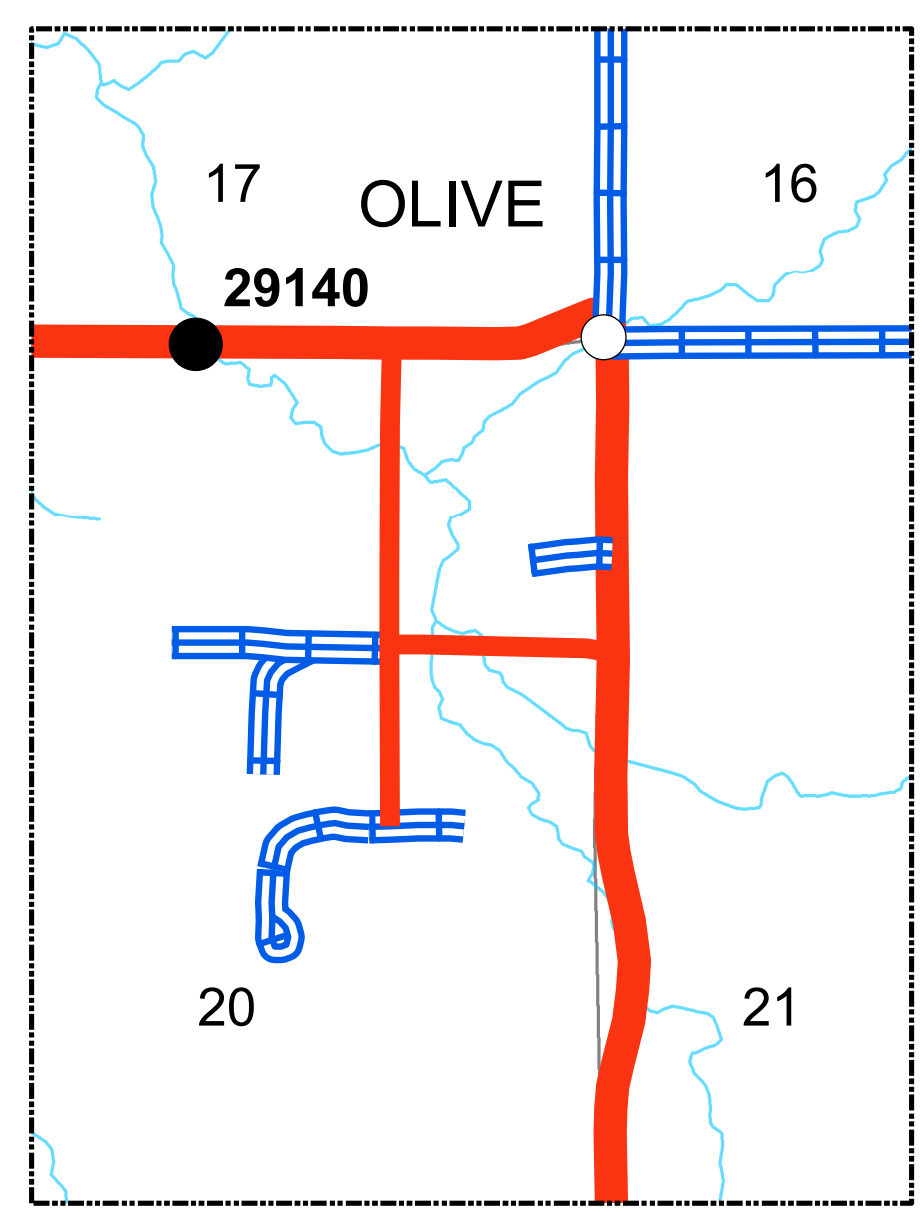
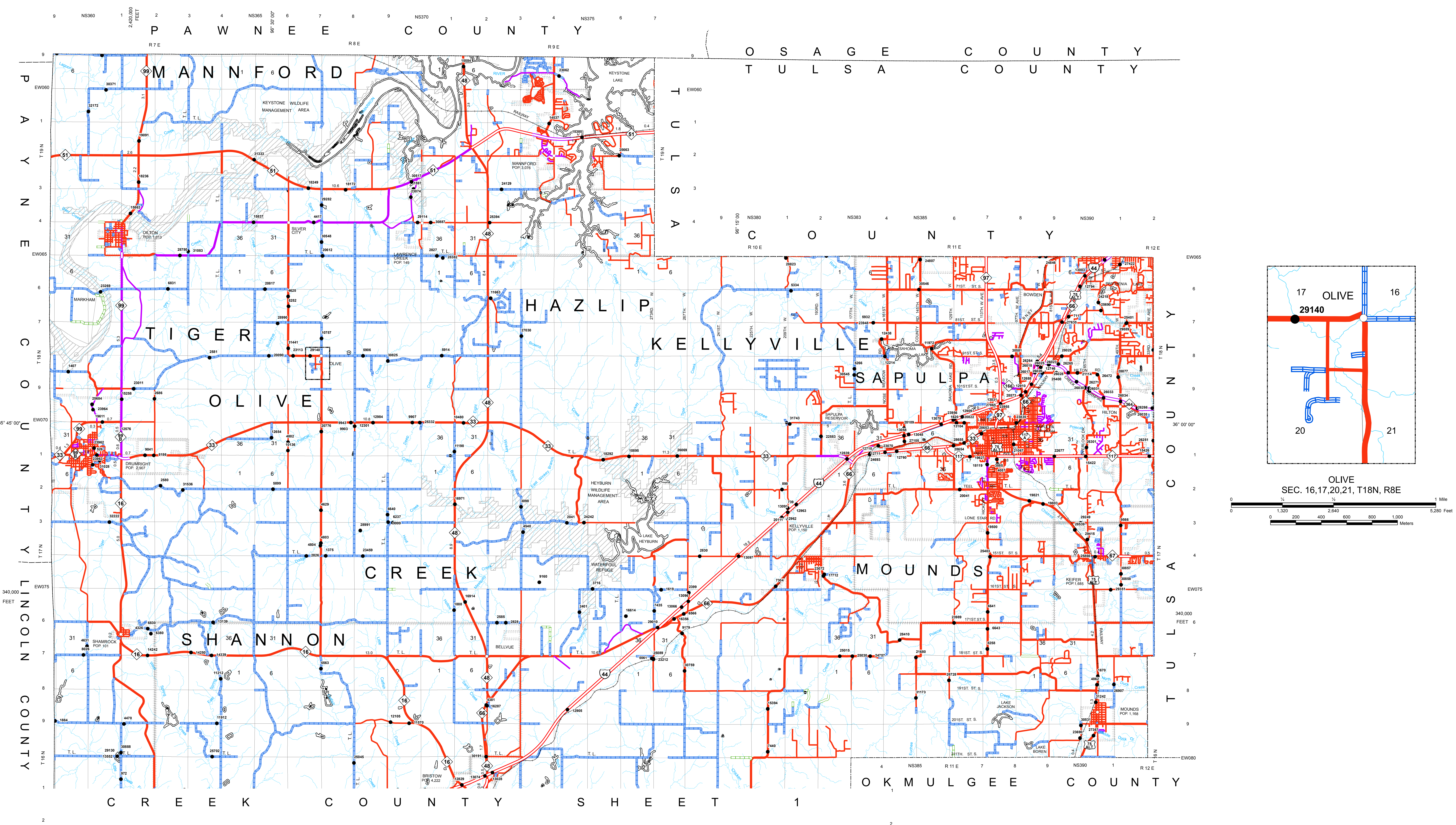

- Legend**
- ◇ State Highway
  - US Highway
  - Divided Highway - Asphalt
  - Divided Highway - Concrete
  - Asphalt
  - Concrete
  - Gravel
  - Grade & Drain
  - Unimproved
  - Railroad
  - River or Stream
  - State Line
  - County Line
  - Section Line
  - Corporate Limit
  - Wildlife Management Area
  - Wildlife Refuge
  - Lake or Reservoir
  - Bridges
  - Low Water Crossing
  - ☼ Natural Elevation Point
  - ⊕ Natural Elevation Point; MESA

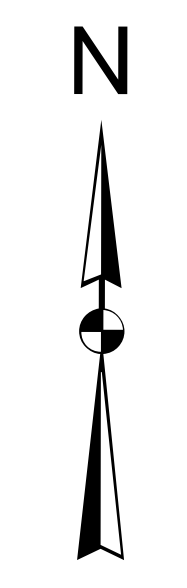
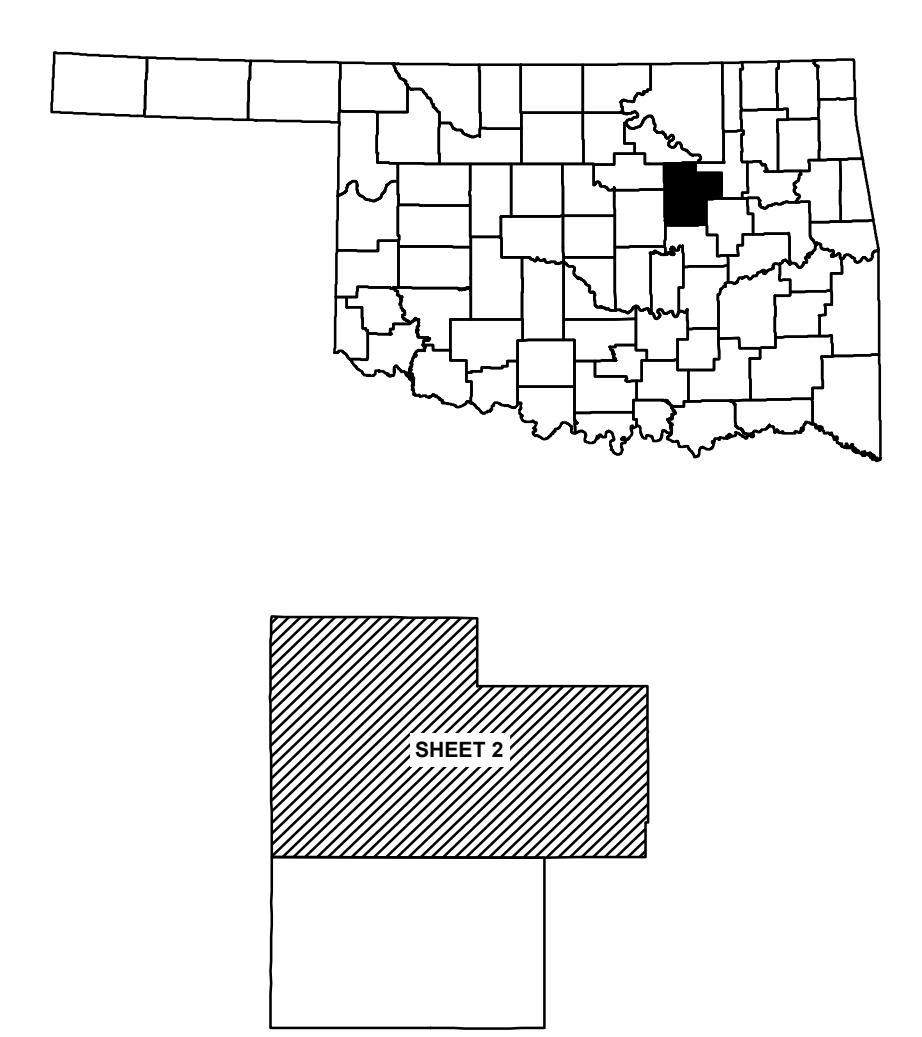

**GENERAL HIGHWAY MAP  
CREEK COUNTY  
OKLAHOMA**

PREPARED BY THE  
OKLAHOMA DEPARTMENT OF TRANSPORTATION  
STRATEGIC ASSET AND PERFORMANCE  
MANAGEMENT DIVISION

IN COOPERATION WITH THE  
U.S. DEPARTMENT OF TRANSPORTATION  
FEDERAL HIGHWAY ADMINISTRATION

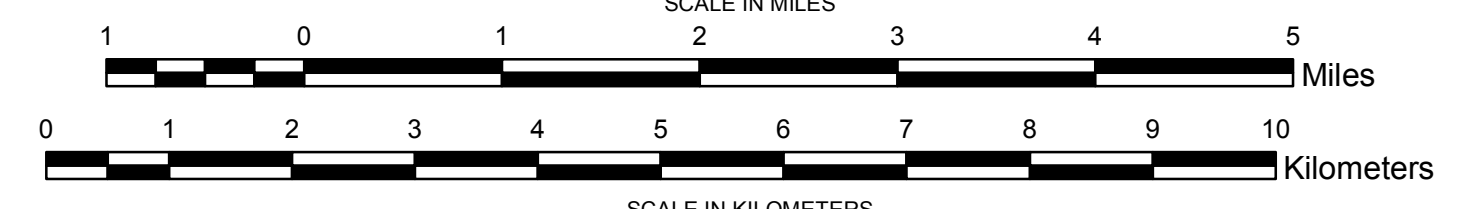

ALL DATA CURRENT AS OF DATE LISTED BELOW  
October 2, 2018

LAMBERT CONFORMAL CONIC PROJECTION U.S. & GEODETIC SURVEY DATA  
20,000 FOOT GRID, OKLAHOMA PLANE COORDINATE SYSTEM NORTH PROJECTION ZONE  
POPULATION FIGURES BASED ON 2010 U.S. CENSUS  
CO. POP. 69,967

Copies of this map are available for public use at nominal cost.  
Address:  
OKLAHOMA DEPARTMENT OF TRANSPORTATION  
PRINTING SERVICES Phone (405) 521-2586  
200 N.E. 21st STREET  
OKLAHOMA CITY, OKLAHOMA 73105-3204

This map indicates those roads known to the Department to be open to public travel. Placement of a road on the map has no relationship to maintenance responsibility by any level of government.