

- Interstate Highway
- US Highway
- State Highway
- Divided Highway - Asphalt
- Divided Highway - Concrete
- Asphalt
- Concrete
- Gravel
- Grade & Drain
- Unimproved
- Railroad
- River or Stream
- State Line
- County Line
- Section Line
- Corporate Limit
- Wildlife Management Area
- Wildlife Refuge
- Lake or Reservoir
- Bridges
- Low Water Crossing
- Natural Elevation Point
- Natural Elevation Point

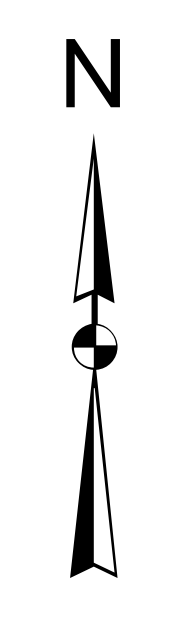

ALL DATA CURRENT AS OF DATE LISTED BELOW
October 2, 2019

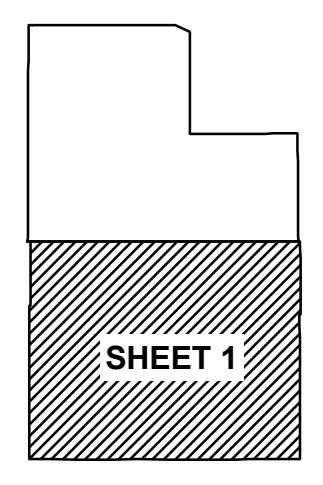
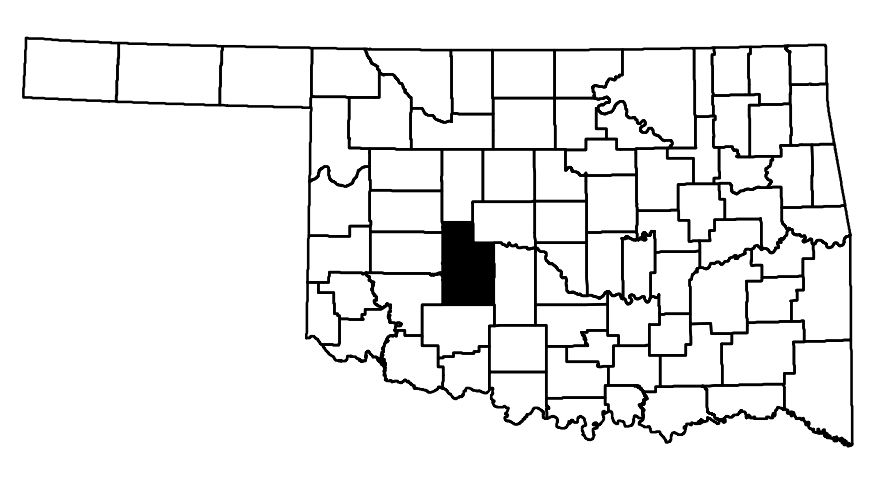
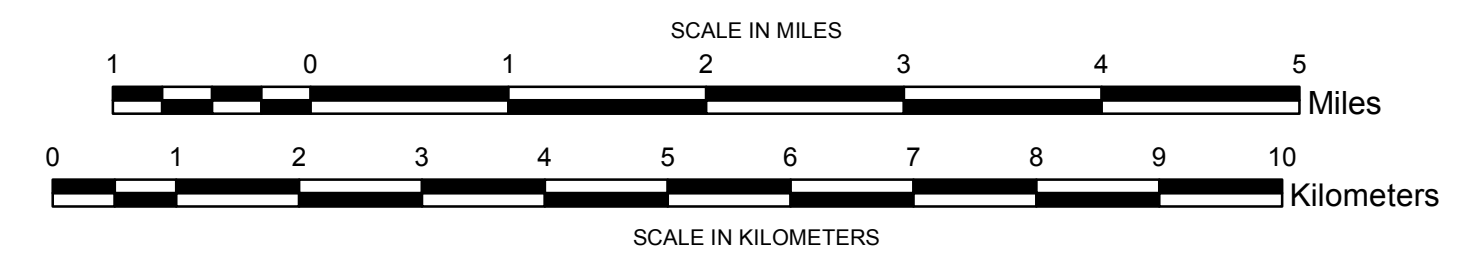

Copies of this map are available for public use at nominal cost.
Address:
OKLAHOMA DEPARTMENT OF TRANSPORTATION
PRINTING SERVICES Phone (405) 521-2586
200 N.E. 21st STREET
OKLAHOMA CITY, OKLAHOMA 73105-3204

This map indicates those roads known to the Department to be open to public travel. Placement of a road on the map has no relationship to maintenance responsibility by any level of government.

GENERAL HIGHWAY MAP CADDO COUNTY OKLAHOMA

PREPARED BY THE
OKLAHOMA DEPARTMENT OF TRANSPORTATION
STRATEGIC ASSET AND PERFORMANCE
MANAGEMENT DIVISION
IN COOPERATION WITH THE
U.S. DEPARTMENT OF TRANSPORTATION
FEDERAL HIGHWAY ADMINISTRATION

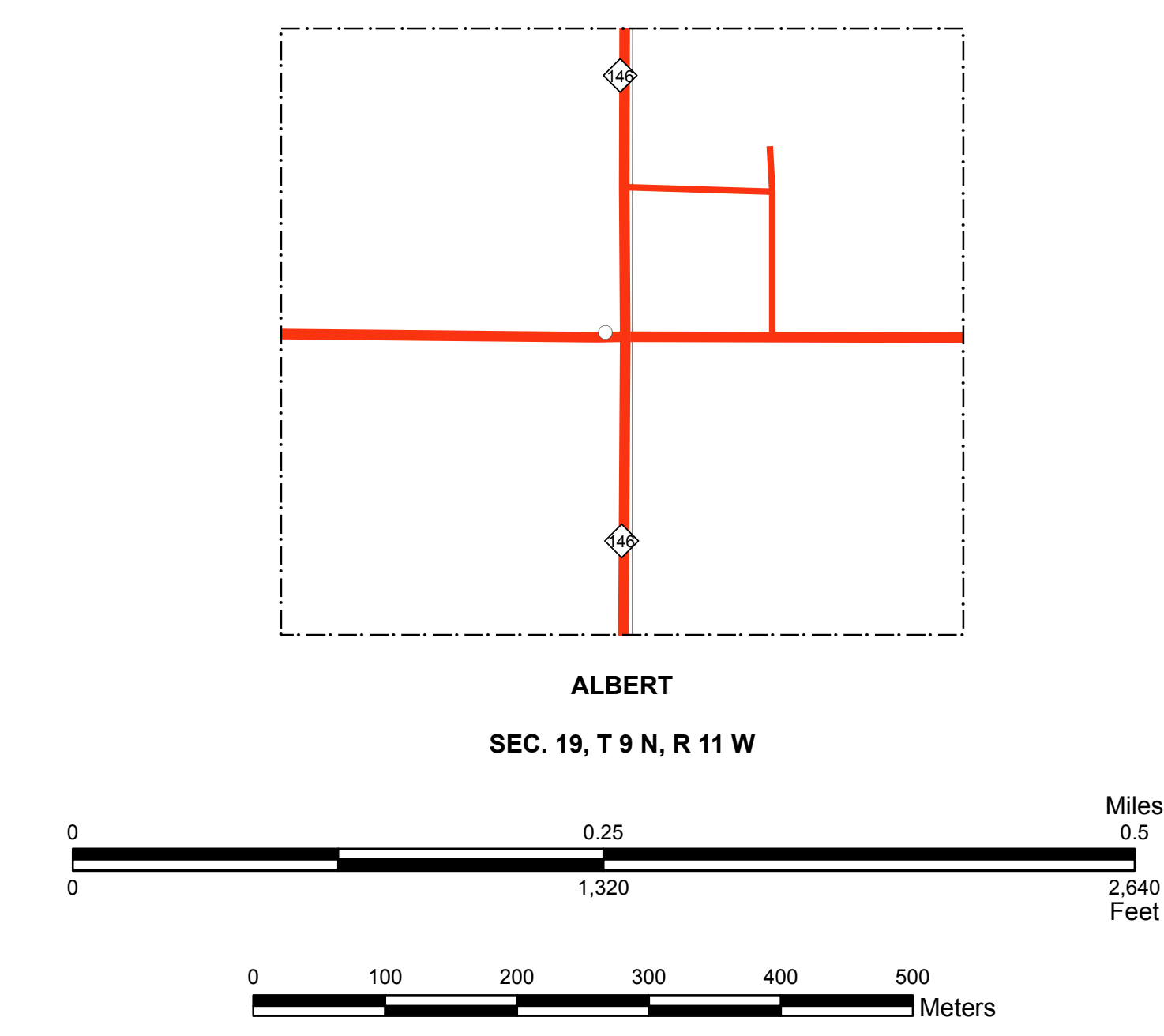
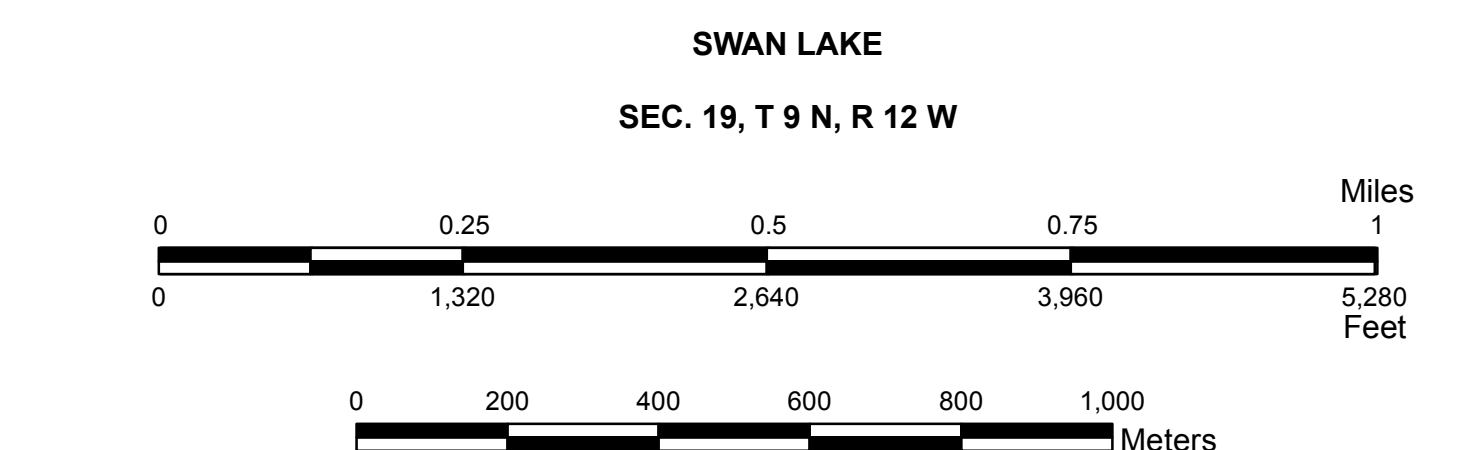
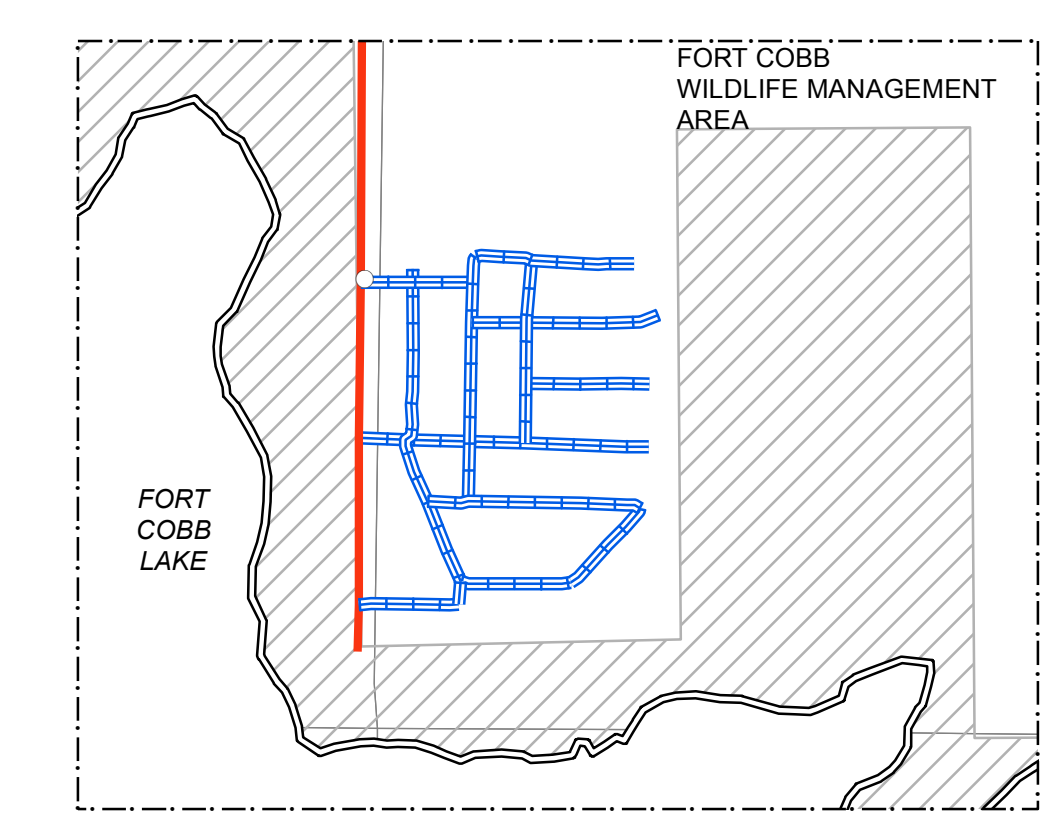
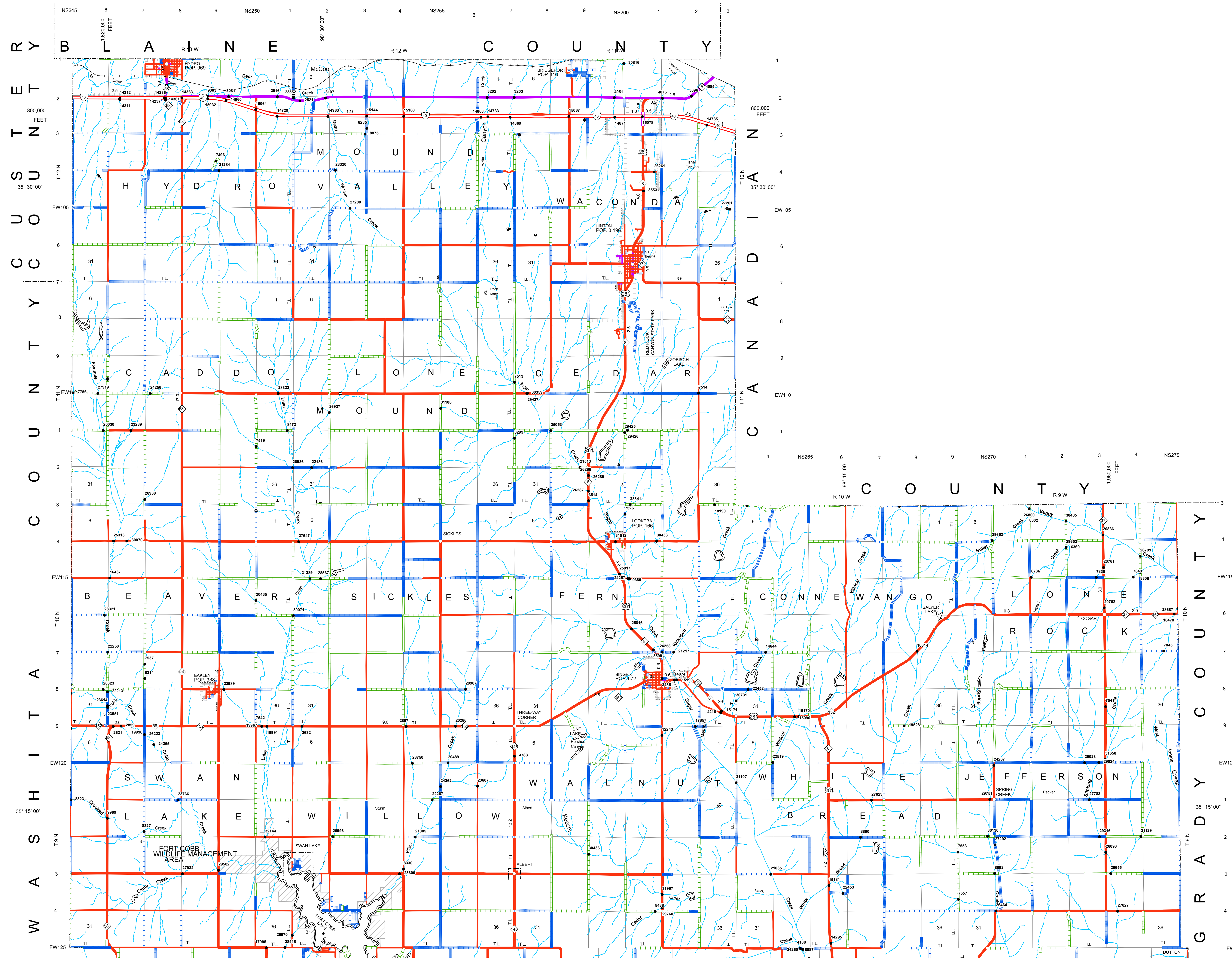

Legend

- Interstate Highway
- US Highway
- ◇ State Highway
- ▬ Divided Highway - Asphalt
- ▬ Divided Highway - Concrete
- ▬ Asphalt
- ▬ Concrete
- ▬ Gravel
- ▬ Grade & Drain
- ▬ Unimproved
- ▬ Railroad
- ▬ River or Stream
- ▬ State Line
- ▬ County Line
- ▬ Section Line
- ▬ Corporate Limit
- ▨ Wildlife Management Area
- ▨ Wildlife Refuge
- ▭ Lake or Reservoir
- Bridges
- Low Water Crossing
- ☼ Natural Elevation Point
- Natural Elevation Point

Copies of this map are available for public use at nominal cost.
 Address:
 OKLAHOMA DEPARTMENT OF TRANSPORTATION
 PRINTING SERVICES Phone (405) 521-2586
 200 N.E. 21st STREET
 OKLAHOMA CITY, OKLAHOMA 73105-3204

This map indicates those roads known to the Department to be open to public travel. Placement of a road on the map has no relationship to maintenance responsibility by any level of government.

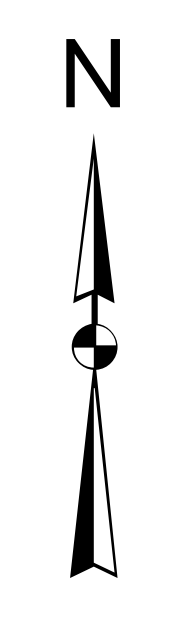
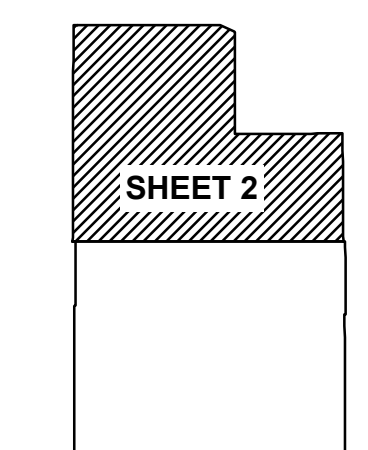
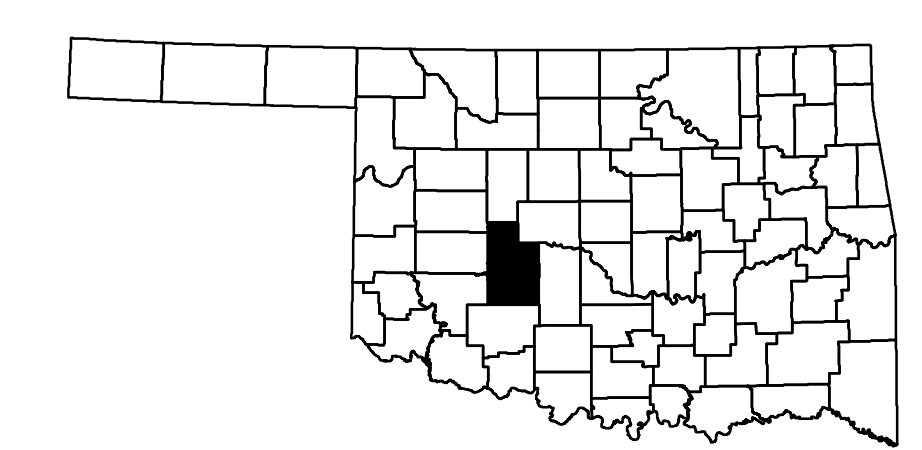

ALL DATA CURRENT AS OF DATE LISTED BELOW
 October 2, 2019

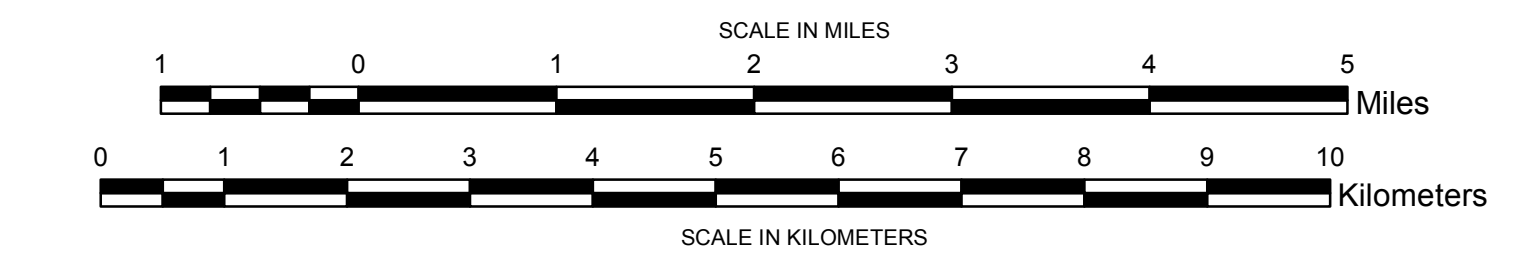

**GENERAL HIGHWAY MAP
 CADDO COUNTY
 OKLAHOMA**

PREPARED BY THE
 OKLAHOMA DEPARTMENT OF TRANSPORTATION
 STRATEGIC ASSET AND PERFORMANCE
 MANAGEMENT DIVISION

IN COOPERATION WITH THE
 U.S. DEPARTMENT OF TRANSPORTATION
 FEDERAL HIGHWAY ADMINISTRATION