

S T A T E O F T E X A S

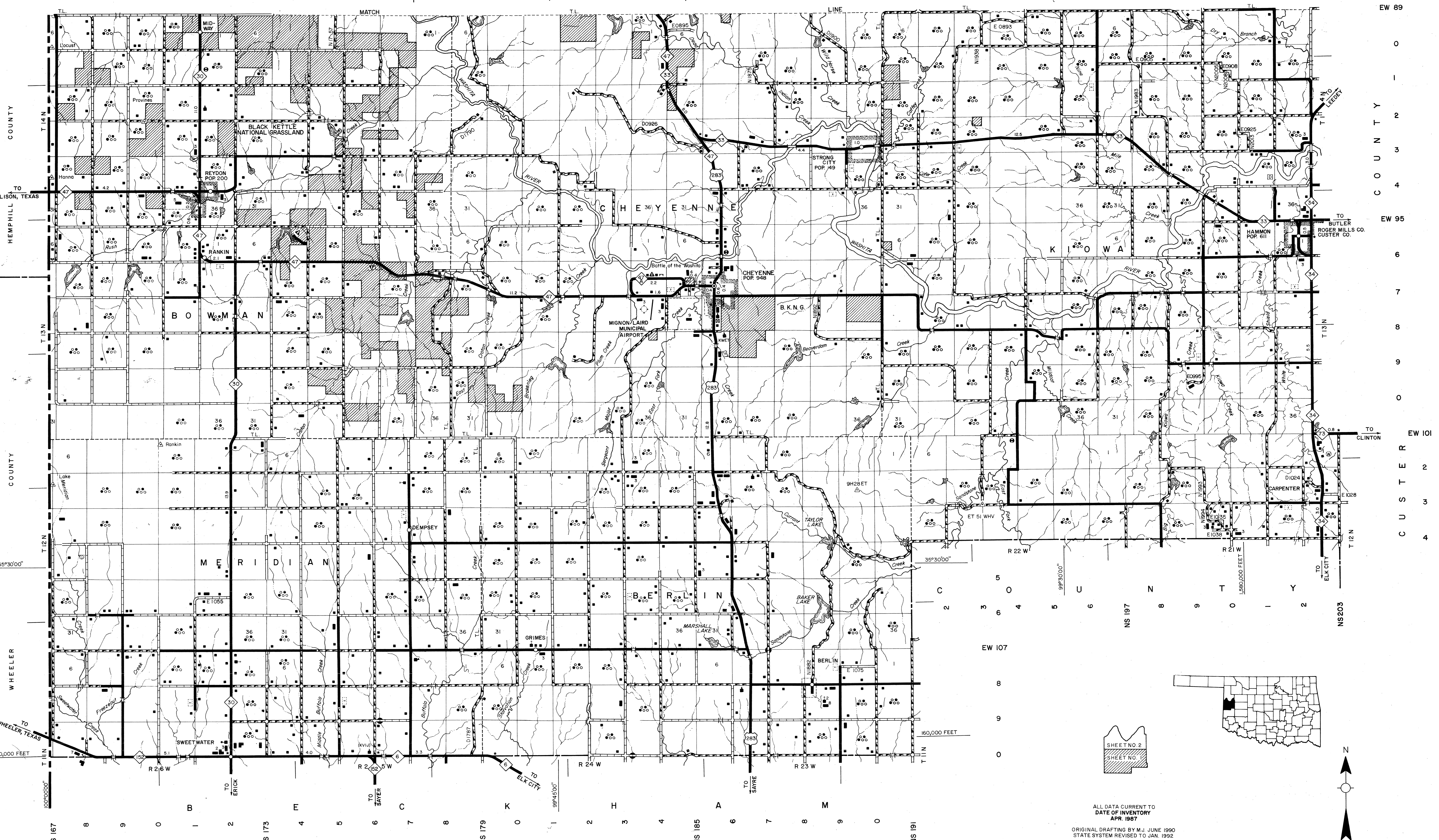

- LEGEND**
- U.S. NUMBERED HIGHWAY
 - STATE NUMBERED HIGHWAY
 - INTERSTATE HIGHWAY ROUTE
 - PAVED ROAD
 - GRAVEL ROAD
 - GRADED & DRAINED ROAD
 - UNPAVED ROAD
 - PRIMITIVE ROAD
 - PROJECTED ROAD
 - RESIDENTIAL ROAD
 - N0001 COUNTY ROAD ID NO.
 - MILEAGE BETWEEN POINTS
 - DIVIDED HIGHWAY 4 OR MORE LANES
 - INDIVIDUAL HIGHWAY 2 OR MORE LANES
 - TRAFFIC CIRCLE
 - HIGHWAY GRADE SEPARATION
 - TRAFFIC INTERCHANGE
 - STATE LINE
 - COUNTY LINE
 - CIVIL TOWNSHIP LINE
 - SECTION LINE
 - RURAL DEVELOPMENT AREA
 - GOVERNMENT PROPERTY LINE
 - MATCH LINE
 - COUNTY SEAT
 - TOWN CENTER
 - CORPORATE LIMITS
 - CIVIL TOWNSHIP ROAD IN PLACE
 - INSET BOUNDARY
 - ELEVATION ABOVE SEA LEVEL
 - MOUNTAIN RANGE BUTTE OR MESA
 - SMALL MONUMENT
 - MARSH OR SWAMP LANDS
 - DRAINAGE DITCH
 - IRRIGATION DITCH
 - LAKE RESERVOIR OR POND WITH DAM
 - ROAD OVER DAM
 - DRY LAKE SUBJECT TO FLOOD
 - SMALL BRIDGES CLOSELY SPACED
 - HIGHWAY BRIDGE OVER 20 FT. IN LENGTH
 - GENERAL BRIDGE LONG CROSSING
 - ARCH BRIDGE
 - TRUSS BRIDGE W-Wood S-Steel C-Concrete
 - CONCRETE DIRT OR FORD
 - FORD ROAD ESTABLISHED
 - INTERMITTENT STREAM
 - NARROW STREAM
 - DOCK PIER OR LANDING
 - NAVIGABLE STREAM WITH LOCK & DAM
 - WIDE STREAM OR RIVER
 - TRIANGULATION STATION
 - RAILROAD ANY NUMBER OF TRACKS
 - RAILROAD WITH STATIONS INDICATED
 - GRADE CROSSING
 - UNDERPASS R.R. ABOVE
 - OVERPASS R.R. BELOW
 - RAILROAD ON STREET
 - MILITARY AIRFIELD
 - AIRPORT WITH COMPLETE FACILITIES
 - AIRPORT WITH LIMITED FACILITIES
 - LANDING STRIP PRIVATE FIELD
 - AIRPORT GENERAL OUTLINE OF FIELD
 - RUNWAYS SHOWN IN POSITION
 - ROADSIDE PARK Picnic Grounds
 - PLAYGROUND
 - CAMP OR LODGE Permanent With Buildings
 - SMALL PARK MP Municipal TP-Trailer Park
 - FOREST RANGER STATION
 - OBSERVATION OR LOOKOUT TOWER
 - CAMP SITE
 - FISH HATCHERY
 - GOLF COURSE OR COUNTRY CLUB
 - ATHLETIC FIELD OR AMUSEMENT PARK
 - FARMLANDS RACE COURSE
 - DWELLING
 - NUMBER OF DWELLINGS CLOSELY SPACED
 - COMBINED BUSINESS AND DWELLING
 - POST OFFICE
 - POST OFFICE COMBINATIONS
 - SEASONAL DWELLINGS
 - CHURCH OR OTHER RELIGIOUS BUILDING
 - CEMETERY
 - CHURCH WITH CEMETERY ADJACENT
 - REST HOME
 - HOSPITAL
 - SMALL BUSINESS
 - INDUSTRY
 - SAW MILL
 - MINE SHAFT OR DRIFT
 - OIL OR GAS FIELD
 - GALVANIZING OR PUMPING STATION
 - WAREHOUSE
 - GRAVEL PIT
 - QUARRY
 - SCHOOL
 - COMMUNITY HALL OR LODGE
 - HISTORICAL MARKER
 - DRIVE-IN THEATER
 - CORRECTIONAL INSTITUTION
 - HIGHWAY GARAGE
 - JUNK YARDS & DUMPS A-Automobile B-Scrap Building Material D-Debris Garbage or Trash Dump F-Sanitary Fill G-Other
 - SEWAGE DISPOSAL PLANT
 - WATER SUPPLY STAND PIPE
 - POWER SUBSTATION
 - ROOSTER STATION
 - POWER SUBSTATION
 - TELEVISION OR RADIO STATION
 - MILITARY INSTALLATION

SHEET NO. 2
SHEET NO.

ALL DATA CURRENT TO
DATE OF INVENTORY
APR. 1987
ORIGINAL DRAFTING BY M.J. JUNE 1990
STATE SYSTEM REVISED TO JAN. 1992

GENERAL HIGHWAY MAP ROGER MILLS COUNTY OKLAHOMA

PREPARED BY THE
**OKLAHOMA DEPARTMENT OF TRANSPORTATION
PLANNING DIVISION**
IN COOPERATION WITH THE
**U.S. DEPARTMENT OF TRANSPORTATION
FEDERAL HIGHWAY ADMINISTRATION**

SCALE
LAMBERT CONFORMAL CONIC PROJECTION U.S. COAST & GEODETIC SURVEY DATA
2000 FOOT GRID ON LAMBERT PLANE COORDINATE SYSTEM NORTH PROJECTION ZONE
ELEVATION REFERENCED TO THE 1980 U.S. TENSIS
COUNTY POPULATION 4,147

ALL RIGHTS RESERVED SHEET 1 OF 2 SHEETS

NOT FOR RESALE