

**LEGEND**

	U.S. NUMBERED HIGHWAY		RAILROAD WITH STATION INDICATED
	STATE NUMBERED HIGHWAY		RAILROAD WITH STATION INDICATED
	INTERSTATE HIGHWAY ROUTE		RAILROAD WITH STATION INDICATED
	PAVED ROAD		RAILROAD WITH STATION INDICATED
	GRAVEL ROAD		RAILROAD WITH STATION INDICATED
	UNIMPROVED ROAD		RAILROAD WITH STATION INDICATED
	PROJECTED ROAD		RAILROAD WITH STATION INDICATED
	COUNTY ROAD ID NO.		RAILROAD WITH STATION INDICATED
	MILEAGE BETWEEN POINTS		RAILROAD WITH STATION INDICATED
	DIVIDED HIGHWAY, 4 OR MORE LANES		RAILROAD WITH STATION INDICATED
	DIVIDED HIGHWAY, 3 OR MORE LANES		RAILROAD WITH STATION INDICATED
	TRAFFIC CIRCLE		RAILROAD WITH STATION INDICATED
	HIGHWAY GRADE SEPARATION		RAILROAD WITH STATION INDICATED
	TRAFFIC INTERCHANGE		RAILROAD WITH STATION INDICATED
	STATE LINE		RAILROAD WITH STATION INDICATED
	COUNTY LINE		RAILROAD WITH STATION INDICATED
	CIVIL TOWNSHIP LINE		RAILROAD WITH STATION INDICATED
	SECTION LINE		RAILROAD WITH STATION INDICATED
	RURAL DEVELOPMENT AREA		RAILROAD WITH STATION INDICATED
	GOVERNMENT PROPERTY LINE		RAILROAD WITH STATION INDICATED
	MATCH LINE		RAILROAD WITH STATION INDICATED
	COUNTY SEAT		RAILROAD WITH STATION INDICATED
	TOWN CENTER		RAILROAD WITH STATION INDICATED
	CORPORATE LIMITS		RAILROAD WITH STATION INDICATED
	CIVIL TOWNSHIP ROAD IN PLACE		RAILROAD WITH STATION INDICATED
	INSET BOUNDARY		RAILROAD WITH STATION INDICATED
	ELEVATION ABOVE SEA LEVEL		RAILROAD WITH STATION INDICATED
	MOUNTAIN RANGE, BUTTE OR MESA		RAILROAD WITH STATION INDICATED
	SMALL MONUMENT		RAILROAD WITH STATION INDICATED
	MARSH OR SWAMP LANDS		RAILROAD WITH STATION INDICATED
	DRAINAGE DITCH		RAILROAD WITH STATION INDICATED
	IRRIGATION DITCH		RAILROAD WITH STATION INDICATED
	LAKE, RESERVOIR OR POND WITH DAM		RAILROAD WITH STATION INDICATED
	ROAD OVER DAM		RAILROAD WITH STATION INDICATED
	DRY LAKE SUBJECT TO FLOOD		RAILROAD WITH STATION INDICATED
	SMALL BRIDGE, CLOSELY SPACED		RAILROAD WITH STATION INDICATED
	HIGHWAY BRIDGE, OVER 20FT. IN LENGTH		RAILROAD WITH STATION INDICATED
	GENERAL BRIDGE, LONG CROSSING		RAILROAD WITH STATION INDICATED
	TRESTLE BRIDGE		RAILROAD WITH STATION INDICATED
	TRUSS BRIDGE		RAILROAD WITH STATION INDICATED
	CONCRETE DIP OR ROAD		RAILROAD WITH STATION INDICATED
	ROAD ROAD ESTABLISHED		RAILROAD WITH STATION INDICATED
	INTERMITTENT STREAM		RAILROAD WITH STATION INDICATED
	NARROW STREAM		RAILROAD WITH STATION INDICATED
	DOCK PIER OR LANDING		RAILROAD WITH STATION INDICATED
	NAVIGABLE STREAM WITH LOCK & DAM		RAILROAD WITH STATION INDICATED
	WIDE STREAM OR RIVER		RAILROAD WITH STATION INDICATED
	TRIANGULATION STATION		RAILROAD WITH STATION INDICATED
	ROADSIDE PARK		RAILROAD WITH STATION INDICATED
	PLAYGROUNDS		RAILROAD WITH STATION INDICATED
	BATHING BEACH OR SWIMMING POOL		RAILROAD WITH STATION INDICATED
	SCENIC SITE		RAILROAD WITH STATION INDICATED
	MOTEL		RAILROAD WITH STATION INDICATED
	CAMP OR LODGE		RAILROAD WITH STATION INDICATED
	FOREST RANGER STATION		RAILROAD WITH STATION INDICATED
	OBSERVATION OR LOOKOUT TOWER		RAILROAD WITH STATION INDICATED
	CAMP SITE		RAILROAD WITH STATION INDICATED
	FISH HATCHERY		RAILROAD WITH STATION INDICATED
	GOLF COURSE OR COUNTRY CLUB		RAILROAD WITH STATION INDICATED
	ATHLETIC FIELD OR AMUSEMENT PARK		RAILROAD WITH STATION INDICATED
	FAIRGROUNDS, RACE COURSE		RAILROAD WITH STATION INDICATED
	NUMBER OF DWELLINGS CLOSELY SPACED		RAILROAD WITH STATION INDICATED
	COMBINED BUSINESS AND DWELLING		RAILROAD WITH STATION INDICATED
	POST OFFICE		RAILROAD WITH STATION INDICATED
	POST OFFICE COMBINATIONS		RAILROAD WITH STATION INDICATED
	SEASONAL DWELLINGS		RAILROAD WITH STATION INDICATED
	CHURCH OR OTHER RELIGIOUS BUILDING		RAILROAD WITH STATION INDICATED
	CEMETERY		RAILROAD WITH STATION INDICATED
	CHURCH WITH CEMETERY ADJACENT		RAILROAD WITH STATION INDICATED
	REST HOME		RAILROAD WITH STATION INDICATED
	HOSPITAL		RAILROAD WITH STATION INDICATED
	SMALL BUSINESS		RAILROAD WITH STATION INDICATED
	INDUSTRY		RAILROAD WITH STATION INDICATED
	SAW MILL		RAILROAD WITH STATION INDICATED
	MINE SHAFT OR DRIFT		RAILROAD WITH STATION INDICATED
	OIL OR GAS FIELD		RAILROAD WITH STATION INDICATED
	GAUGING OR PUMPING STATION		RAILROAD WITH STATION INDICATED
	WAREHOUSE		RAILROAD WITH STATION INDICATED
	GRAVEL PIT		RAILROAD WITH STATION INDICATED
	QUARRY		RAILROAD WITH STATION INDICATED
	SCHOOL		RAILROAD WITH STATION INDICATED
	COMMUNITY HALL OR LODGE		RAILROAD WITH STATION INDICATED
	DRIVE-IN THEATER		RAILROAD WITH STATION INDICATED
	CORRECTIONAL INSTITUTION		RAILROAD WITH STATION INDICATED
	HIGHWAY GARAGE		RAILROAD WITH STATION INDICATED
	JUNK YARD & DUMP		RAILROAD WITH STATION INDICATED
	A-Automobile, B-Scrap Building Material, C-Other		RAILROAD WITH STATION INDICATED
	SEWAGE DISPOSAL PLANT		RAILROAD WITH STATION INDICATED
	WATER SUPPLY STAND PIPE		RAILROAD WITH STATION INDICATED
	POWER PLANT		RAILROAD WITH STATION INDICATED
	BOOSTER STATION		RAILROAD WITH STATION INDICATED
	POWER SUBSTATION		RAILROAD WITH STATION INDICATED
	TELEVISION OR RADIO STATION		RAILROAD WITH STATION INDICATED
	MILITARY INSTALLATION		RAILROAD WITH STATION INDICATED

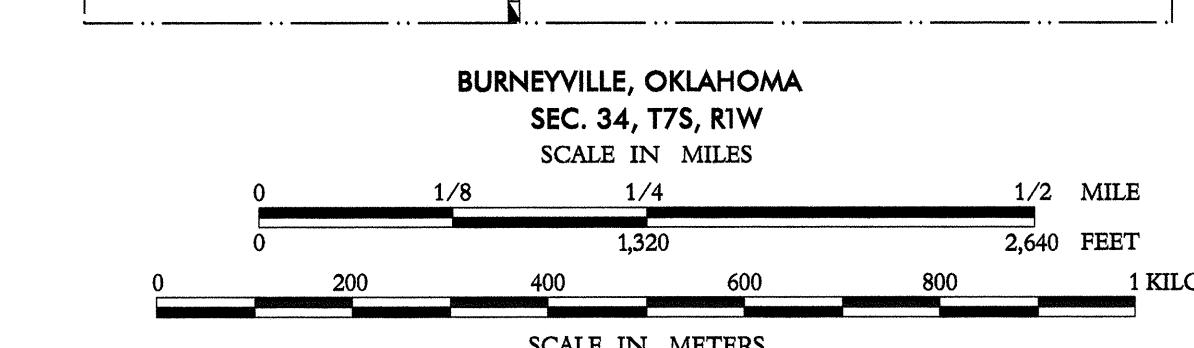
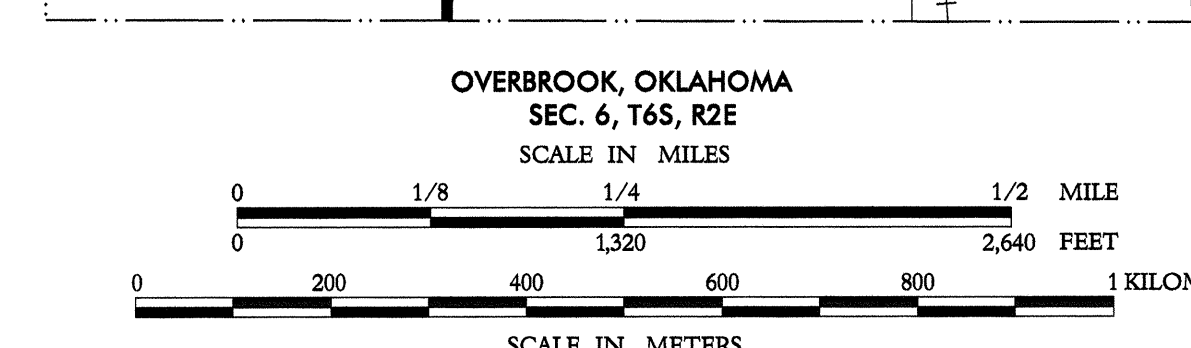
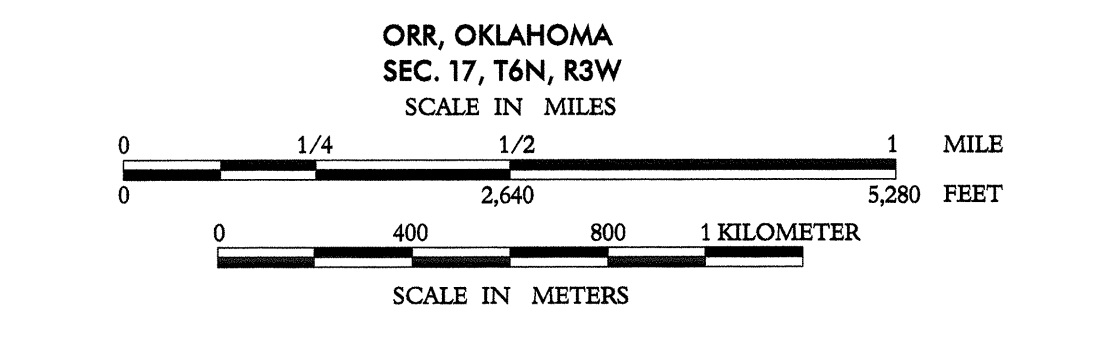
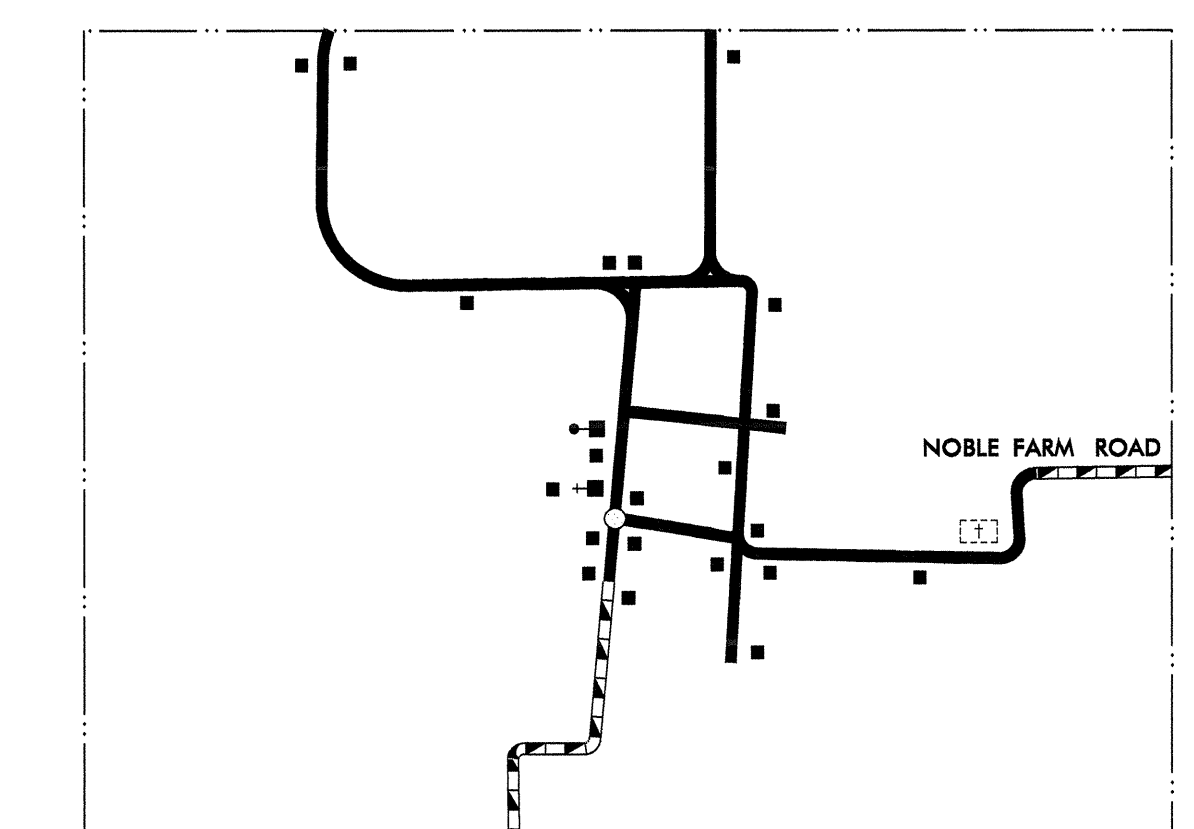
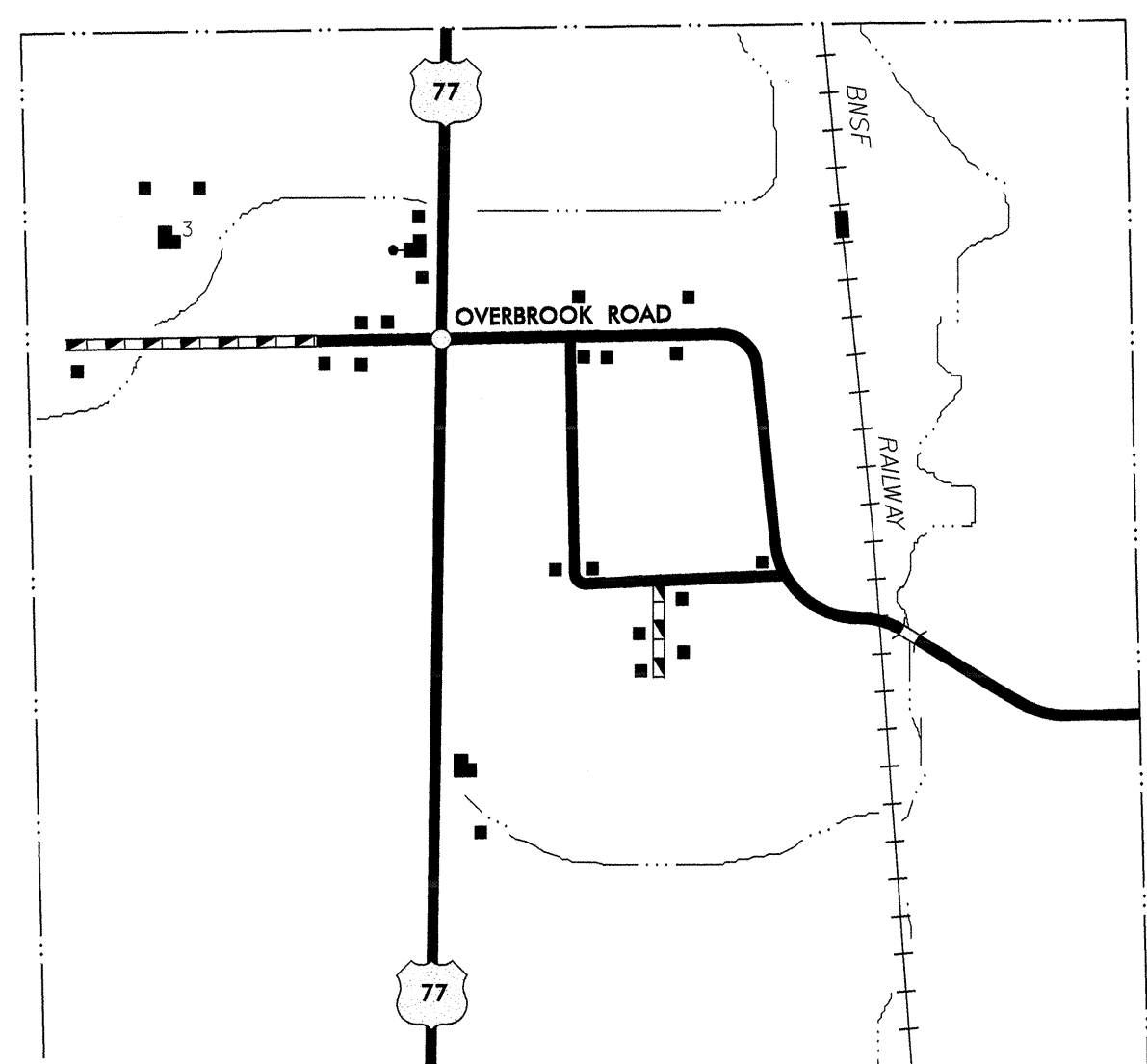
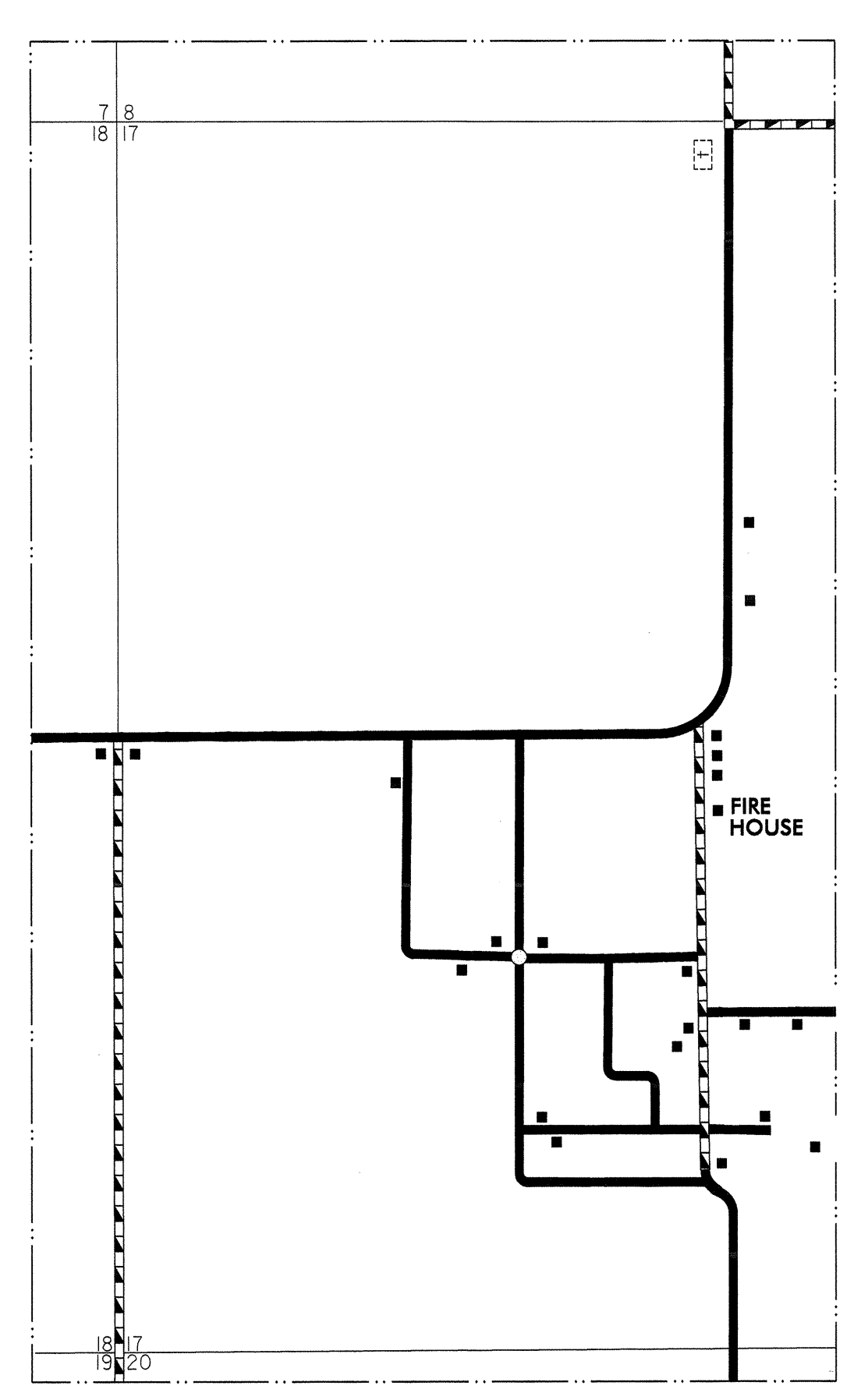

**GENERAL HIGHWAY MAP  
LOVE COUNTY  
OKLAHOMA**

PREPARED BY THE  
OKLAHOMA DEPARTMENT OF TRANSPORTATION  
PLANNING DIVISION

IN COOPERATION WITH THE  
U.S. DEPARTMENT OF TRANSPORTATION  
FEDERAL HIGHWAY ADMINISTRATION

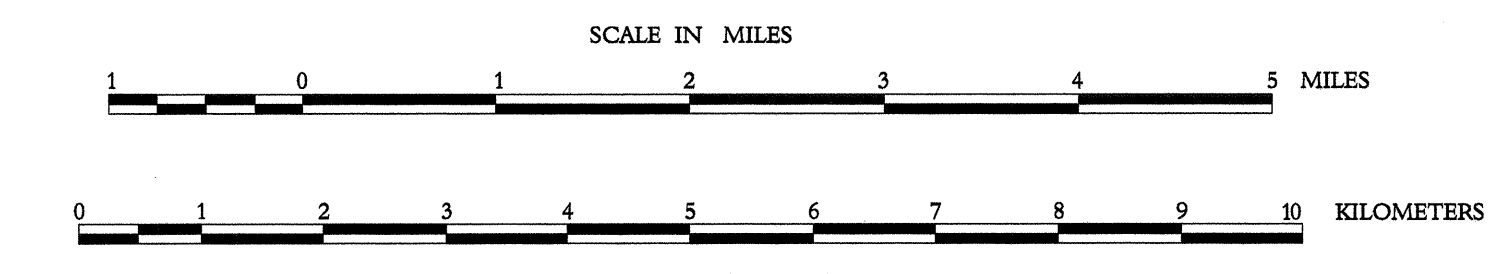

Copies of this map are available for public use at nominal cost. This map indicates those roads known to the Department to be open to public travel. Placement of a road on the map has no relationship to maintenance responsibility by any level of government.

OKLAHOMA DEPARTMENT OF TRANSPORTATION  
REPRODUCTION BRANCH Phone (405) 521-2586  
200 N.E. 21st STREET  
OKLAHOMA CITY, OKLAHOMA 73105-3204

ALL DATA CURRENT TO  
DATE OF INVENTORY  
JULY 2002  
ORIGINAL DRAFTING BY JAV, JULY 2002  
STATE SYSTEM REVISED TO JULY 2002

ALL RIGHTS RESERVED COMPUTER GENERATED

NOT FOR RESALE