

LEGEND

- U.S. NUMBERED HIGHWAY
- STATE NUMBERED HIGHWAY
- INTERSTATE HIGHWAY ROUTE
- AVIATION ROAD
- GRAVEL ROAD
- GRADED & DRAINED ROAD
- UNGRADED ROAD
- PRIVATE ROAD
- INDICATED ROAD
- RESIDENTIAL ROAD
- COUNTY ROAD NO. NO.
- RELEASE BETWEEN POINTS
- UNDIVIDED HIGHWAY, 4 OR MORE LANES
- UNDIVIDED HIGHWAY, 3 OR MORE LANES
- TRAFFIC CIRCLE
- HIGHWAY GRADE SEPARATION
- TRAFFIC INTERCHANGE
- STATE LINE
- COUNTY LINE
- CIVIL TOWNSHIP LINE
- SECTION LINE
- GOVERNMENT PROPERTY LINE
- MATCH LINE
- COUNTY SEAT
- TOWN CENTER
- CORPORATE LIMITS
- CIVIL TOWNSHIP ROAD IN PLACE
- FINEST BOUNDARY
- ELEVATION ABOVE SEA LEVEL
- MOUNTAIN RANGE, BUTTE OR MESA
- SMALL MONUMENT
- MARSH OR SWAMP LANDS
- DRAINAGE DITCH
- IRRIGATION DITCH
- LAKE, RESERVOIR OR POND WITH DAM
- ROAD OVER DAM
- DRY LAKE SUBJECT TO FLOOD
- SMALL BRIDGES CLOSELY SPACED
- HIGHWAY BRIDGE OVER 20 FT. IN LENGTH
- GENERAL BRIDGE/ROAD CROSSING
- ARCH BRIDGE
- TRUSS BRIDGE-WOODS-STEEL-CONCRETE
- CONCRETE DIP OR FORD
- FORD ROAD ESTABLISHED
- INTERMITTENT STREAM
- NARROW STREAM
- DOCK PIER OR LANDING
- NAVIGABLE STREAM WITH LOCK & DAM
- WIDE STREAM OR RIVER
- TRANSLATION STATION
- RAILROAD, ANY NUMBER OF TRACKS
- RAILROAD WITH STATION INDICATED
- GRADE CROSSING
- UNDERPASS, R.A. ABOVE
- OVERPASS, R.A. BELOW
- RAILROAD ON STREET
- MILITARY AIRFIELD
- AIRPORT WITH COMPLETE FACILITIES
- AIRPORT WITH LIMITED FACILITIES
- LANDING STRIP, PRIVATE FIELD
- AIRPORT GENERAL OUTLINE OF FIELD
- RUNWAYS SHOWN IN POSITION
- NOTE
- ROADSIDE PARK, Picnic Grounds
- PLAYGROUND
- BATHING BEACH OR SWIMMING POOL
- SCENIC SITE
- CAMP OR LODGE, Permanent with Buildings
- SMALL PARK, State, or County
- CAMP OR LODGE, Temporary
- FOREST BARRIER STRIP
- OBSERVATION OR LOOKOUT TOWER
- CAMP SITE
- FISH HATCHERY
- GOLF COURSE OR COUNTRY CLUB
- ATHLETIC FIELD OR AMUSEMENT PARK
- FRICTIONLESS RACE COURSE
- NUMBER OF DWELLINGS CLOSELY SPACED
- COMBINED BUSINESS AND DWELLING
- POST OFFICE
- POST OFFICE COMBINATIONS
- SEASONAL DWELLING
- CHURCH OR OTHER RELIGIOUS BUILDING
- CHURCH
- CHURCH WITH CEMETERY ADJACENT
- REST HOME
- HOSPITAL
- SMALL BUSINESS
- INDUSTRY
- SAW MILL
- WINE SHED OR DRIFT
- OIL OR GAS FIELD
- GASOLINE OR PUMPING STATION
- GARAGE
- QUARRY
- SCHOOL
- COMMUNITY HALL OR LODGE
- DRIVE-IN THEATER
- CORRECTIONAL INSTITUTION
- HIGHWAY GARAGE
- JUNK YARD & DRUMS A-Automobile
- 5-Store Building, Normal
- 2-Store, Garage or Truck Dump
- SEWAGE DISPOSAL PLANT
- WATER SUPPLY STAND PIPE
- POWER PLANT
- BOOSTER STATION
- POWER SUBSTATION
- TELEVISION OR RADIO STATION
- MILITARY INSTALLATION

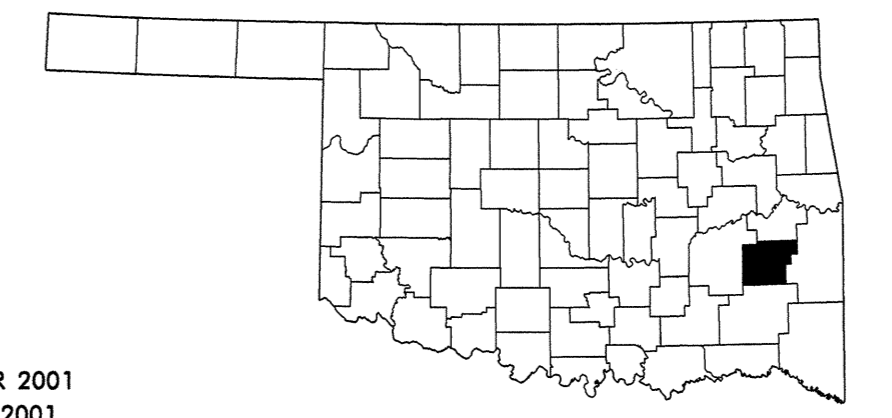
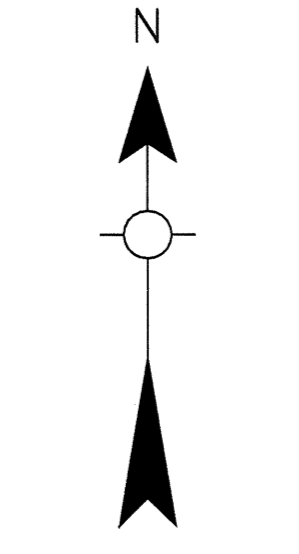
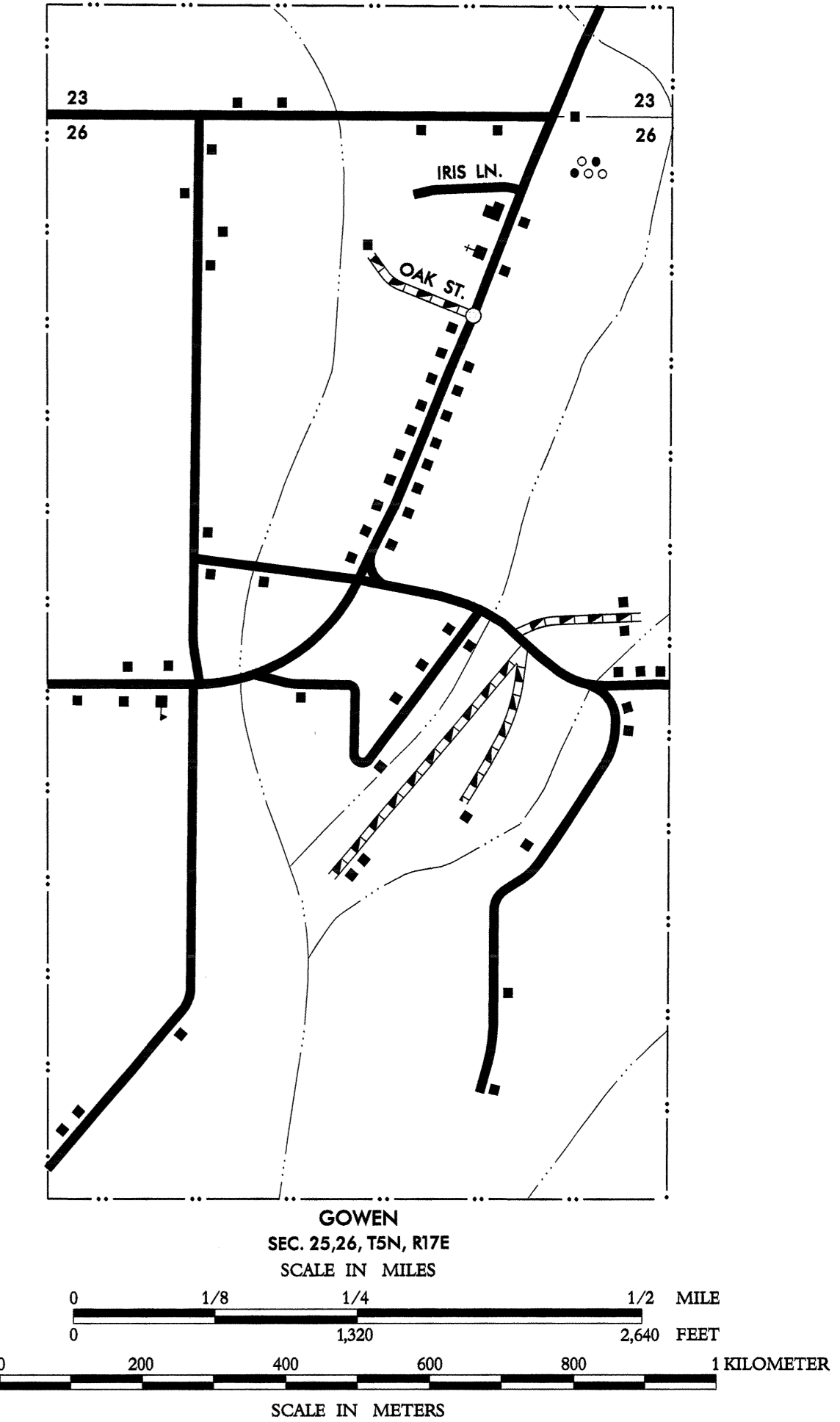
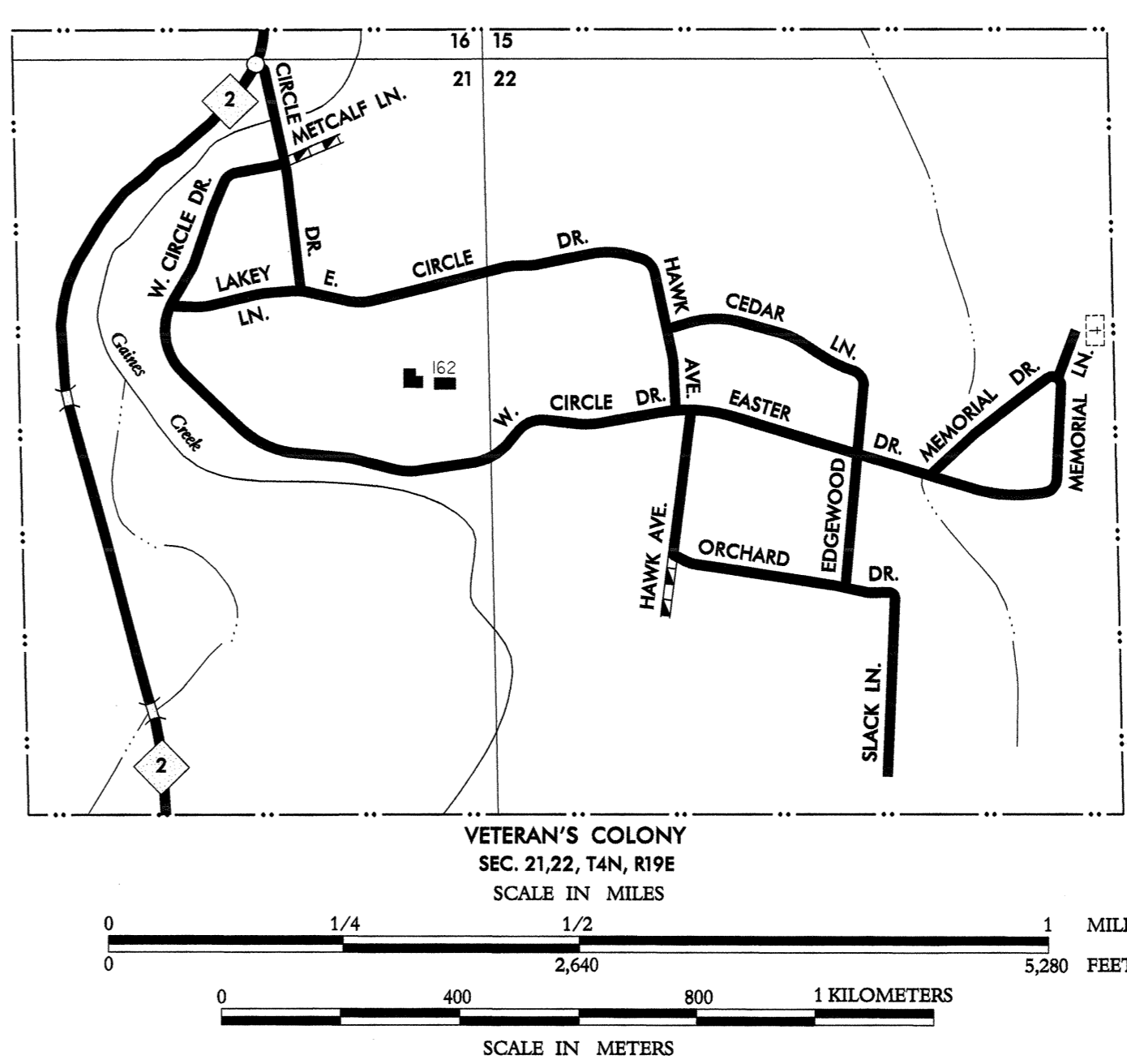
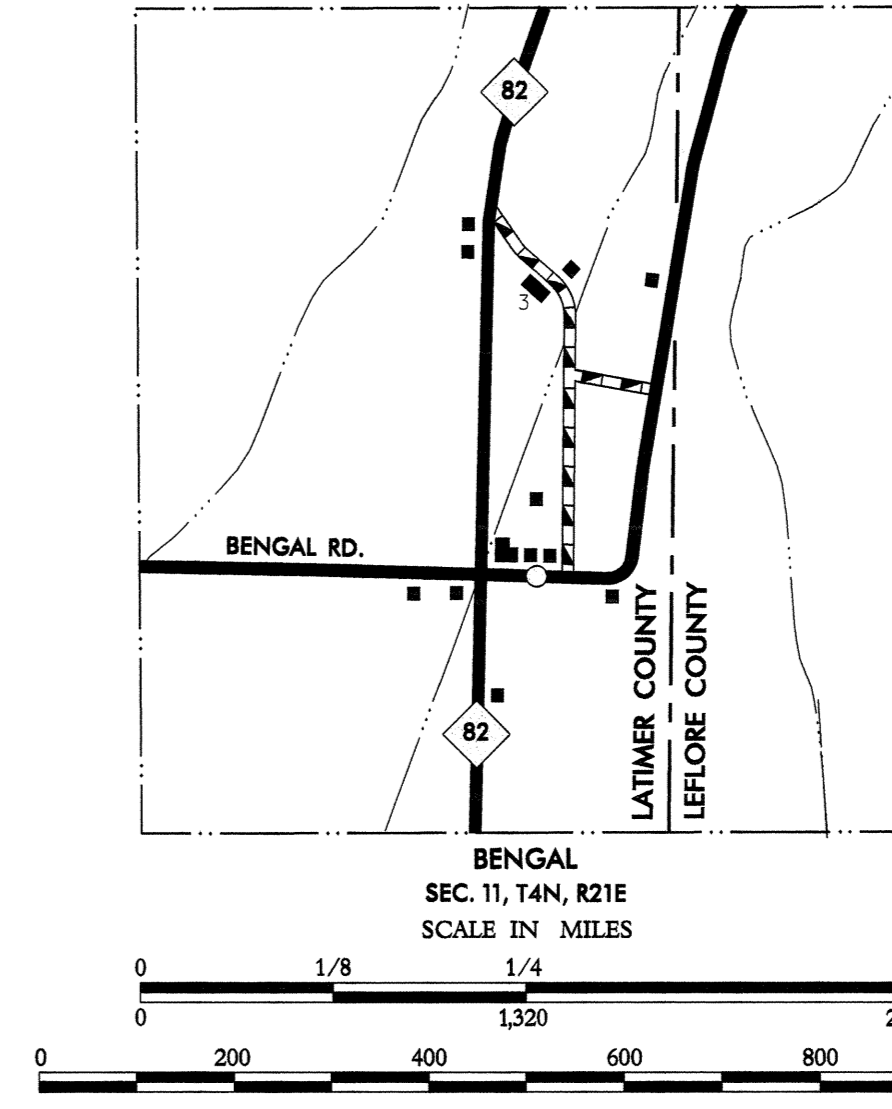

**GENERAL HIGHWAY MAP
LATIMER COUNTY
OKLAHOMA**

PREPARED BY THE
**OKLAHOMA DEPARTMENT OF TRANSPORTATION
PLANNING DIVISION**

IN COOPERATION WITH THE
**U.S. DEPARTMENT OF TRANSPORTATION
FEDERAL HIGHWAY ADMINISTRATION**

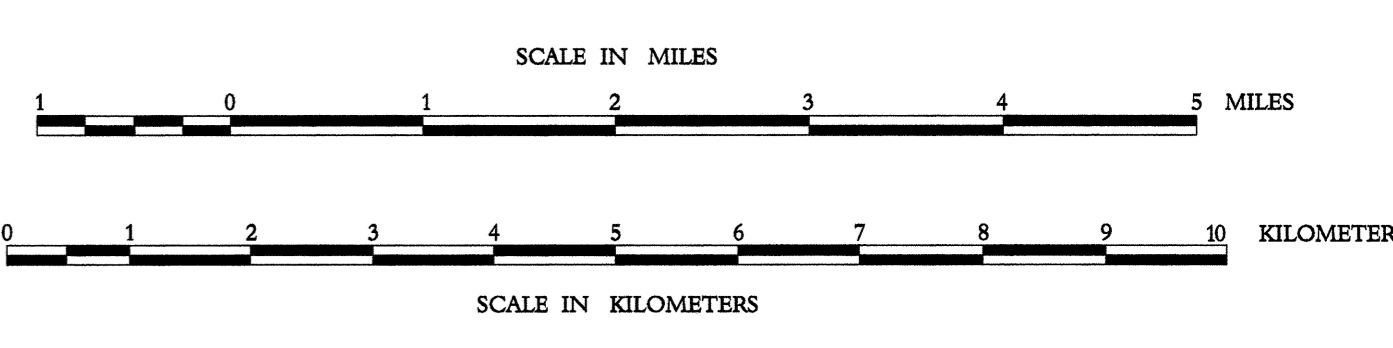

ALL DATA CURRENT TO
DATE OF INVENTORY
MARCH 2001
ORIGINAL DRAFTING BY WAT, NOVEMBER 2001
STATE SYSTEM REVISED TO NOVEMBER 2001

LAMBERT CONFORMAL CONIC PROJECTION U.S. & GEODETIC SURVEY DATA
20,000 FOOT GRID, OKLAHOMA PLANE COORDINATE SYSTEM, SOUTH PROJECTION ZONE
POPULATION FIGURES BASED ON 2000 U.S. CENSUS
CO. POP. 10,492

Copies of this map are available for public use at nominal cost.
This map indicates those roads known to the Department to be open to public travel. Placement of a road on the map has no relationship to maintenance responsibility by any level of government.
Address:
OKLAHOMA DEPARTMENT OF TRANSPORTATION
REPRODUCTION BRANCH Phone (405) 521-2586
200 N.E. 21st STREET
OKLAHOMA CITY, OKLAHOMA 73105-3204