

LEGEND

- RAILROAD, ANY NUMBER OF TRACKS
- RAILROAD WITH STATION INDICATED
- GRADE CROSSING
- UNDERPASS, & ABOVE
- OVERPASS, & BELOW
- RAILROAD ON STREET
- MILITARY AIRFIELD
- AIRPORT WITH COMPLETE FACILITIES
- AIRPORT WITH LIMITED FACILITIES
- LANDING STRIP, PRIVATE FIELD
- AIRPORT, GENERAL OUTLINE OF FIELD
- RUNWAYS SHOWN IN POSITION
- ROADSIDE PARK Public Grounds
- RANGELANDS
- BATHING BEACH OR SWIMMING POOL
- CAMP OR LODGE, Permanent with buildings
- SCENIC SITE
- WATER TOWER
- SHALL PARK SP-3000, CA-County
- FOREST RANGER STATION
- OBSERVATION OR LOOKOUT TOWER
- CAMP SITE
- RSH HATCHERY
- DOG CLUBS OR COUNTRY CLUB
- ATHLETIC FIELD OR AMUSEMENT PARK
- PARKLANDS, RACE COURSE
- DWELLING NUMBER OF DWELLINGS CLOSELY SPACED
- COMBINED BUSINESS AND DWELLING
- POST OFFICE
- POST OFFICE COMBINATIONS
- SEASONAL DWELLINGS
- CHURCH OR OTHER RELIGIOUS BUILDING
- CEMETERY
- CHURCH WITH CEMETERY ADJACENT
- REST HOME
- HOSPITAL
- SMALL BUSINESS
- INDUSTRY
- SAW MILL
- MINE SHAFT OR DRIFT
- OIL OR GAS FIELD
- QUARRY OR PAVING STATION
- WAREHOUSE
- DRAWING
- SCHOOL
- COMMUNITY HALL OR LODGE
- DIVE-IN THEATER
- CONVENTIONAL INSTITUTION
- HIGHWAY GRADE
- JUNK YARDS & DUMPS A-Airborne, B-Building, C-Covered, D-Makes, Garbage or trash dump, E-Industry, F-Fuel, G-Gas
- SEWAGE DISPOSAL PLANT
- WATER SUPPLY STAND PIPE
- POWER PLANT
- BOILER STATION
- POWER SUBSTATION
- TELEVISION OR RADIO STATION
- MILITARY INSTALLATION

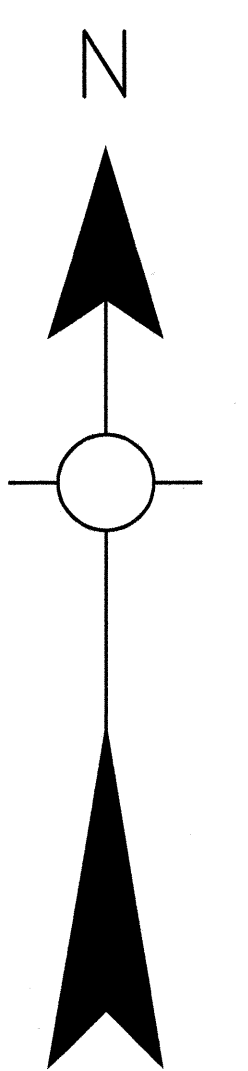
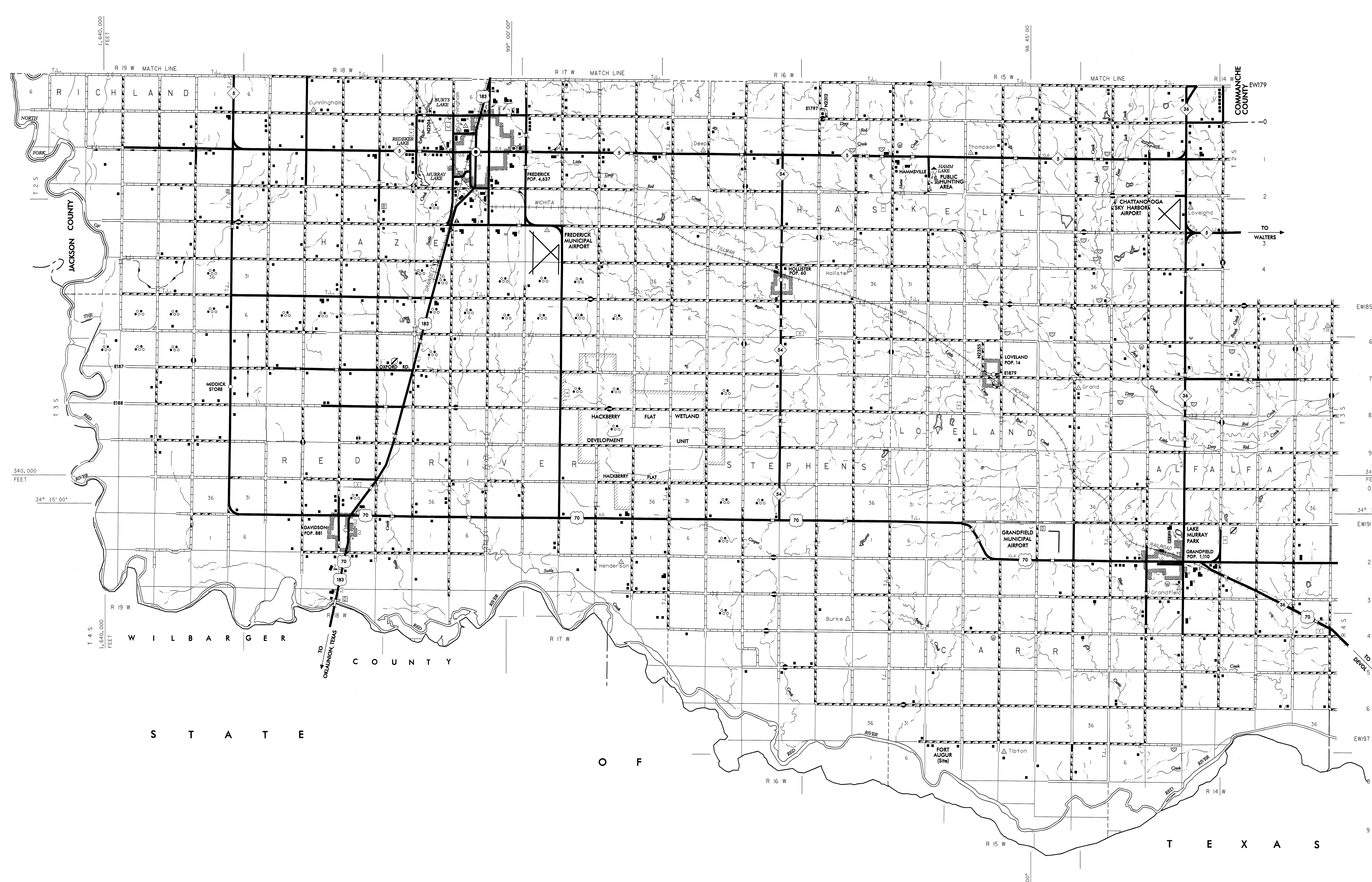

**GENERAL HIGHWAY MAP
TILLMAN COUNTY
OKLAHOMA**

PREPARED BY THE
**OKLAHOMA DEPARTMENT OF TRANSPORTATION
PLANNING DIVISION**

IN COOPERATION WITH THE
**U.S. DEPARTMENT OF TRANSPORTATION
FEDERAL HIGHWAY ADMINISTRATION**

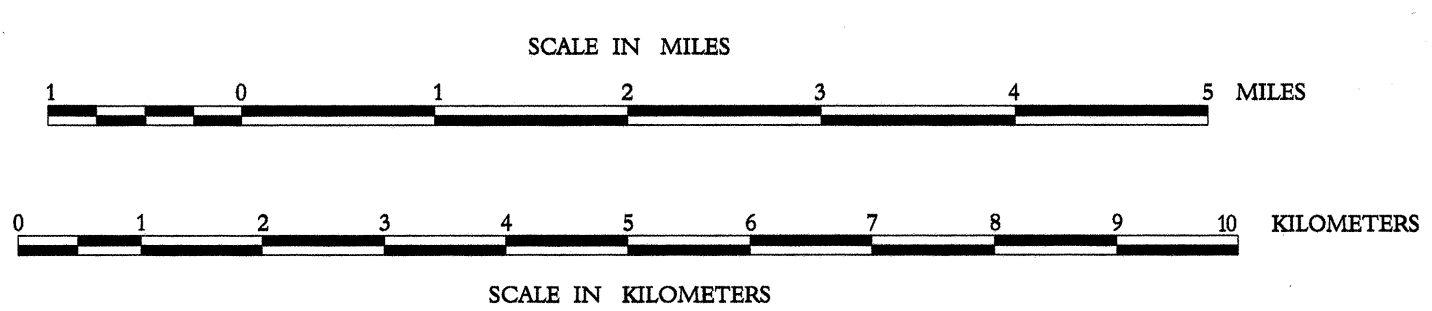

ALL DATA CURRENT TO
DATE OF INVENTORY
AUGUST 2000
ORIGINAL DRAWING BY JAN. AUGUST 2002
STATE SYSTEM REVISED TO AUGUST 2002

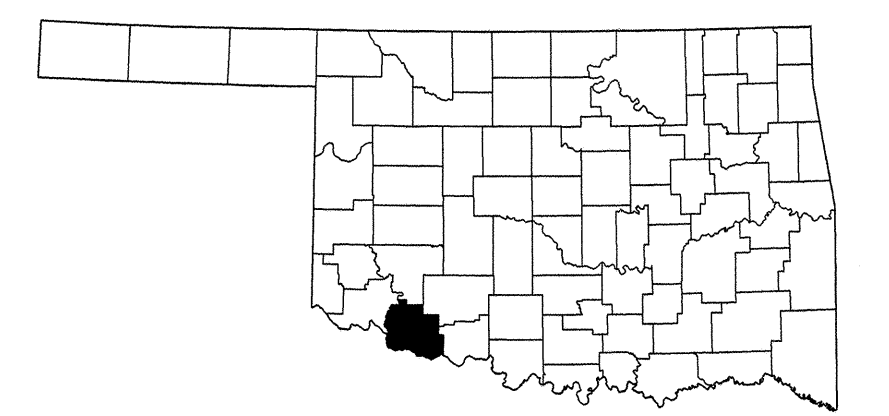

SHEET 1 OF 2 SHEETS

Copies of this map are available for public use at nominal cost.
Address: OKLAHOMA DEPARTMENT OF TRANSPORTATION
PRINTING SERVICES PHONE (405) 521-2586
200 N.E. 21st STREET
OKLAHOMA CITY, OKLAHOMA 73105-3204

This map indicates those roads known to the Department to be open to public travel. Placement of a road on the map has no relationship to maintenance responsibility by any level of government.

NOT FOR RESALE