

**TYPICAL CROSS SECTION**

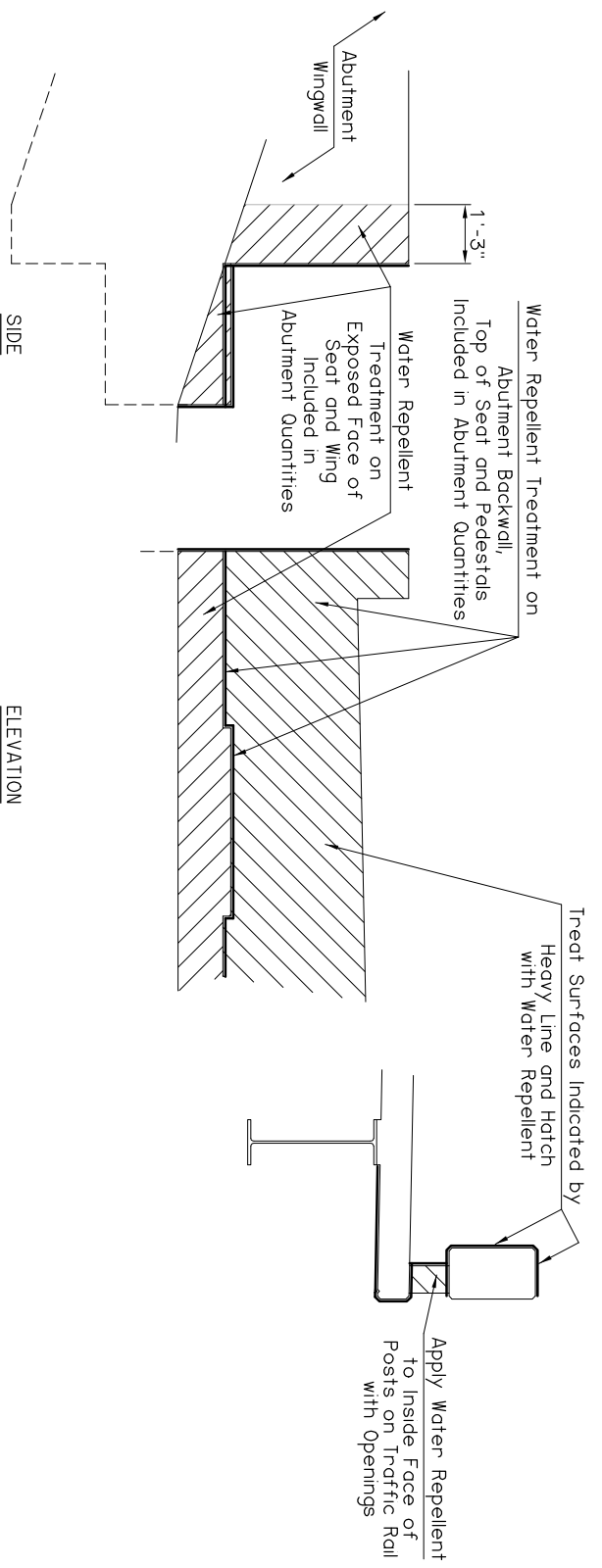

**BEAM HAUNCH DETAIL**

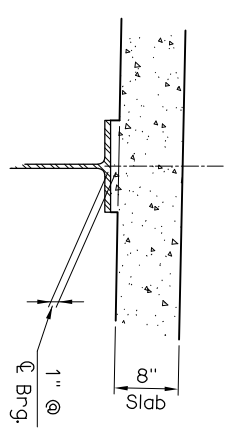

NOTE:  
Plan quantities for CLASS AA CONCRETE include Beam Haunches. Haunch height shown is at centerline bearing only, measured from bottom of Deck Slab to top of Beam, and varies across the span. Haunch height to be determined after erection of beams to provide for dead load deflection and grade adjustment, but the poy quantity will be as shown on the plans.

**ABUTMENT WATER REPELLENT TREATMENT DETAILS**

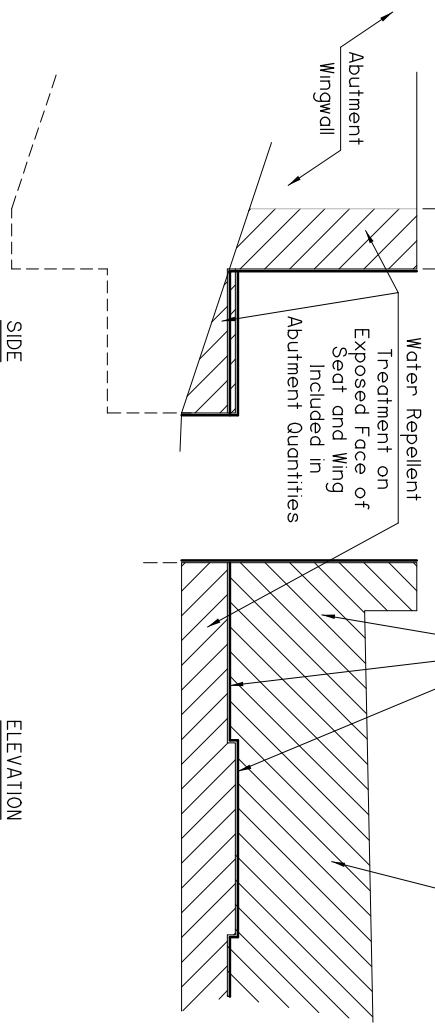

APPROVED BY BRIDGE ENGINEER	DATE
<i>Chad Head</i>	8/18/03
OKLAHOMA DEPT. OF TRANSPORTATION BRIDGE STANDARD (ENGLISH)	
TYPICAL CROSS SECTION ROLLED BEAMS CONVENTIONAL	
1999 SPECIFICATIONS	B40-C-XSECT-RB
OOE	B-263E