

DETAIL OF WELDED SPLICE  
(TYPICAL SECTION THRU FLANGE & WEB)

- 2 - 3/4" X 7 7/8" X 1'-0" PLATES (HP 10 X 42)
- 2 - 3/4" X 9 3/4" X 1'-0" PLATES (HP 12 X 53)
- 2 - 3/4" X 11 3/8" X 1'-0" PLATES (HP 14 X 73)

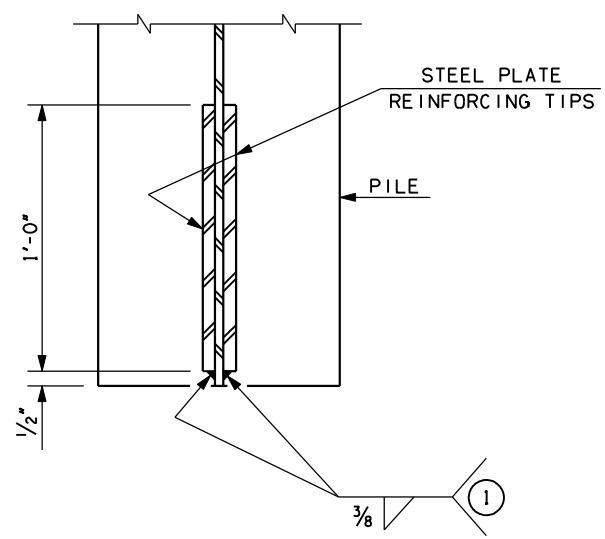
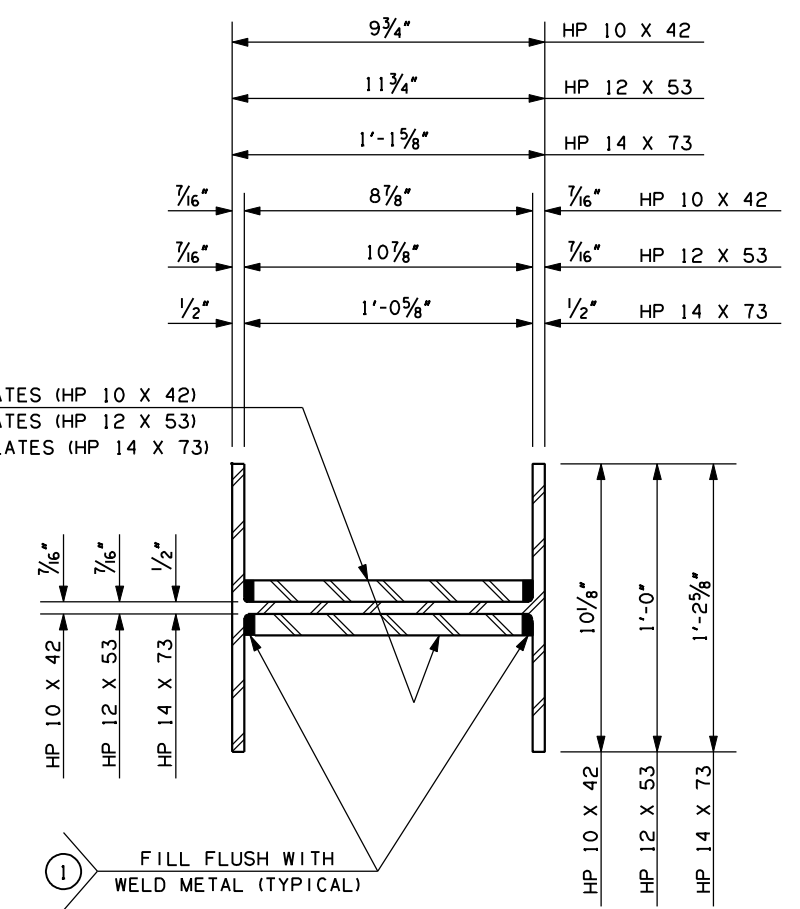

① STEEL PLATE REINFORCING TIPS MAY BE WELDED IN THE SHOP OR IN THE FIELD

ALL STEEL PILING SHALL HAVE STEEL PLATE REINFORCING TIPS UNLESS SPECIFICALLY DELETED BY NOTES IN THE PROJECT PLANS AND SPECIFICATIONS.

△ THE CONTRACTOR MAY USE MANUFACTURED DRIVING TIPS AS AN ALTERNATIVE TO THE STEEL PLATE REINFORCING TIPS SHOWN, WITH THE APPROVAL BY THE BRIDGE ENGINEER. ALL COSTS OF PILE TIPS SHALL BE INCLUDED IN THE PRICE BID PER LINEAR FEET OF "STEEL PILING FURNISHED".

APPROVED BY BRIDGE ENGINEER *Robert J. Neuch* DATE 3-23-00

**OKLAHOMA DEPT. OF TRANSPORTATION  
BRIDGE STANDARD (ENGLISH)**

STEEL PILING

1999 SPECIFICATIONS

HP1-1	OIE
B-11E	