

| PIER CAP REINFORCING AND QUANTITY SCHEDULE |             |     |        |      |     |        |      |     |        |      |     |                                    |                        |        |
|--|-------------|-----|--------|------|-----|--------|------|-----|--------|------|-----|------------------------------------|------------------------|--------|
| CAP TYPE                                   | REINFORCING |     |        |      |     |        |      |     |        |      |     | QUANTITIES                         |                        |        |
|  | H1          |     |        | H2   |     |        | H3   |     |        | S    |     | CLASS S CONCRETE (m <sup>3</sup> ) | REINFORCING STEEL (kg) |        |
|  | SIZE        | NO. | LENGTH | SIZE | NO. | LENGTH | SIZE | NO. | LENGTH | SIZE | NO. |                                    |                        | LENGTH |
| CAP 1                                      | #29         | 3   | 9460   | #16  | 6   | 8700   | #29  | 5   | 8700   | #13  | 33  | 4030                               | 9.5                    | 577    |
| CAP 2                                      | #29         | 5   | 10 760 | #16  | 6   | 10 000 | #29  | 5   | 10 000 | #13  | 37  | 4030                               | 10.9                   | 767    |
| CAP 3                                      | #32         | 5   | 11 460 | #16  | 6   | 10 600 | #29  | 6   | 10 600 | #13  | 61  | 4030                               | 11.6                   | 1032   |
| CAP 4                                      | #36         | 5   | 13 060 | #16  | 6   | 12 100 | #36  | 5   | 12 100 | #13  | 64  | 4030                               | 13.2                   | 1364   |

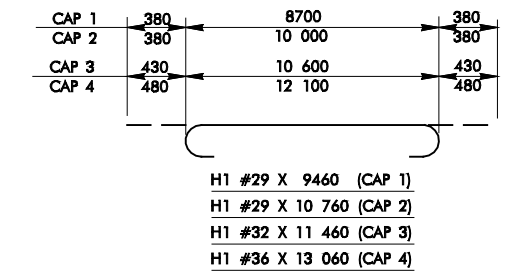
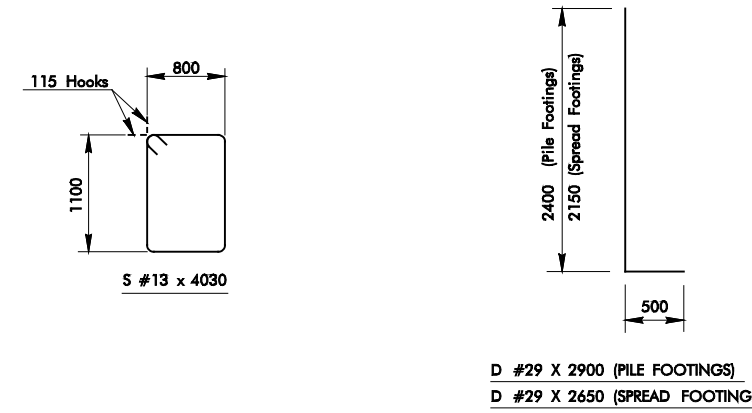

H1 #29 X 9460 (CAP 1)  
H1 #29 X 10 760 (CAP 2)  
H1 #32 X 11 460 (CAP 3)  
H1 #36 X 13 060 (CAP 4)

| PIER CAP DOWEL REINFORCING                     |              |     |        |                            |
|--|--------------|-----|--------|----------------------------|
| SUPERSTRUCTURE                                 | SMOOTH DOWEL |     |        | QUANTITY REINF. STEEL (kg) |
|  | SIZE         | NO. | LENGTH |                            |
| 8m NOMINAL ROADWAY DOUBLE TEE TYPE A, B, OR C  | 20 mm #      | 18  | 600    | 27                         |
| 8m NOMINAL ROADWAY DOUBLE TEE TYPE D OR E      | 20 mm #      | 19  | 600    | 28                         |
| 10m NOMINAL ROADWAY DOUBLE TEE TYPE A, B, OR C | 20 mm #      | 23  | 600    | 34                         |
| 10m NOMINAL ROADWAY DOUBLE TEE TYPE D OR E     | 20 mm #      | 23  | 600    | 34                         |
| 8m NOMINAL ROADWAY PAN GIRDERS                 | 20 mm #      | 10  | 600    | 15                         |
| 10m NOMINAL ROADWAY PAN GIRDERS                | 20 mm #      | 12  | 600    | 18                         |

| PILE FOOTING REINFORCING AND QUANTITY SCHEDULE |      |                          |               |     |        |      |     |        |      |     |        |      |     |                                    |                        |        |
|--|------|--------------------------|---------------|-----|--------|------|-----|--------|------|-----|--------|------|-----|------------------------------------|------------------------|--------|
| FOOTING TYPE                                   | FT1  | NO. OF PILES PER FOOTING | REINFORCING ④ |     |        |      |     |        |      |     |        |      |     | QUANTITIES ⑤                       |                        |        |
|  |      |                          | F1            |     |        | F2   |     |        | D    |     |        | CT   |     | CLASS A CONCRETE (m <sup>3</sup> ) | REINFORCING STEEL (kg) |        |
|  |      |                          | SIZE          | NO. | LENGTH | SIZE | NO. | LENGTH | SIZE | NO. | LENGTH | SIZE | NO. |                                    |                        | LENGTH |
| PF1  | 2100 | 4                        | #19           | 36  | 1950   | #16  | 24  | 1950   | #29  | 14  | 2900   | #13  | 8   | 2515                               | 8.8                    | 455    |
| PF2  | 2400 | 4                        | #19           | 40  | 2250   | #16  | 24  | 2250   | #29  | 14  | 2900   | #13  | 8   | 2515                               | 11.5                   | 510    |
| PF3  | 2400 | 4                        | #19           | 40  | 2250   | #16  | 24  | 2250   | #29  | 28  | 2900   | #13  | 8   | 2515                               | 11.5                   | 716    |
| PF4  | 2400 | 5                        | #22           | 40  | 2250   | #16  | 36  | 2250   | #29  | 14  | 2900   | #13  | 8   | 2515                               | 11.5                   | 625    |
| PF5  | 2400 | 5                        | #22           | 40  | 2250   | #16  | 36  | 2250   | #29  | 28  | 2900   | #13  | 8   | 2515                               | 11.5                   | 830    |
| PF6  | 2700 | 5                        | #25           | 48  | 2550   | #16  | 36  | 2550   | #29  | 14  | 2900   | #13  | 8   | 2515                               | 14.6                   | 854    |
| PF7  | 2700 | 5                        | #29           | 48  | 2550   | #16  | 36  | 2550   | #29  | 28  | 2900   | #13  | 8   | 2515                               | 14.6                   | 1193   |

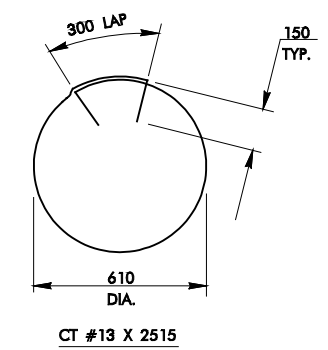

| SPREAD FOOTING REINFORCING AND QUANTITY SCHEDULE |      |               |     |        |         |      |     |        |      |     |        |                                    |                        |
|--|------|---------------|-----|--------|---------|------|-----|--------|------|-----|--------|------------------------------------|------------------------|
| FOOTING TYPE                                     | FT1  | REINFORCING ④ |     |        |         |      |     |        |      |     |        | QUANTITIES ⑤                       |                        |
|  |      | F1            |     |        |         | D    |     |        | CT   |     |        | CLASS A CONCRETE (m <sup>3</sup> ) | REINFORCING STEEL (kg) |
|  |      | SIZE          | NO. | LENGTH | SPACING | SIZE | NO. | LENGTH | SIZE | NO. | LENGTH |                                    |                        |
| SF1  | 2100 | #22           | 32  | 1950   | 275     | #29  | 14  | 2650   | #13  | 6   | 2515   | 6.6                                | 393                    |
| SF2  | 2250 | #22           | 32  | 2100   | 300     | #29  | 14  | 2650   | #13  | 6   | 2515   | 7.6                                | 407                    |
| SF3  | 2400 | #22           | 36  | 2250   | 275     | #29  | 14  | 2650   | #13  | 6   | 2515   | 8.6                                | 449                    |
| SF4  | 2400 | #22           | 36  | 2250   | 275     | #29  | 28  | 2650   | #13  | 6   | 2515   | 8.6                                | 637                    |
| SF5  | 2550 | #25           | 36  | 2400   | 300     | #29  | 14  | 2650   | #13  | 6   | 2515   | 9.8                                | 546                    |
| SF6  | 2550 | #25           | 36  | 2400   | 300     | #29  | 28  | 2650   | #13  | 6   | 2515   | 9.8                                | 734                    |
| SF7  | 2700 | #25           | 40  | 2550   | 275     | #29  | 14  | 2650   | #13  | 6   | 2515   | 10.9                               | 608                    |
| SF8  | 2700 | #25           | 40  | 2550   | 275     | #29  | 28  | 2650   | #13  | 6   | 2515   | 10.9                               | 796                    |
| SF9  | 2850 | #25           | 40  | 2700   | 300     | #29  | 28  | 2650   | #13  | 6   | 2515   | 12.2                               | 820                    |

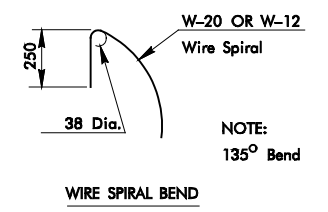

| COLUMN REINFORCING AND QUANTITY SCHEDULE |               |     |         |      |     |  |                                      |                                 |
|--|---------------|-----|---------|------|-----|--|--------------------------------------|---------------------------------|
| COLUMN TYPE                              | REINFORCING ① |     |         |      |     |  | QUANTITIES ③                         |                                 |
|  | CV            |     |         | CS ② |     |  | CLASS S CONCRETE (m <sup>3</sup> /m) | REINFORCING STEEL (kg AND kg/m) |
|  | SIZE          | NO. | LENGTH  | SIZE | NO. | LENGTH   |                                      |                                 |
| COL 1                                    | #29           | 14  | H - 100 | W-20 | 2   | $\left[ \frac{H - 1200}{150} \right] \times 1891 + 4270$ | 0.91                                 | 87 kg + 96.5 kg/m               |
| COL 2                                    | #29           | 28  | H - 100 | W-20 | 2   | $\left[ \frac{H - 1200}{150} \right] \times 1891 + 4270$ | 0.91                                 | 165 kg + 167 kg/m               |

| DRILLED SHAFT REINFORCING AND QUANTITY SCHEDULE |                   |     |        |      |     |        |      |     |        |      |     |   |
|---|-------------------|-----|--------|------|-----|--------|------|-----|--------|------|-----|---|
| DRILLED SHAFT TYPE                              | REINFORCING ④ ⑥ ⑦ |     |        |      |     |        |      |     |        |      |     | LENGTH  |
|   | D                 |     |        | CT   |     |        | DV   |     |        | DS   |     |   |
|   | SIZE              | NO. | LENGTH | SIZE | NO. | LENGTH | SIZE | NO. | LENGTH | SIZE | NO. |   |
| DS1   | #29               | 14  | 2700   | #13  | 10  | 2515   | #29  | 22  | L-150  | W-12 | 2   | $\left[ \frac{L-150}{150} \right] \times 2361 + 5212$ |
| DS2   | #29               | 28  | 2700   | #13  | 10  | 2515   | #29  | 22  | L-150  | W-12 | 2   | $\left[ \frac{L-150}{150} \right] \times 2361 + 5212$ |

- ① COLUMN REINFORCING SHOWN IS FOR TWO COLUMNS
- ② FOR EACH SPLICE OF COLUMN SPIRAL ADD 800 mm TO THE SCHEDULED LENGTH
- ③ THE TOTAL QUANTITIES SHOWN ARE FOR TWO COLUMNS AND THE UNIT/METER QUANTITIES SHOWN ARE BASED UPON THE QUANTITIES CONTAINED IN TWO COLUMNS PER METER OF HEIGHT OF COLUMN.

- ④ REINFORCING SHOWN IS FOR TWO FOOTINGS OR DRILLED SHAFTS
- ⑤ QUANTITIES SHOWN ARE FOR TWO FOOTINGS.
- ⑥ INCLUDED IN PRICE BID PER METER OF DRILLED SHAFT
- ⑦ L = DRILLED SHAFT LENGTH (mm)

APPROVED BY BRIDGE ENGINEER \_\_\_\_\_ DATE \_\_\_\_\_

**OKLAHOMA DEPT. OF TRANSPORTATION  
COUNTY BRIDGE DIVISION STANDARD (METRIC)  
PIER SCHEDULES  
FOR PIERS UNDER  
DOUBLE TEES**

1999 SPECIFICATIONS PIER3-1 OOM

ALL DIMENSIONS ON THIS SHEET IN MILLIMETERS UNLESS OTHERWISE NOTED. CB-23M