

Legend

- Highways
- Asphalt
- Concrete
- Gravel
- Grade & Drain
- Unimproved
- Road Common
- Local Roads
- Railroad
- River or Stream
- Corporate Limit
- TULSA
- County Line
- Section Line
- Wildlife Management Area
- Wildlife Refuge
- Lake or Reservoir
- Bridges
- Low Water Crossing

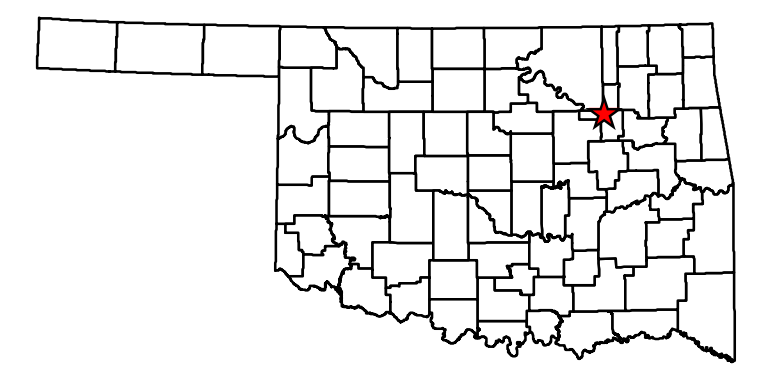
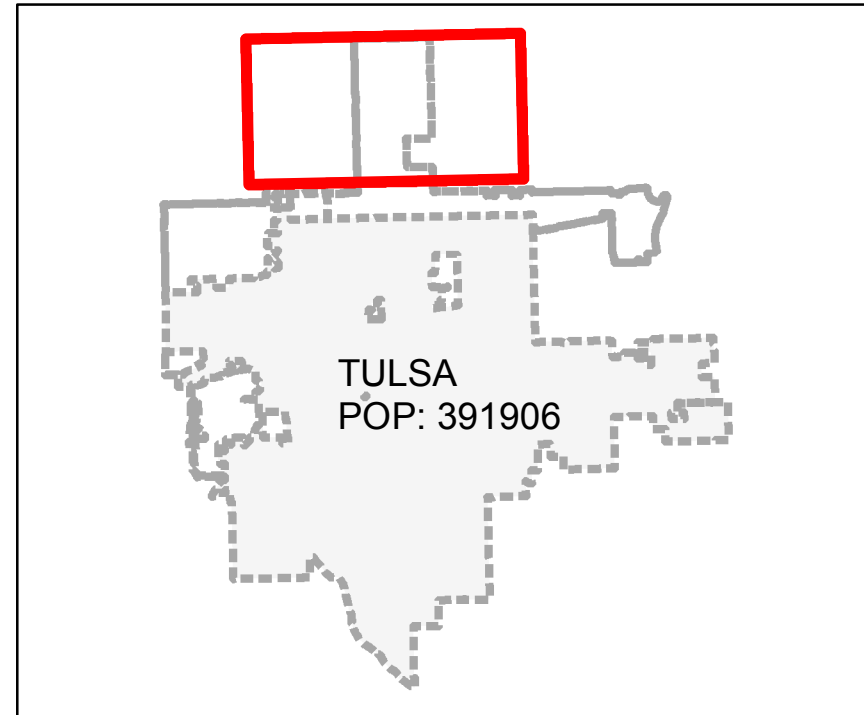

**STATE OF OKLAHOMA
DEPARTMENT OF TRANSPORTATION**

**CITY OF
TULSA
TULSA COUNTY**

CENSUS YEAR 2010
POPULATION 391,906

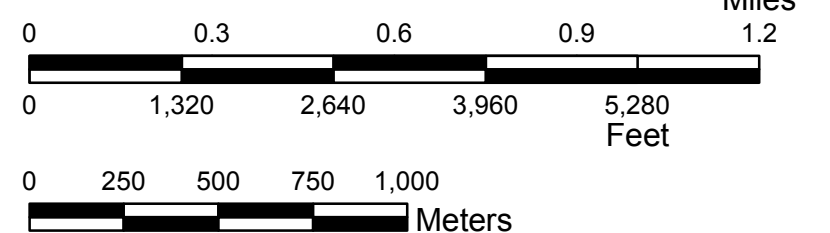

Copies of this map are available for public use at nominal cost.
Address:
OKLAHOMA DEPARTMENT OF TRANSPORTATION
PRINTING SERVICES Phone (405) 521-2586
200 N.E. 21st STREET
OKLAHOMA CITY, OKLAHOMA 73105-3204

This map indicates those roads known to the Department to be open to public travel. Placement of a road on the map has no relationship to maintenance responsibility by any level of government.

© COPYRIGHT 2018
PRINTED AT STATE EXPENSE

NOT FOR RESALE

ALL RIGHTS RESERVED COMPUTER GENERATED September, 2018

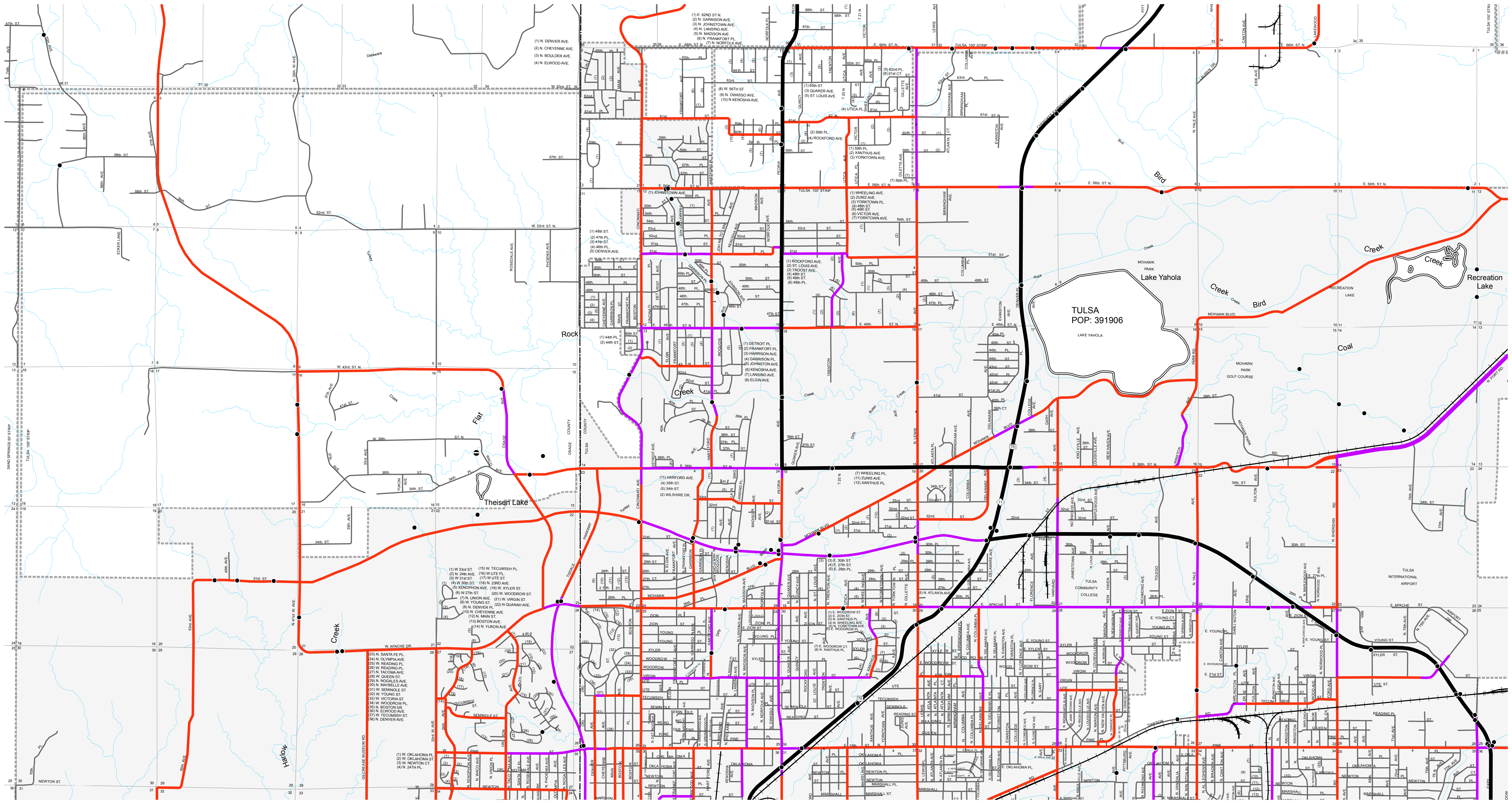

Legend

- Highways
- Asphalt
- Concrete
- Gravel
- Grade & Drain
- Unimproved
- Road Common
- Local Roads
- Railroad
- River or Stream
- Corporate Limit
- TULSA
- County Line
- Section Line
- Wildlife Management Area
- Wildlife Refuge
- Lake or Reservoir
- Bridges
- Low Water Crossing

Copies of this map are available for public use at nominal cost.
 Address:
 OKLAHOMA DEPARTMENT OF TRANSPORTATION
 PRINTING SERVICES Phone (405) 521-2586
 200 N.E. 21st STREET
 OKLAHOMA CITY, OKLAHOMA 73105-3204

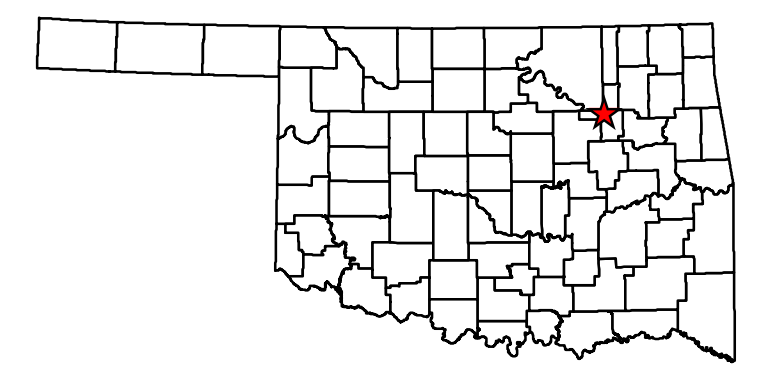
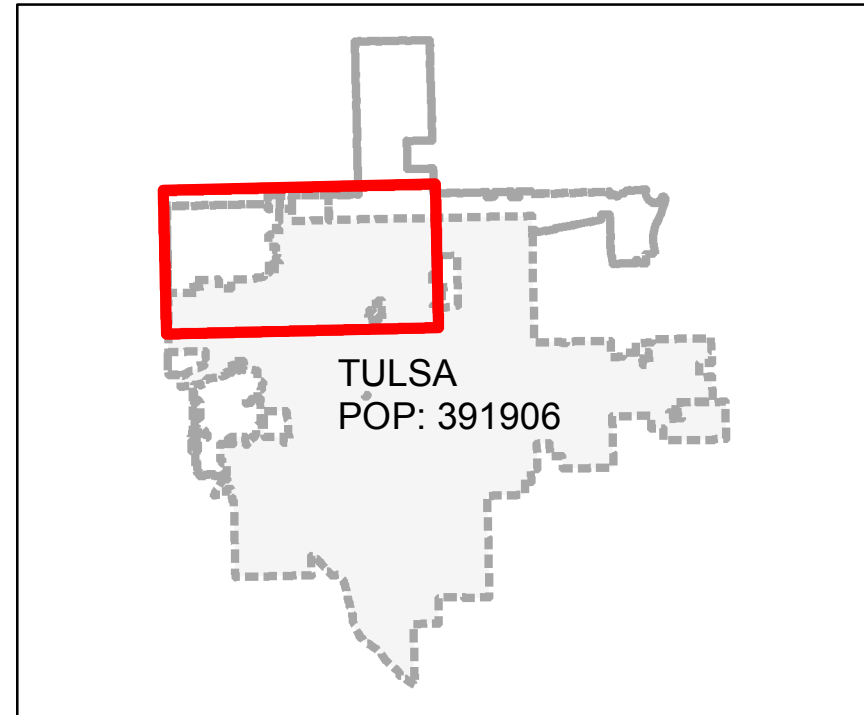

**STATE OF OKLAHOMA
 DEPARTMENT OF TRANSPORTATION**

**CITY OF
 TULSA
 TULSA COUNTY**

CENSUS YEAR 2010
 POPULATION 391,906

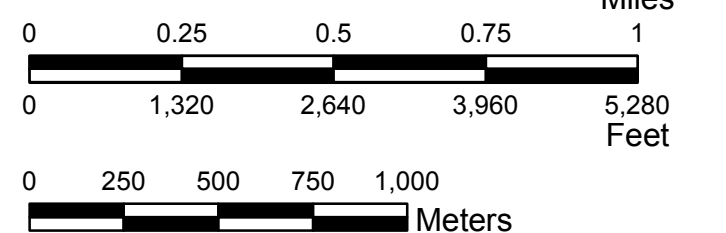

This map indicates those roads known to the Department to be open to public travel. Placement of a road on the map has no relationship to maintenance responsibility by any level of government.

© COPYRIGHT 2018
 PRINTED AT STATE EXPENSE

NOT FOR RESALE

ALL RIGHTS RESERVED COMPUTER GENERATED September, 2018

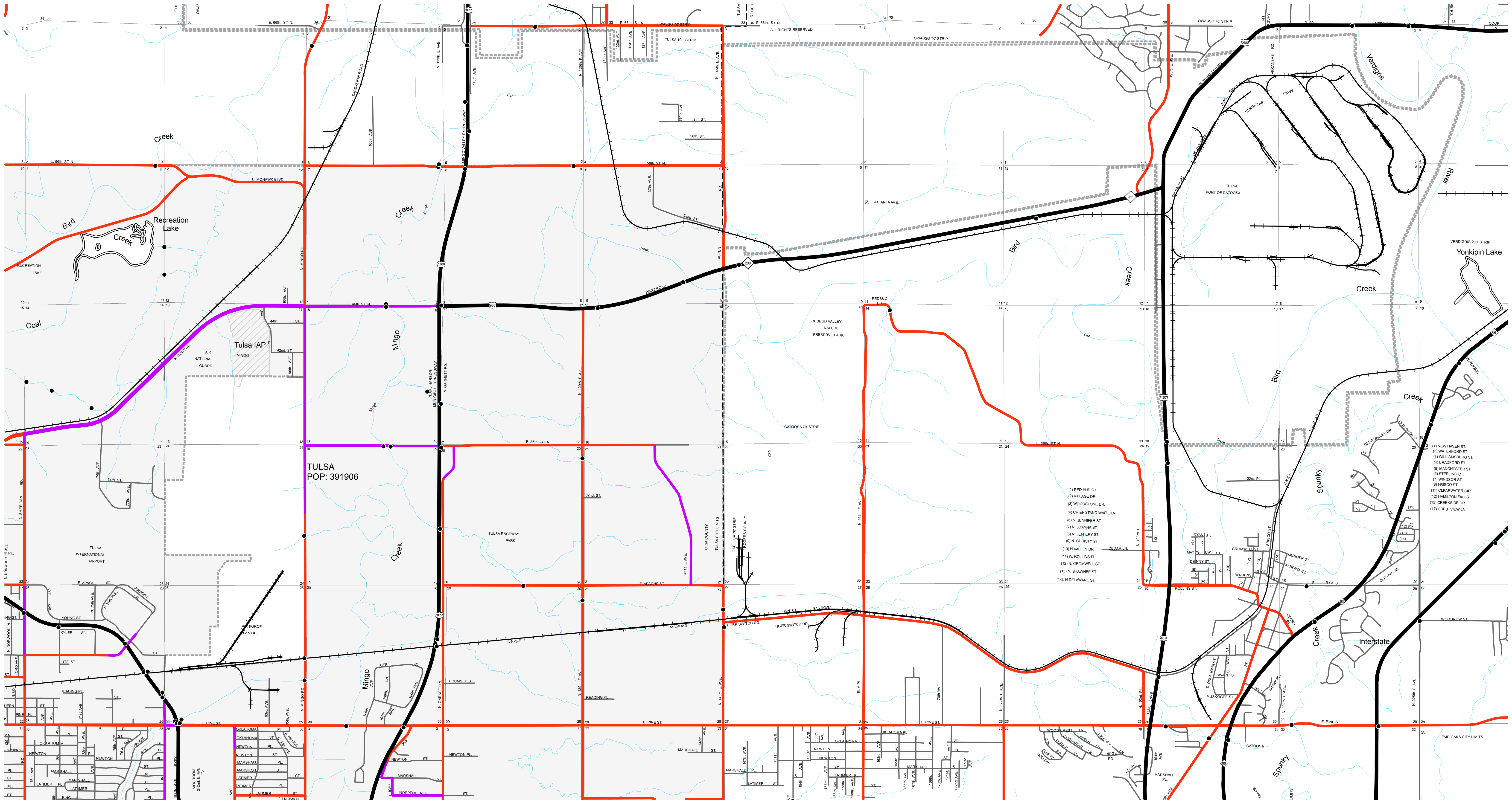

TULSA
POP: 391906

- (1) RED BLVD CT.
- (2) VILLAGE DR.
- (3) WOODSTONE DR.
- (4) CHIEF STAND WASTE LN.
- (5) N. JENNIFER ST.
- (6) N. JOANNA ST.
- (7) N. JEFFERY ST.
- (8) N. CHRISTY ST.
- (9) N. WILLEY DR.
- (10) N. ROLLINS PL.
- (11) N. CROWWELL ST.
- (12) N. SHAWNEE ST.
- (13) N. DELAWARE ST.
- (14) N. DELAWARE ST.

- (1) NEW HAVEN ST.
- (2) WATERFORD ST.
- (3) WILLIAMSBURG ST.
- (4) BRADFORD ST.
- (5) MANCHESTER ST.
- (6) STERLING CT.
- (7) WINDSOR ST.
- (8) FRISCO ST.
- (9) CLEARWATER DR.
- (10) HAMILTON FALLS
- (11) CREEKSIDE DR.
- (12) CREEKSIDE DR.
- (13) CREEKSIDE DR.
- (14) CREEKSIDE DR.
- (15) CREEKSIDE DR.
- (16) CREEKSIDE DR.
- (17) CREEKSIDE DR.

Legend

- Highways
- Asphalt
- Concrete
- Gravel
- Grade & Drain
- Unimproved
- Road Common
- Local Roads
- Railroad
- River or Stream
- Corporate Limit
- TULSA
- County Line
- Section Line
- Wildlife Management Area
- Wildlife Refuge
- Lake or Reservoir
- Bridges
- Low Water Crossing

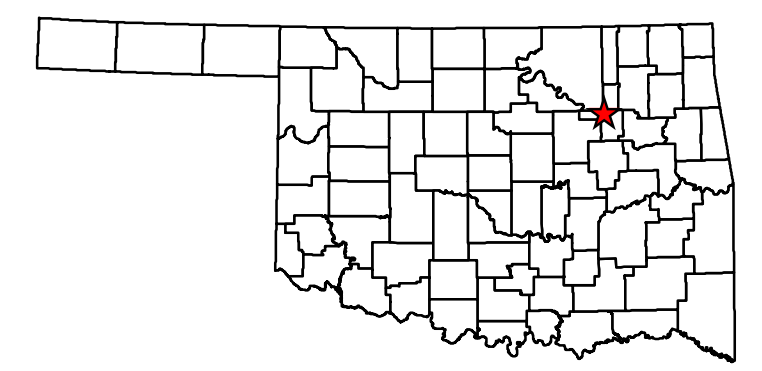
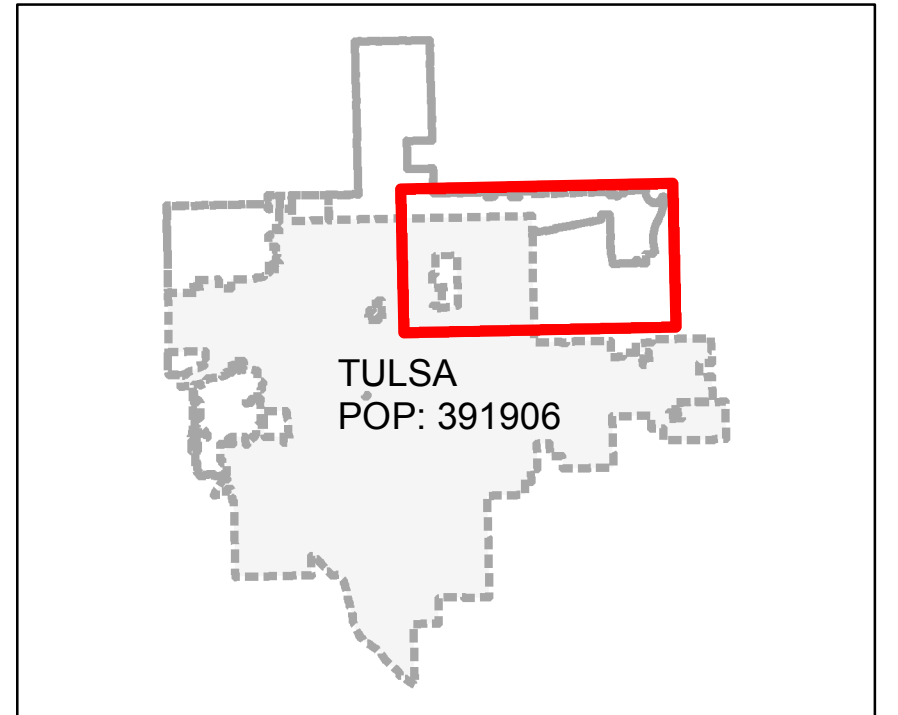

**STATE OF OKLAHOMA
DEPARTMENT OF TRANSPORTATION**

**CITY OF
TULSA
TULSA COUNTY**

CENSUS YEAR 2010
POPULATION 391,906

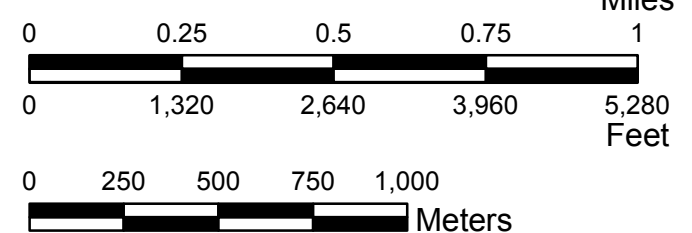

Copies of this map are available for public use at nominal cost.
Address:
OKLAHOMA DEPARTMENT OF TRANSPORTATION
PRINTING SERVICES Phone (405) 521-2586
200 N.E. 21st STREET
OKLAHOMA CITY, OKLAHOMA 73105-3204

This map indicates those roads known to the Department to be open to public travel. Placement of a road on the map has no relationship to maintenance responsibility by any level of government.

© COPYRIGHT 2018
PRINTED AT STATE EXPENSE

NOT FOR RESALE

ALL RIGHTS RESERVED COMPUTER GENERATED September, 2018

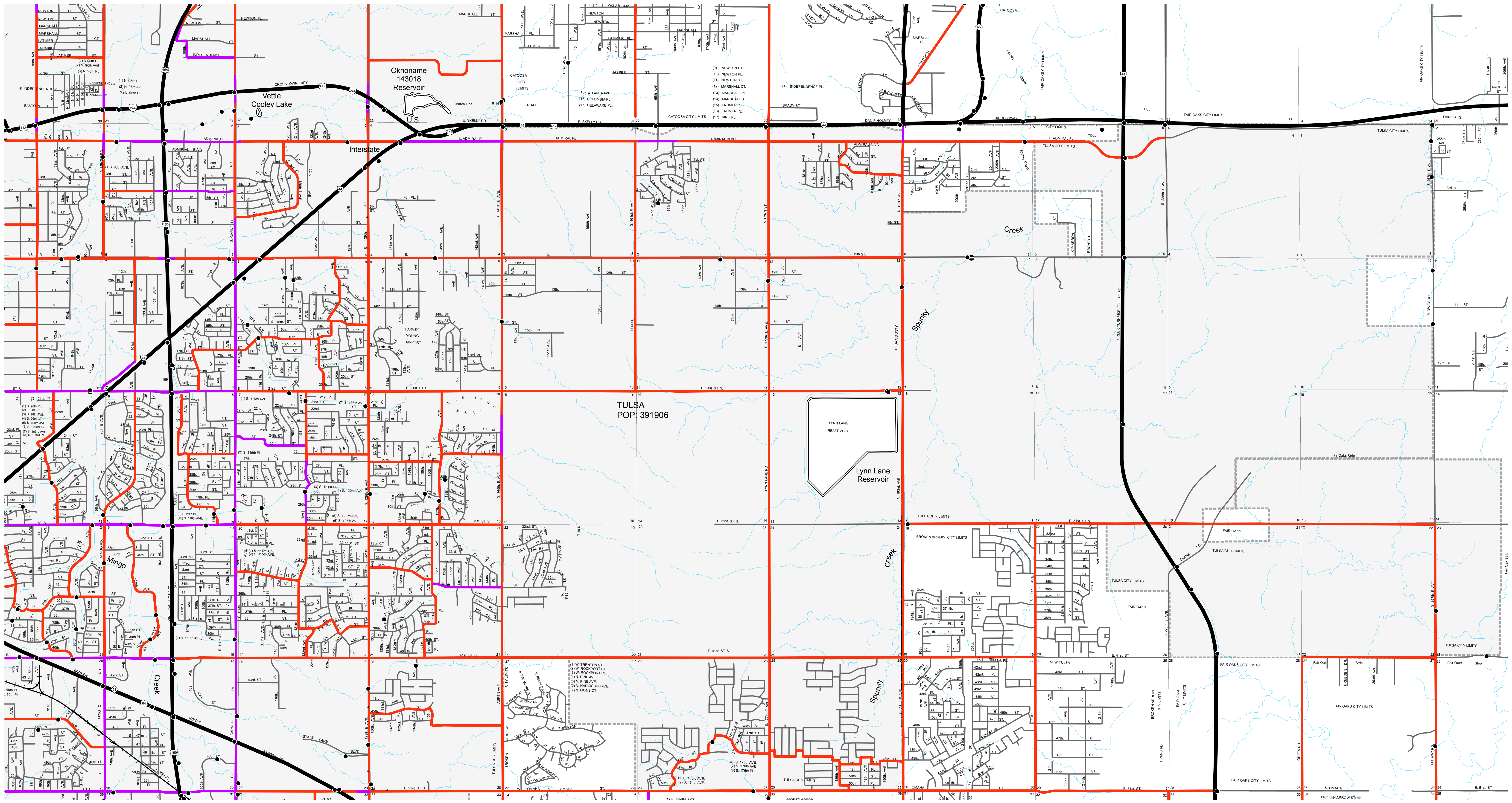

Legend

- Highways
- Asphalt
- Concrete
- Gravel
- Grade & Drain
- Unimproved
- Road Common
- Local Roads
- Railroad
- River or Stream
- Corporate Limit
- TULSA
- County Line
- Section Line
- Wildlife Management Area
- Wildlife Refuge
- Lake or Reservoir
- Bridges
- Low Water Crossing

Copies of this map are available for public use at nominal cost.
 Address:
 OKLAHOMA DEPARTMENT OF TRANSPORTATION
 PRINTING SERVICES Phone (405) 521-2586
 200 N.E. 21st STREET
 OKLAHOMA CITY, OKLAHOMA 73105-3204

This map indicates those roads known to the Department to be open to public travel. Placement of a road on the map has no relationship to maintenance responsibility by any level of government.

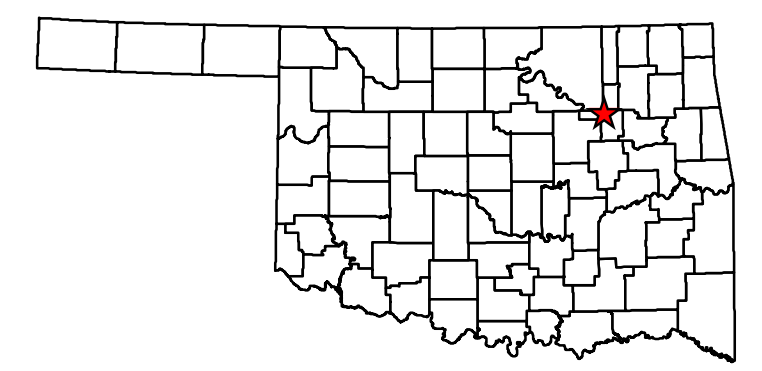
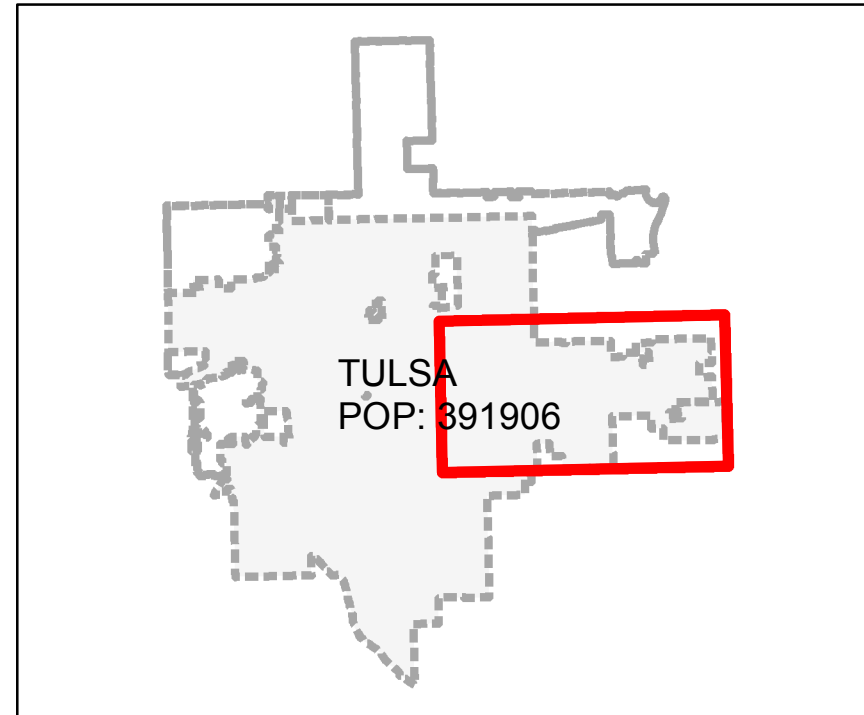

**STATE OF OKLAHOMA
 DEPARTMENT OF TRANSPORTATION**

**CITY OF
 TULSA
 TULSA COUNTY**

CENSUS YEAR 2010
 POPULATION 391,906

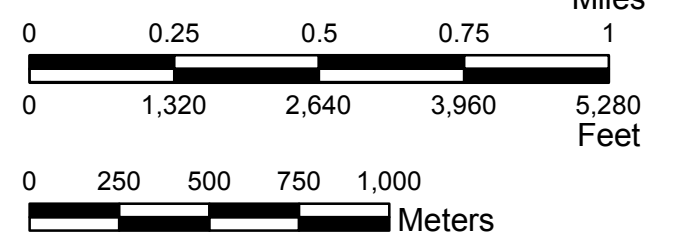

ALL RIGHTS RESERVED COMPUTER GENERATED September, 2018

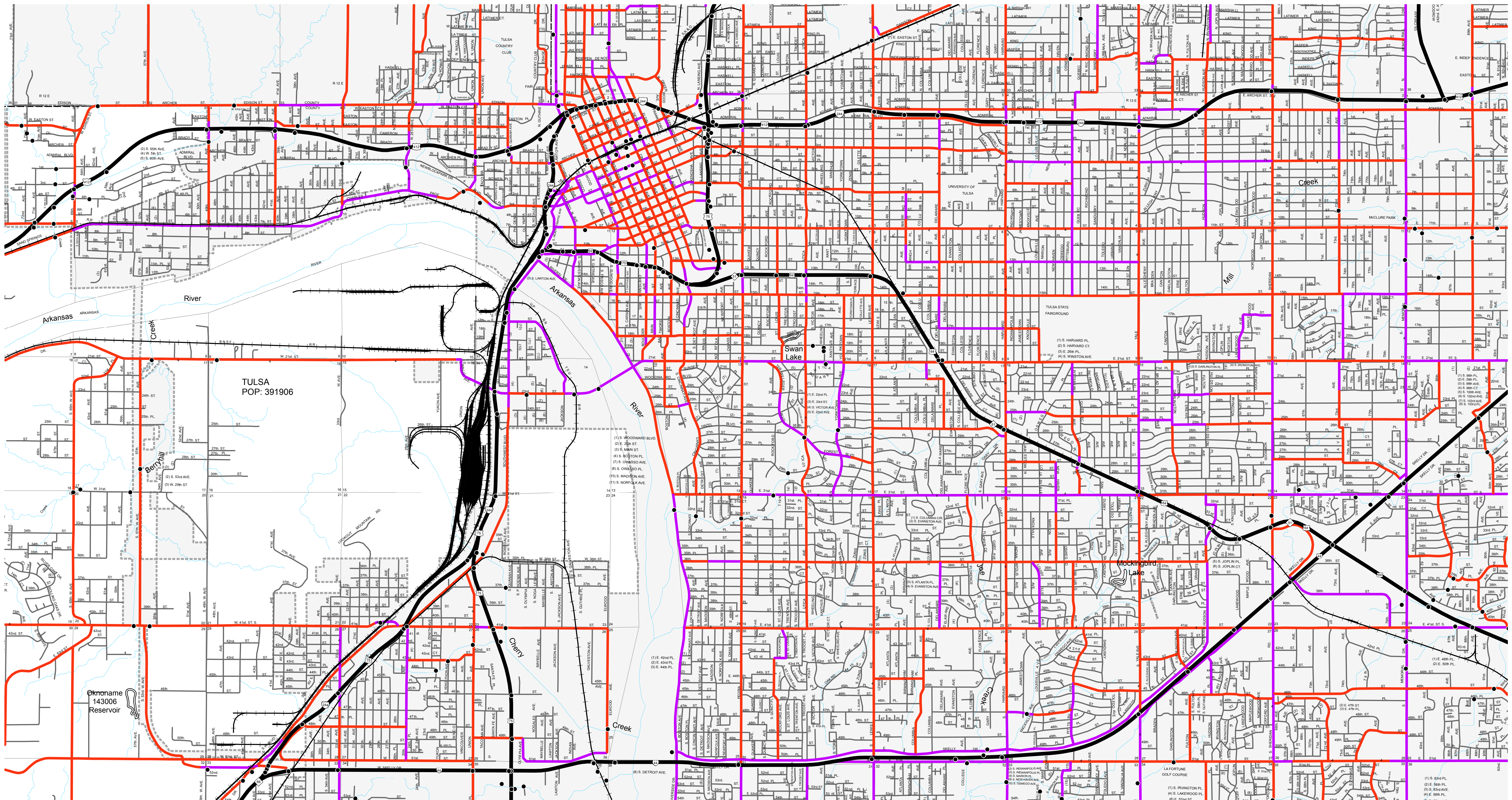

Legend

- Highways
- Asphalt
- Concrete
- Gravel
- Grade & Drain
- Unimproved
- Road Common
- Local Roads
- Railroad
- River or Stream
- Corporate Limit
- TULSA
- County Line
- Section Line
- Wildlife Management Area
- Wildlife Refuge
- Lake or Reservoir
- Bridges
- Low Water Crossing

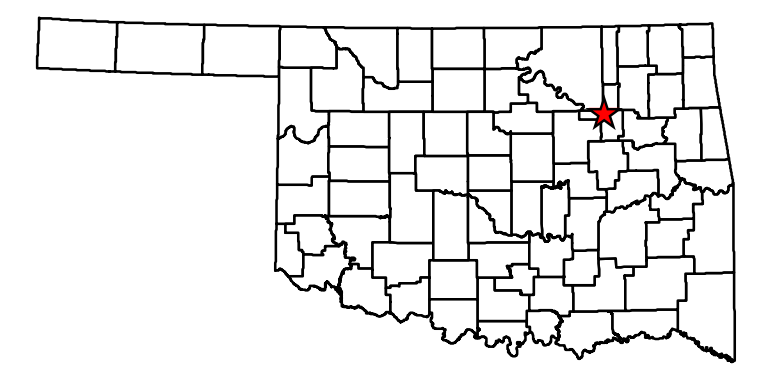
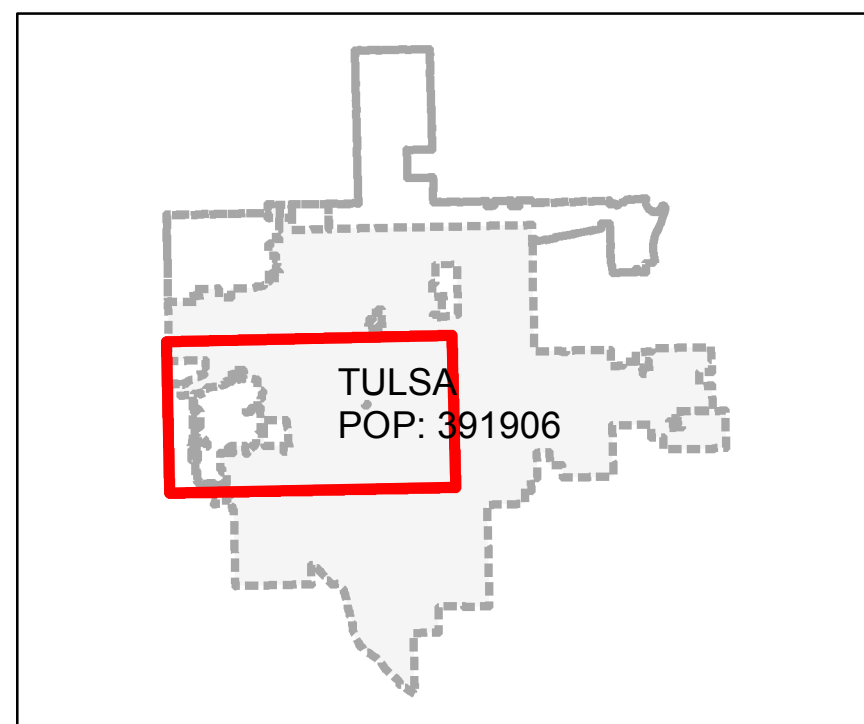

**STATE OF OKLAHOMA
DEPARTMENT OF TRANSPORTATION**

**CITY OF
TULSA
TULSA COUNTY**

CENSUS YEAR 2010
POPULATION 391,906

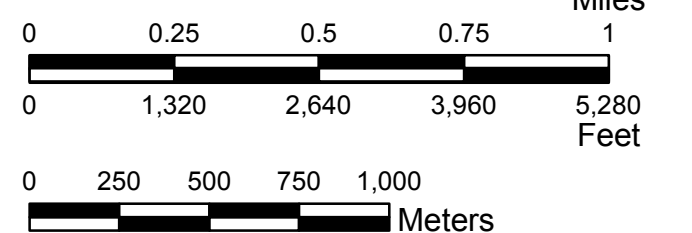

Copies of this map are available for public use at nominal cost.
Address:
OKLAHOMA DEPARTMENT OF TRANSPORTATION
PRINTING SERVICES Phone (405) 521-2586
200 N.E. 21st STREET
OKLAHOMA CITY, OKLAHOMA 73105-3204

This map indicates those roads known to the Department to be open to public travel. Placement of a road on the map has no relationship to maintenance responsibility by any level of government.

© COPYRIGHT 2018
PRINTED AT STATE EXPENSE

NOT FOR RESALE

ALL RIGHTS RESERVED COMPUTER GENERATED September, 2018

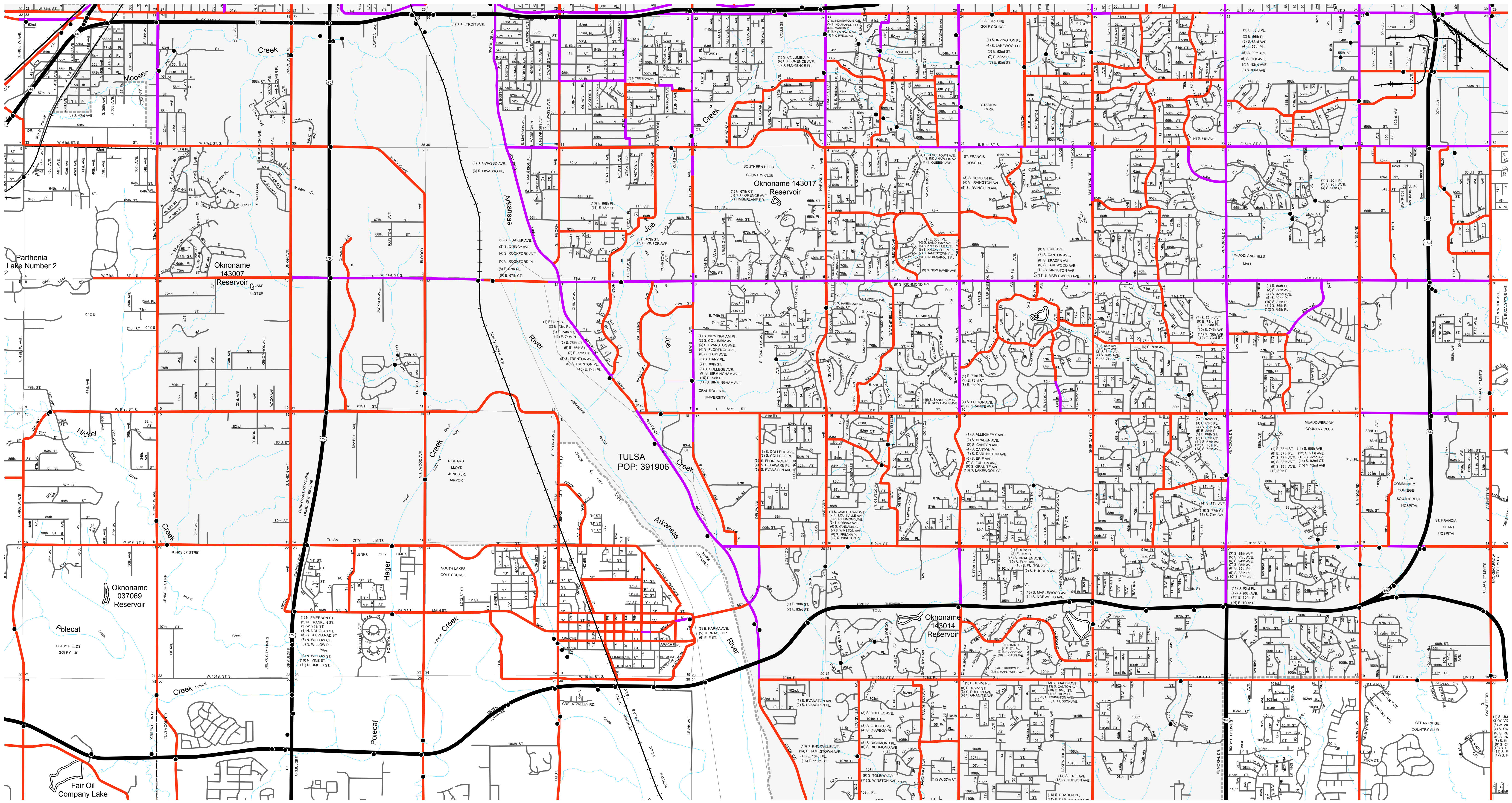

Legend

- | | | |
|-----------------|--------------------------|--------------------|
| Highways | Corporate Limit | Bridges |
| Asphalt | TULSA | Low Water Crossing |
| Concrete | County Line | |
| Gravel | Section Line | |
| Grade & Drain | Wildlife Management Area | |
| Unimproved | Wildlife Refuge | |
| Road Common | Lake or Reservoir | |
| Local Roads | | |
| Railroad | | |
| River or Stream | | |

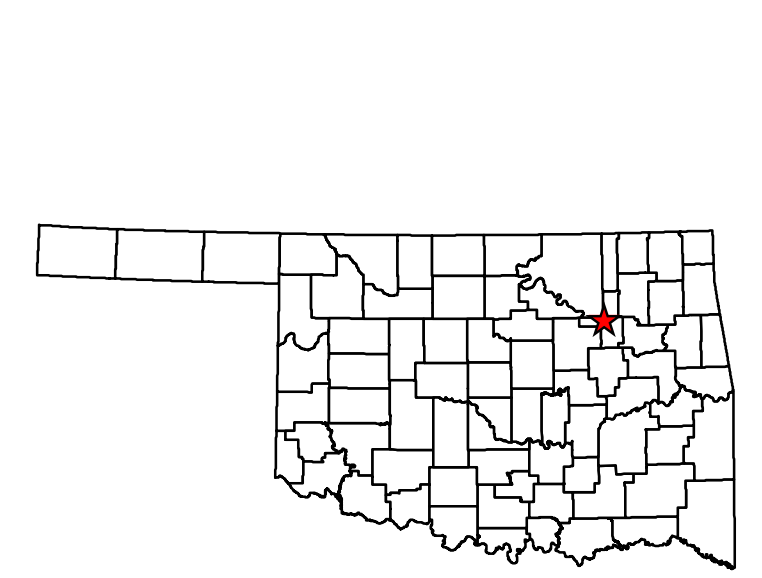
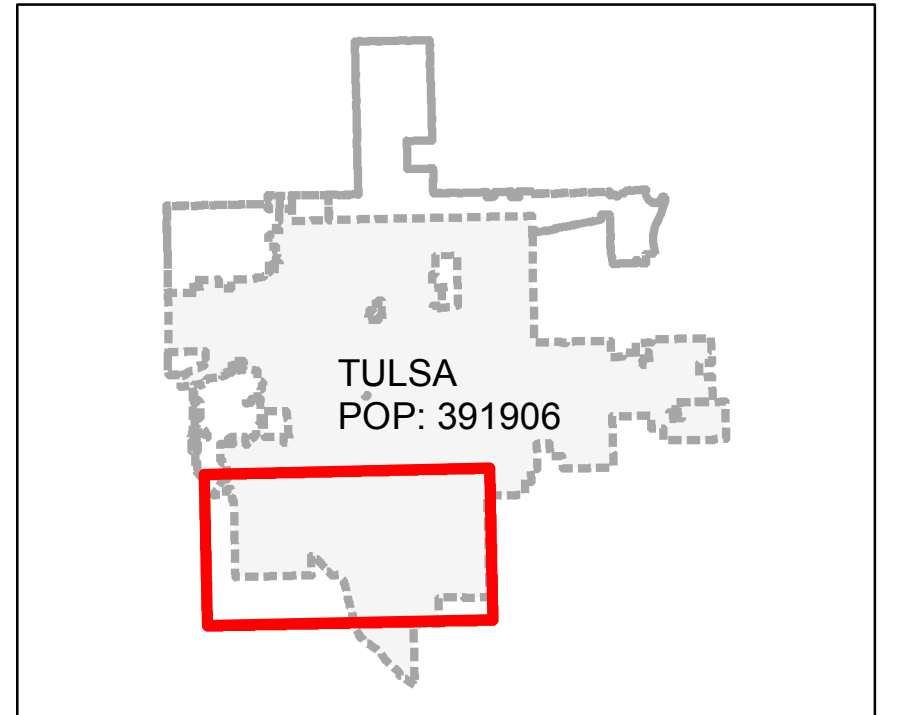

**STATE OF OKLAHOMA
DEPARTMENT OF TRANSPORTATION**

**CITY OF
TULSA
TULSA COUNTY**

CENSUS YEAR 2010
POPULATION 391,906

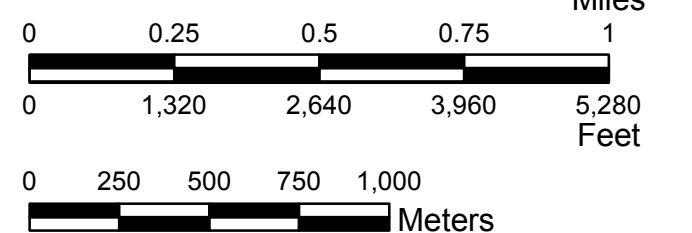

Copies of this map are available for public use at nominal cost.
Address: OKLAHOMA DEPARTMENT OF TRANSPORTATION
PRINTING SERVICES Phone (405) 521-2586
200 N.E. 21st STREET
OKLAHOMA CITY, OKLAHOMA 73105-3204

This map indicates those roads known to the Department to be open to public travel. Placement of a road on the map has no relationship to maintenance responsibility by any level of government.

© COPYRIGHT 2018
PRINTED AT STATE EXPENSE

NOT FOR RESALE

ALL RIGHTS RESERVED COMPUTER GENERATED September, 2018

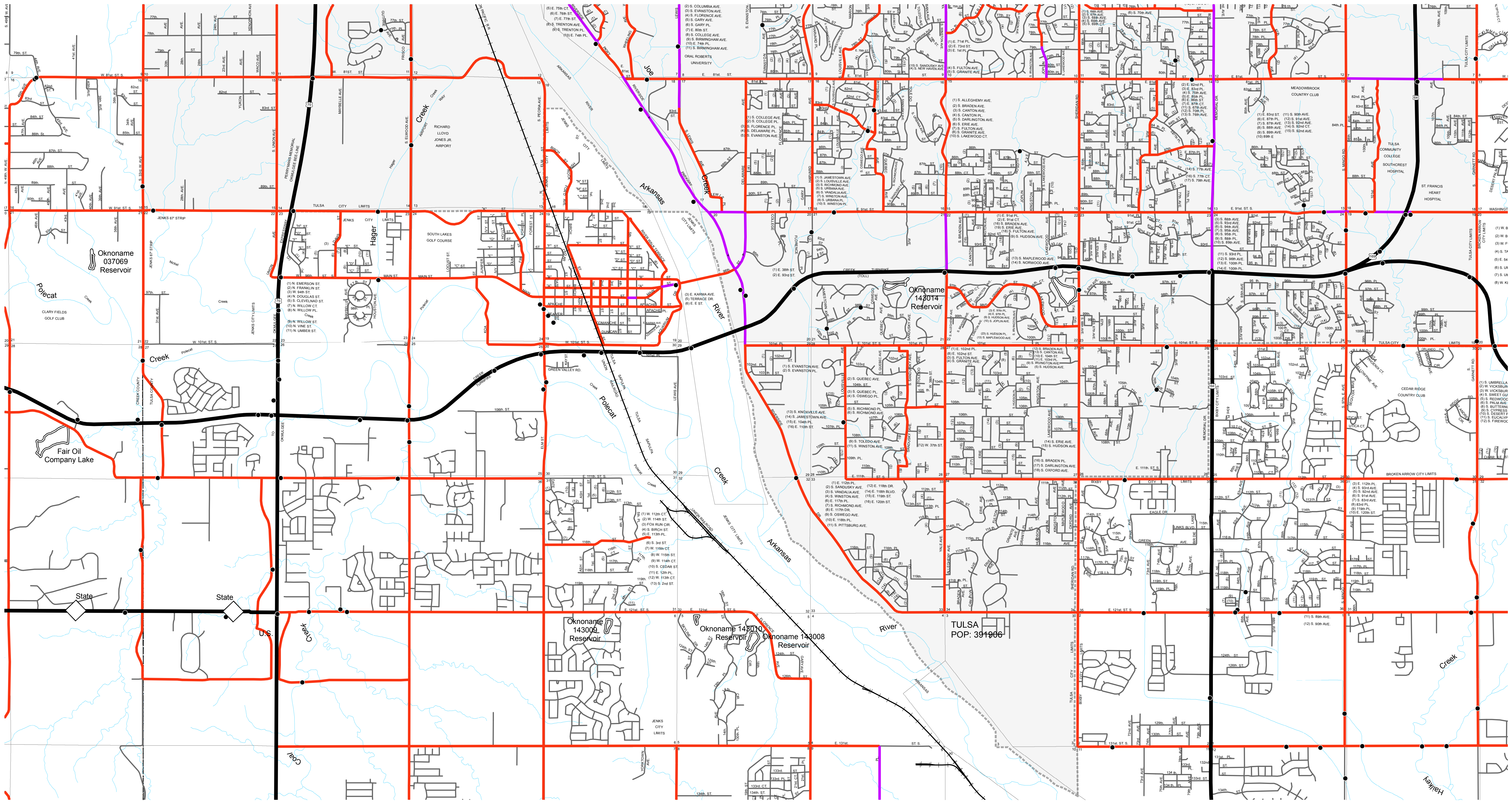

Legend

- | | | |
|-----------------|--------------------------|--------------------|
| Highways | Corporate Limit | Bridges |
| Asphalt | TULSA | Low Water Crossing |
| Concrete | County Line | |
| Gravel | Section Line | |
| Grade & Drain | Wildlife Management Area | |
| Unimproved | Wildlife Refuge | |
| Road Common | Lake or Reservoir | |
| Local Roads | | |
| Railroad | | |
| River or Stream | | |

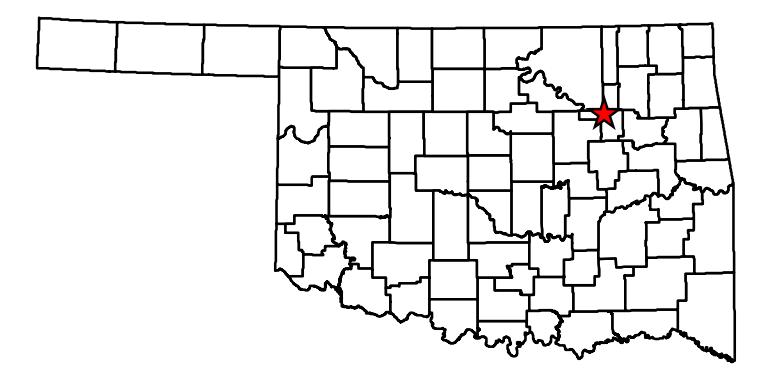
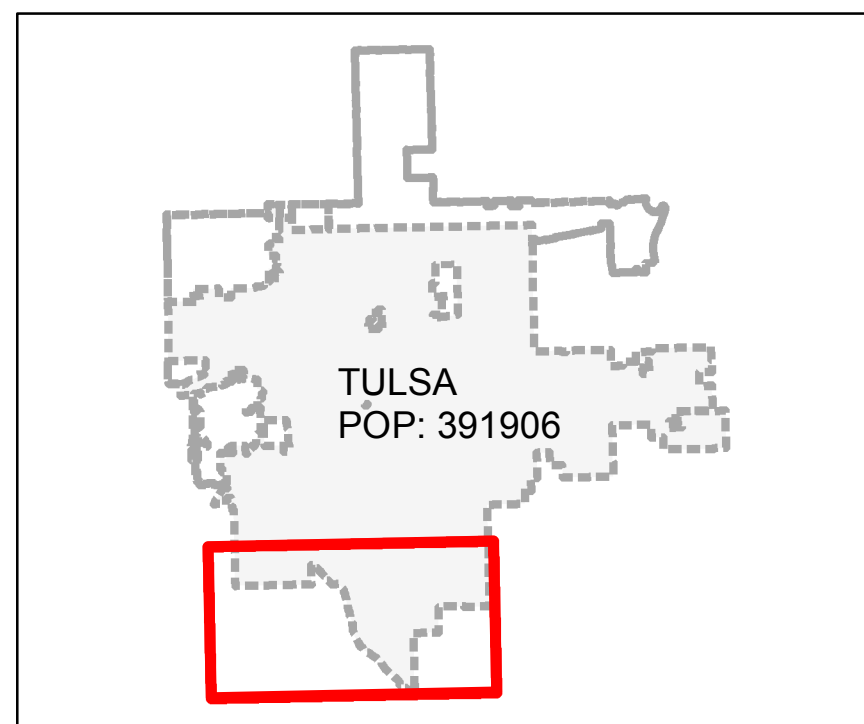

**STATE OF OKLAHOMA
DEPARTMENT OF TRANSPORTATION**

**CITY OF
TULSA
TULSA COUNTY**

CENSUS YEAR 2010
POPULATION 391,906

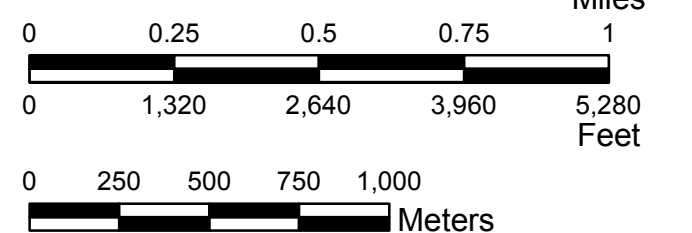

Copies of this map are available for public use at nominal cost.
Address:
OKLAHOMA DEPARTMENT OF TRANSPORTATION
PRINTING SERVICES Phone (405) 521-2586
200 N.E. 21st STREET
OKLAHOMA CITY, OKLAHOMA 73105-3204

This map indicates those roads known to the Department to be open to public travel. Placement of a road on the map has no relationship to maintenance responsibility by any level of government.

© COPYRIGHT 2018
PRINTED AT STATE EXPENSE

NOT FOR RESALE

ALL RIGHTS RESERVED COMPUTER GENERATED September, 2018