

Copies of this map are available for public use at nominal cost.
OKLAHOMA DEPARTMENT OF TRANSPORTATION
PRINTING SERVICES Phone (405) 521-2586
200 N.E. 21st STREET
OKLAHOMA CITY, OKLAHOMA 73105-3204

This map indicates those roads known to the Department to be open to public travel. Placement of a road on the map has no relationship to maintenance responsibility by any level of government.

© COPYRIGHT 2018
PRINTED AT STATE EXPENSE

NOT FOR RESALE

ALL RIGHTS RESERVED
COMPUTER GENERATED
TIPTON, TILLMAN COUNTY
September, 2018

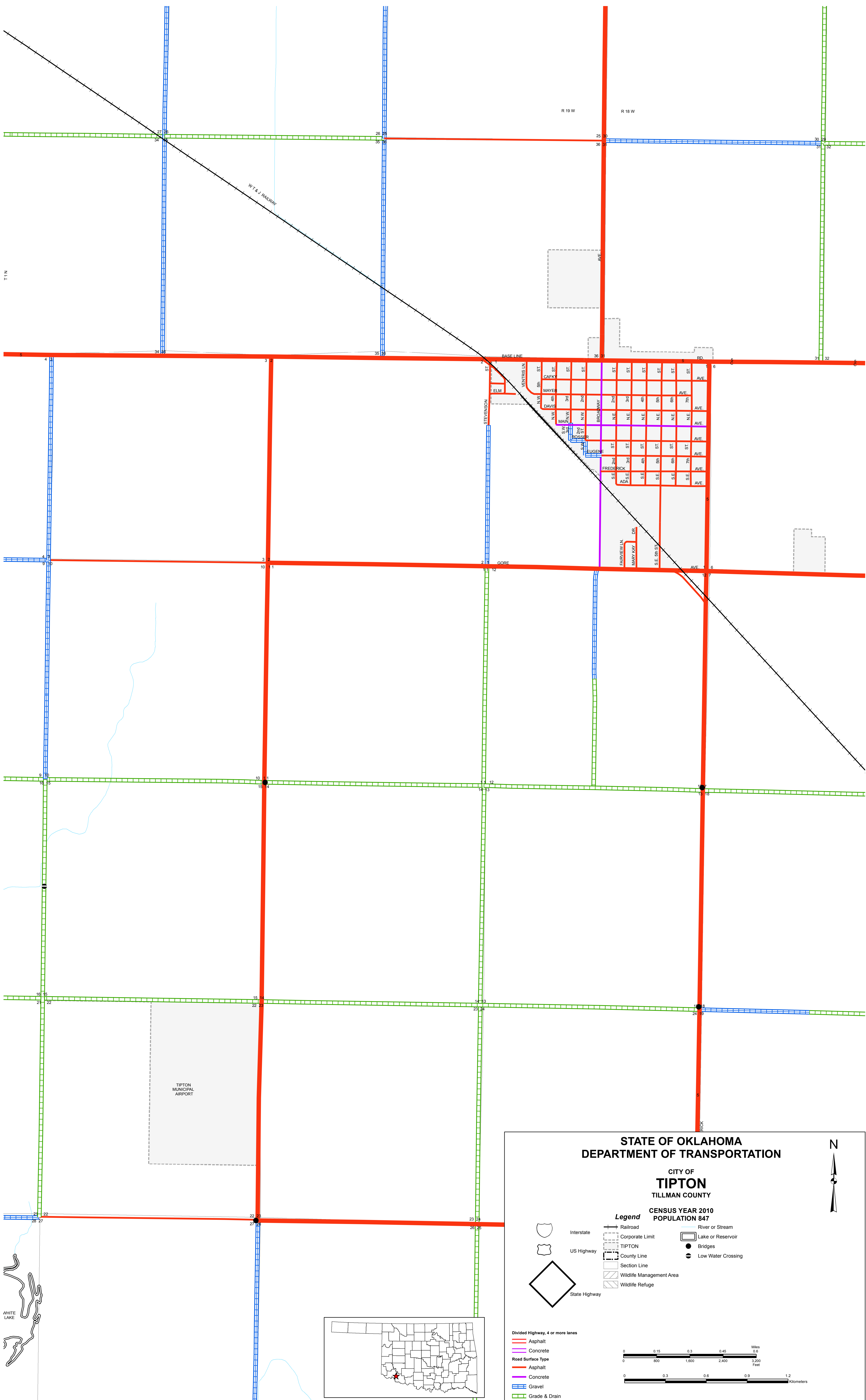

**STATE OF OKLAHOMA
DEPARTMENT OF TRANSPORTATION**

**CITY OF
TIPTON
TILLMAN COUNTY**

**CENSUS YEAR 2010
POPULATION 847**

Legend

	Interstate		Railroad		River or Stream
	US Highway		Corporate Limit		Lake or Reservoir
	County Line		TIPTON		Bridges
	Section Line		Low Water Crossing		Wildlife Management Area
	Wildlife Refuge				

Divided Highway, 4 or more lanes

- Asphalt
- Concrete

Road Surface Type

- Asphalt
- Concrete
- Gravel
- Grade & Drain
- Unimproved