

**STATE OF OKLAHOMA  
DEPARTMENT OF TRANSPORTATION**

**CITY OF  
SAND SPRINGS  
OSAGE COUNTY**

CENSUS YEAR 2010  
POPULATION 18,906

**Legend**

- Interstate
- US Highway
- State Highway
- Highways
- Local Roads
- Asphalt
- Concrete
- Gravel
- Grade & Drain
- Unimproved
- Railroad
- Corporate Limit
- Sand Springs
- County Line
- Section Line
- Wildlife Management Area
- Wildlife Refuge
- River or Stream
- Lake or Reservoir
- Bridges
- Low Water Crossing

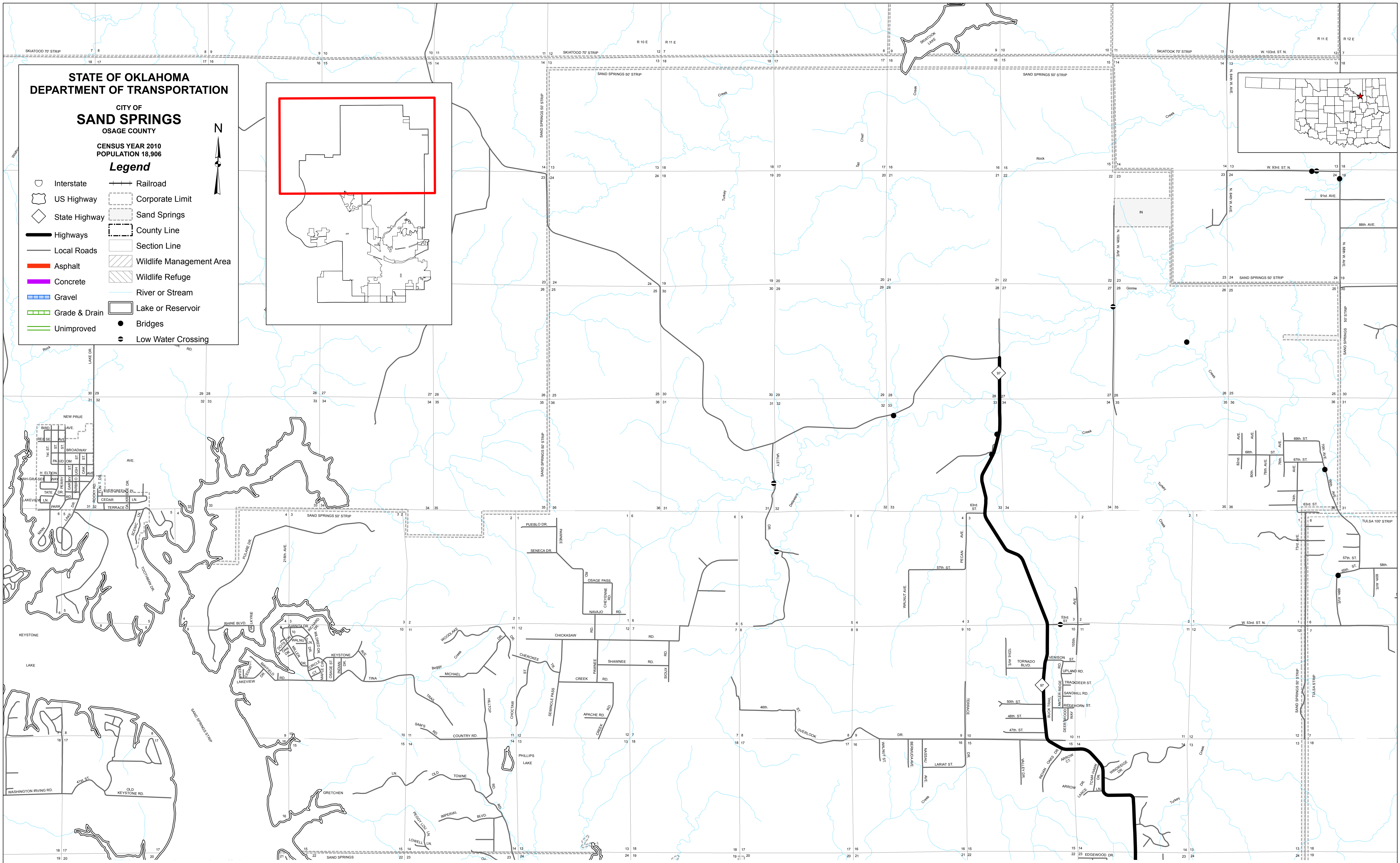
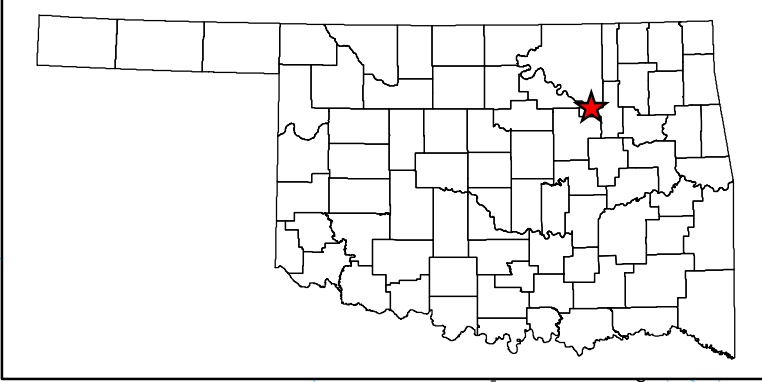
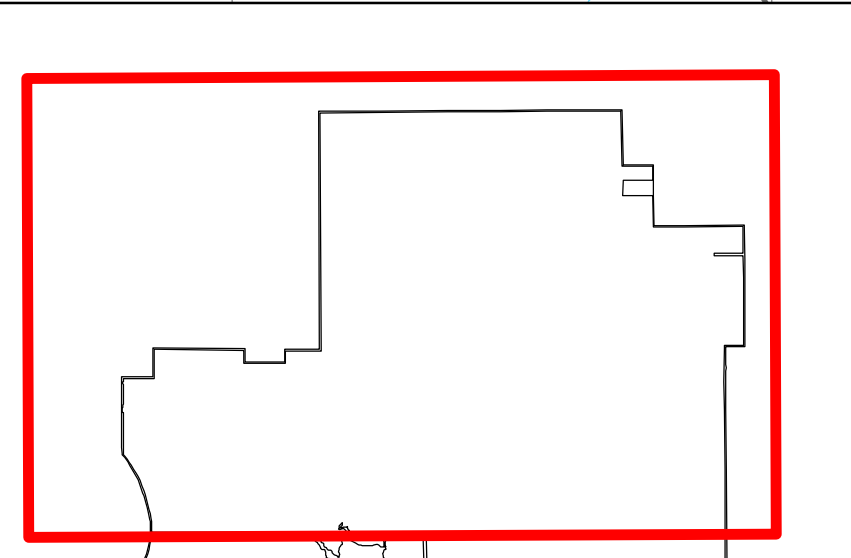

Copies of this map are available for public use at nominal cost.  
Address:  
OKLAHOMA DEPARTMENT OF TRANSPORTATION  
PRINTING SERVICES PHONE (405) 521-2586  
200 N.E. 21st STREET  
OKLAHOMA CITY, OKLAHOMA 73105-3204

This map indicates those roads known to the Department to be open to public travel. Placement of a road on the map has no relationship to maintenance responsibility by any level of government.

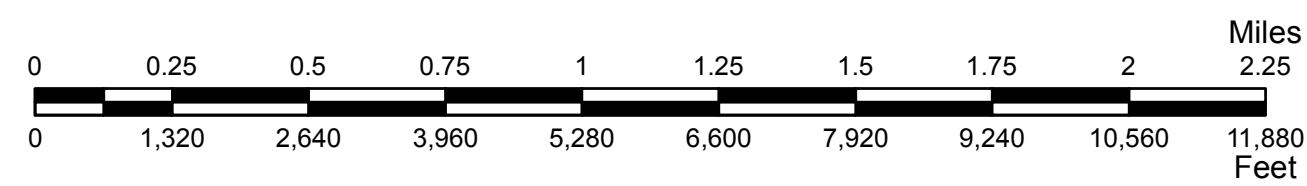

© COPYRIGHT 2018  
PRINTED AT STATE EXPENSE

**NOT FOR RESALE**

ALL RIGHTS RESERVED COMPUTER GENERATED September, 2018

**SAND SPRINGS, OSAGE COUNTY**

**SAND SPRINGS**

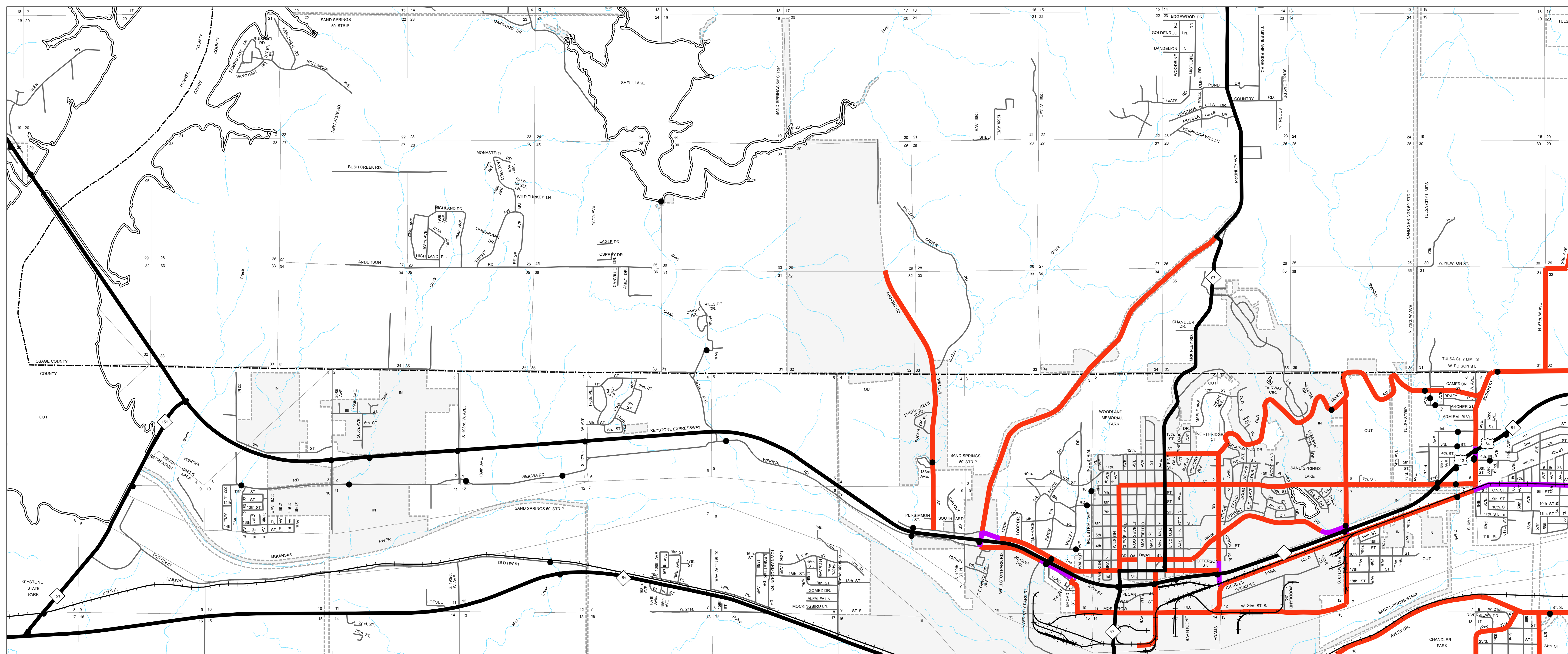

**STATE OF OKLAHOMA  
DEPARTMENT OF TRANSPORTATION**

**CITY OF  
SAND SPRINGS  
OSAGE COUNTY**

CENSUS YEAR 2010  
POPULATION 18,906

**Legend**

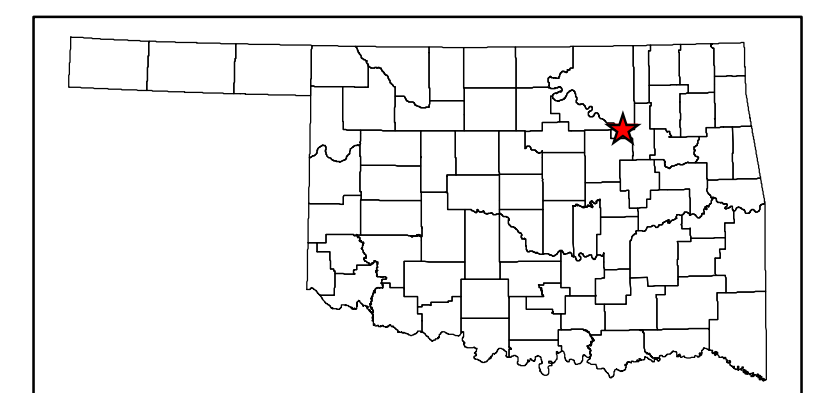
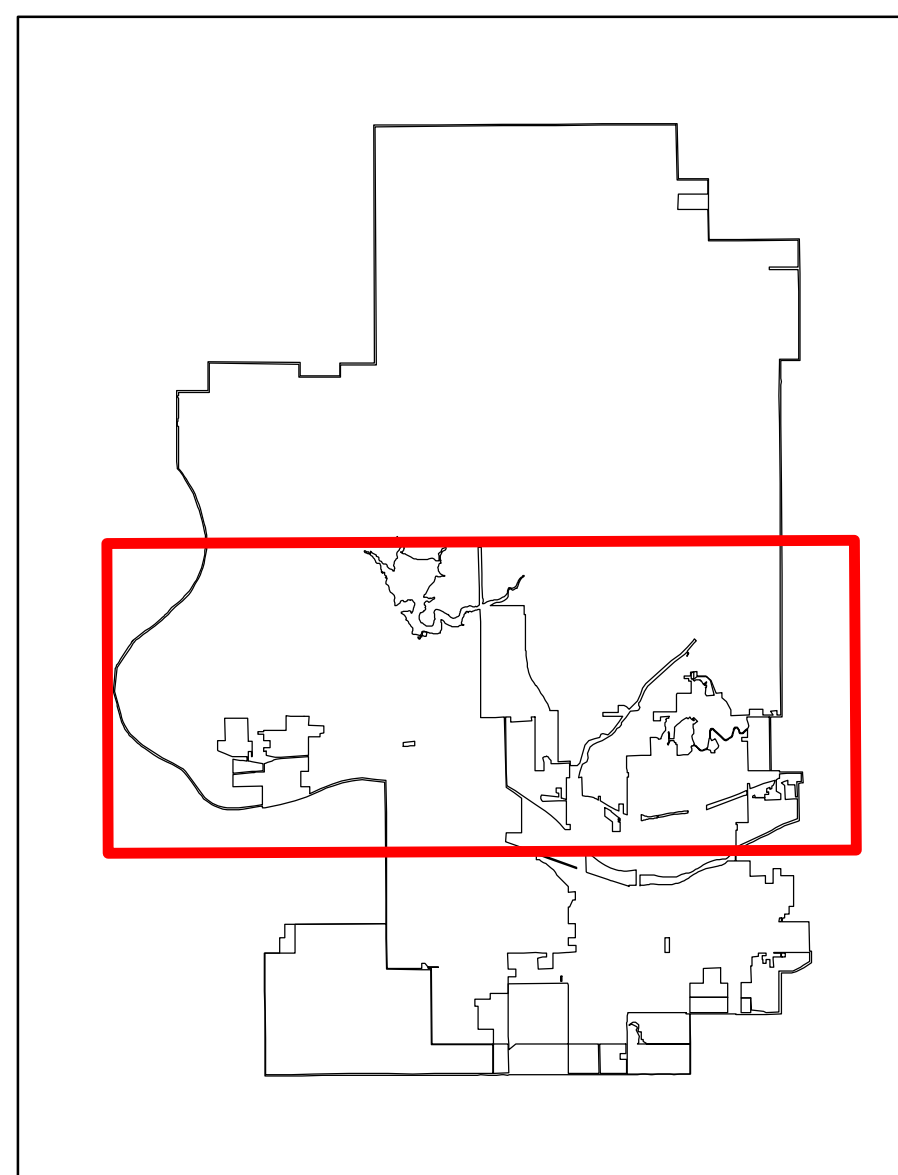
Copies of this map are available for public use at nominal cost.  
Address:  
OKLAHOMA DEPARTMENT OF TRANSPORTATION  
PRINTING SERVICES Phone (405) 521-2586  
200 N.E. 21st STREET  
OKLAHOMA CITY, OKLAHOMA 73105-3204

This map indicates those roads known to the Department to be open to public travel. Placement of a road on the map has no relationship to maintenance responsibility by any level of government.

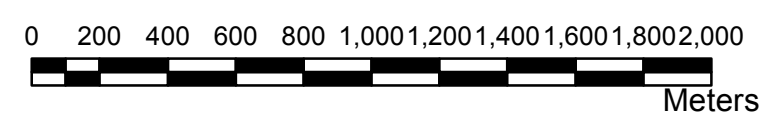
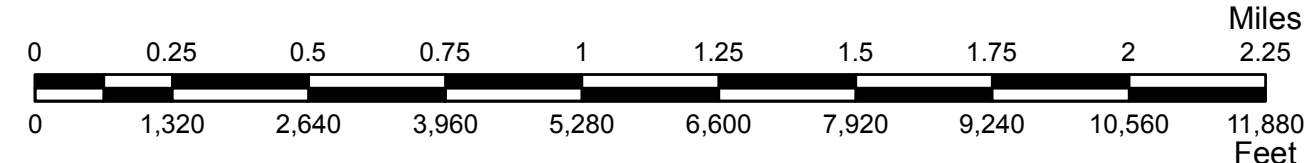

© COPYRIGHT 2018  
PRINTED AT STATE EXPENSE

**NOT FOR RESALE**

ALL RIGHTS RESERVED COMPUTER GENERATED September, 2018

**SAND SPRINGS, OSAGE COUNTY**

**SAND SPRINGS**

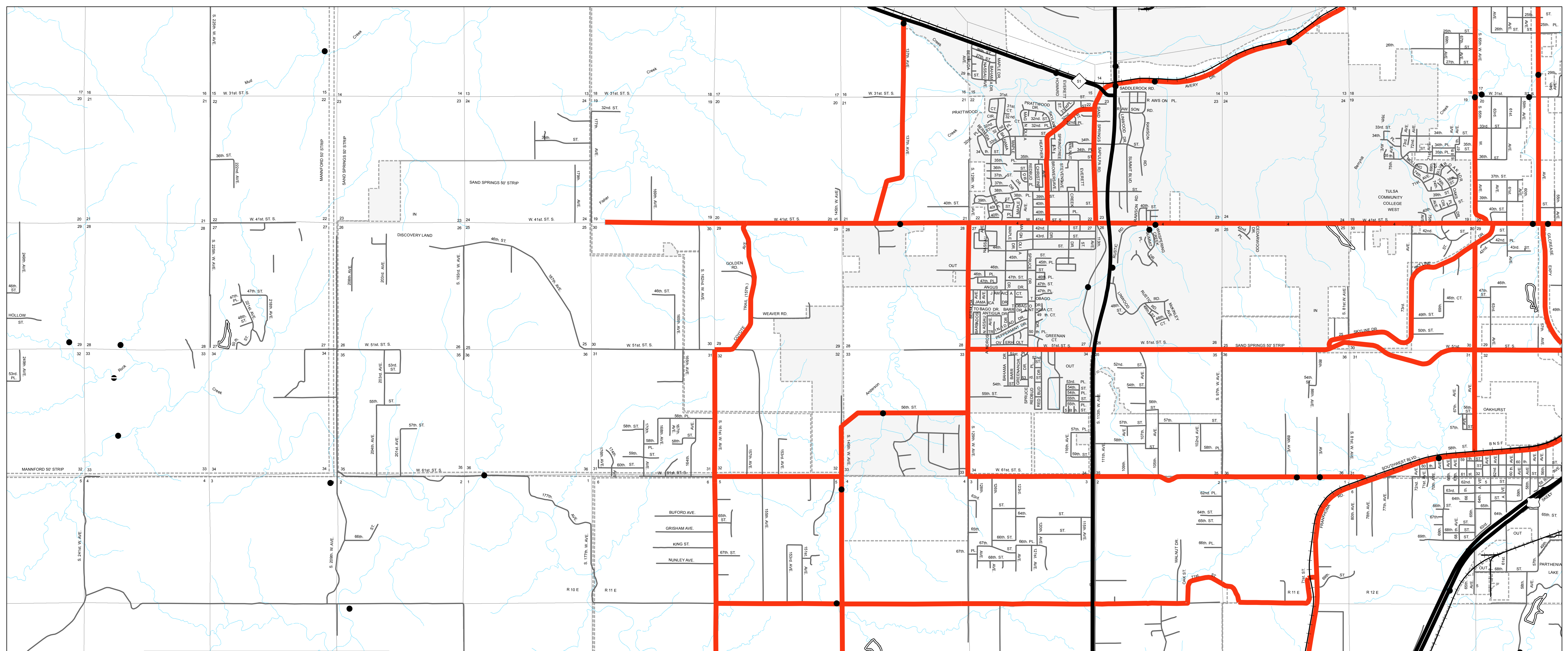

**STATE OF OKLAHOMA  
DEPARTMENT OF TRANSPORTATION**

**CITY OF  
SAND SPRINGS  
OSAGE COUNTY**

CENSUS YEAR 2010  
POPULATION 18,906

**Legend**

Interstate	Railroad
US Highway	Corporate Limit
State Highway	Sand Springs
Highways	County Line
Local Roads	Section Line
Asphalt	Wildlife Management Area
Concrete	Wildlife Refuge
Gravel	River or Stream
Grade & Drain	Lake or Reservoir
Unimproved	Bridges
	Low Water Crossing

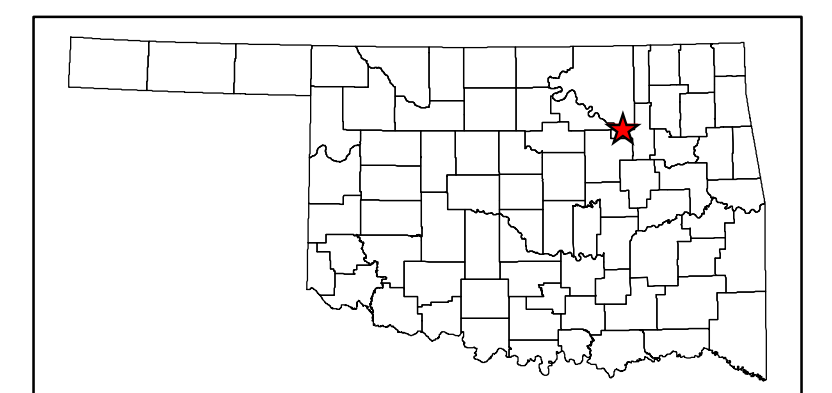
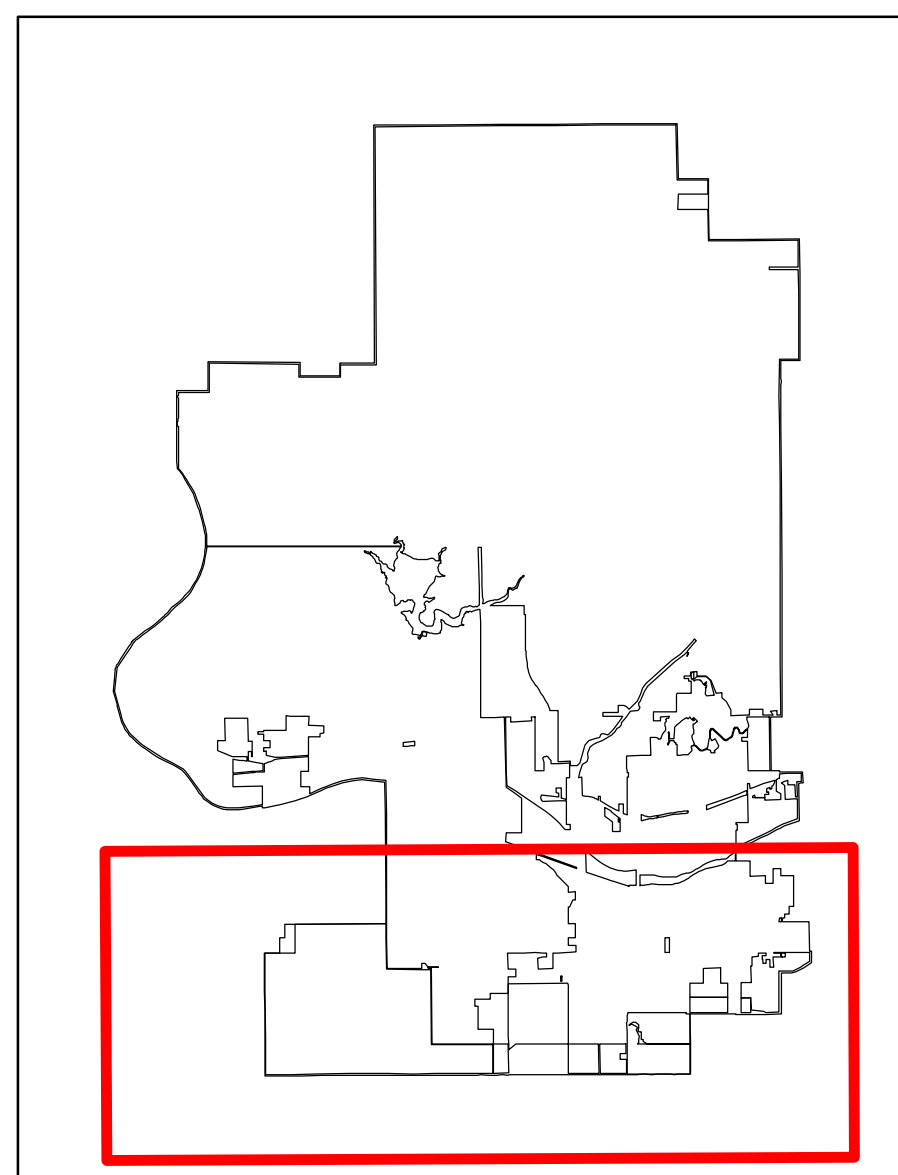
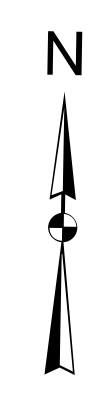

Copies of this map are available for public use at nominal cost.  
Address:  
OKLAHOMA DEPARTMENT OF TRANSPORTATION  
PRINTING SERVICES Phone (405) 521-2586  
200 N.E. 21st STREET  
OKLAHOMA CITY, OKLAHOMA 73105-3204

This map indicates those roads known to the Department to be open to public travel. Placement of a road on the map has no relationship to maintenance responsibility by any level of government.

