

Copies of this map are available for public use at nominal cost.
OKLAHOMA DEPARTMENT OF TRANSPORTATION
PRINTING SERVICES Phone (405) 521-2566
200 N.E. 21st STREET
OKLAHOMA CITY, OKLAHOMA 73105-3204

This map indicates those roads known to the Department to be open to public travel. Placement of a road on the map has no relationship to maintenance responsibility by any level of government.

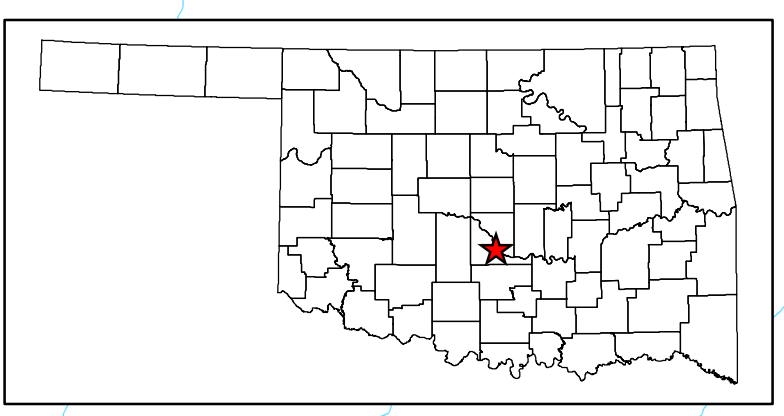
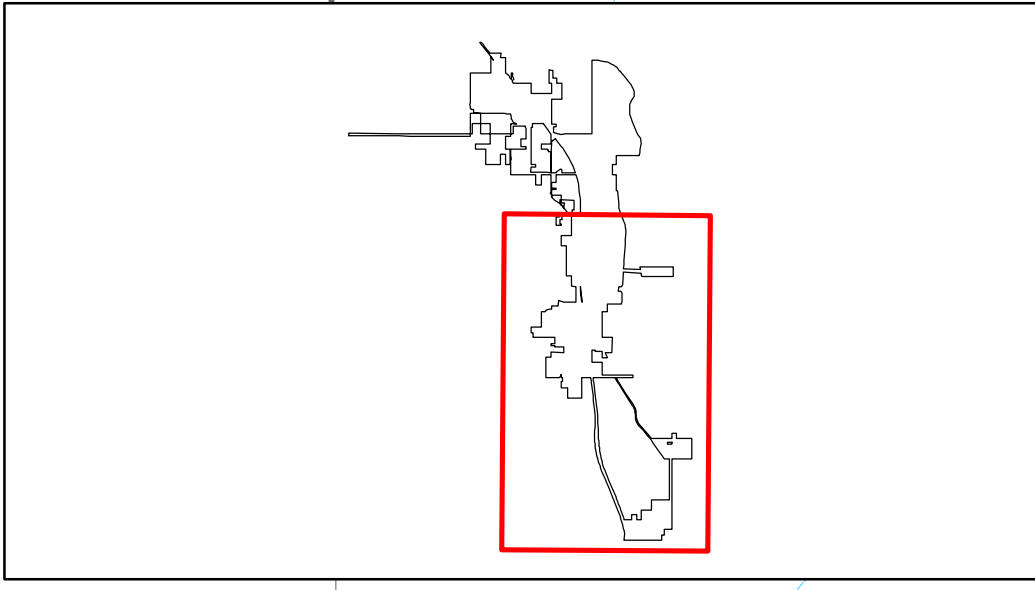
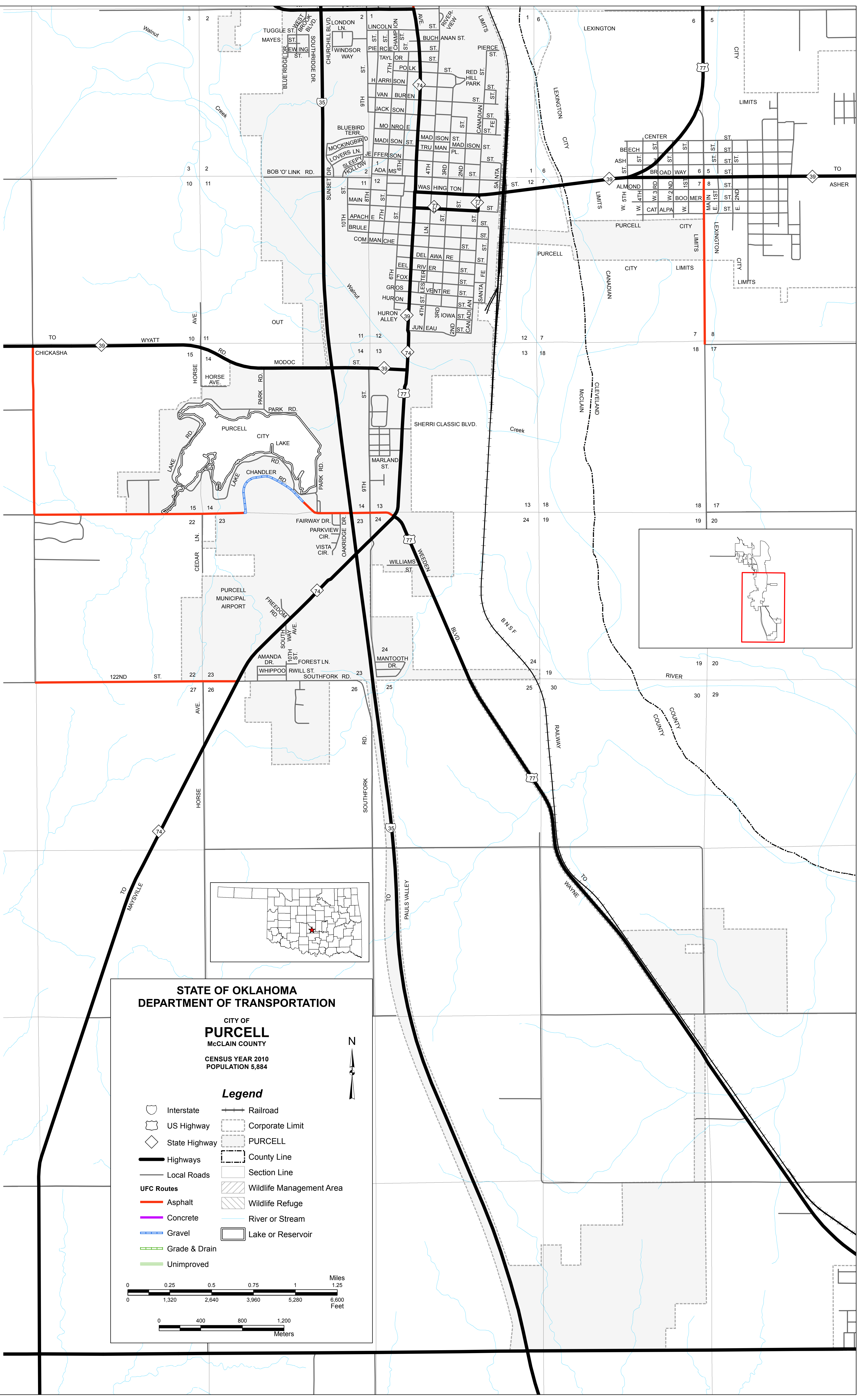

STATE OF OKLAHOMA
DEPARTMENT OF TRANSPORTATION

CITY OF
PURCELL
McCLAIN COUNTY

CENSUS YEAR 2010
POPULATION 5,884



Legend

- Interstate
- US Highway
- State Highway
- Highways
- Local Roads
- UFC Routes
- Asphalt
- Concrete
- Gravel
- Grade & Drain
- Unimproved
- Railroad
- Corporate Limit
- PURCELL
- County Line
- Section Line
- Wildlife Management Area
- Wildlife Refuge
- River or Stream
- Lake or Reservoir

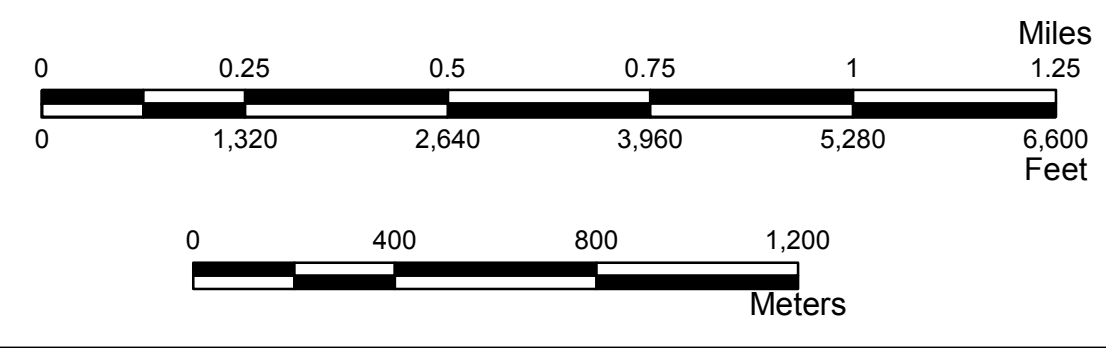

















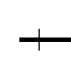

**STATE OF OKLAHOMA
DEPARTMENT OF TRANSPORTATION**

**CITY OF
PURCELL**
McCLAIN COUNTY

CENSUS YEAR 2010
POPULATION 5,884

Legend

-  Interstate
-  US Highway
-  State Highway
-  Highways
-  Local Roads
-  UFC Routes
-  Asphalt
-  Concrete
-  Gravel
-  Grade & Drain
-  Unimproved
-  Railroad
-  Corporate Limit
-  PURCELL
-  County Line
-  Section Line
-  Wildlife Management Area
-  Wildlife Refuge
-  River or Stream
-  Lake or Reservoir

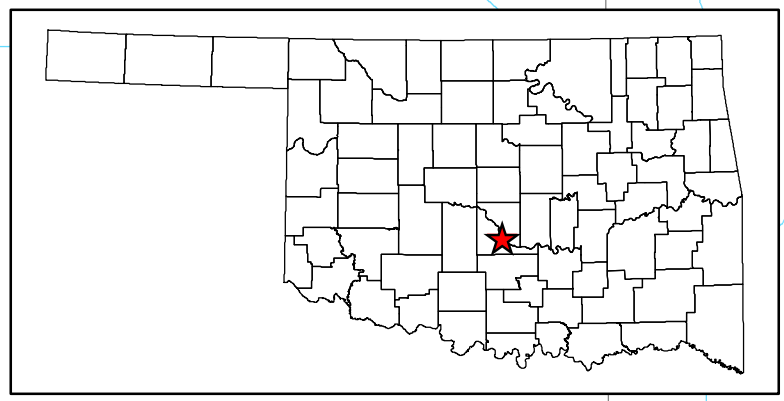
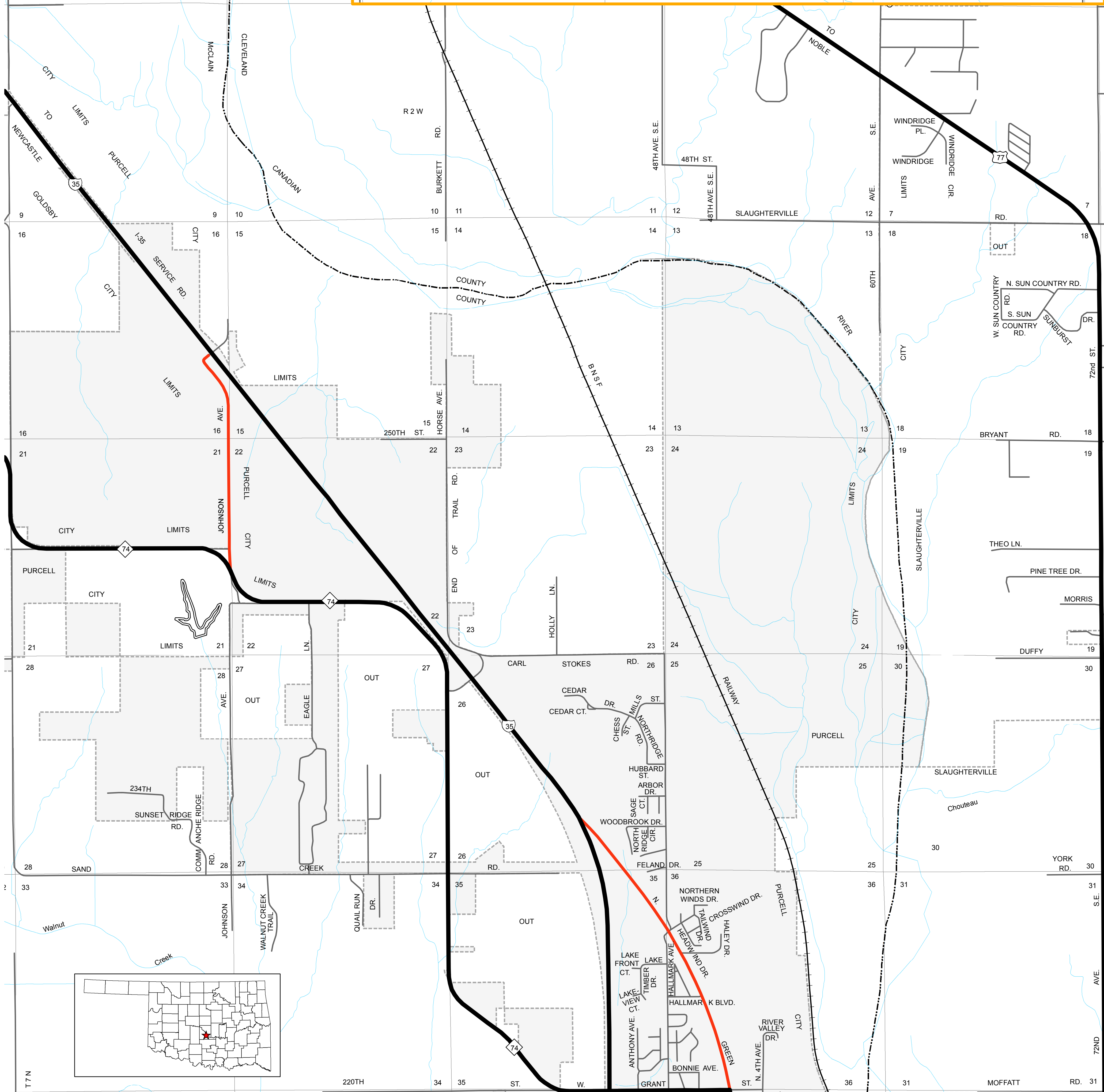
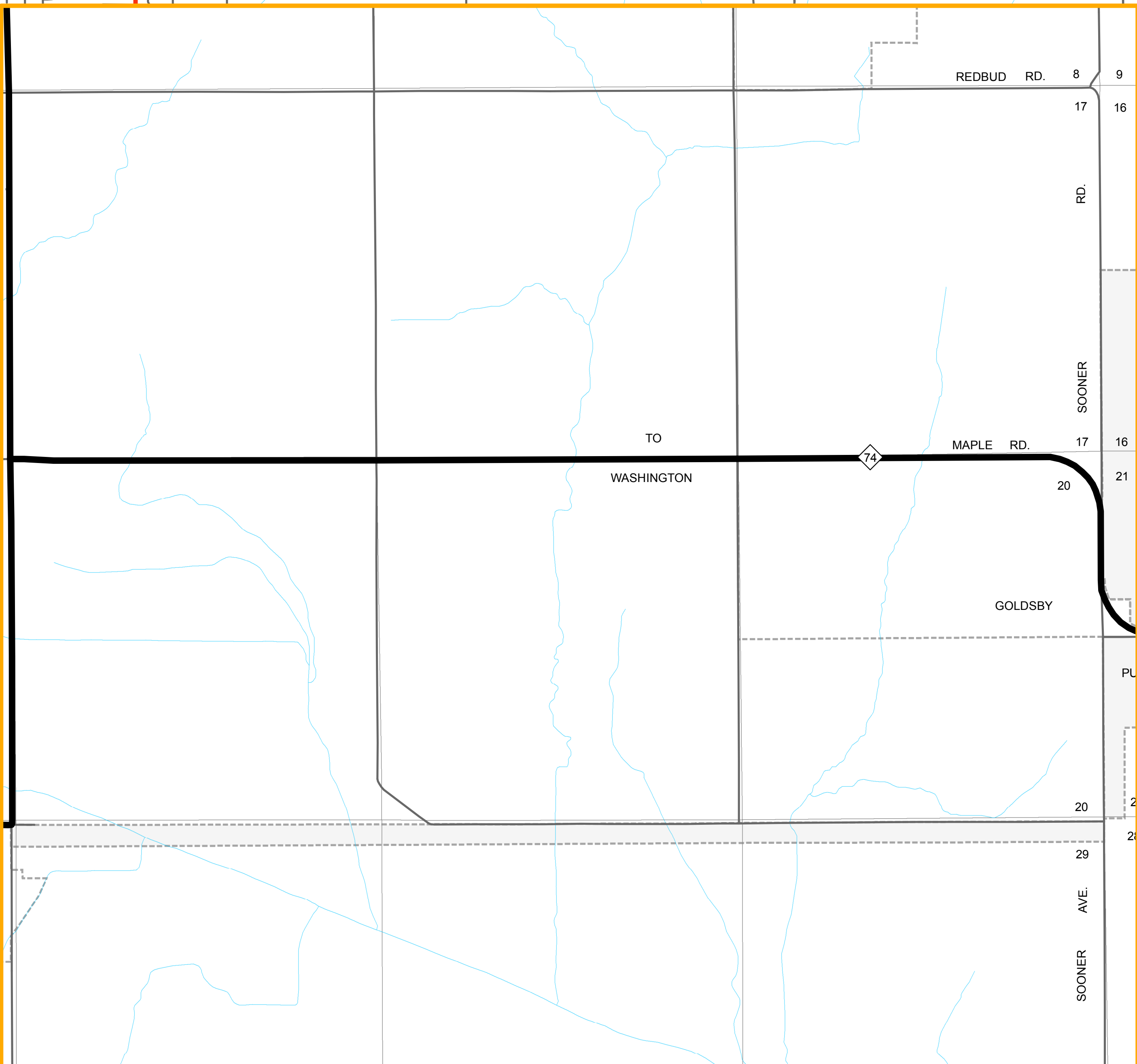
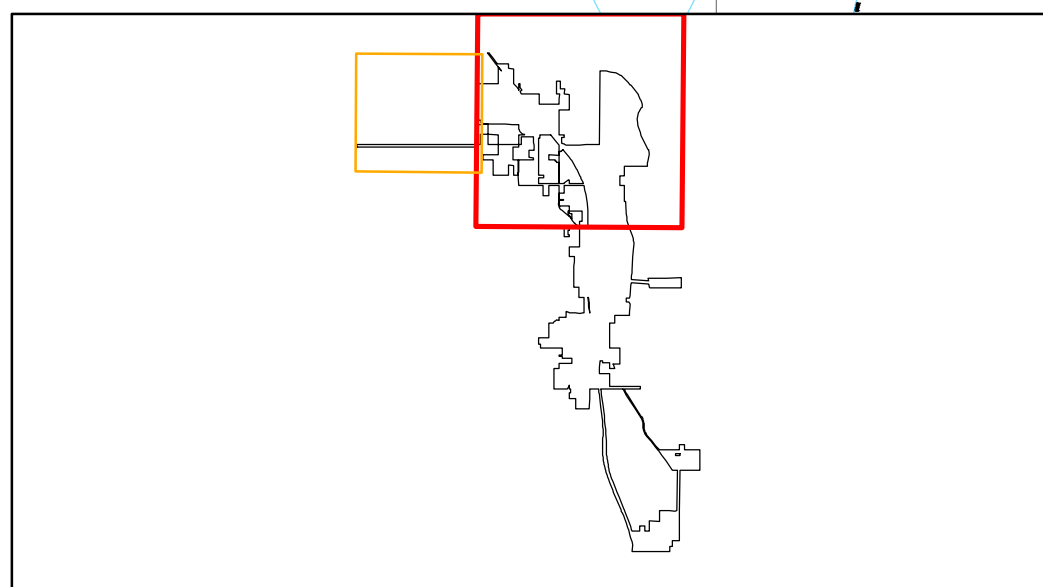
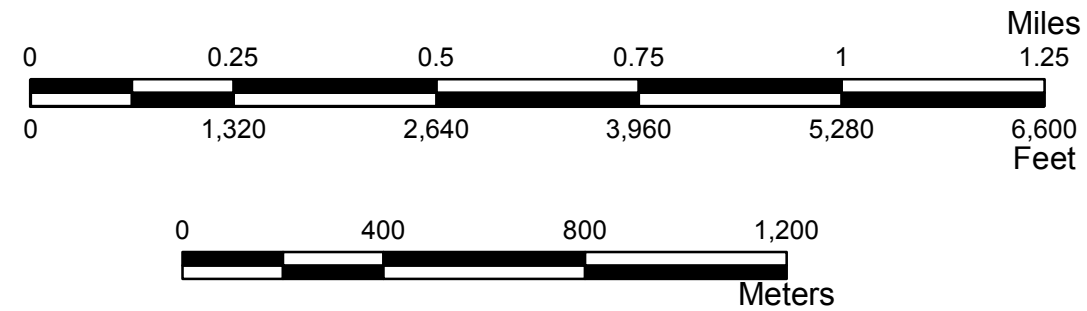

Copies of this map are available for public use at nominal cost.
 OKLAHOMA DEPARTMENT OF TRANSPORTATION
 PRINTING SERVICES Phone (405) 521-2596
 200 N.E. 21st STREET
 OKLAHOMA CITY, OKLAHOMA 73105-3204
 This map indicates those roads known to the Department to be open to public travel. Placement of a road on the map has no relationship to maintenance responsibility by any level of government.
 © COPYRIGHT 2018
 PRINTED AT STATE EXPENSE
 NOT FOR RESALE
 ALL RIGHTS RESERVED
 COMPUTER GENERATED
 September 2018
 PURCELL, McCLAIN COUNTY