

Legend

- Interstate
- US Highway
- State Highway
- Highways
- Local Roads
- Railroad
- Asphalt
- Concrete
- Gravel
- Grade & Drain
- Unimproved
- Corporate Limit
- PIEDMONT
- County Line
- Section Line
- Wildlife Management Area
- Wildlife Refuge
- River or Stream
- Lake or Reservoir
- Bridges
- Low Water Crossing

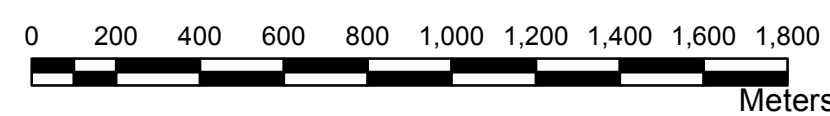
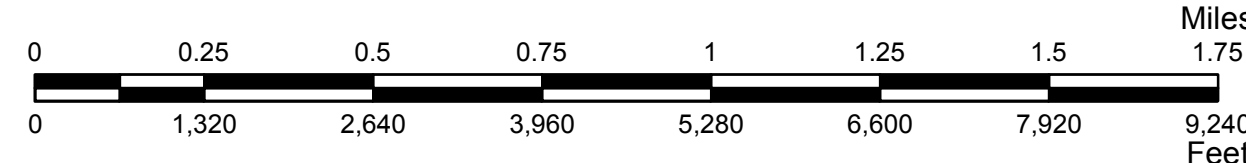

Copies of this map are available for public use at nominal cost.
 Address:
 OKLAHOMA DEPARTMENT OF TRANSPORTATION
 PRINTING SERVICES Phone (405) 521-2586
 200 N.E. 21st STREET
 OKLAHOMA CITY, OKLAHOMA 73105-3204

This map indicates those roads known to the Department to be open to public travel. Placement of a road on the map has no relationship to maintenance responsibility by any level of government.

STATE OF OKLAHOMA
DEPARTMENT OF TRANSPORTATION

CITY OF
PIEDMONT
 CANADIAN COUNTY

CENSUS YEAR 2010
 POPULATION 5,720

ALL RIGHTS RESERVED COMPUTER GENERATED September, 2018

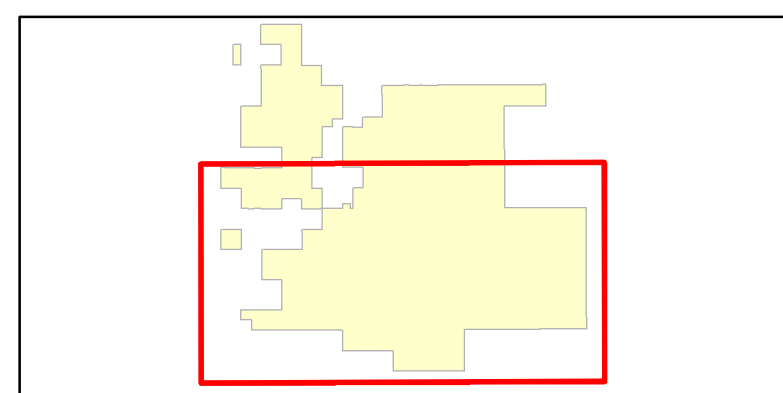
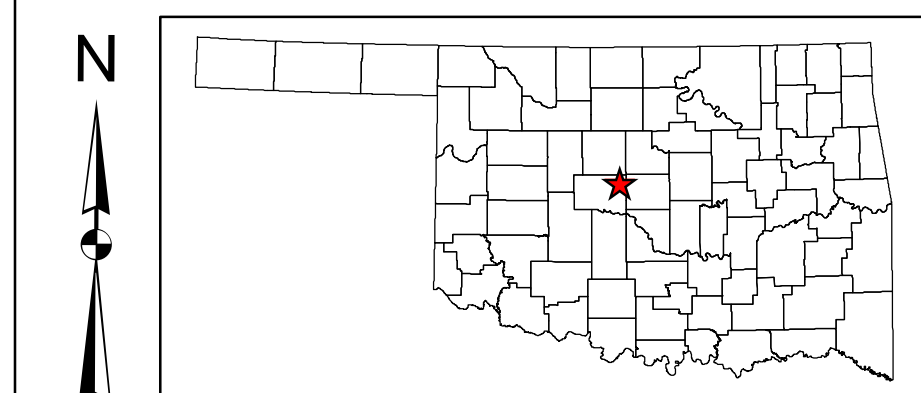
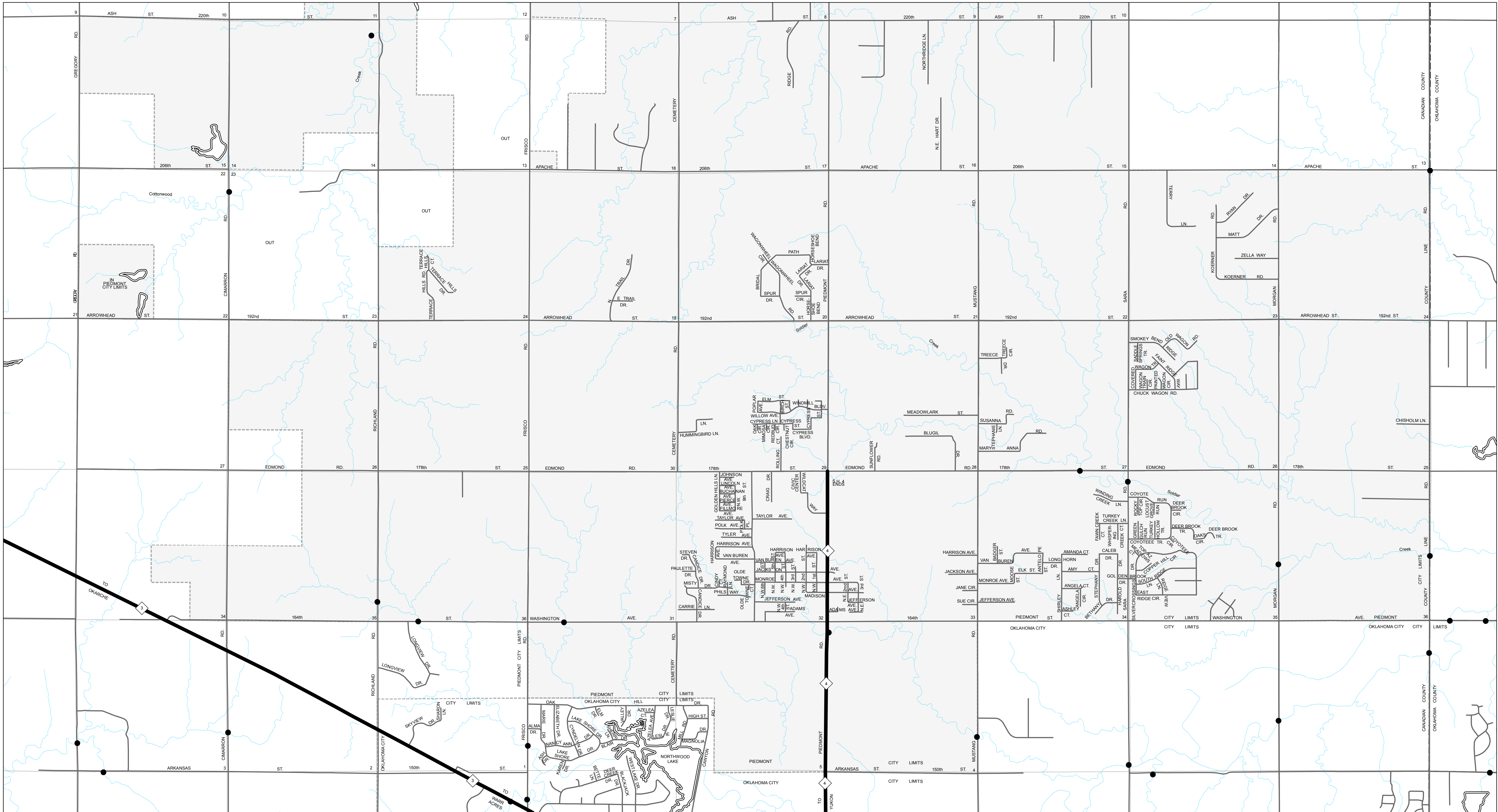

Copies of this map are available for public use at nominal cost.
 Address:
 OKLAHOMA DEPARTMENT OF TRANSPORTATION
 PRINTING SERVICES PHONE (405) 521-2586
 200 N.E. 21st STREET
 OKLAHOMA CITY, OKLAHOMA 73105-3204

This map indicates those roads known to the Department to be open to public travel. Placement of a road on the map has no relationship to maintenance responsibility by any level of government.

- Legend**
- Interstate
 - US Highway
 - State Highway
 - Highways
 - Local Roads
 - Railroad
 - Asphalt
 - Concrete
 - Gravel
 - Grade & Drain
 - Unimproved
 - Corporate Limit
 - PIEDMONT
 - County Line
 - Section Line
 - Wildlife Management Area
 - Wildlife Refuge
 - River or Stream
 - Lake or Reservoir
 - Bridges
 - Low Water Crossing

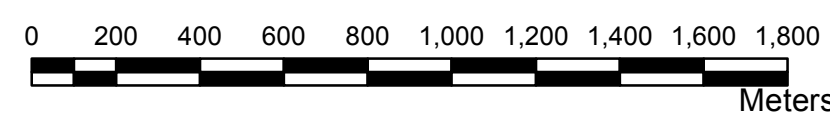
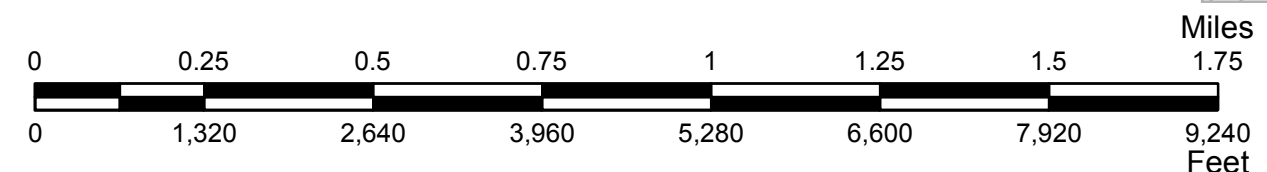

**STATE OF OKLAHOMA
 DEPARTMENT OF TRANSPORTATION**

CITY OF
PIEDMONT
 CANADIAN COUNTY

CENSUS YEAR 2010
 POPULATION 5,720