

STATE OF OKLAHOMA
DEPARTMENT OF TRANSPORTATION

CITY OF
NEWCASTLE
McCLAIN COUNTY

CENSUS YEAR 2010
POPULATION 7,685



Legend

- | | | | |
|--|---------------|--|--------------------------|
| | Interstate | | Railroad |
| | US Highway | | Corporate Limit |
| | State Highway | | NEWCASTLE |
| | Highways | | County Line |
| | Local Roads | | Section Line |
| | Asphalt | | Wildlife Management Area |
| | Concrete | | Wildlife Refuge |
| | Gravel | | River or Stream |
| | Grade & Drain | | Lake or Reservoir |
| | Unimproved | | |

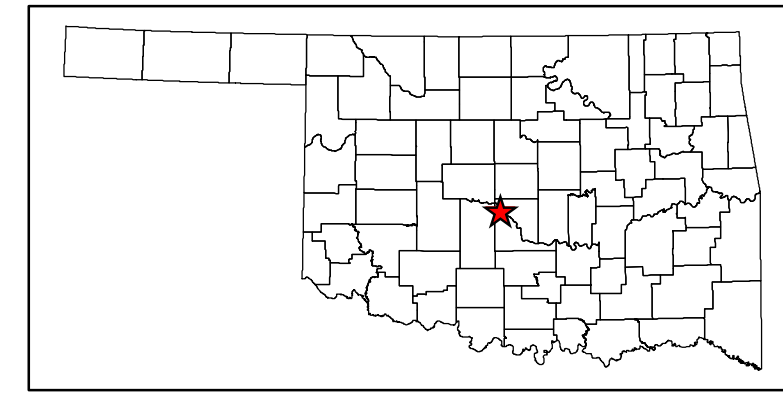
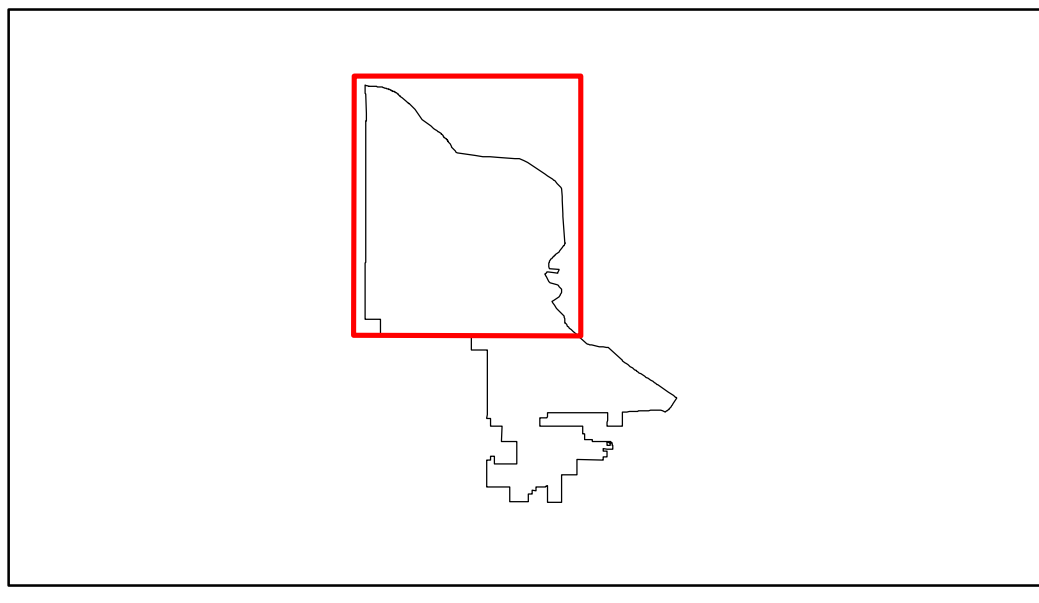
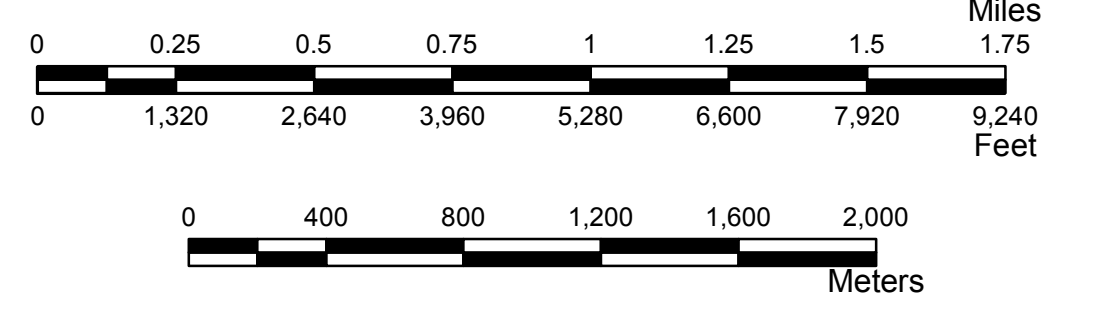

Copies of this map are available for public use at nominal cost.
OKLAHOMA DEPARTMENT OF TRANSPORTATION
PRINTING SERVICES Phone (405) 521-2596
200 N.E. 21st STREET
OKLAHOMA CITY, OKLAHOMA 73105-3204

This map indicates those roads known to the Department to be open to public travel. Placement of a road on the map has no relationship to maintenance responsibility by any level of government.

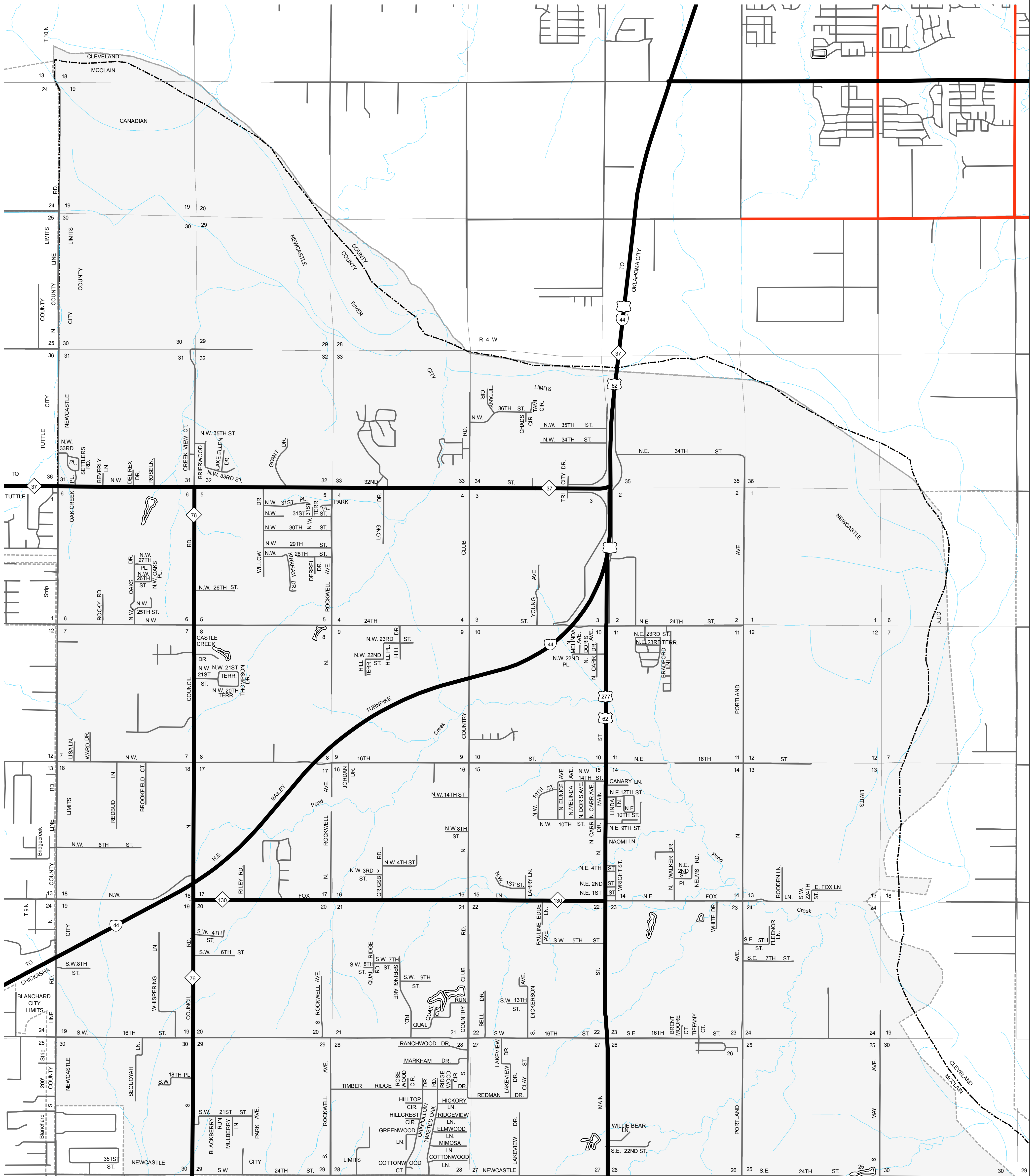

STATE OF OKLAHOMA
DEPARTMENT OF TRANSPORTATION

CITY OF
NEWCASTLE

McCLAIN COUNTY

CENSUS YEAR 2010
POPULATION 7,685



Legend

- Interstate
- US Highway
- State Highway
- Highways
- Local Roads
- UFC Routes**
- Asphalt
- Concrete
- Gravel
- Grade & Drain
- Unimproved
- Railroad
- Corporate Limit
- NEWCASTLE
- County Line
- Section Line
- Wildlife Management Area
- Wildlife Refuge
- River or Stream
- Lake or Reservoir

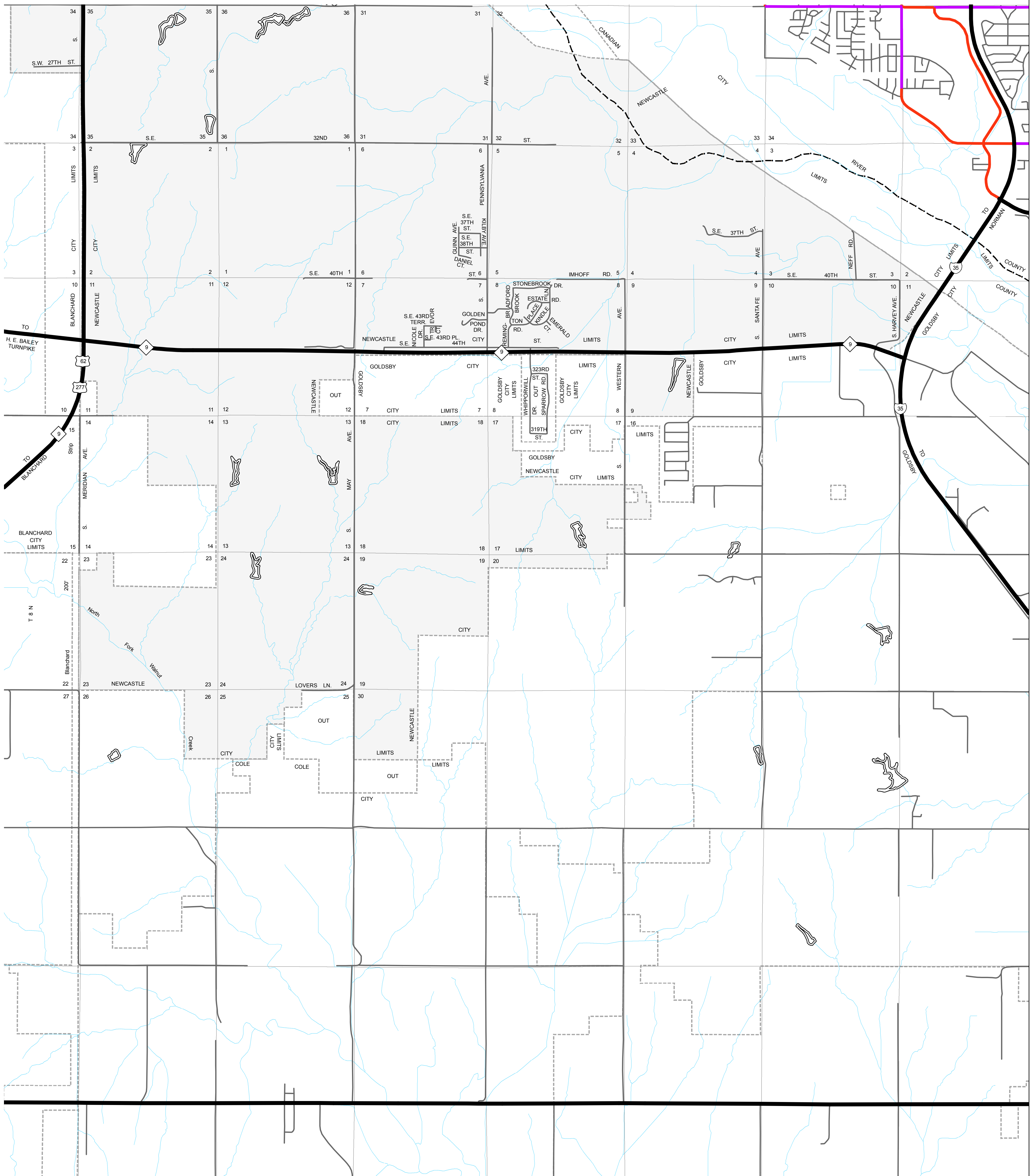
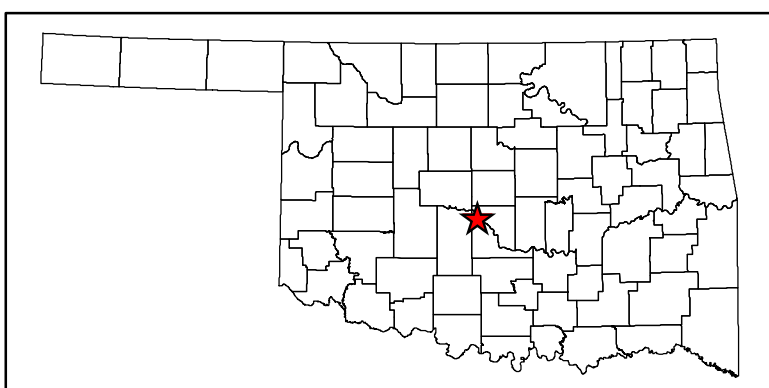
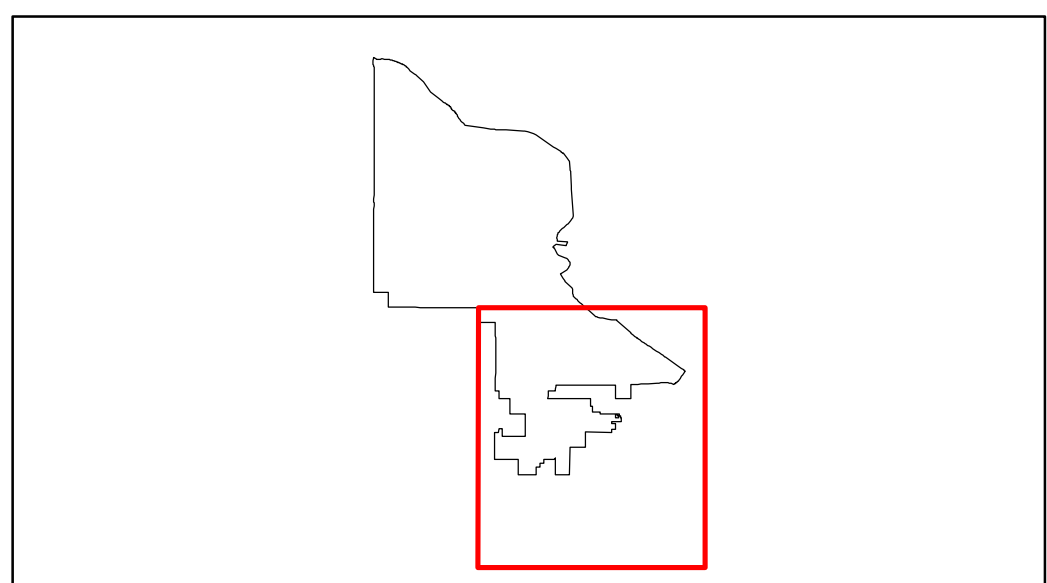
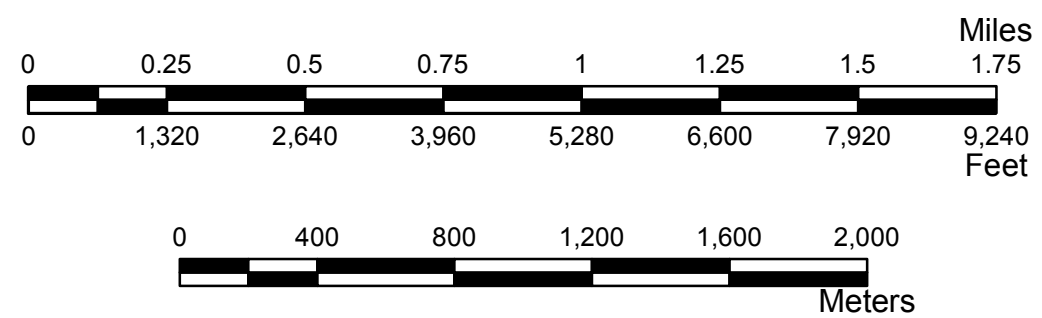

Copies of this map are available for public use at nominal cost.

OKLAHOMA DEPARTMENT OF TRANSPORTATION
PRINTING SERVICES Phone (405) 521-2586
200 N.E. 21st STREET
OKLAHOMA CITY, OKLAHOMA 73105-3204

This map indicates those roads known to the Department to be open to public travel. Placement of a road on the map has no relationship to maintenance responsibility by any level of government.

NEWCASTLE

© COPYRIGHT 2018
PRINTED AT STATE EXPENSE

NOT FOR RESALE

ALL RIGHTS RESERVED

COMPUTER GENERATED
NEWCASTLE, McCLAIN COUNTY
September 2018