

LINDSAY
 © COPYRIGHT 2018
 PRINTED AT STATE EXPENSE
 NOT FOR RESALE
 ALL RIGHTS RESERVED
 COMPUTER GENERATED
 September 2018
 LINDSAY, GARVIN COUNTY

Copies of this map are available for public use at nominal cost.
 OKLAHOMA DEPARTMENT OF TRANSPORTATION
 PRINTING SERVICES Phone (405) 521-2596
 200 N.E. 21st STREET
 OKLAHOMA CITY, OKLAHOMA 73105-3204

This map indicates those roads known to the Department to be open to public travel. Placement of a road on the map has no relationship to maintenance responsibility by any level of government.

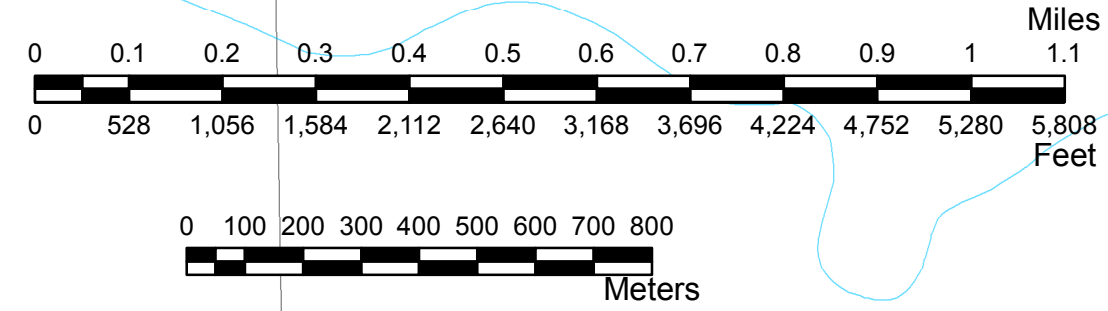
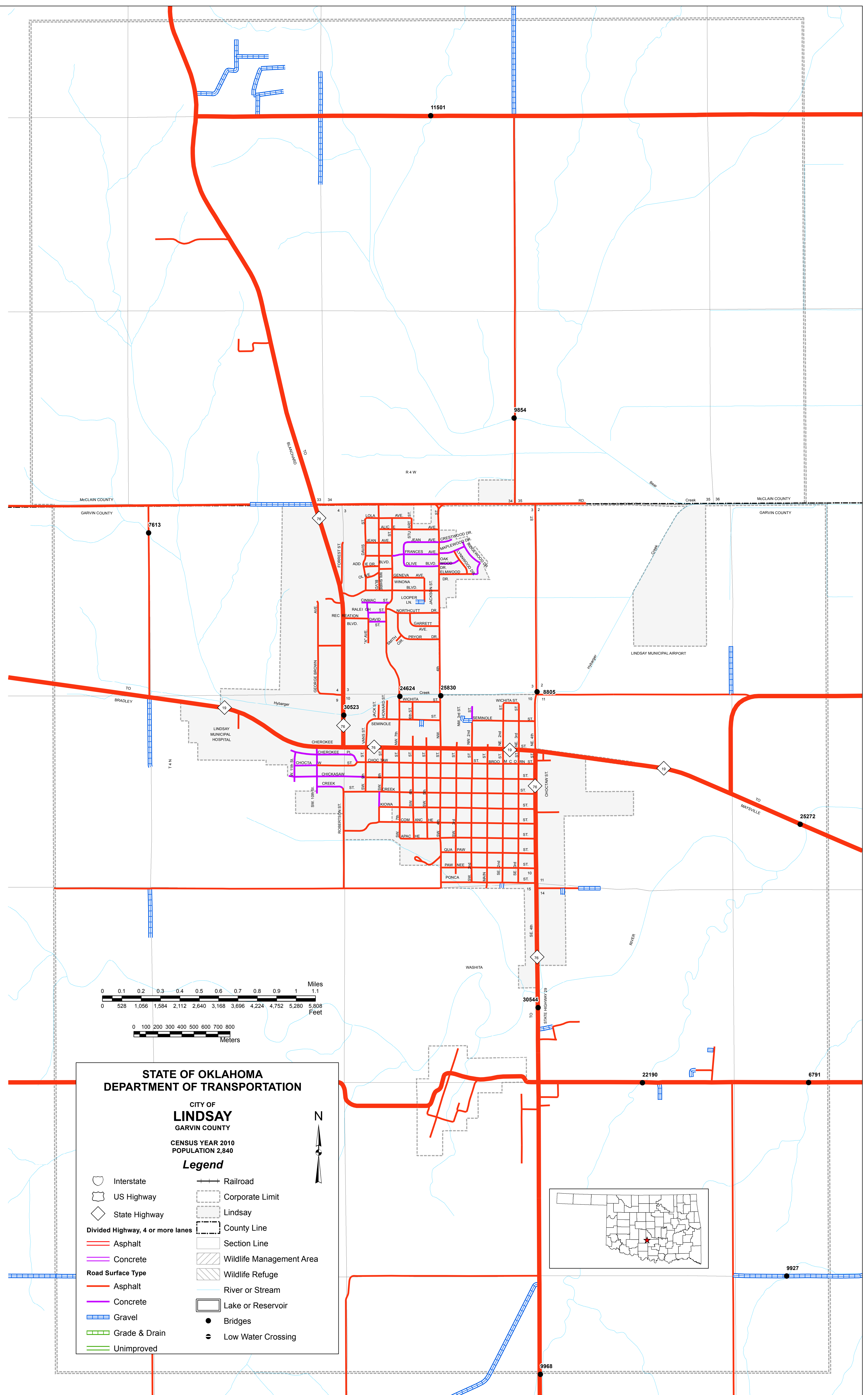

STATE OF OKLAHOMA
DEPARTMENT OF TRANSPORTATION

CITY OF LINDSAY
 GARVIN COUNTY

CENSUS YEAR 2010
 POPULATION 2,840

Legend

<ul style="list-style-type: none"> Interstate US Highway State Highway Divided Highway, 4 or more lanes Asphalt Concrete Road Surface Type Asphalt Concrete Gravel Grade & Drain Unimproved 	<ul style="list-style-type: none"> Railroad Corporate Limit Lindsay County Line Section Line Wildlife Management Area Wildlife Refuge River or Stream Lake or Reservoir Bridges Low Water Crossing
---	--

