

Copies of this map are available for public use at nominal cost.
 Address:
 OKLAHOMA DEPARTMENT OF TRANSPORTATION
 PRINTING SERVICES Phone (405) 521-2586
 200 N.E. 21st STREET
 OKLAHOMA CITY, OKLAHOMA 73105-3204

This map indicates those roads known to the Department to be open to public travel. Placement of a road on the map has no relationship to maintenance responsibility by any level of government.

Legend	
State Highway	County Line
U.S. Highway	Section Line
Interstate	US Military Installations
Divided Highway, 4 or more lanes	Wildlife Management Area
Asphalt	Wildlife Refuge
Concrete	River or Stream
Gravel	Lake or Reservoir
Grade & Drain	Bridges
Unimproved	Low Water Crossing
Railroad	
Corporate Limit	
Lawton	

**STATE OF OKLAHOMA
DEPARTMENT OF TRANSPORTATION**

CITY OF
LAWTON
COMANCHE COUNTY

CENSUS YEAR 2010
POPULATION 96,867

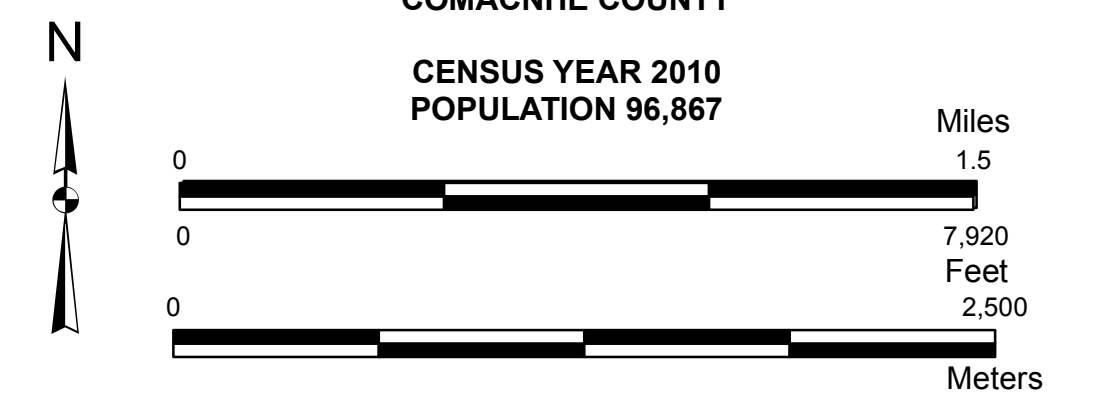

ALL RIGHTS RESERVED COMPUTER GENERATED September 2018

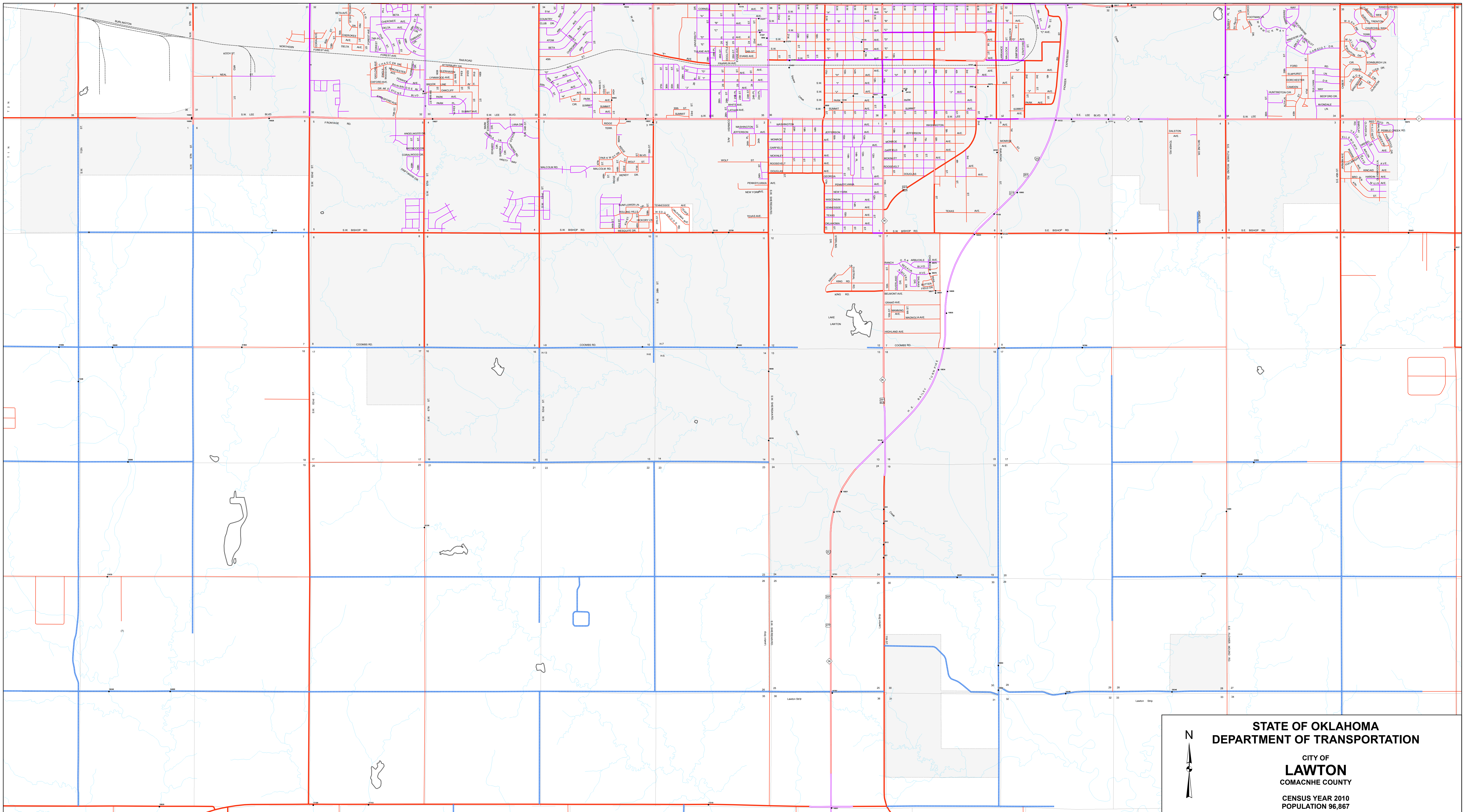

Copies of this map are available for public use at nominal cost.
 Address:
 OKLAHOMA DEPARTMENT OF TRANSPORTATION
 PRINTING SERVICES Phone (405) 521-2586
 200 N.E. 21st STREET
 OKLAHOMA CITY, OKLAHOMA 73105-3204

This map indicates those roads known to the Department to be open to public travel. Placement of a road on the map has no relationship to maintenance responsibility by any level of government.

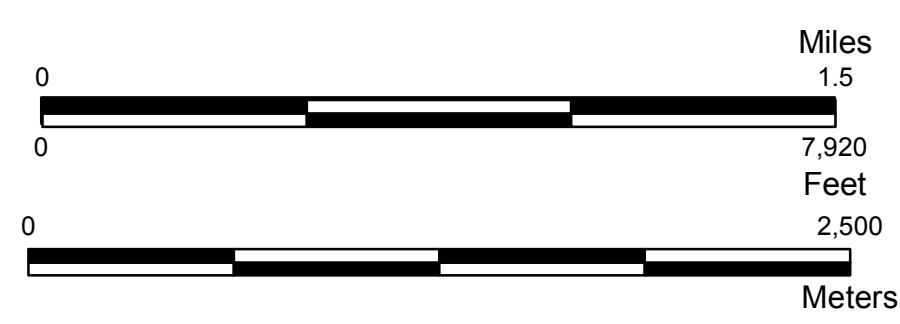
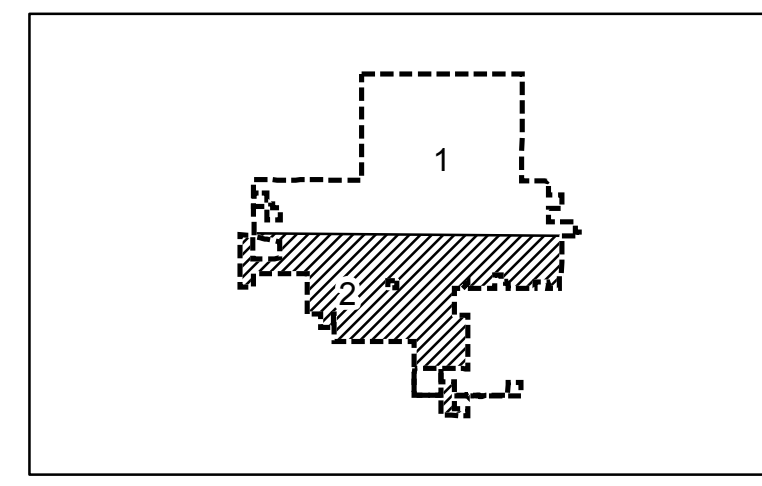
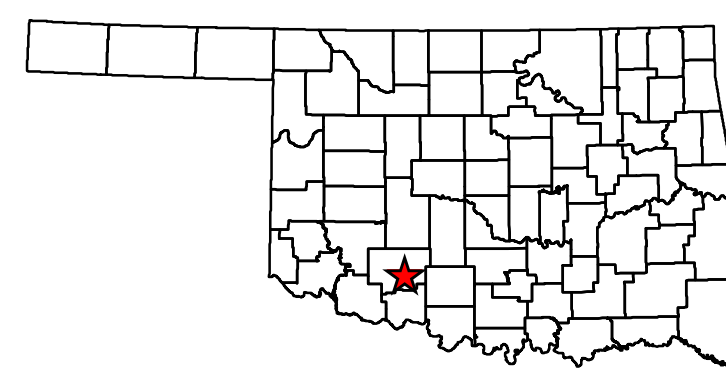

STATE OF OKLAHOMA
DEPARTMENT OF TRANSPORTATION

CITY OF
LAWTON
 COMANCHE COUNTY

CENSUS YEAR 2010
 POPULATION 96,867

Legend

<ul style="list-style-type: none"> State Highway U.S. Highway Interstate Divided Highway, 4 or more lanes Asphalt Concrete 	Road Surface Type <ul style="list-style-type: none"> Asphalt Concrete Gravel Grade & Drain Unimproved Railroad Corporate Limit Lawton 	<ul style="list-style-type: none"> County Line Section Line US Military Installations Wildlife Management Area Wildlife Refuge River or Stream Lake or Reservoir Bridges Low Water Crossing
--	--	---

ALL RIGHTS RESERVED COMPUTER GENERATED September 2018