

**STATE OF OKLAHOMA
DEPARTMENT OF TRANSPORTATION**

**CITY OF
GUTHRIE
LOGAN COUNTY**

CENSUS YEAR 2010
POPULATION 10,191

Legend

- | | | | |
|--|----------------------------------|--|--------------------------|
| | Interstate | | Railroad |
| | US Highway | | County Line |
| | State Highway | | Section Line |
| | Divided Highway, 4 or more lanes | | Corporate Limit |
| | Asphalt | | GUTHRIE |
| | Concrete | | Wildlife Management Area |
| | Road Surface Type | | Wildlife Refuge |
| | Asphalt | | River or Stream |
| | Concrete | | Lake or Reservoir |
| | Gravel | | Low Water Crossing |
| | Grade & Drain | | |
| | Unimproved | | |

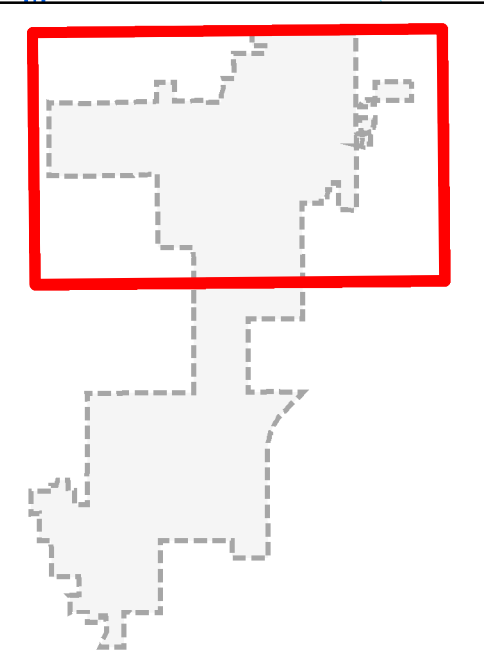

Copies of this map are available for public use at nominal cost.
Address:
OKLAHOMA DEPARTMENT OF TRANSPORTATION
PRINTING SERVICES Phone (405) 521-2586
200 N.E. 21st STREET
OKLAHOMA CITY, OKLAHOMA 73105-3204

This map indicates those roads known to the Department to be open to public travel. Placement of a road on the map has no relationship to maintenance responsibility by any level of government.

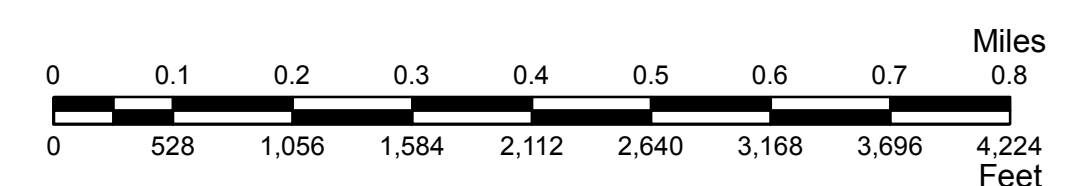

© COPYRIGHT 2018
PRINTED AT STATE EXPENSE

NOT FOR RESALE

ALL RIGHTS RESERVED COMPUTER GENERATED September, 2018

GUTHRIE, LOGAN COUNTY

GUTHRIE

STATE OF OKLAHOMA
DEPARTMENT OF TRANSPORTATION

CITY OF
GUTHRIE
LOGAN COUNTY
CENSUS YEAR 2010
POPULATION 10,191

Legend

- Interstate
- US Highway
- State Highway
- Divided Highway, 4 or more lanes
- Asphalt
- Concrete
- Road Surface Type: Asphalt
- Road Surface Type: Concrete
- Road Surface Type: Gravel
- Road Surface Type: Grade & Drain
- Road Surface Type: Unimproved
- Railroad
- County Line
- Section Line
- Corporate Limit
- GUTHRIE
- Wildlife Management Area
- Wildlife Refuge
- River or Stream
- Lake or Reservoir
- Low Water Crossing

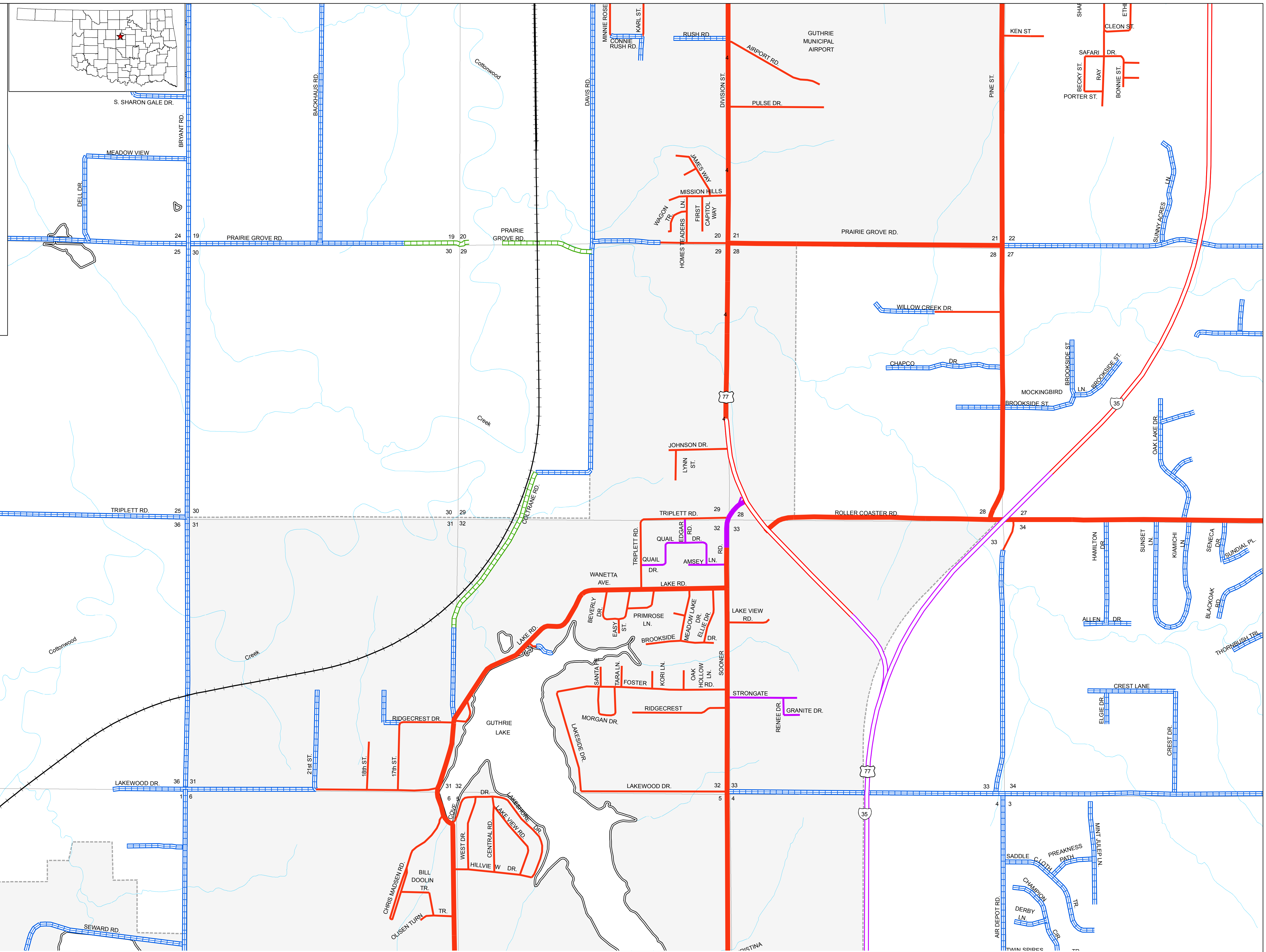
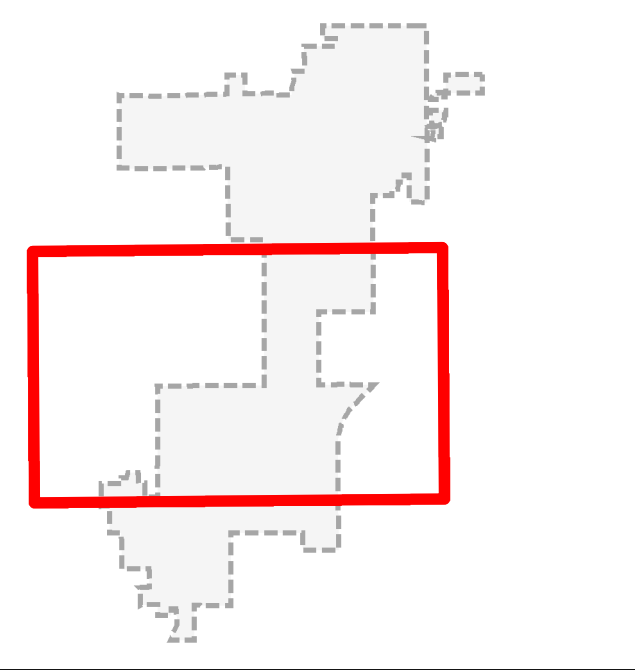

Copies of this map are available for public use at nominal cost.
Address:
OKLAHOMA DEPARTMENT OF TRANSPORTATION
PRINTING SERVICES Phone (405) 521-2586
200 N.E. 21st STREET
OKLAHOMA CITY, OKLAHOMA 73105-3204

This map indicates those roads known to the Department to be open to public travel. Placement of a road on the map has no relationship to maintenance responsibility by any level of government.

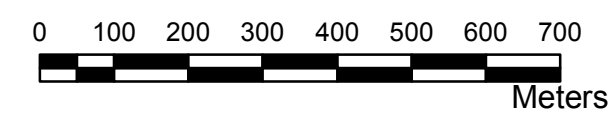
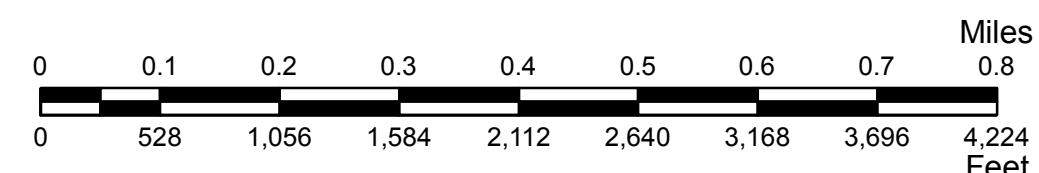

© COPYRIGHT 2018
PRINTED AT STATE EXPENSE

NOT FOR RESALE

ALL RIGHTS RESERVED COMPUTER GENERATED September, 2018

STATE OF OKLAHOMA
DEPARTMENT OF TRANSPORTATION

CITY OF
GUTHRIE
LOGAN COUNTY
CENSUS YEAR 2010
POPULATION 10,191

Legend

- | | | | |
|--|----------------------------------|--|--------------------------|
| | Interstate | | Railroad |
| | US Highway | | County Line |
| | State Highway | | Section Line |
| | Divided Highway, 4 or more lanes | | Corporate Limit |
| | Asphalt | | GUTHRIE |
| | Concrete | | Wildlife Management Area |
| | Road Surface Type | | Wildlife Refuge |
| | Asphalt | | River or Stream |
| | Concrete | | Lake or Reservoir |
| | Gravel | | Low Water Crossing |
| | Grade & Drain | | |
| | Unimproved | | |

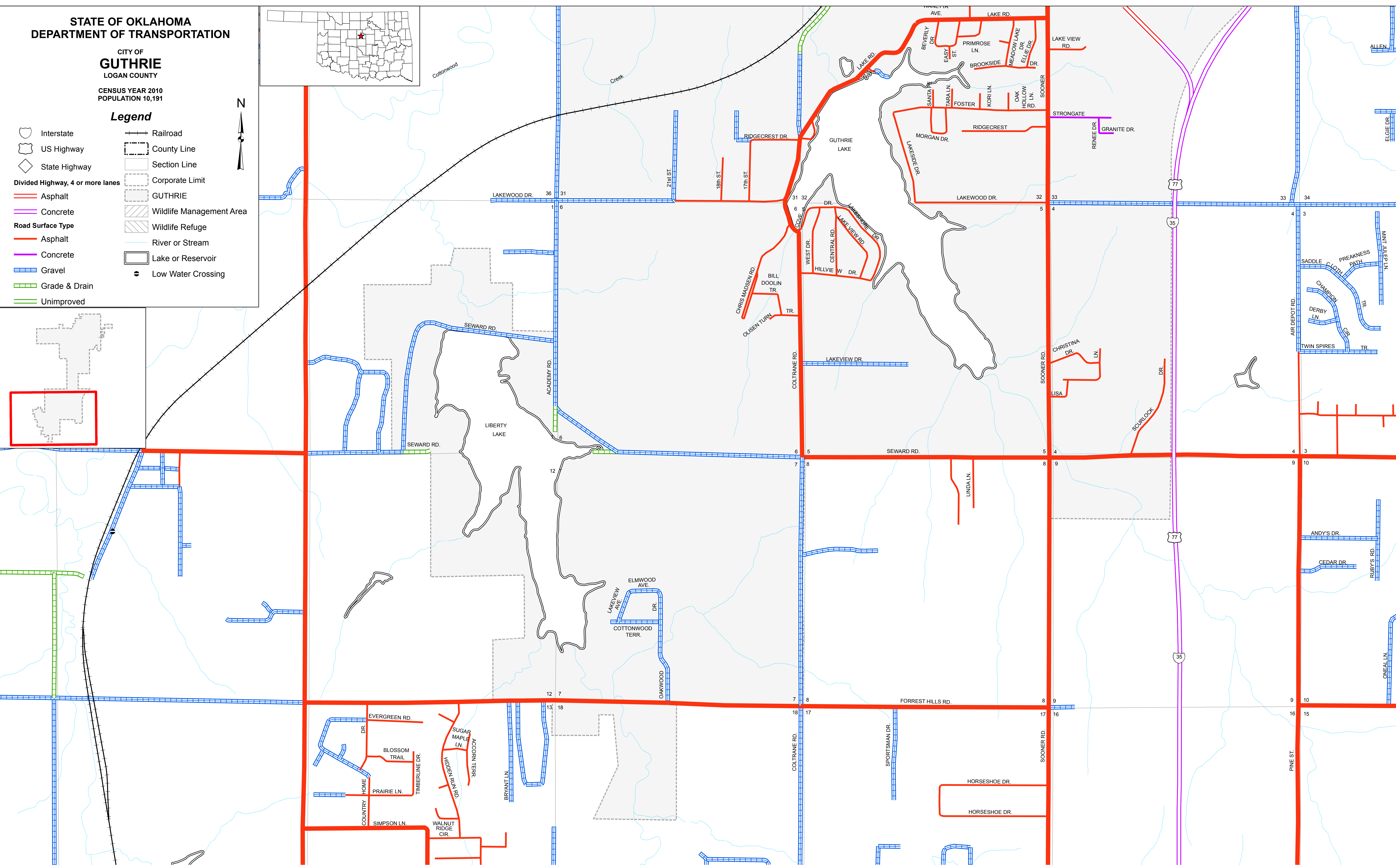
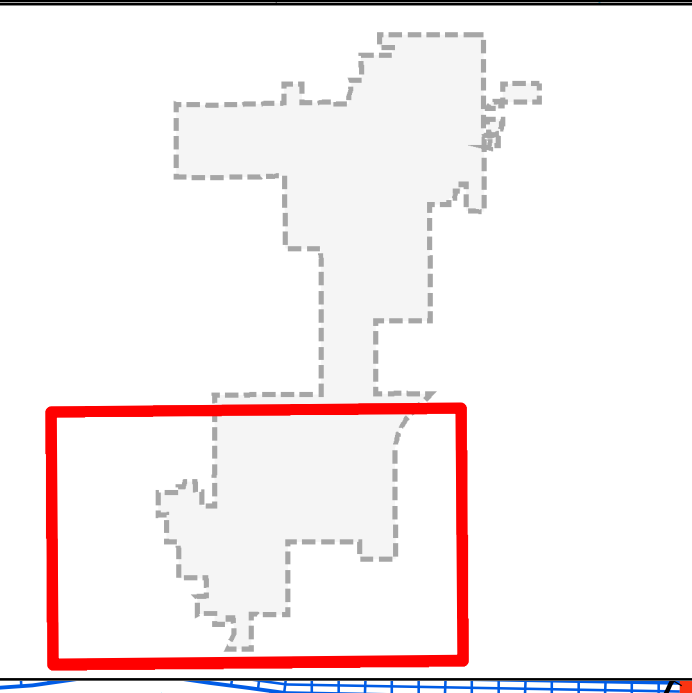
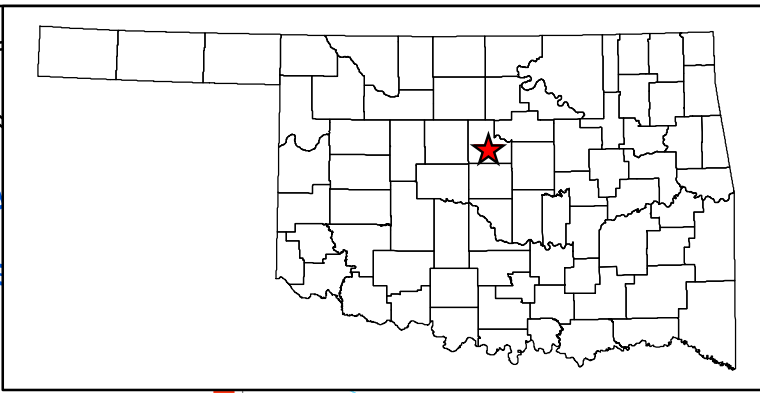

Copies of this map are available for public use at nominal cost.
Address:
OKLAHOMA DEPARTMENT OF TRANSPORTATION
PRINTING SERVICES Phone (405) 521-2586
200 N.E. 21st STREET
OKLAHOMA CITY, OKLAHOMA 73105-3204

This map indicates those roads known to the Department to be open to public travel. Placement of a road on the map has no relationship to maintenance responsibility by any level of government.

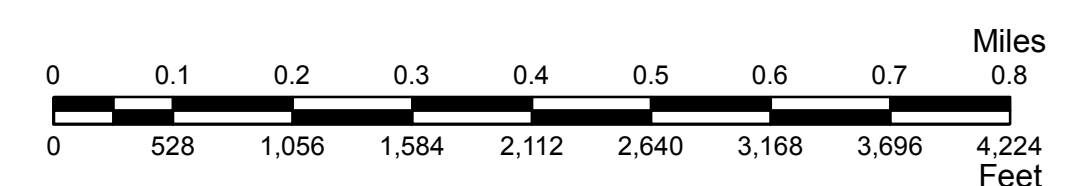

© COPYRIGHT 2018
PRINTED AT STATE EXPENSE

NOT FOR RESALE

ALL RIGHTS RESERVED COMPUTER GENERATED September, 2018