

BENNINGTON  
 OKLAHOMA DEPARTMENT OF TRANSPORTATION  
 PRINTING SERVICES Phone (405) 521-2595  
 200 N.E. 21st STREET  
 OKLAHOMA CITY, OKLAHOMA 73105-3204

Copies of this map are available for public use at nominal cost.

This map indicates those roads known to the Department to be open to public travel. Placement of a road on the map has no relationship to maintenance responsibility by any level of government.

© COPYRIGHT 2018  
 PRINTED AT STATE EXPENSE

NOT FOR RESALE

COMPUTER GENERATED September 2018  
 ALL RIGHTS RESERVED  
 BENNINGTON, BRYAN COUNTY

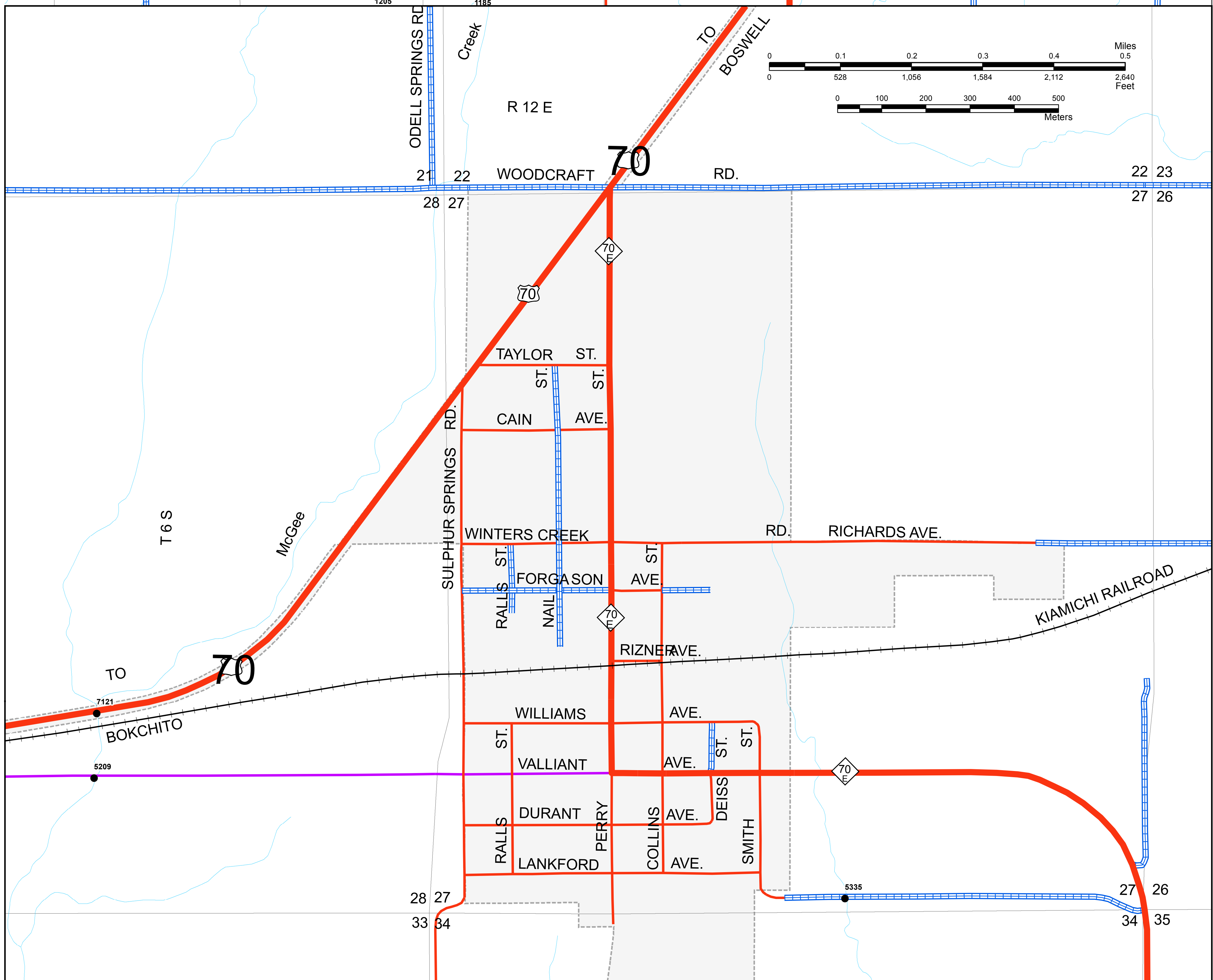
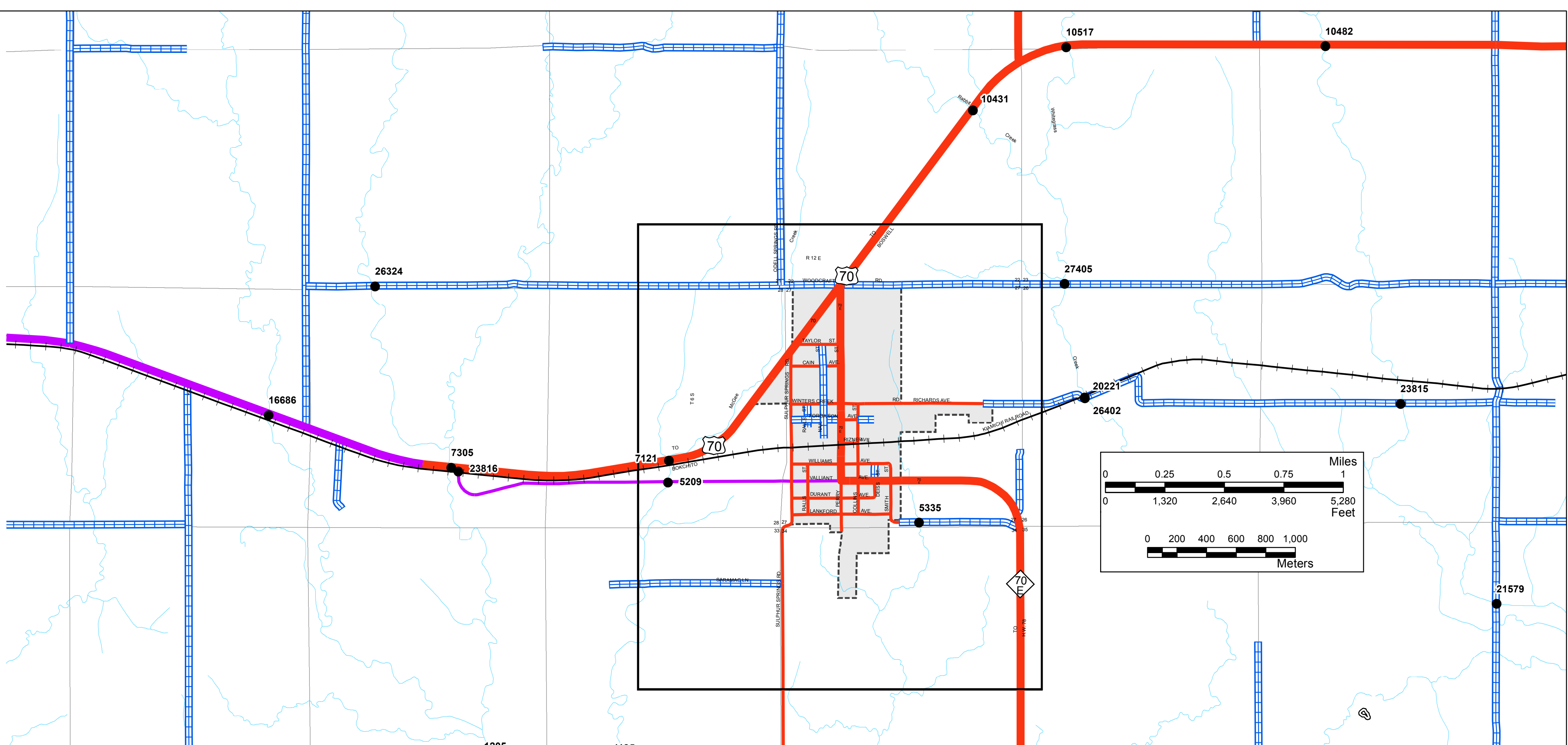

**STATE OF OKLAHOMA  
 DEPARTMENT OF TRANSPORTATION**

**CITY OF  
 BENNINGTON**  
 BRYAN COUNTY

CENSUS YEAR 2010  
 POPULATION 334

**Legend**

Interstate	Railroad	River or Stream
US Highway	Corporate Limit	Lake or Reservoir
State Highway	Bennington	Bridges
Divided Highway, 4 or more lanes	County Line	Low Water Crossing
Asphalt	Section Line	
Concrete	Wildlife Management Area	
<b>Road Surface Type</b>	Wildlife Refuge	
Asphalt		
Concrete		
Gravel		
Grade & Drain		
Unimproved		

