

Copies of this map are available for public use at nominal cost.  
 OKLAHOMA DEPARTMENT OF TRANSPORTATION  
 PRINTING SERVICES Phone (405) 521-2586  
 200 N.E. 21st STREET  
 OKLAHOMA CITY, OKLAHOMA 73105-3204

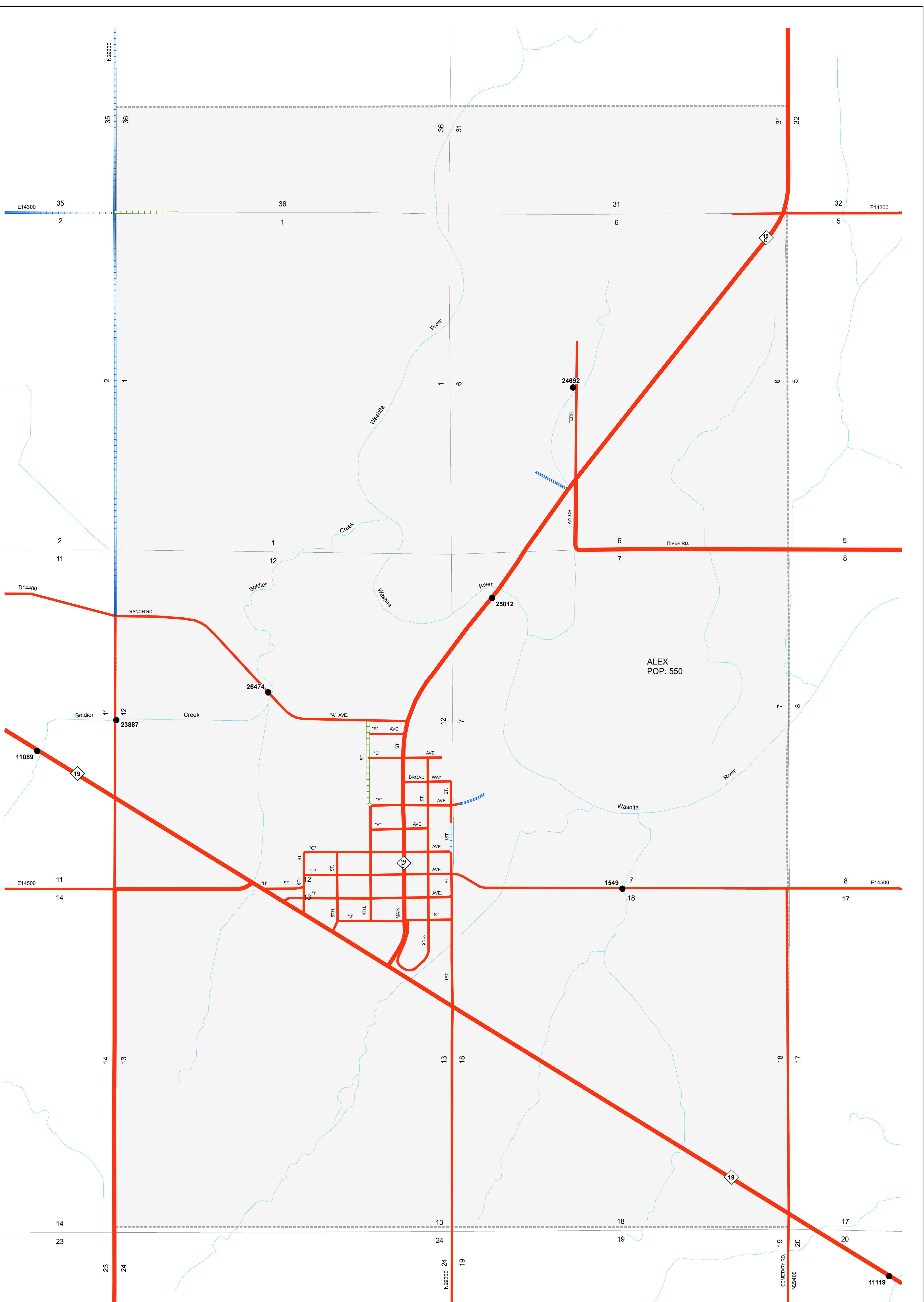

**Legend**

|                                  |                          |                          |                    |
|----------------------------------|--------------------------|--------------------------|--------------------|
| Interstate                       | <b>Road Surface Type</b> | Corporate Limit          | Bridges            |
| State                            | Asphalt                  | ALEX                     | Low Water Crossing |
| US                               | Concrete                 | County Line              | River or Stream    |
| Railroad                         | Gravel                   | Section Line             | Lake or Reservoir  |
| Divided Highway, 4 or more lanes | Grade & Drain            | Wildlife Management Area |                    |
| Asphalt                          | Unimproved               | Wildlife Refuge          |                    |
| Concrete                         |                          |                          |                    |

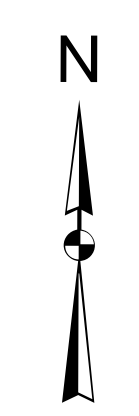
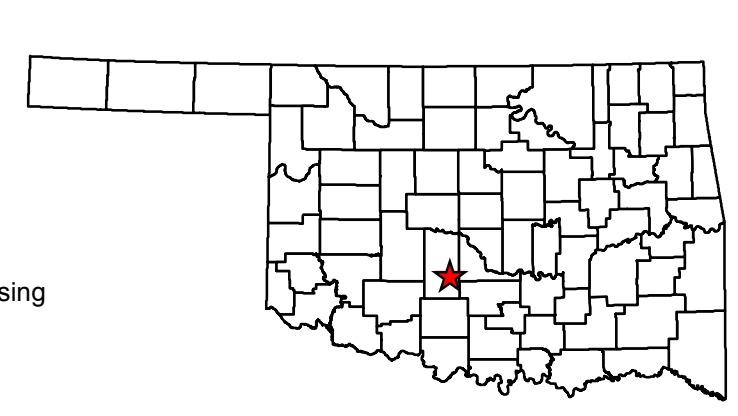

**STATE OF OKLAHOMA**  
**DEPARTMENT OF TRANSPORTATION**  
 CITY OF  
**ALEX**  
 GRADY COUNTY  
 CENSUS YEAR 2010  
 POPULATION 550

