

NON-DOWELED CONTRACTION JOINT

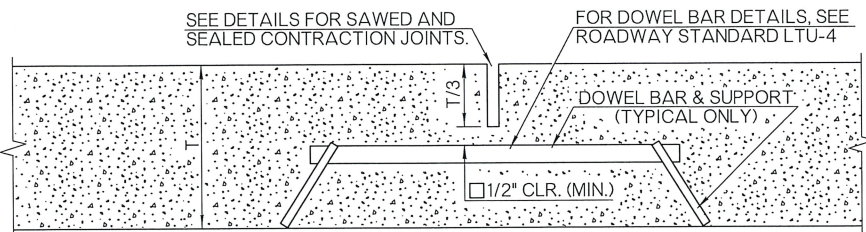

DOWELED CONTRACTION JOINT

ON JOINTED PORTLAND CEMENT CONCRETE PAVEMENTS, DOWELED CONTRACTION JOINTS SHALL BE USED ON DRIVING LANES ONLY. CONCRETE SHOULDERS SHALL NOT BE DOWELED UNLESS SPECIFIED ON THE PLANS.

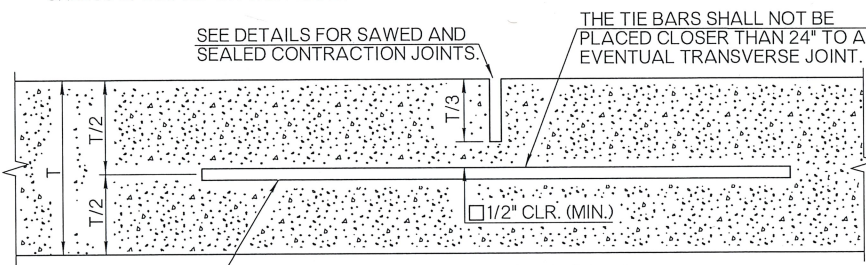

LONGITUDINAL JOINT

NO. 4 DEF. TIE BARS; 2'-6" LONG AT 2'-6" CTRS. TO BE SUPPORTED AT EACH END BY AN APPROVED BAR SUPPORT OR PLACED BY AN APPROVED MECHANICAL DEVICE INTO THE FRESH CONCRETE.

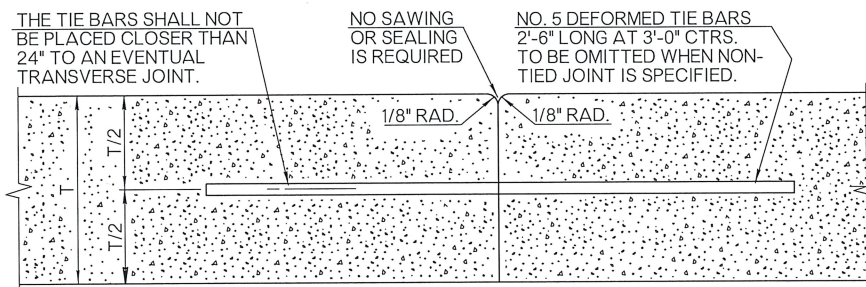

TIED BUTT JOINT AND LONGITUDINAL CONSTRUCTION JOINT

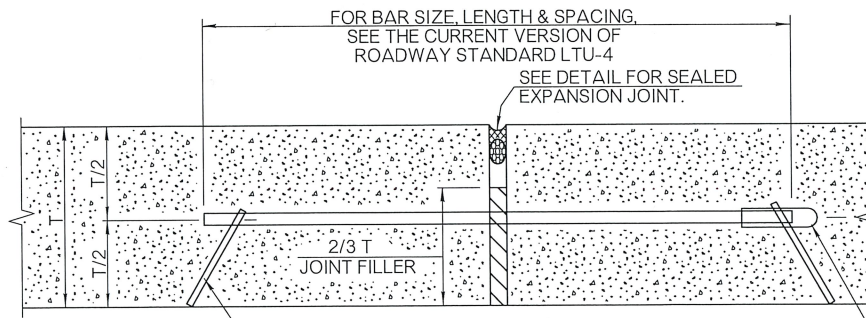

EXPANSION JOINT / ISOLATION JOINT
OMIT DOWEL BARS, CAPS & SUPPORTS FOR ISOLATION JOINTS

FOR DOWEL BAR SUPPORT DETAIL, SEE THE CURRENT VERSION OF ROADWAY STANDARD LTU-4

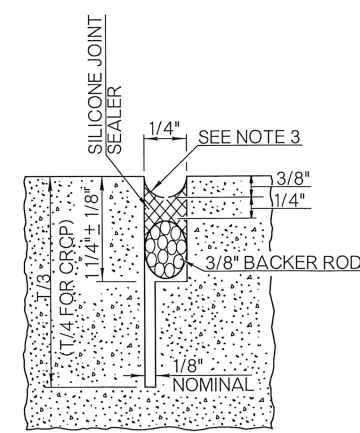

SILICONE SEALANT OPTION

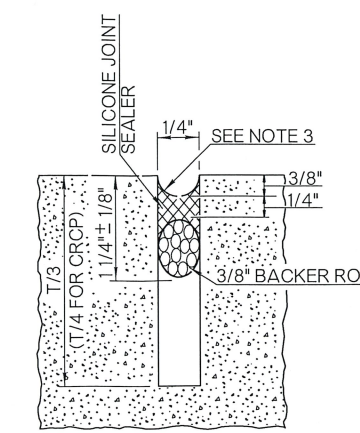

SILICONE SEALANT OPTION

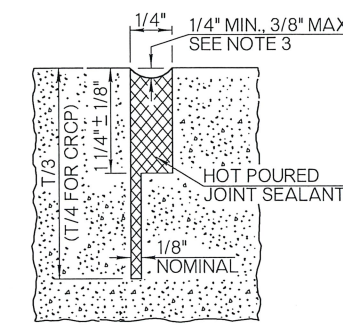

HOT POUR OPTION

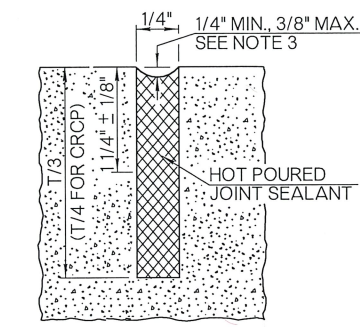

HOT POUR OPTION

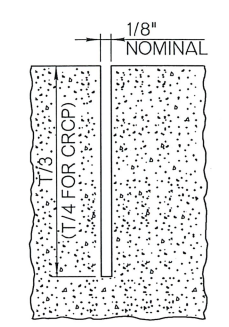

NO SEALANT OPTION

NOTE: ON ALL SAWED JOINTS, THE KERF DEPTH SHALL CLEAR DOWEL BARS, TIE BARS AND/OR REINFORCING STEEL BY A MINIMUM OF 1/2".

SAWED AND SEALED, CONTRACTION AND LONGITUDINAL JOINTS ALTERNATE DETAILS UNLESS OTHERWISE SPECIFIED IN THE PLANS, ONLY THE SILICONE SEALANT OPTIONS WILL BE ALLOWED.

WHERE CURB IS CONSTRUCTED SEPARATE FROM THE SLAB & SECURED BY PINS, THE CURB SHALL BE SAW CUT UP THE FACE AND ACROSS THE TOP OF THE CURB AT LOCATIONS OF ALL CONTRACTION JOINTS. JOINT SEALER WILL BE REQUIRED IN CUTS IN THE CURB.

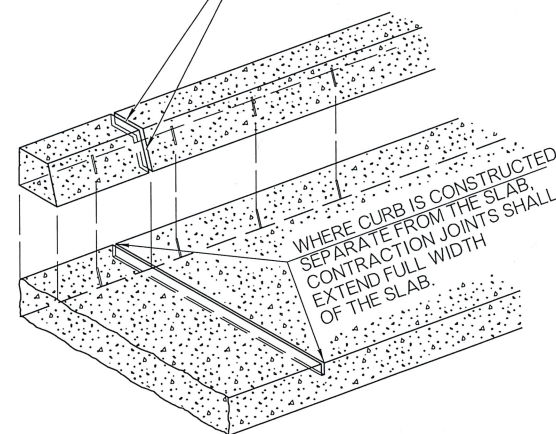

CONTRACTION JOINT WITH SEPARATE CURB

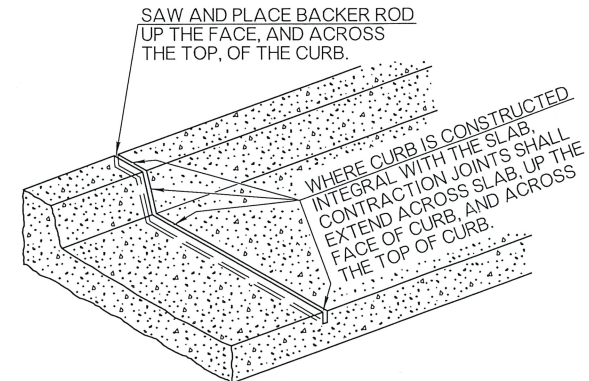

CONTRACTION JOINT WITH INTEGRAL CURB

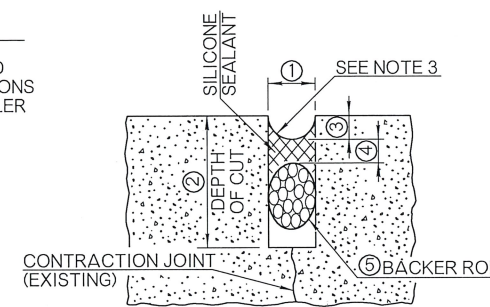

JOINT REHABILITATION DETAILS

JOINT REHABILITATION TREATMENT TABLE				
SILICONE SEALANT				
JOINT WIDTH	DEPTH OF CUT	SEALANT RECESS DEPTH	SEALANT THICKNESS	BACKER ROD DIAMETER
①	②	③	④	⑤
3/8"	1 1/4"	3/8"	3/16"	1/2"
1/2"	1 3/4"	3/8"	1/4"	5/8"
3/4"	1 3/4"	3/8"	3/8"	7/8"
7/8"	1 3/4"	1/2"	7/16"	1"
1"	2"	1/2"	1/2"	1 1/8"
OVER 1"	OVER 2"	1/2"	1/2"	1 1/4"

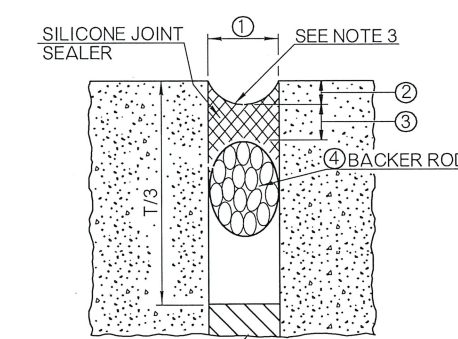

EXPANSION JOINTS / ISOLATION JOINTS
HOT POURED JOINT SEALANT MAY BE USED IN LIEU OF BACKER ROD AND SILICONE SEALANT, IF APPROVED BY THE ENGINEER

EXPANSION JOINT / ISOLATION JOINT TREATMENT TABLE			
JOINT WIDTH	SEALANT RECESS DEPTH	SILICONE SEALANT THICKNESS	BACKER ROD DIAMETER
①	②	③	④
1/2"	3/8"	1/4"	5/8"
3/4"	3/8"	3/8"	7/8"
1"	3/8"	1/2"	1 1/4"
1 1/2"	1/2"	3/4"	2"
2"	1/2"	3/4"	2 1/2"

EXPANSION OR ISOLATION JOINT WIDTH SHALL BE 1/2", UNLESS OTHERWISE SPECIFIED ON THE PLANS. TABLE VALUES, AS SHOWN IN THIS TABLE, SHALL BE USED IN THOSE SPECIFIED CASES.

- GENERAL NOTES
- ALL CONSTRUCTION AND MATERIALS REQUIREMENTS SHALL BE IN ACCORDANCE WITH THE 2009 ODOT STANDARD SPECIFICATIONS.
 - ALL CONCRETE JOINT SEALING SHALL BE IN ACCORDANCE WITH SECTION 415 OF THE SPECIFICATIONS.
 - THE SHAPE FACTOR, COMBINED WITH THE JOINT CLEANLINESS, IS THE CRITICAL COMBINATION NECESSARY TO GUARANTEE DESIRED BONDING AND FUNCTION OF SEALED JOINTS. THE JOINT SHAPE FACTOR IS DEFINED AS THE FINAL PRESSED SHAPE OF THE SILICONE MATERIAL. THE TOOLING OPERATION WILL FIRMLY PRESS THE FRESHLY APPLIED MATERIAL INTIMATELY AGAINST THE CUT SIDES OF THE RECESS AND THE BACKER ROD SURFACES. THE ROUNDED SHAPE ON TOP AND BOTTOM OF THE SILICONE ALLOWS THE SEALANT TO PROPERLY FLEX BUT MAINTAIN ADHERENCE TO THE PAVING. SELF LEVELING SEALANTS WILL BE INSTALLED TO BE FLUSH WITH THE PAVEMENT SURFACE, OR BY MANUFACTURER'S RECOMMENDATION.
 - LONGITUDINAL JOINTS BETWEEN PAVEMENT AND TIED CONCRETE SHOULDERS SHALL NOT BE SAWED OR SEALED UNLESS OTHERWISE SHOWN ON THE PLANS.
 - CONTRACTION JOINTS IN JOINTED P. C. PAVEMENT SHALL BE AT APPROXIMATELY 15'-0" CENTERS, UNLESS OTHERWISE SPECIFIED ON THE PLANS.
 - TRANSVERSE GROOVING SHALL BE CONSTRUCTED TO THE FOLLOWING DIMENSIONS: 1/8" TO 3/16" WIDE, 1/8" TO 3/16" DEEP, AND EQUALLY SPACED AT 1/2" TO 1" APART. GROOVES SHALL BE NEAT IN APPEARANCE, OF UNIFORM DEPTH, AND LOCATED 1" TO 3" FROM NEAREST CONTRACTION JOINTS.

APPROVED BY ROADWAY ENGINEER: *Colton A.* DATE: 04/23/19

ROADWAY DESIGN DIVISION STANDARD

DOT JOINTS AND SEALERS - LONGITUDINAL, EXPANSION / ISOLATION, & CONTRACTION