

OKLAHOMA DEPARTMENT OF TRANSPORTATION — CONTROL SECTION LOG ---- WASHINGTON COUNTY

CONTROL	ROUTE	LENGTH	STARTING DESRIPTION	DIRECTION	ENDING DESCRIPTION	NOTES
7402	US 60	6.98	JCT. US 75 (WASHINGTON BLVD)IN BARTLESVILLE	EASTERLY	NOWATA COUNTY LINE	
7408	US 75	19.17	JCT. US 60 IN BARTLESVILLE	NORTHERLY	KANSAS STATE LINE	
7410	SH 11	1.25	OSAGE COUNTY LINE	SOUTHERLY	TULSA COUNTY LINE	
7413	SH 123	4.89	JCT US 60 (WESTERN & 2ND) BARTLESVILLE	NORTHEASTERLY	JCT. US 75(OSAGE ST & DURHAM AVE)IN DEWEY	
7420	SH 10	7.96	JCT. US 75 S. OF COPAN	WEST & NORTHERLY	OSAGE COUNTY LINE	
7421	US 75	21.12	TULSA COUNTY LINE	NORTHERLY	JCT. US 60 IN BARTLESVILLE	
7422	US 60	3.74	JCT SH 123 (WESTERN & ADAMS) BARTLESVILLE	EASTERLY	JCT. US 75 (WASHINGTON BLVD) E. END BRIDGE.	REINVENTORIED 2005 (3.77 MI. BEFORE)
7424	SH 10	6.41	NOWATA COUNTY LINE	WESTERLY	JCT. US 75 N.E. EDGE OF COPAN	

71.52 TOTAL COUNTY MILEAGE

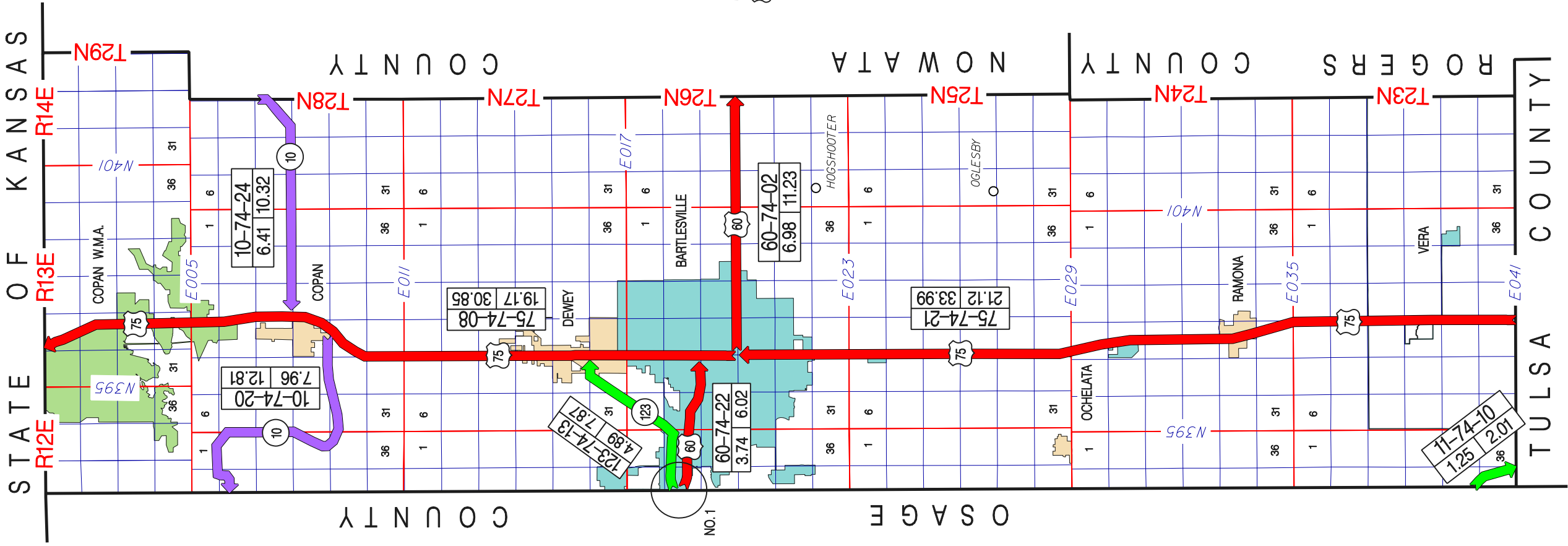

INSET NO.1

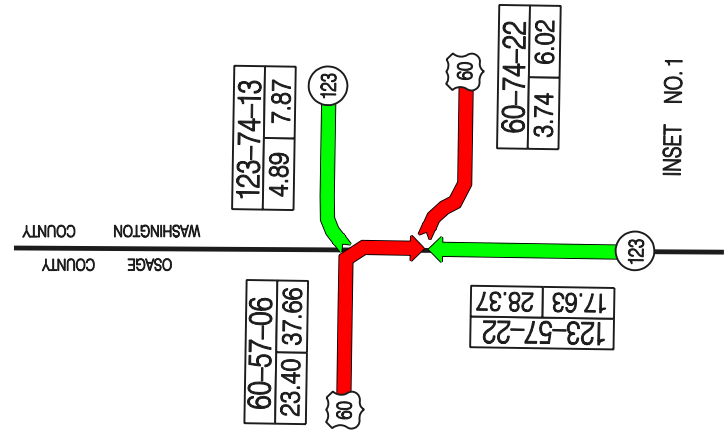

INSET NO.1

STATE OF KANSAS

COUNTY

NOWATA

COUNTY

ROGERS

TULSA COUNTY

COUNTY

OSAGE

