

OKLAHOMA DEPARTMENT OF TRANSPORTATION — CONTROL SECTION LOG ---- TULSA COUNTY

CONTROL	ROUTE	LENGTH	STARTING DESCRIPTION	DIRECTION	ENDING DESCRIPTION	NOTES
7206	US 64	14.81	JCT. US 169 (N. SIDE STRUCTURE)	SOUTH & EASTERLY	WAGONER COUNTY LINE	
7208	IS 44	1.10	CREEK COUNTY LINE	NORTHERLY	JCT. I-244 (N. BOUND GORE PT.)	
7209	IS 244	16.28	JCT.I-44 (E.BOUND GORE POINT)	NORTH & EASTERLY	JCT.I-44 IN TULSA (I-44 E. BD.GORE POINT)	LENGTH CORRECTED FROM 15.75 (2005)
7217	US 75	6.08	OKMULGEE COUNTY LINE	NORTHERLY	JCT SH 67 IN GLENPOOL (N. SIDE STR.)	
7218	US 75	11.79	JCT SH 67 IN GLENPOOL (N. SIDE STR.)	NORTHERLY	JCT. I-244 (N. BOUND GORE PT.)	
7220	SH 51	1.21	JCT. SH 97 IN SAND SPRINGS	NORTHERLY	JCT. US 64 IN SAND SPRINGS (N. SIDE STR.)	
7231	SH 266	2.10	JCT. US 169 (W. SIDE STR.)	EASTERLY	ROGERS COUNTY LINE	
7236	SH 11	15.74	WASHINGTON COUNTY LINE	SOUTHERLY	JCT SH 11(36TH ST & PEORIA AVE)IN TULSA	
7246	SH 20	0.55	OSAGE COUNTY LINE	EASTERLY	JCT. SH 11(CINCINNATI & ROGERS)IN SKIATOOK	
7250	SH 20	9.60	JCT. SH 11(CINCINNATI & ROGERS)IN SKIATOOK	EASTERLY	JCT. US 169 EAST OF COLLINSVILLE	
7254	SH 20	0.49	JCT. US 169 N.E. OF OWASSO	EASTERLY	ROGERS COUNTY LINE	
7260	TOLL RD	0.97	CREEK COUNTY LINE	EASTERLY	JCT US 75 (WEST SIDE STRUCTURE)	CREEK T.P.
7262	TOLL RD	7.32	JCT US 169 (W. SIDE STR)	SOUTHEASTERLY	WAGONER COUNTY LINE	CREEK T.P. (CONSTRUCTION 2002)
7274	SH 67	8.02	CREEK COUNTY LINE	EASTERLY	JCT. US 64(MEMORIAL & E. 151ST)IN BIXBY	
7276	SH 97	3.00	CREEK COUNTY LINE	NORTHERLY	JCT. SH 51 IN SAND SPRINGS	
7277	SH 97	2.08	JCT. US 64 IN SAND SPRINGS (N. SIDE STR.)	NORTHERLY	OSAGE COUNTY LINE	
7278	IS 44	14.47	JCT. I-244 (N. BOUND GORE)	NORTHEASTERLY	ROGERS COUNTY LINE (E. SIDE STR.)	
7280	SH 51	14.44	JCT. I-444	SOUTHEASTERLY	WAGONER COUNTY LINE	BROKEN ARROW FREEWAY
7281	US 169	17.46	JCT. I-44 (N. END STR.)	NORTHERLY	ROGERS COUNTY LINE	MINGO VALLEY FREEWAY
7282	SH 117	1.01	CREEK COUNTY LINE	EASTERLY	JCT. US 75, N. OF GLENPOOL(E. SIDE STR.)	
7283	US 169	9.10	JCT US 64 (E. SIDE STRUCTURE)	NORTHERLY	JCT. I-44 (N. END STR.)	
7284	SH 135	0.40	MAIN ST & 2ND AVE IN OWASSO	EASTERLY	JCT US 169 (E. SIDE STR.)	
7285	SH 51	10.41	CREEK COUNTY LINE	EASTERLY	JCT. SH 97 IN SAND SPRINGS	
7286	US 64	15.35	OSAGE COUNTY LINE	EASTERLY	JCT. I-244 (MERGE PT. E BND.64 & E BND.244)	KEYSTONE FREEWAY
7287P	P & S	0.00	CREEK COUNTY LINE	NORTHERLY	OSAGE COUNTY LINE	SEQUOYAH LOOP EXPRESSWAY
7288P	P & S	0.00	JCT. I-244 (N. BND. GORE POINT)	NORTHERLY	OSAGE COUNTY LINE	OSAGE FREEWAY
7289P	P & S	0.00	OSAGE COUNTY LINE	NORTHERLY	OSAGE COUNTY LINE	OSAGE FREEWAY
7290	SH 11	5.45	JCT US 75 (E. BND GORE POINT) IN TULSA	EAST & SOUTH	JCT. I-244 (S. SIDE STR.)	GILCREASE FREEWAY
7290P	P & S	0.00	OSAGE COUNTY LINE	EASTERLY	JCT SH 11 EXISTING GILCREASE FREEWAY	
7291	US 169	0.16	ROGERS COUNTY LINE	NORTHEASTERLY	ROGERS COUNTY LINE	
7291P	P & S	0.00	JCT US 64 (W. OF SAND SPRINGS)	NORTHERLY	OSAGE COUNTY LINE	
7292	IS 444	1.45	JCT SH 51(E. BOUND GORE POINT)	NORTHERLY	JCT. I-244 (N. SIDE STR.)	E. SIDE INNER DISPERSAL LOOP
7293	US 75	19.48	JCT. I-244(N. SIDE STR.)	NORTHERLY	WASHINGTON COUNTY LINE	CHEROKEE FREEWAY
7294	IS 444	1.32	JCT I-244	EASTERLY	JCT SH 51	BROKEN ARROW FREEWAY
7295	SH 11	1.70	JCT. SH 11 NORTH (PEORIA AVE.)	EASTERLY	JCT. US 75	
7297	SH 151	2.30	JCT. SH 51 (S. SIDE STR.)	NORTHERLY	JCT. US 64 (N. SIDE STR.)	
7298	TOLL RD	7.42	US 75 W. SIDE STRUCTURE (W. OF JENKS)	EASTERLY	US 64 E. SIDE STRUCTURE	CREEK T.P.

223.06 TOTAL COUNTY MILEAGE

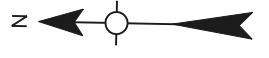

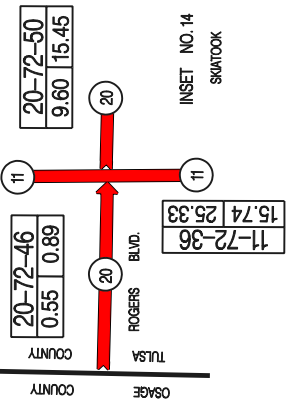
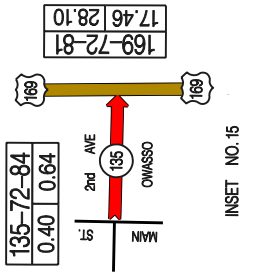
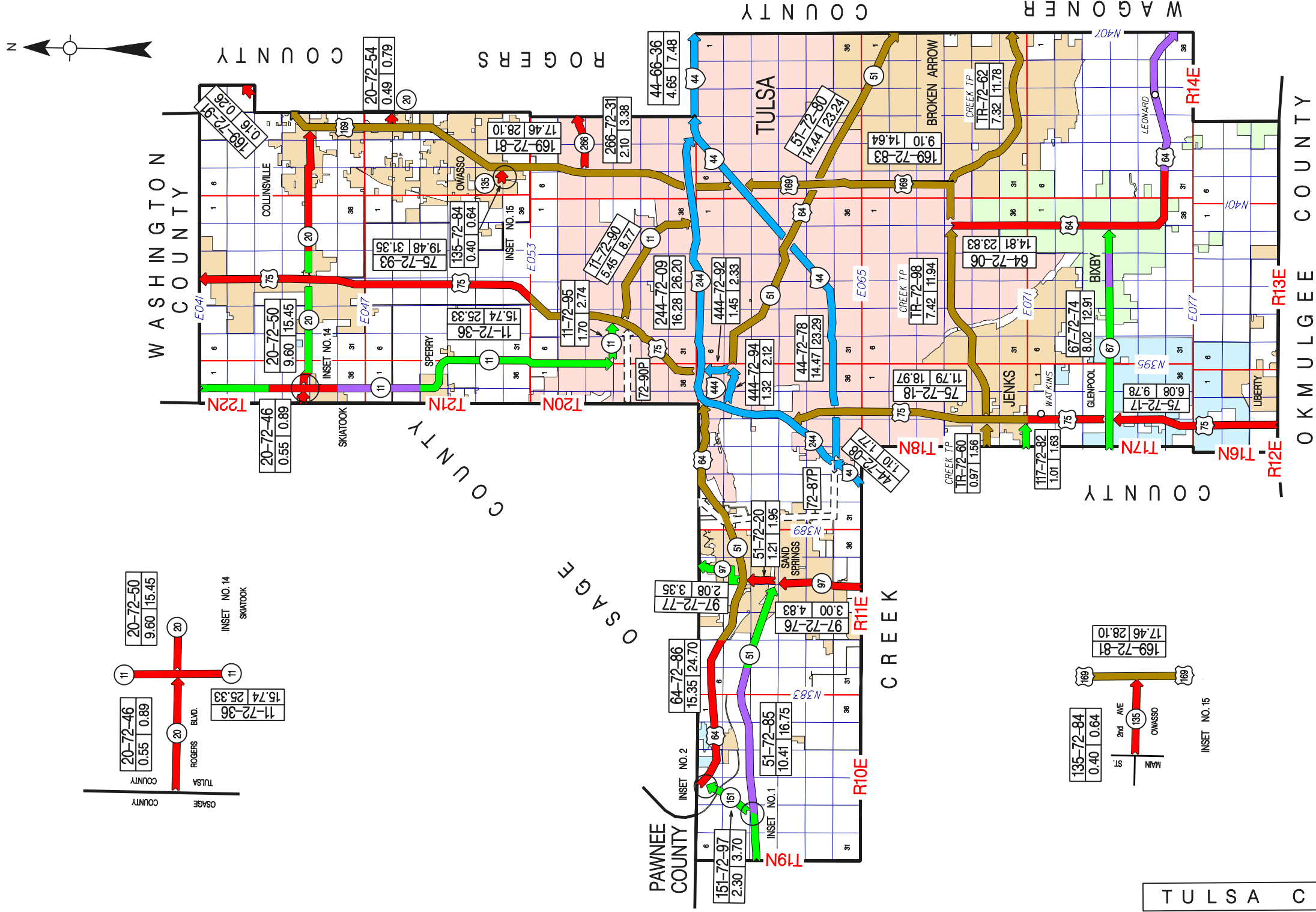
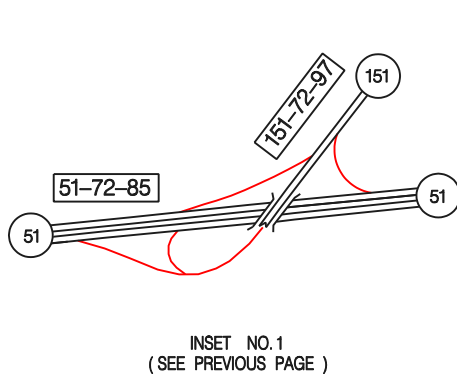

INSET NO. 1
(SEE PREVIOUS PAGE)

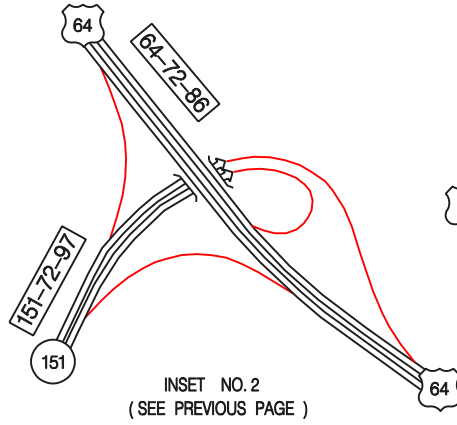

INSET NO. 2
(SEE PREVIOUS PAGE)

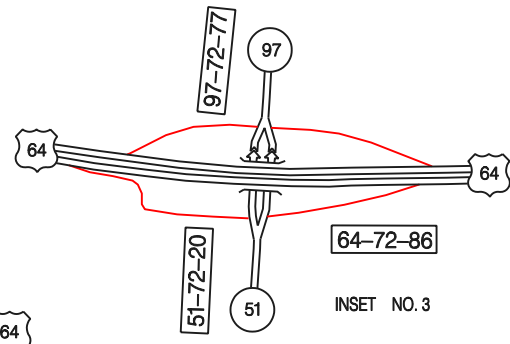

INSET NO. 3

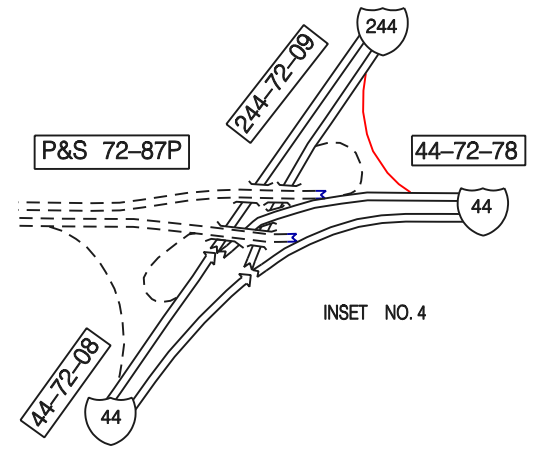

INSET NO. 4

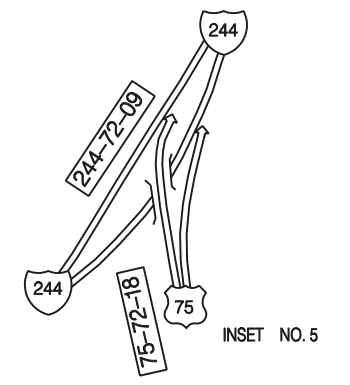

INSET NO. 5

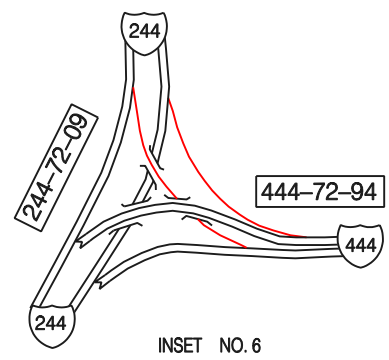

INSET NO. 6

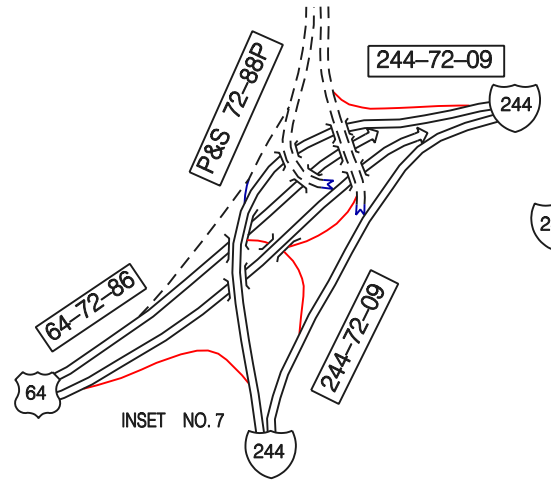

INSET NO. 7

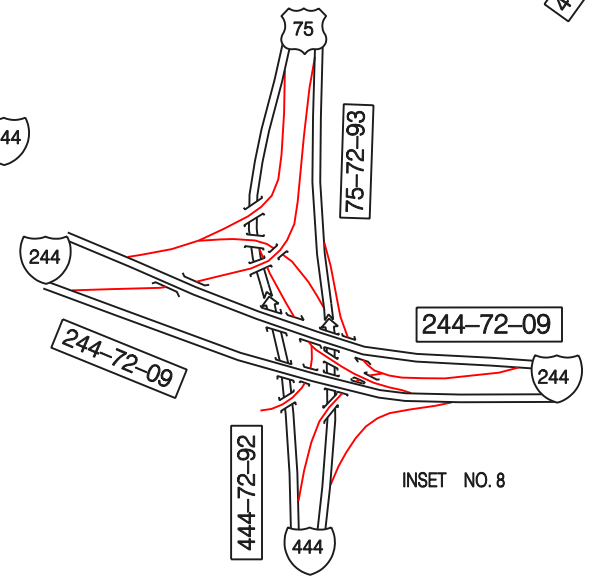

INSET NO. 8

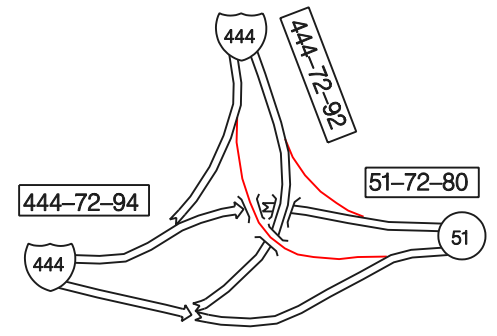

INSET NO. 9

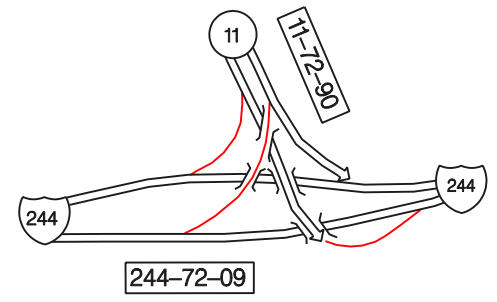

INSET NO. 10

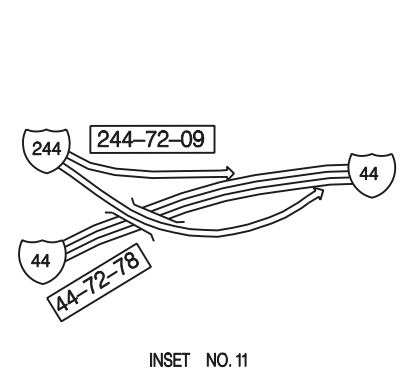

INSET NO. 11

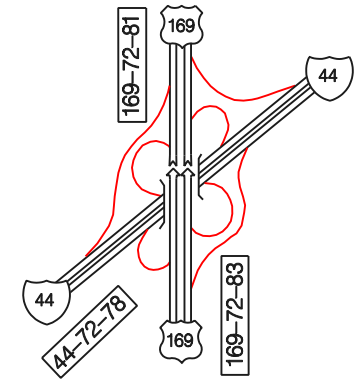

INSET NO. 12

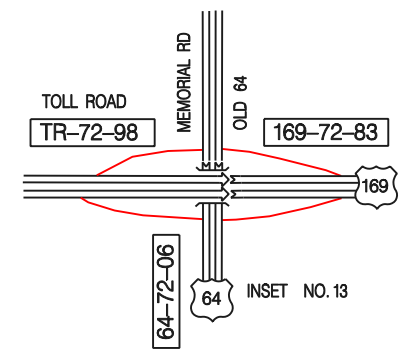

INSET NO. 13

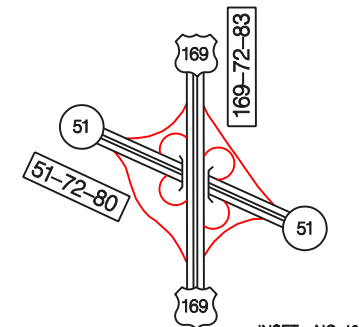

INSET NO. 16

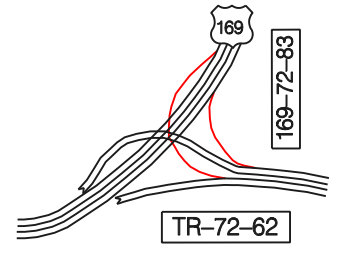

INSET NO. 17

* SEE PREVIOUS PAGE
FOR INSET 14 & 15

OSAGE COUNTY

ROGERS COUNTY

WAGONER COUNTY

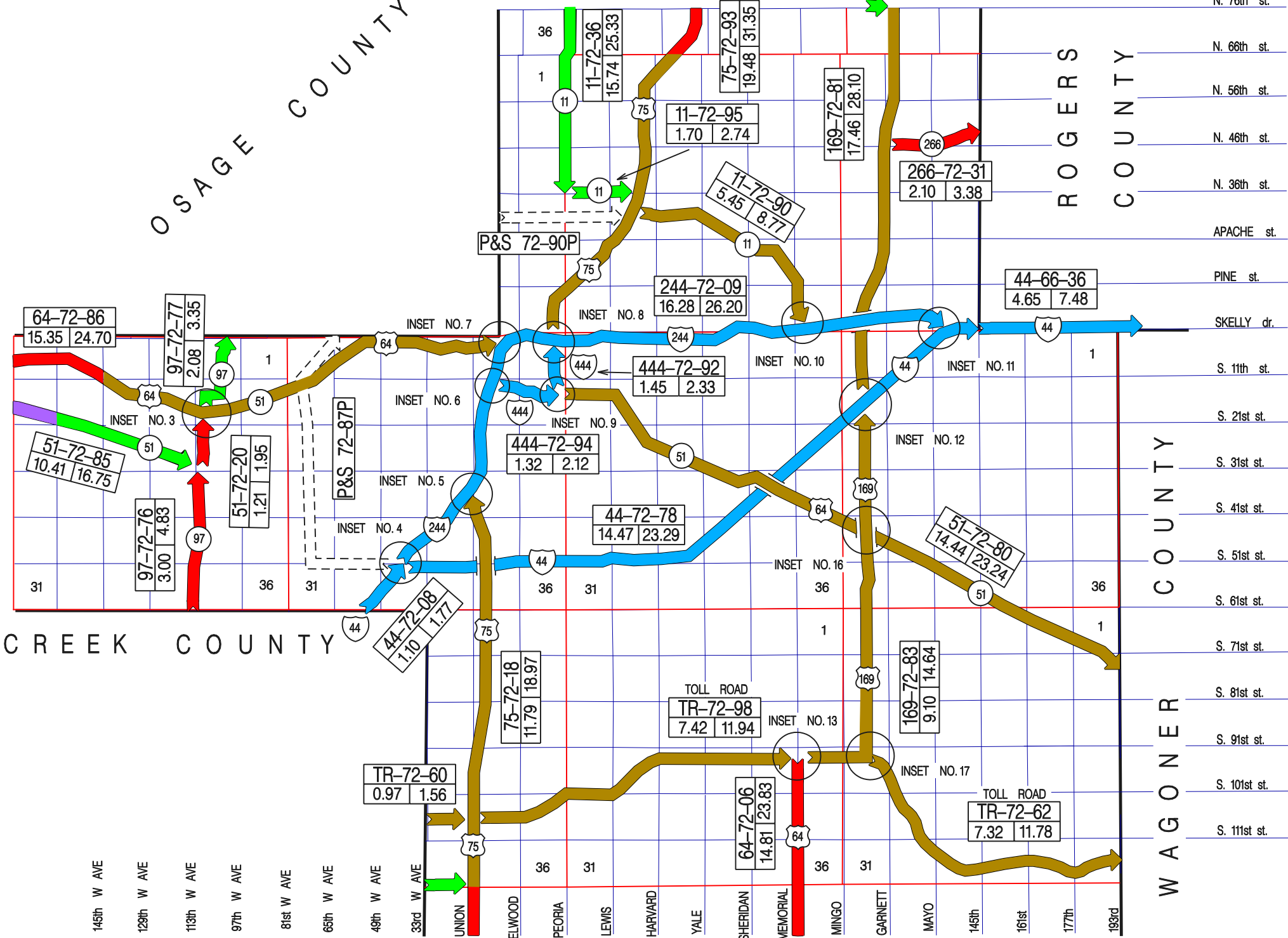

CREEK COUNTY

145th W AVE
 129th W AVE
 113th W AVE
 97th W AVE
 81st W AVE
 65th W AVE
 49th W AVE
 33rd W AVE

TULSA COUNTY 72

