

OKLAHOMA DEPARTMENT OF TRANSPORTATION — CONTROL SECTION LOG ---- ROGERS COUNTY

CONTROL	ROUTE	LENGTH	STARTING DESCRIPTION	DIRECTION	ENDING DESCRIPTION	NOTES
6602	SH 66	13.26	JCT. I-44 (GORE PT. I-44 N. BOUND)	NORTHEASTERLY	JCT. SH 20(2ND ST & RIGGS BLVD)IN CLAREMORE	AGENDA ITEM (12.95 MILES BEFORE)
6604	SH 66	25.05	JCT. SH 20(2ND ST & RIGGS BLVD)IN CLAREMORE	NORTHEASTERLY	CRAIG COUNTY LINE	
6605	US 169	1.27	TULSA COUNTY LINE	NORTHEASTERLY	TULSA COUNTY LINE	
6606	US 169	17.43	TULSA COUNTY LINE	NORTHERLY	NOWATA COUNTY LINE	REALIGNMENT (17.48 MILES BEFORE)
6608	SH 20	12.16	TULSA COUNTY LINE	EASTERLY	JCT. SH 66(WILL ROGERS & RIGGS)IN CLAREMORE	AGENDA ITEM (12.22 MILES BEFORE)
6610	SH 20	10.19	JCT. SH 66(RIGGS BLVD & 2ND ST)IN CLAREMORE	EASTERLY	MAYES COUNTY LINE	OFFSET ALIGNMENT 2005
6612	SH 28	7.43	NOWATA COUNTY LINE	SOUTHEASTERLY	JCT. SH 66(WALNUT AVE & 6TH ST)IN CHELSEA	
6616	SH 28	6.13	JCT. SH 66 S. OF CHELSEA	SOUTHERLY	MAYES COUNTY LINE	
6618	US 412	16.50	JCT. I-44 (CREEK T.P. WEST SIDE STR)	EASTERLY	MAYES COUNTY LINE	AGENDA ITEM (17.74 MILES BEFORE)
6622	SH 88	11.66	JCT. SH 33 N.W. OF INOLA	NORTHERLY	JCT. SH 20(1ST ST & LYNN RIGGS) IN CLAREMORE	AGENDA ITEM (11.78 MILES BEFORE)
6628	SH 88	12.06	JCT. SH 20(WILL ROGERS BLVD)IN CLAREMORE	NORTHWESTERLY	JCT. US 169 S. OF OOLOGAH	
6629	SH 28A	4.56	JCT. SH 66 N.E. EDGE OF FOYIL	EASTERLY	MAYES COUNTY LINE	
6630	IS 44	23.23	JCT US 412 (S. SIDE STR) REALIGN 2002	NORTHEAST (TOLL RD.)	MAYES COUNTY LINE	WILL ROGERS T.P. (AGENDA 23.41 MI.BEFORE)
6633	SH 266	8.82	TULSA COUNTY LINE	EASTERLY	JCT. SH 66 (EAST SIDE STRUCTURE)	PARTIAL REMOVAL (ADDED TO 66-46)
6634	SH 167	4.88	JCT I-44 S. EDGE OF CATOOSA	NORTHERLY	JCT. SH 266 N. OF CATOOSA	
6636	IS 44	4.65	TULSA COUNTY LINE (E. SIDE STR.)	EASTERLY	JCT. CREEK T.P. (W. SIDE STR) EXTENDED 2002	AGENDA ITEM (3.76 MILES BEFORE)
6638	SH 88	1.39	BROADWAY & COMMERCIAL IN INOLA	NORTHWESTERLY	JCT US 412 (N. SIDE STR.)	
6644	SH 412P	1.26	JCT US 412 ON SECTION LINE NS41400	EASTERLY	JCT US 412 ON SECTION LINE NS41500	
6646	TOLL RD	0.62	JCT SH 66 (E. SIDE STR)	EASTERLY	JCT I-44 (E. SIDE STR)	WILL ROGERS SPUR T.P. (CONSTRUCTED 2003)
6648P	P & S	0.00	JCT SH 20 (W. OF KEETONVILLE)	SOUTHEASTERLY	PROPOSED JCT SH 88	PROJECT MANAGEMENT
6650P	P & S	0.00	JCT SH 20 (PROPOSED ALIGNMENT)	NORTHERLY	JCT SH 20	PROJECT MANAGEMENT
6652P	P & S	0.00	JCT SH 20 (PROPOSED ALIGNMENT)	EASTERLY	JCT SH 88	PROJECT MANAGEMENT

182.55 TOTAL COUNTY MILEAGE

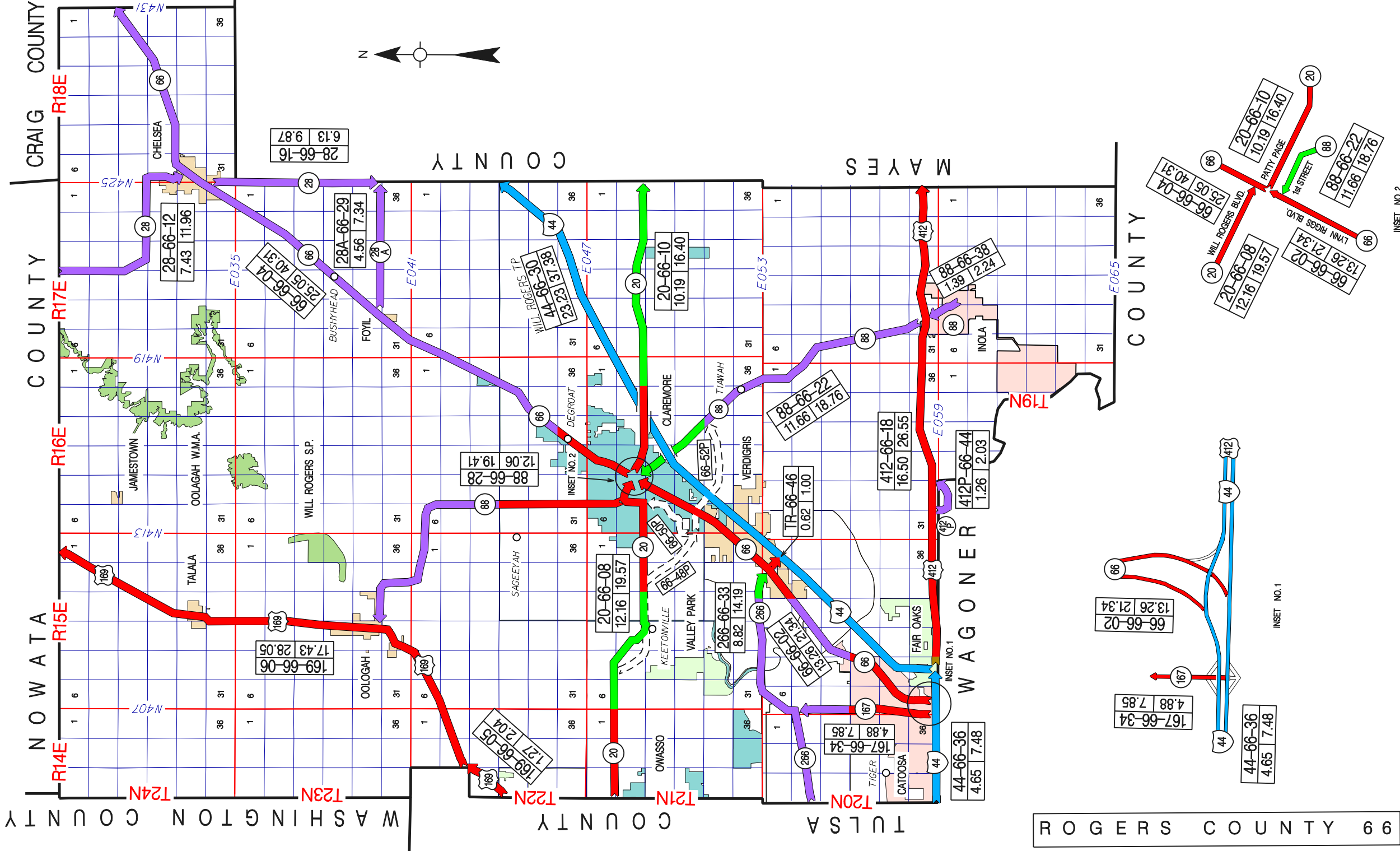

ROGERS COUNTY 69

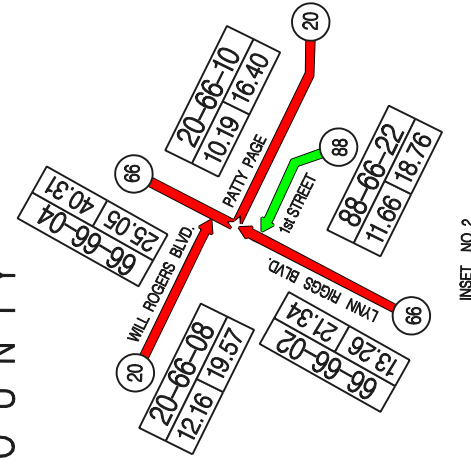
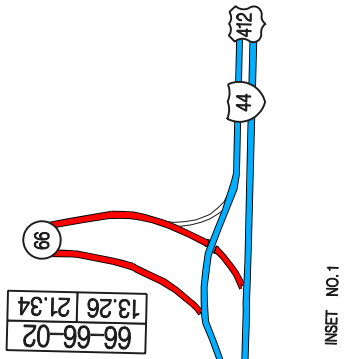
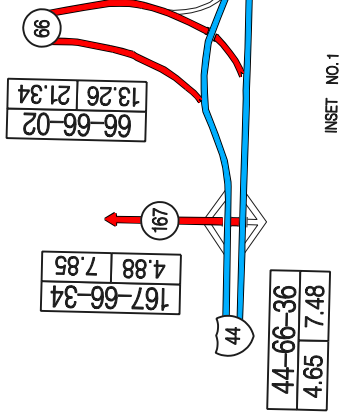

WASHINGTON COUNTY
NOWATA COUNTY
CRAIG COUNTY

T24N
T23N
T22N
T21N
T20N

R14E
R15E
R16E
R17E
R18E

N407
N413
N419
N425
N431

COUNTY

MAYES COUNTY

COUNTY

WAGONER COUNTY

