

OKLAHOMA DEPARTMENT OF TRANSPORTATION — CONTROL SECTION LOG ---- MAJOR COUNTY

CONTROL	ROUTE	LENGTH	STARTING DESCRIPTION	DIRECTION	ENDING DESCRIPTION	NOTES
4702	US 60	30.09	DEWEY COUNTY LINE	NORTH & EASTERLY	JCT. SH 58(MAIN ST) IN FAIRVIEW	
4704	US 60	10.01	JCT. SH 58 S. IN FAIRVIEW	NORTHERLY	JCT. SH 8 S. OF CLEO SPRINGS (W. WYE LEG)	AGENDA ITEM 2004 (9.99 MILES BEFORE)
4706	US 60	18.83	JCT. SH 8 S. OF CLEO SPRINGS (W. WYE LEG)	EASTERLY	GARFIELD COUNTY LINE	
4708	US 183	0.53	DEWEY-WOODWARD COUNTY LINE	NORTH ON COUNTY LINE	JCT. US 270 ON WOODWARD COUNTY LINE	
4712	US 270	1.40	JCT. US 183 ON WOODWARD COUNTY LINE	SOUTHEASTERLY	DEWEY COUNTY LINE	
4716	US 281	21.03	JCT. US 60 AT CHESTER	NORTHERLY	WOODS COUNTY LINE	
4718	SH 8	16.62	BLAINE COUNTY LINE	NORTHERLY & WESTERLY	JCT US 60,(MAIN ST) IN FAIRVIEW	
4722	SH 8	5.30	JCT. US 60 S. OF CLEO SPRINGS(W. WYE LEG)	NORTHERLY	ALFALFA COUNTY LINE	
4724	US 412	4.02	WOODWARD COUNTY LINE	EASTERLY	JCT. US 281	
4726	US 412	24.44	JCT. US 281	EASTERLY	JCT. US 60 AT ORIENTA	AGENDA ITEM 2004 (24.52 MILES BEFORE)
4728	SH 58	7.73	BLAINE COUNTY LINE	NORTHERLY	JCT. US 60 W. IN FAIRVIEW	
4732	SH 58	9.79	JCT. SH 8, E. OF FAIRVIEW	NORTHWESTERLY	JCT. US 60, N. OF RINGWOOD	
4736	SH 58	5.00	JCT. US 60, N. OF RINGWOOD	NORTHERLY	ALFALFA COUNTY LINE	
4737	SH 51A	0.85	BLAINE COUNTY LINE	NORTHERLY	JCT. SH 58 S. OF FAIRVIEW	

155.64 TOTAL COUNTY MILEAGE

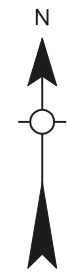
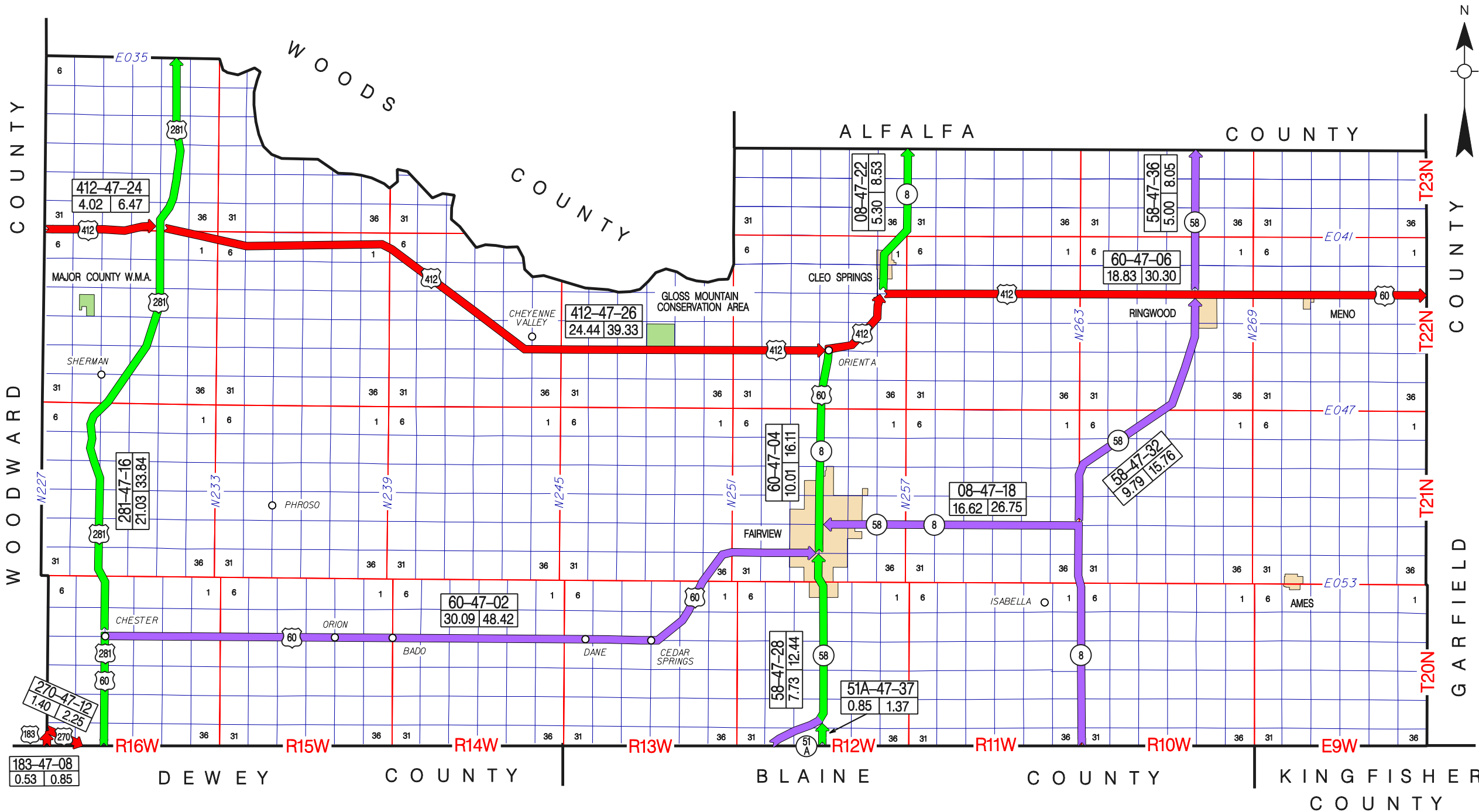

MAJOR COUNTY 47