

**OKLAHOMA DEPARTMENT OF TRANSPORTATION — CONTROL SECTION LOG ---- GRADY COUNTY**

CONTROL	ROUTE	LENGTH	STARTING DESCRIPTION	DIRECTION	ENDING DESCRIPTION	NOTES
2602	US 62	16.11	CADDO COUNTY LINE IN VERDEN	EASTERLY	JCT. SH 39 AT TABLER	
2604	US 62	10.66	JCT. SH 39 AT TABLER	NORTHEASTERLY	MCCLAIN COUNTY LINE S.W. OF BLANCHARD	AGENDA ITEM (11.07 MILES BEFORE)
2606	US 81	22.30	STEPHENS COUNTY LINE	NORTHERLY	JCT. SH 19, S. OF CHICKASHA	
2608	US 81	4.10	JCT. SH 19(S. OF CHICKASHA)	NORTHERLY	JCT. US 62(CHOCTAW AV & 4TH ST)IN CHICKASHA	
2612	US 81	21.72	JCT. US 62 W. IN CHICKASHA	NORTHERLY	CANADIAN COUNTY LINE (N. END BRIDGE)	
2614	US 277	8.58	CADDO COUNTY LINE	EASTERLY	JCT. US 81 S. OF CHICKASHA	
2616	SH 17	8.44	COMANCHE COUNTY LINE	NORTH & EASTERLY	JCT. US 81B(RUSH & BLAKELEY)IN RUSH SPRINGS	
2618	SH 19	19.18	JCT. US 81, S. OF CHICKASHA	SOUTHEASTERLY	GARVIN COUNTY LINE	
2620	SH 19C	0.48	JCT. SH 19 S. OF ALEX	NORTHERLY	"E" AVE & MAIN ST IN ALEX	
2622	SH 19D	0.30	JCT. SH 19 IN BRADLEY	NORTHERLY	STATE MAINTENANCE ENDS SIGN	
2624	SH 37	8.75	CADDO COUNTY LINE	EASTERLY	JCT. US 81 IN MINCO	
2628	SH 37	16.33	JCT. US 81(W. SECOND ST & MAIN ST)IN MINCO	EASTERLY	MCCLAIN COUNTY LINE	AGENDA ITEM (16.62 MILES BEFORE)
2630	SH 39	8.59	JCT. US 62 AT TABLER	EASTERLY	MCCLAIN COUNTY LINE	
2636	SH 92	18.09	JCT. US 62, E. OF CHICKASHA	NORTHEASTERLY	JCT. SH 37(MAIN ST & FOURTH)IN TUTTLE	
2642	IS 44	34.62	CADDO COUNTY LINE	NORTHEASTERLY	MCCLAIN COUNTY LINE	H. E. BAILEY T.P.
2646	US 81B	2.88	JCT. US 81 S. OF RUSH SPRINGS	NORTHERLY	JCT. US 81 N. OF RUSH SPRINGS	
2648	SH 4	2.65	JCT SH 37 IN TUTTLE	NORTHERLY	CANADIAN COUNTY LINE (N. END BRIDGE)	NEW CONSTRUCTION 2002
2650	SH 4	5.26	JCT I-44 (H.E. BAILEY TURNPIKE) W. SIDE STR.	NORTHERLY	JCT SH 37	NEW CONSTRUCTION 2003
2652	TOLL RD	2.72	JCT I-44 (H.E. BAILEY TURNPIKE) W. SIDE STR.	EASTERLY	MCCLAIN COUNTY LINE	NORMAN SPUR T.P. (CONSTRUCTED 2002)
2654P	P & S	0.00	JCT US 81	NORTHERLY	JCT US 62	PROJECT MGMT EST 6.70 MILES

**211.76 TOTAL COUNTY MILEAGE**

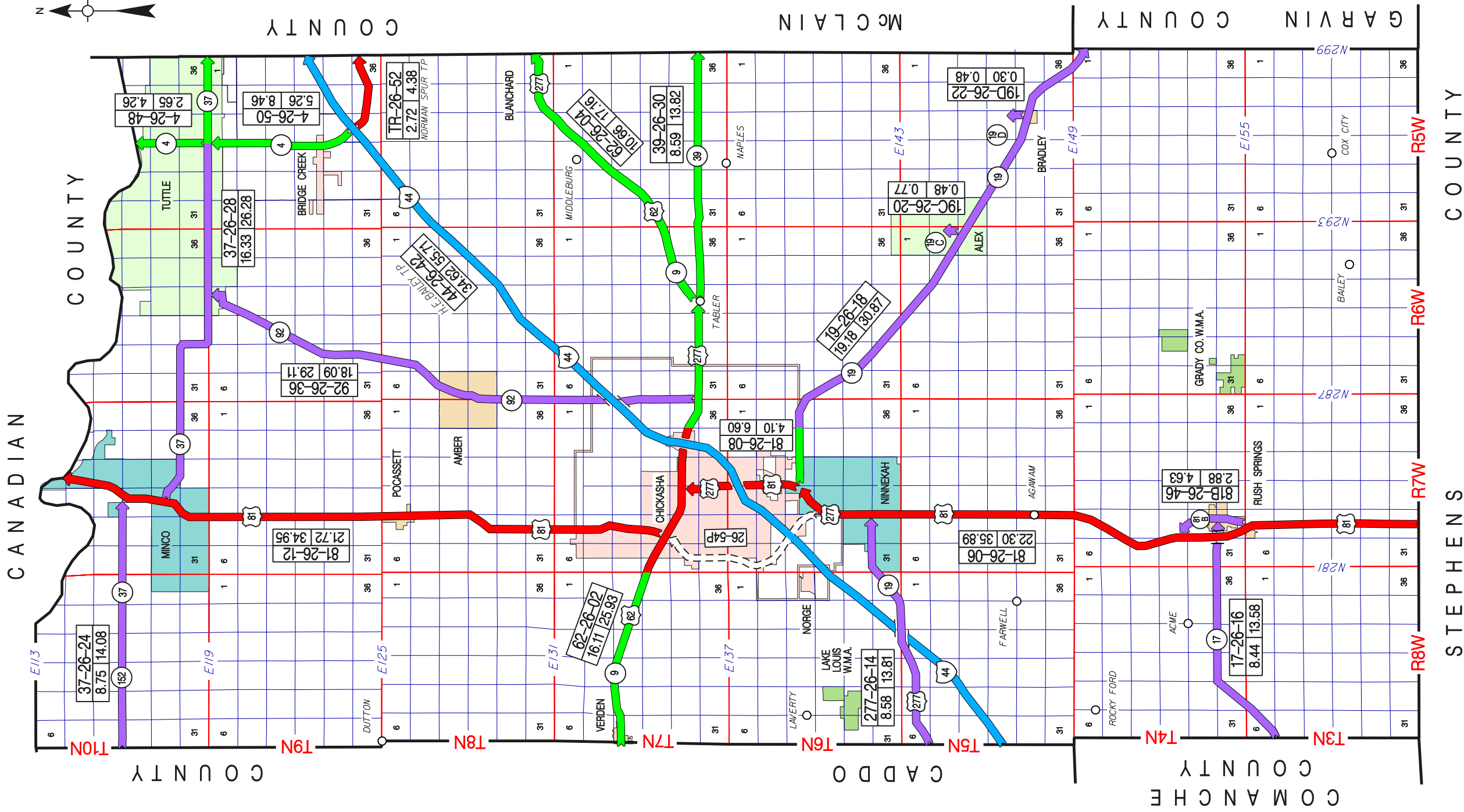

CANADIAN COUNTY  
STEPHENS COUNTY  
COMANCHE COUNTY  
McCLAIN COUNTY