

OKLAHOMA DEPARTMENT OF TRANSPORTATION — CONTROL SECTION LOG ---- GARVIN COUNTY

CONTROL	ROUTE	LENGTH	STARTING DESRIPTION	DIRECTION	ENDING DESCRIPTION	NOTES
2502	US 77	20.02	MURRAY COUNTY LINE	NORTHERLY	MC CLAIN COUNTY LINE	AGENDA ITEM (REALIGN SAME MILEAGE)
2504	SH 7	10.03	MURRAY COUNTY LINE AT HENNEPIN	EASTERLY	MURRAY COUNTY LINE	
2506	US 177	14.99	MURRAY COUNTY LINE	NORTHERLY	MCCLAIN COUNTY LINE	
2508	SH 19	15.21	GRADY COUNTY LINE	EASTERLY	JCT. SH 74(RIPLEY & SIXTH STS)IN MAYSVILLE	
2510	SH 19	12.46	JCT. SH 74(RIPLEY ST & SIXITH ST)IN MAYSVILLE	SOUTHEASTERLY	JCT. US 77(ASH ST & GRANT AVE)	
2512	SH 19	16.04	JCT. US 77(GRANT & CHICKASAW)IN PAULS VALLEY	NORTHEASTERLY	JCT. US 177(FORREST & SMITH)IN STRATFORD	AGENDA ITEM (16.25 MILES BEFORE)
2514	SH 19	2.00	JCT. US 177(FORREST & SMITH)IN STRATFORD	EASTERLY	PONTOTOC COUNTY LINE	
2520	SH 29	21.67	STEPHENS COUNTY LINE	EASTERLY	JCT. US 77 N.W. OF WYNNEWOOD	
2526	SH 29	11.72	JCT. US 77(MCGEE & KERR) IN WYNNEWOOD	EASTERLY	JCT. US 177	
2527	SH 74	8.46	CARTER COUNTY LINE	NORTHERLY	JCT. SH 29("D" ST & MAIN ST)IN ELMORE CITY	
2528	SH 74	13.51	JCT. SH 29("D" ST & MAIN ST)IN ELMORE CITY	NORTHERLY	JCT. SH 19(6TH ST & RIPLEY ST)IN MAYSVILLE	
2530	SH 74	2.62	JCT. SH 19(6TH ST & RIPLEY ST)IN MAYSVILLE	NORTHERLY	MCCLAIN COUNTY LINE	
2532	SH 76	8.01	CARTER COUNTY LINE	NORTHERLY	JCT. SH 29, W. OF FOSTER	
2536	SH 76	10.76	STEPHENS COUNTY LINE	NORTHERLY	JCT. SH 19E(CHEROKEE ST & 4TH ST)IN LINDSAY	
2540	SH 76	1.28	JCT. SH 19 W(CHEROKEE ST)IN LINDSAY	NORTHERLY	MCCLAIN COUNTY LINE	
2544	SH 29A	0.48	END OF HIGHWAY AT FOSTER (POST OFFICE)	NORTHERLY	JCT. SH 29, N. OF FOSTER	
2545	SH 59B	2.36	JCT. SH 19, E. OF LINDSAY	NORTHEASTERLY	MCCLAIN COUNTY LINE	
2546	IS 35	25.89	MURRAY COUNTY LINE	NORTHWESTERLY	MCCLAIN COUNTY LINE	
2547	SH 133	4.55	JCT. SH 19 N.E. OF PAULS VALLEY	NORTHEASTERLY	MCCLAIN COUNTY LINE	
2548	SH 145	2.88	JCT. I-35 (W. SIDE STR.)	EASTERLY	JCT. US 77(OKLAHOMA ST & DAVIS ST)IN PAOLI	
2553	SH 17A	3.10	JCT I-35	EASTERLY	JCT US 77 SOUTH OF WYNNEWOOD	

208.04 TOTAL COUNTY MILEAGE

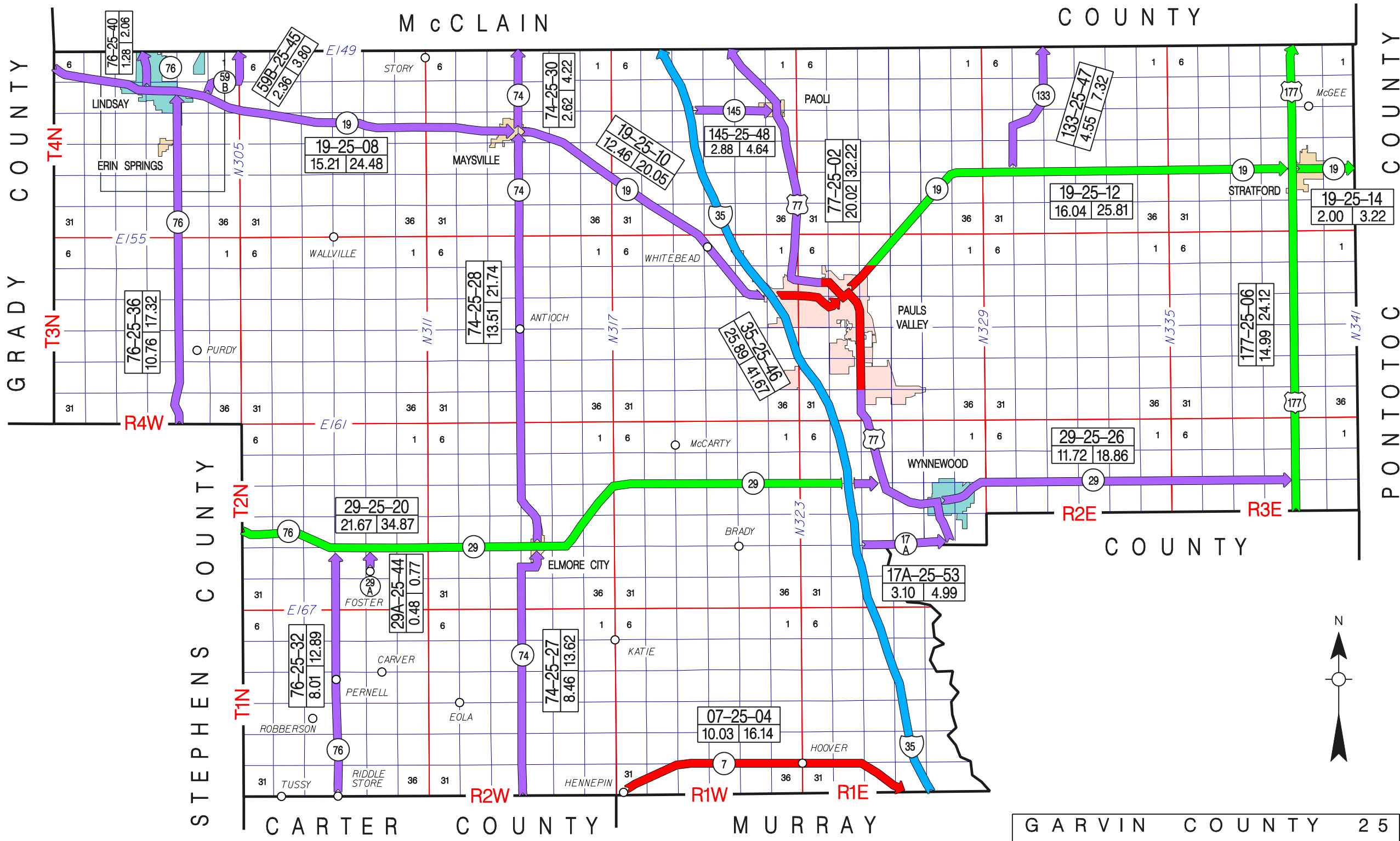

76-25-40
1.28 2.06

59B-23-45
2.36 3.80

19-25-08
15.21 24.48

74-25-30
2.62 4.22

19-25-10
12.46 20.05

145-25-48
2.88 4.64

77-25-02
20.02 32.22

133-25-47
4.55 7.32

19-25-12
16.04 25.81

19-25-14
2.00 3.22

76-25-36
10.76 17.32

74-25-28
13.51 21.74

35-25-46
25.89 41.67

177-25-06
14.99 24.12

29-25-26
11.72 18.86

29-25-20
21.67 34.87

29A-25-44
0.48 0.77

76-25-32
8.01 12.89

74-25-27
8.46 13.62

07-25-04
10.03 16.14

17A-25-53
3.10 4.99

