

**OKLAHOMA DEPARTMENT OF TRANSPORTATION — CONTROL SECTION LOG ---- CIMARRON COUNTY**

<b>CONTROL</b>	<b>ROUTE</b>	<b>LENGTH</b>	<b>STARTING DESRIPTION</b>	<b>DIRECTION</b>	<b>ENDING DESCRIPTION</b>	<b>NOTES</b>
1302	US 56	33.52	NEW MEXICO STATE LINE	NORTHEASTERLY	JCT. US 287 E. OF BOISE CITY	
1304	US 64	25.74	JCT. US 287 E. OF BOISE CITY	EASTERLY	TEXAS COUNTY LINE	
1306	US 287	21.15	TEXAS STATE LINE	NORTHWESTERLY	JCT. US 64, E. OF BOISE CITY (N. END BRIDGE)	REALIGNMENT 2011 (21.07 BEFORE)
1310	US 287	19.80	JCT. US 64 E. OF BOISE CITY (N. END BR.)	NORTHERLY	COLORADO STATE LINE	REALIGNMENT 2011 (18.55 BEFORE)
1314	US 64A	0.09	JCT. US 64 S., IN BOISE CITY	WEST SIDE OF CRT HOUSE	JCT. US 385 N., IN BOISE CITY	
1316	US 56	22.37	JCT. US 64 N.E. OF BOISE CITY	NORTHEASTERLY	TEXAS COUNTY LINE	
1317	US 385	14.09	TEXAS STATE LINE	NORTHERLY	JCT. US 56, S.W. OF BOISE CITY	
1320	SH 325	38.08	NEW MEXICO STATE LINE	SOUTHEASTERLY	JCT US 64A, IN BOISE CITY	
1321	SH 171	21.47	JCT. US 287	NORTHERLY	JCT. US 56 W. EDGE OF KEYES	
1322	US 385	0.98	JCT. US 56 IN BOISE CITY	NORTHERLY	JCT. US 287 N. OF BOISE CITY	AGENDA ITME 2011 (OLD US 287)

**197.29 TOTAL COUNTY MILEAGE**

STATE

OF

COLORADO

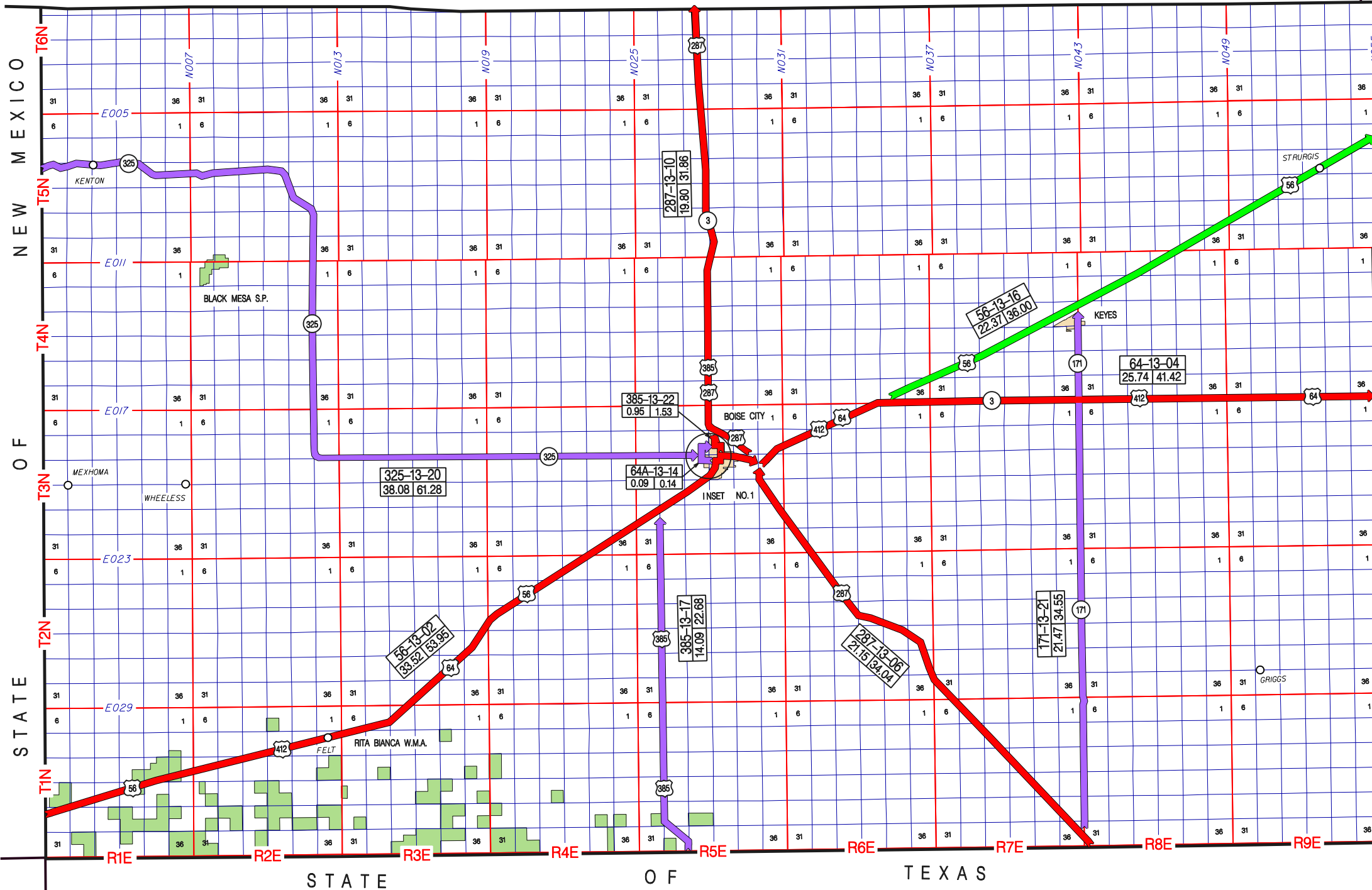

COUNTY

TEXAS

STATE

OF

TEXAS

