

McCLAIN

COUNTY

GRADY COUNTY

PONTOTOC COUNTY

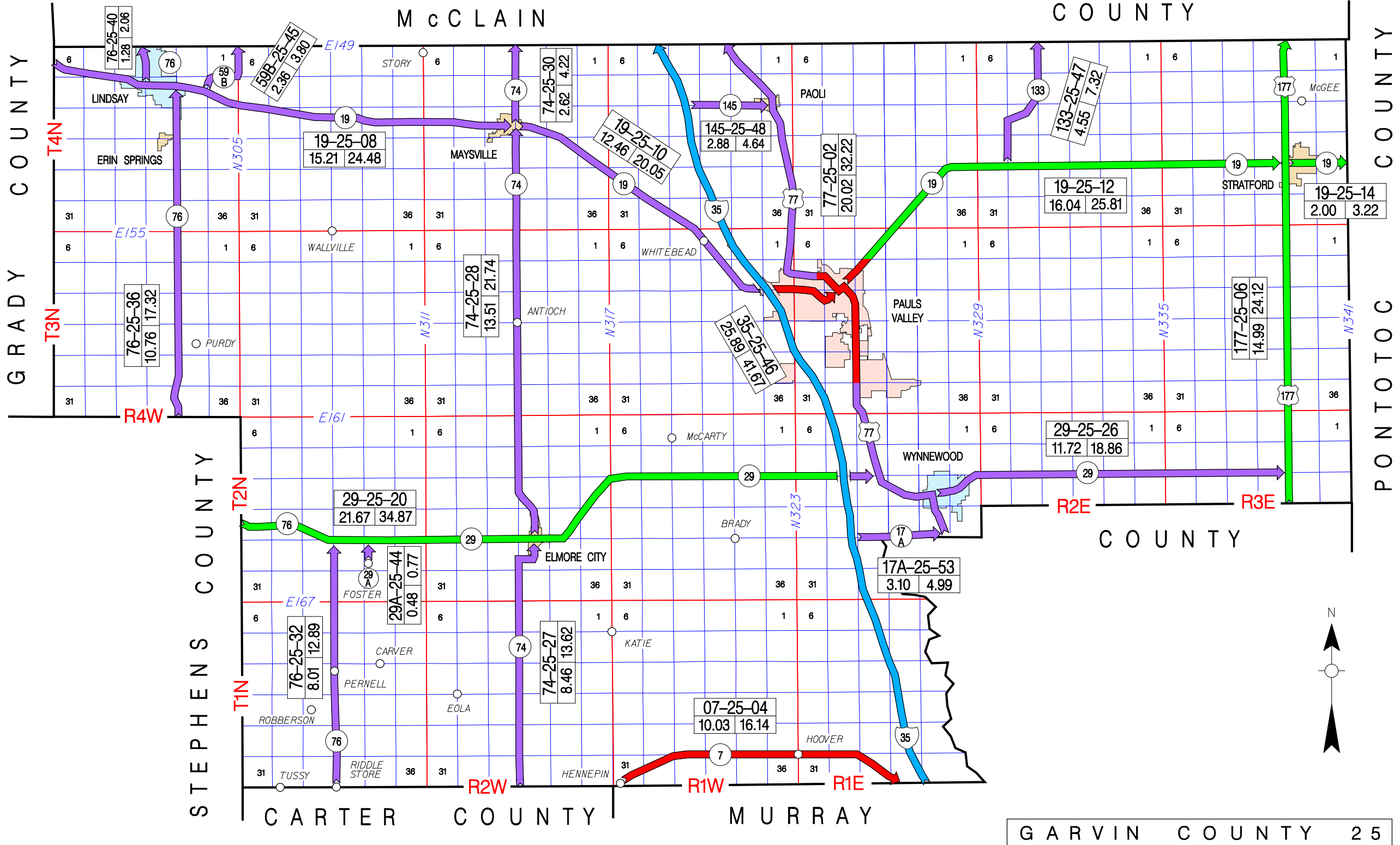

76-25-40  
1.28 2.06

59B-25-45  
2.36 3.80

19-25-08  
15.21 24.48

74-25-30  
2.62 4.22

19-25-10  
12.46 20.05

145-25-48  
2.88 4.64

77-25-02  
20.02 32.22

133-25-47  
4.55 7.32

19-25-12  
16.04 25.81

19-25-14  
2.00 3.22

76-25-36  
10.76 17.32

74-25-28  
13.51 21.74

35-25-46  
25.89 41.67

177-25-06  
14.99 24.12

29-25-26  
11.72 18.86

29-25-20  
21.67 34.87

29A-25-44  
0.48 0.77

76-25-32  
8.01 12.89

74-25-27  
8.46 13.62

17A-25-53  
3.10 4.99

07-25-04  
10.03 16.14

